

THIS DRAWING IS UNPUBLISHED. RELEASED FOR PUBLICATION  
 © COPYRIGHT BY TYCO ELECTRONICS CORPORATION. ALL RIGHTS RESERVED.

LOC	DIST	REVISIONS			
P	LTR	DESCRIPTION	DATE	DWN	APVD
		0	TRANSFERED TO TYCO FORMAT	26JUN02	MF EH

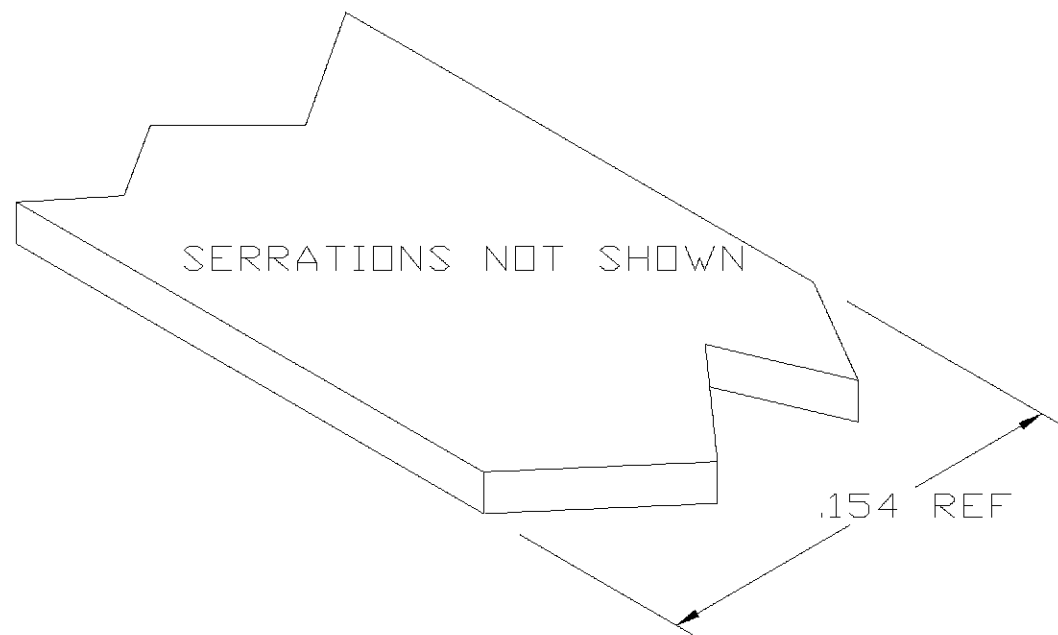

- 1 CRIMPBAND MATERIAL PROVIDED IN CONTINUOUS STRIP.
- 2 REFERENCE DESCRIPTIVE PART NUMBER 6R16B.
- 3 880 FEET PER REEL. PIECES PER REEL DETERMINED BY APPLICATION TOOLSET.

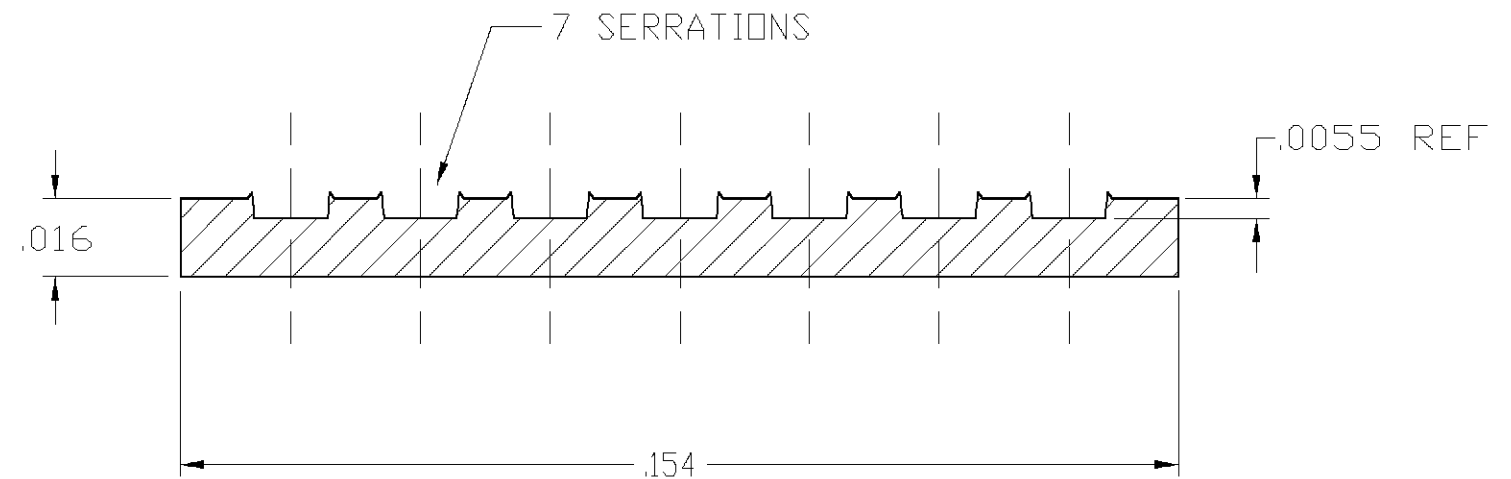

TYP. CROSS SECTION

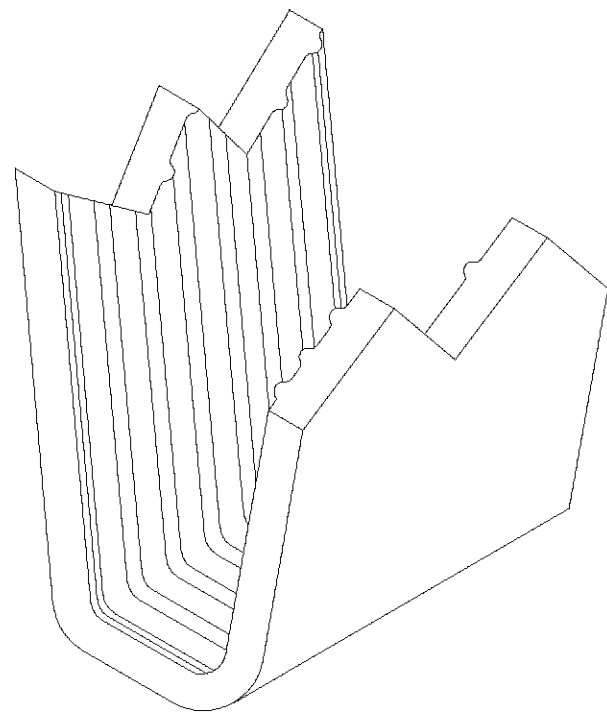

PARTIAL FORMED VIEW (REF)  
FORMED BY APPLICATION TOOLING

1601991-1  
PART NUMBER

THIS DRAWING IS A CONTROLLED DOCUMENT.		DWN MICHAEL S. FEHER 26JUN2002	Tyco Electronics Corporation Harrisburg, PA 17105-3608		
DIMENSIONS: INCHES	TOLERANCES UNLESS OTHERWISE SPECIFIED:	CHK EDWARD HOWARD 26JUN2002	NAME		
	0 PLC ± -	APVD EDWARD HOWARD 26JUN2002	-		
	1 PLC ± -	PRODUCT SPEC	CRIMPBAND, MTM		
	2 PLC ± -	APPLICATION SPEC	SIZE	CAGE CODE	DRAWING NO
	3 PLC ± .005	WEIGHT	A3	00779	C-1601991
	4 PLC ± -	CUSTOMER DRAWING	SCALE	SHEET	OF
	ANGLES ± -		1:1	1	1
MATERIAL	FINISH		RESTRICTED TO	REV	
UNS C26000 BRASS	NONE		-	0	