

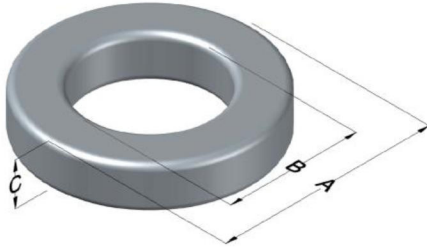

0076451A7

110 Delta Drive
 Pittsburgh, PA 15238
 NAFTA Sales: (1)800-245-3984
 HK Sales : (852)3102-9337
 magnetics@spang.com
 www.mag-inc.com



Kool M μ Hf Permeability (μ)	A _L (nH/T ²)	Core Marking			Coating Color
		Lot Number	Part Number	Inductance Grade	
60	108 ± 8%	XXXXXX	76451A7	N/A	Black

Dimensions	Uncoated		Coated Limits			Packaging
	(mm)	(in)	(mm)	(in)		
OD (A)	42.90	1.689	43.84	1.726	max	Cardboard cut-outs Box Qty= 120 pcs
ID (B)	24.21	0.953	23.39	0.921	min	
HT (C)	16.26	0.640	17.27	0.680	max	

Electrical Characteristics			Physical Characteristics						
Watt Loss @ 100 kHz, 100mT max (mW/cm ³)	DC Bias min (oersteds)		Voltage Breakdown wire to wire min (V _{AC})	Break Strength min (kg)	Window Area W _A (mm ²)	Cross Section A _e (mm ²)	Path Length L _e (mm)	Volume V _e (mm ³)	Weight (g)
	80%	50%							
450	45	100	3000	98.8	430	147.5	102	15100	90

Winding Information					Temperature Rating	
Winding Length Per Turn				Wound Coil Dimensions (mm)		Curie Temp: 500°C
Winding Factor	(mm)	Winding Factor	(mm)	40% Winding Factor	OD	47.6
					HT	24.6
0%	55.0	40%	67.1	Completely Full Window	Max OD	59.4
20%	61.1	45%	68.9		Max HT	36.7
25%	62.5	50%	70.8	Surface Area (mm ²)		
30%	63.8	60%	74.2	Unwound Core		5,800
35%	65.6	70%	78.5	40% Winding Factor		8,400
Coating Temp (Continuous up to): 200°C						
Notes:						

