

ITEM	PART#	DESCRIPTION	QTY	UOM
A	561349002	2.0 WTB CONN CRIMP REC AWG#26-#28 CHAIN	1	PC

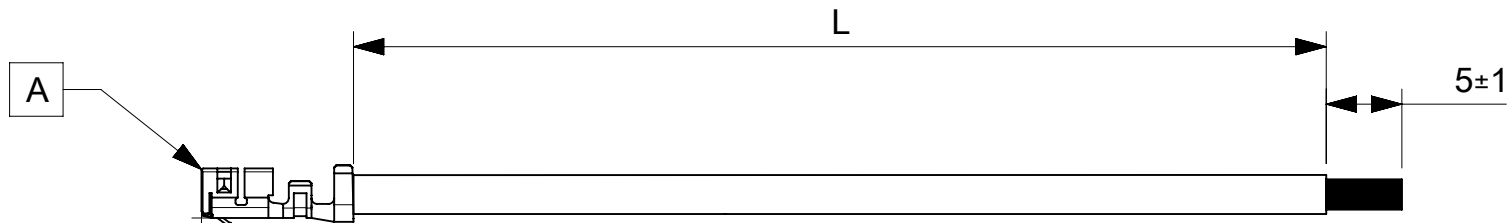

PART NUMBER	TITLE	CABLE DESCRIPTION	LENGTH 'L'	CABLE COLOR
2196551101	Micro-One ISL F-S 75mm 26AWG Lead BK Sn	1X26AWG DISC PVC BK UL1569	75±3	BLACK
2196551102	Micro-One ISL F-S 150mm 26AWG Lead BK Sn	1X26AWG DISC PVC BK UL1569	150±4	BLACK
2196551103	Micro-One ISL F-S 225mm 26AWG Lead BK Sn	1X26AWG DISC PVC BK UL1569	225±4	BLACK
2196551104	Micro-One ISL F-S 300mm 26AWG Lead BK Sn	1X26AWG DISC PVC BK UL1569	300±4	BLACK
2196551105	Micro-One ISL F-S 450mm 26AWG Lead BK Sn	1X26AWG DISC PVC BK UL1569	450±4	BLACK
2196552101	Micro-One ISL F-S 75mm 26AWG Lead RD Sn	1X26AWG DISC PVC RD UL1569	75±3	RED
2196552102	Micro-One ISL F-S 150mm 26AWG Lead RD Sn	1X26AWG DISC PVC RD UL1569	150±4	RED
2196552103	Micro-One ISL F-S 225mm 26AWG Lead RD Sn	1X26AWG DISC PVC RD UL1569	225±4	RED
2196552104	Micro-One ISL F-S 300mm 26AWG Lead RD Sn	1X26AWG DISC PVC RD UL1569	300±4	RED
2196552105	Micro-One ISL F-S 450mm 26AWG Lead RD Sn	1X26AWG DISC PVC RD UL1569	450±4	RED

**NOTES:**

1. Crimping to be done as per Molex standards.
2. The product specification relies on the terminals & wire spec.
3. Free ends must be stripped, twisted & tinned. The length of tinning is 5±1mm. Tinning dia must be 0.65mm Max.

REVISION			
DATE	REV	DESCRIPTION	CHANGER
2021/12/27	A	INITIAL RELEASE	SAIKIG
DOCUMENT STATUS	P1	RELEASE DATE	2022/01/11 06:51:04

FUNCTIONAL SYMBOLS	THIS DRAWING CONTAINS INFORMATION THAT IS PROPRIETARY TO MOLEX ELECTRONIC TECHNOLOGIES, LLC AND SHOULD NOT BE USED WITHOUT WRITTEN PERMISSION		
	DIMENSION UNITS	SCALE	CURRENT REV DESC:
$\nabla_A = 0$	mm	NTS	<p><b>molex</b></p> <p>SEE TABLE</p> <p>PRODUCT CUSTOMER DRAWING</p> <p>DOCUMENT NUMBER: 2196551101   DOC TYPE: PSD   DOC PART: 000   REVISION: A</p> <p>INITIAL REVISION: DRWN: SAIKIG 2021/12/25   APPR: MNARAYAN01 2022/01/11</p> <p>DRAFT WHERE APPLICABLE MUST REMAIN WITHIN DIMENSIONS</p> <p>THIRD ANGLE PROJECTION</p> <p>DRAWING: A4-SIZE   SERIES: 219655   MATERIAL NUMBER: SEE TABLE   CUSTOMER: GENERAL MARKET   SHEET NUMBER: 1 OF 1</p>
$\nabla_E = 0$	GENERAL TOLERANCES (UNLESS SPECIFIED)		
$\nabla_P = 0$	ANGULAR TOL ± °		
DIVISIONAL SYMBOLS	4 PLACES	±	
	3 PLACES	±	