

NOTES:

1. FOR ILLUSTRATION PURPOSES, DRAWING SHOWS PART WITH 12 CIRCUIT SIZE.
2. MATERIAL:
HOUSING & CAP:
HIGH TEMPERATURE THERMOPLASTIC, UL RATED 94V-0 SUITABLE FOR SURFACE-MOUNT SOLDERING PROCESS.
COLOR BLACK
TERMINAL: PHOSPHOR BRONZE ALLOY.
3. PLATING- 0.76µm MINIMUM GOLD PLATE AT CONTACT AREA, AND 1.90µm MINIMUM TIN PLATE AT P.C TAIL AREA, BOTH OVER 1.27µm MINIMUM NICKEL OVERALL.
4. COPLANARITY OF P.C TAIL TO BE MEASURED BY RESTING THE PART ON A FLAT GAGE SURFACE.
5. THIS AREA OF PART TO BE HEAT-STAKED TO RETAIN CONTACTS.
6. POSITION OF CAP TO BE LOCATED AT CENTER OF DIMENSION "A" REGARDLESS OF CIRCUIT SIZE.
7. PRODUCT SPECIFICATION PS-87340 APPLIES.
8. PART TO BE PACKAGED IN TAPE-&-REEL. SEE SHEET 2 FOR PACKAGING DETAILS.
9. CONTACT FACTORY FOR PARTS AVAILABILITY.

PART NUMBER W/CAP IN TUBE	CKT. SIZE	DIM. A	DIM. B
87340-0497	4	4.00	2.00
87340-0697	6	6.00	4.00
87340-0897	8	8.00	6.00
87340-1097	10	10.00	8.00
87340-1297	12	12.00	10.00
87340-1497	14	14.00	12.00
87340-1697	16	16.00	14.00
87340-1897	18	18.00	16.00
87340-2097	20	20.00	18.00

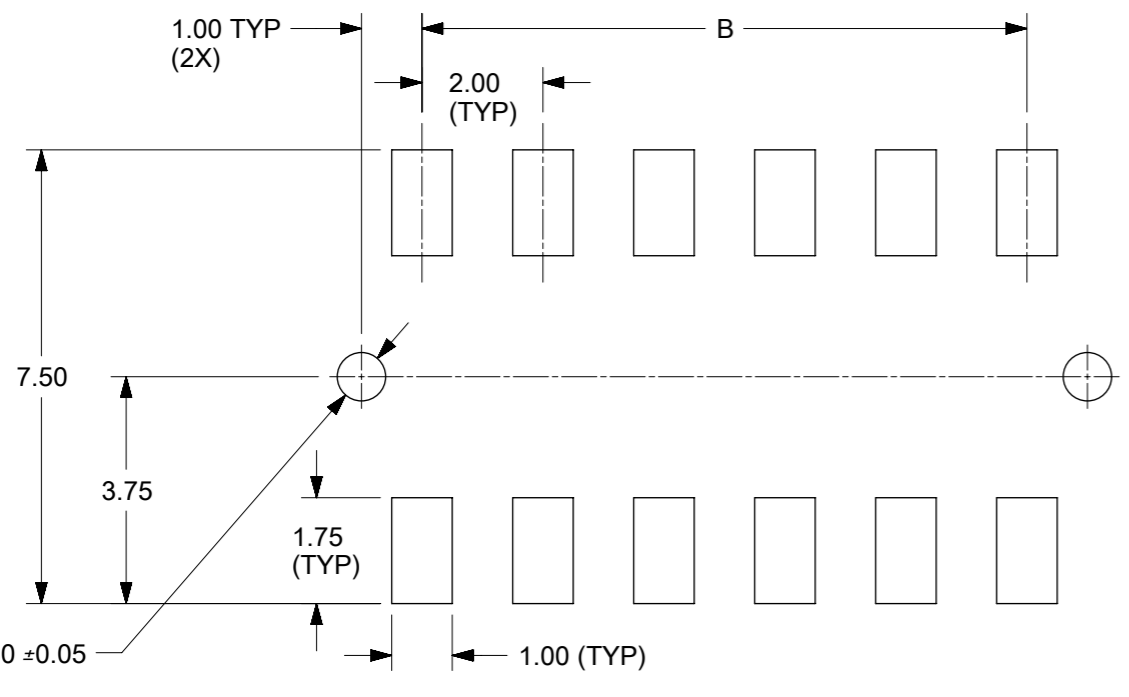
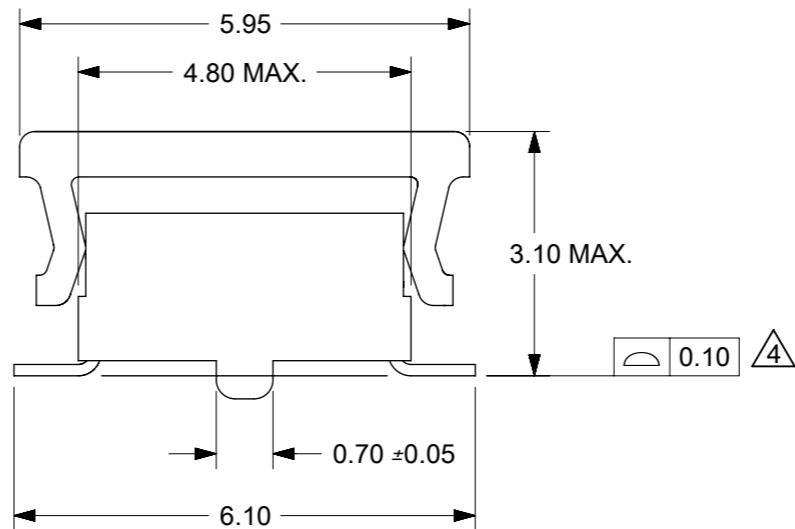
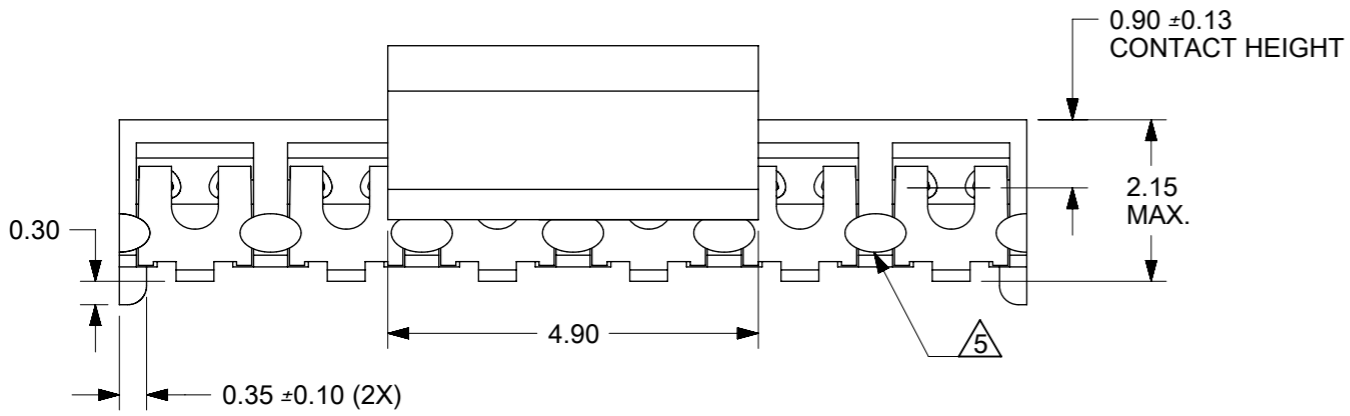

RECOMMENDED SOLDER PAD DESIGN

THIS DRAWING CONTAINS INFORMATION THAT IS PROPRIETARY TO MOLEX ELECTRONIC TECHNOLOGIES, LLC AND SHOULD NOT BE USED WITHOUT WRITTEN PERMISSION		CURRENT REV DESC: MIGRATED TO ECTR		molex																																												
MGRID, VLPR II TOP ENTRY RECEPT., SMT W/CAP FOR PICK-&-PLACE		PRODUCT CUSTOMER DRAWING																																														
<table border="1"> <tr><th>DIMENSION UNITS</th><th>SCALE</th></tr> <tr><td>mm</td><td>NTS</td></tr> </table>		DIMENSION UNITS	SCALE	mm	NTS	<table border="1"> <tr><th>GENERAL TOLERANCES (UNLESS SPECIFIED)</th><th>MM</th><th>INCH</th></tr> <tr><td>4 PLACES ±</td><td></td><td></td></tr> <tr><td>3 PLACES ±</td><td></td><td></td></tr> <tr><td>2 PLACES ±</td><td>0.2</td><td></td></tr> <tr><td>1 PLACE ±</td><td></td><td></td></tr> <tr><td>0 PLACES ±</td><td></td><td></td></tr> <tr><td>ANGULAR TOL</td><td>± 3.0°</td><td></td></tr> </table>		GENERAL TOLERANCES (UNLESS SPECIFIED)	MM	INCH	4 PLACES ±			3 PLACES ±			2 PLACES ±	0.2		1 PLACE ±			0 PLACES ±			ANGULAR TOL	± 3.0°		<table border="1"> <tr><td>EC NO: 172635</td><td></td></tr> <tr><td>DRWN: RMV02</td><td>2018/02/20</td></tr> <tr><td>CHK'D: CD</td><td>2018/05/25</td></tr> <tr><td>APPR: GGA</td><td>2018/05/30</td></tr> </table>		EC NO: 172635		DRWN: RMV02	2018/02/20	CHK'D: CD	2018/05/25	APPR: GGA	2018/05/30	<table border="1"> <tr><td>DOCUMENT NUMBER</td><td>DOC TYPE</td><td>DOC PART</td><td>REVISION</td></tr> <tr><td>SD-87340-XX94</td><td>PSD</td><td>001</td><td>D1</td></tr> </table>		DOCUMENT NUMBER	DOC TYPE	DOC PART	REVISION	SD-87340-XX94	PSD	001	D1
DIMENSION UNITS	SCALE																																															
mm	NTS																																															
GENERAL TOLERANCES (UNLESS SPECIFIED)	MM	INCH																																														
4 PLACES ±																																																
3 PLACES ±																																																
2 PLACES ±	0.2																																															
1 PLACE ±																																																
0 PLACES ±																																																
ANGULAR TOL	± 3.0°																																															
EC NO: 172635																																																
DRWN: RMV02	2018/02/20																																															
CHK'D: CD	2018/05/25																																															
APPR: GGA	2018/05/30																																															
DOCUMENT NUMBER	DOC TYPE	DOC PART	REVISION																																													
SD-87340-XX94	PSD	001	D1																																													
<table border="1"> <tr><td>INITIAL REVISION:</td><td></td></tr> <tr><td>DRWN: DSOH</td><td>1997/06/19</td></tr> <tr><td>APPR: SKTOH</td><td>1997/06/27</td></tr> </table>		INITIAL REVISION:		DRWN: DSOH	1997/06/19	APPR: SKTOH	1997/06/27	<table border="1"> <tr><td>DRAFT WHERE APPLICABLE MUST REMAIN WITHIN DIMENSIONS</td><td>THIRD ANGLE PROJECTION</td><td>DRAWING</td><td>SERIES</td><td>MATERIAL NUMBER</td><td>CUSTOMER</td><td>SHEET NUMBER</td></tr> <tr><td></td><td></td><td>A3-SIZE</td><td>87340</td><td>SEE TABLE</td><td>GENERAL MARKET</td><td>1 OF 2</td></tr> </table>		DRAFT WHERE APPLICABLE MUST REMAIN WITHIN DIMENSIONS	THIRD ANGLE PROJECTION	DRAWING	SERIES	MATERIAL NUMBER	CUSTOMER	SHEET NUMBER			A3-SIZE	87340	SEE TABLE	GENERAL MARKET	1 OF 2																									
INITIAL REVISION:																																																
DRWN: DSOH	1997/06/19																																															
APPR: SKTOH	1997/06/27																																															
DRAFT WHERE APPLICABLE MUST REMAIN WITHIN DIMENSIONS	THIRD ANGLE PROJECTION	DRAWING	SERIES	MATERIAL NUMBER	CUSTOMER	SHEET NUMBER																																										
		A3-SIZE	87340	SEE TABLE	GENERAL MARKET	1 OF 2																																										

PART NUMBER W/CAP IN TAPE/REEL	CKT. SIZE	Ao	Bo	F	W	Ko
87340-0498	4	6.70	5.30	11.50	24.00	5.30
87340-0698	6	6.50	6.50	7.50	16.00	4.50
87340-0898	8	6.70	8.40	11.50	24.00	5.30
87340-1298	12	6.60	12.40	11.50	24.00	4.40
87340-1498	14	6.60	14.30	11.50	24.00	4.40
87340-1698	16	6.60	16.30	11.50	24.00	4.40
87340-2098	20	6.70	20.50	20.20	44.00	5.30

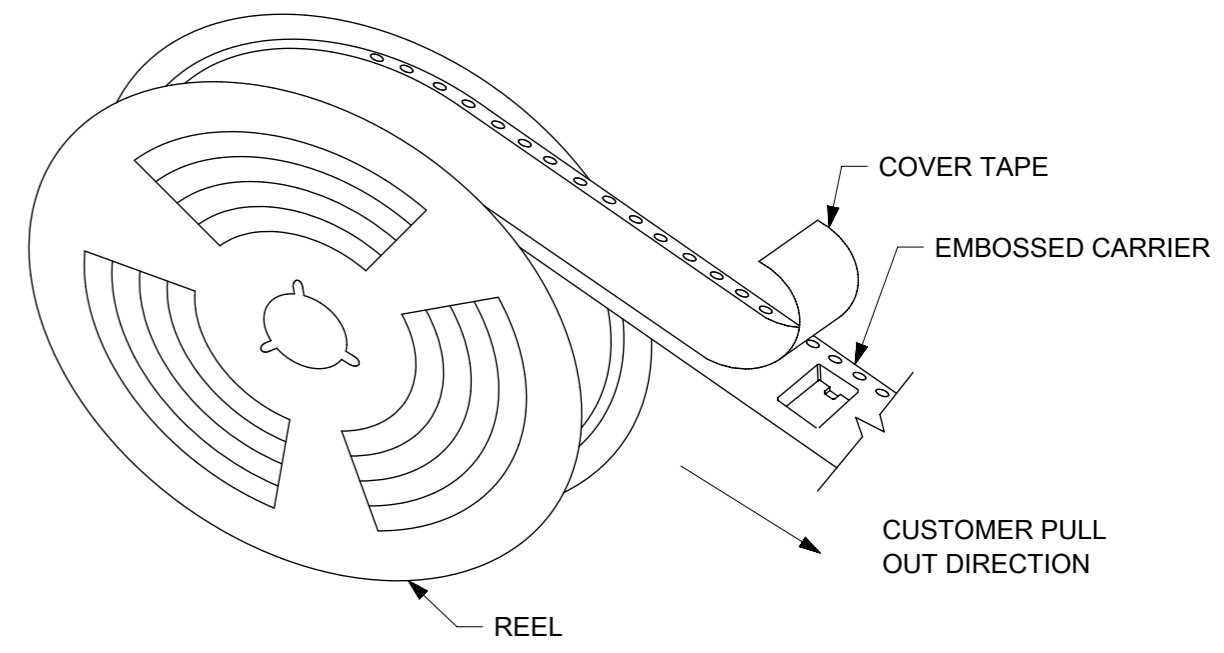
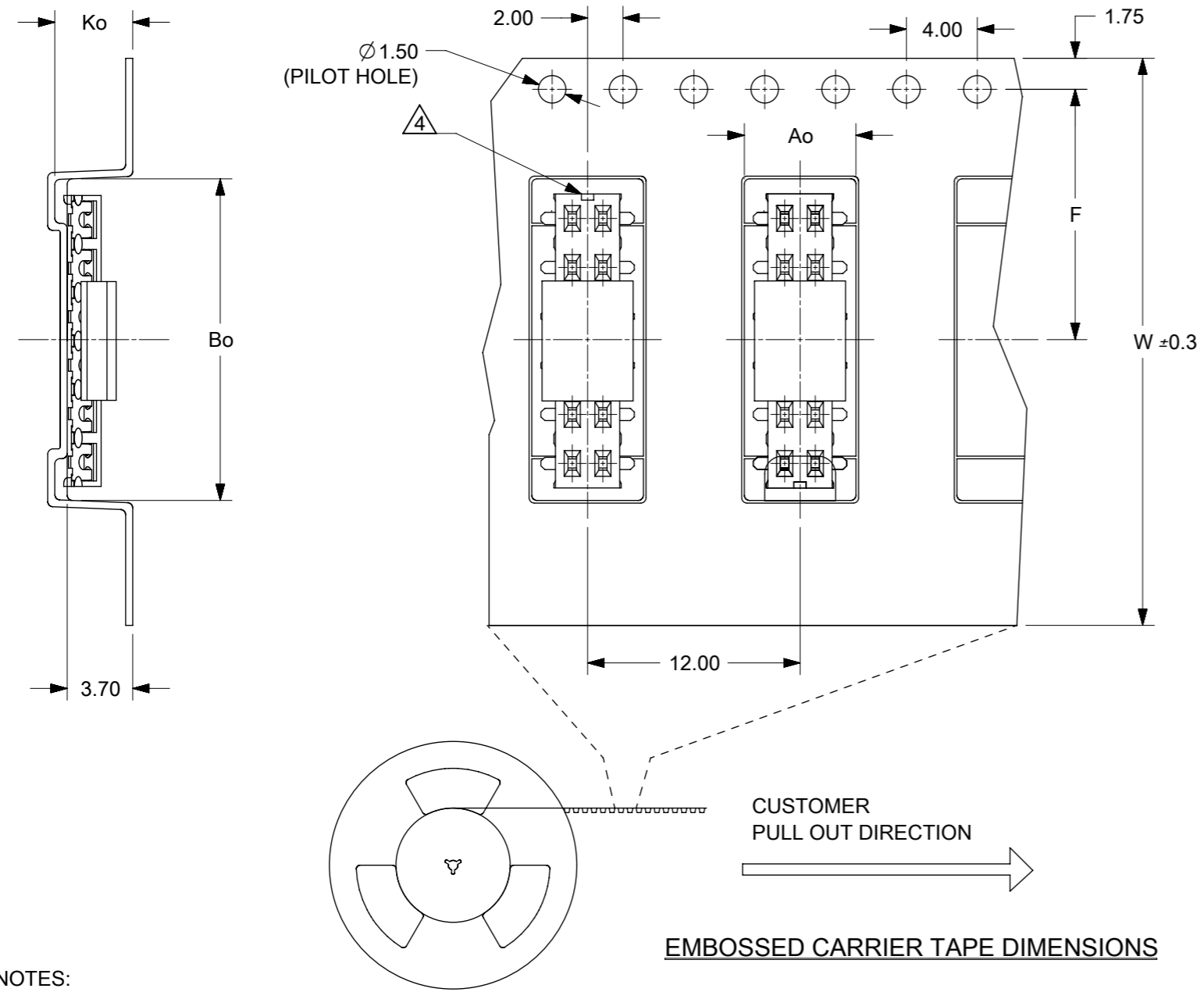

TAPE AND REEL ASSEMBLY SHOWN IS FOR ILLUSTRATION ONLY.

EMBOSSED CARRIER TAPE DIMENSIONS

NOTES:
1. LEADER AND TRAILER TAPE

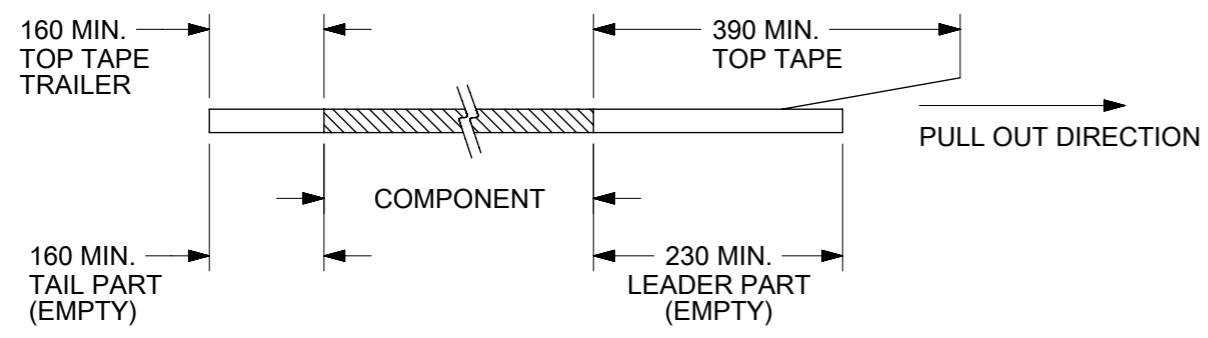

2. PEELING OFF FORCE OF THE TOP TAPE: 20-80gf.
(PEELING DIRECTION AS SHOWN IN FOLLOWING FIGURE)

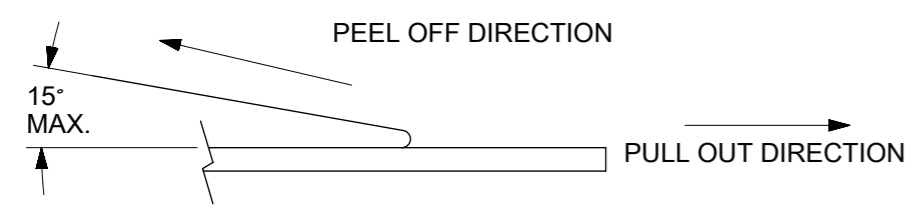

3. PACKAGING STANDARD IS AS PER EIA-481.
4. NO FIX ORIENTATION OF ASSEMBLY PART IN T&R.

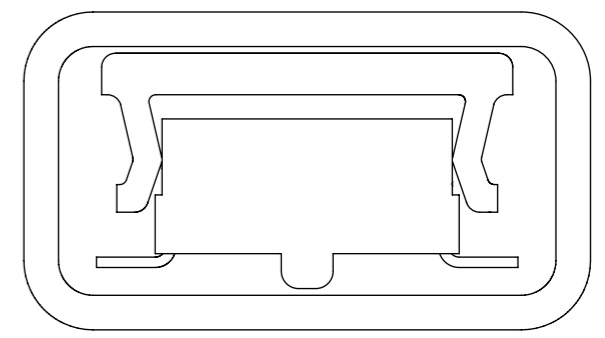

PART IN TUBE VIEW

THIS DRAWING CONTAINS INFORMATION THAT IS PROPRIETARY TO MOLEX ELECTRONIC TECHNOLOGIES, LLC AND SHOULD NOT BE USED WITHOUT WRITTEN PERMISSION											
DIMENSION UNITS		SCALE		CURRENT REV DESC: MIGRATED TO ECTR							
mm		NTS									
GENERAL TOLERANCES (UNLESS SPECIFIED)											
		MM	INCH	EC NO: 172635 DRWN: RMV02 2018/02/20 CHK'D: CD 2018/05/25 APPR: GGA 2018/05/30							
4 PLACES		±	±	PRODUCT CUSTOMER DRAWING DOCUMENT NUMBER: SD-87340-XX94 DOC TYPE: PSD DOC PART: 001 REVISION: D1							
3 PLACES		±	±								
2 PLACES		± 0.2	±	INITIAL REVISION: DRWN: DSOH 1997/06/19 APPR: SKTOH 1997/06/27							
1 PLACE		±	±								
0 PLACES		±	±	MATERIAL NUMBER: SEE TABLE CUSTOMER: GENERAL MARKET SHEET NUMBER: 2 OF 2							
ANGULAR TOL		± 3.0°									
DRAFT WHERE APPLICABLE MUST REMAIN WITHIN DIMENSIONS				THIRD ANGLE PROJECTION		DRAWING		SERIES		MATERIAL NUMBER	
						A3-SIZE		87340		SEE TABLE	