

THIS DOCUMENT IS SUBJECT TO CHANGE WITHOUT NOTICE. IT IS CONFIDENTIAL AND A PROPERTY OF Amphenol LTW. DISCLOSURE TO THIRD PARTY HAS TO BE AUTHORIZED BY Amphenol LTW.

| | | | | |
|------|---------|------|------|-------------|
| REV. | ECN NO. | DATE | SIGN | DESCRIPTION |
| | | | | |

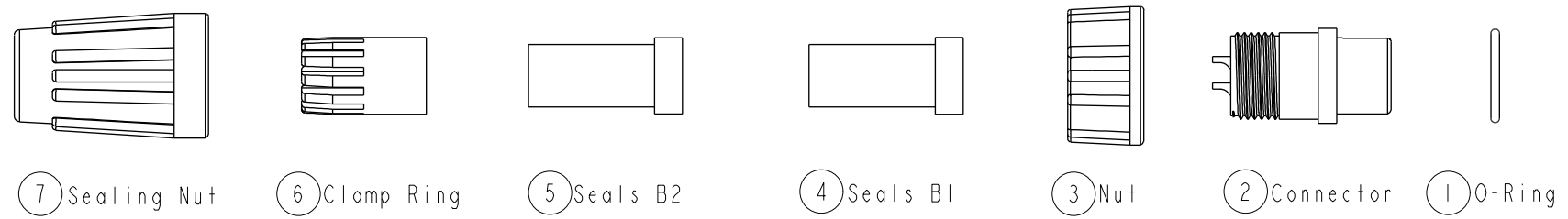

ALTW
 DCC. DEPT.
 CONFIDENTIAL
 2012-03-26
ISSUED

ALTW
 CONFIDENTIAL
 2012-03-19
 R&D DEPT.

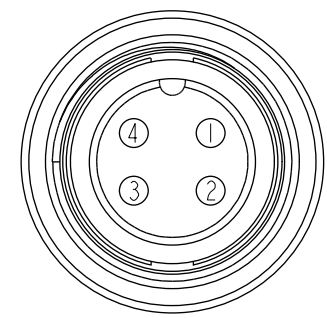
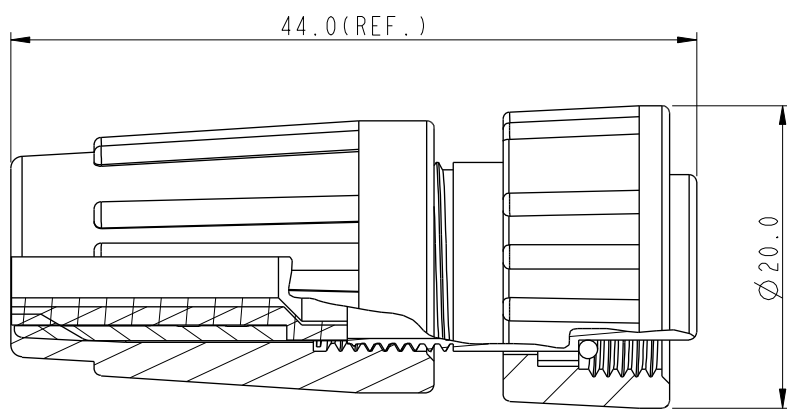

Pin Assignments
Front View 前視圖

- Note:
- * Seals B1 for Cable OD: $\varnothing 4.5\text{mm} \sim \varnothing 6.5\text{mm}$
(防水墊圈B1線徑: $\varnothing 4.5\text{mm} \sim \varnothing 6.5\text{mm}$)
 - * Seals B2 for Cable OD: $\varnothing 3.5\text{mm} \sim \varnothing 5.3\text{mm}$
(防水墊圈B2線徑: $\varnothing 3.5\text{mm} \sim \varnothing 5.3\text{mm}$)
 - * One Set Unassembled in One PE Bag
(每一組未組裝, 放置於一個PE袋, 並封口)
 - * CC Important Dimension.
 - * Waterproof Rate : IP66
 - * Ring: Black, EPDM
 - * Housing: Black, Nylon+GF
 - * Pin: Copper Alloy, Gold Plated
 - * Screw Nut: Black, Nylon+GF
 - * Seals: Black, EPDM
 - * Clamping Ring: Black, Nylon
 - * Sealing Nut: Black, Nylon
 - * PE Bag: 90mm*85mm

| | | | | | | | |
|-----------|---|--|--------------------------------------|-------------------------------|------------------|-------------|------------|
| UNIT: mm | | TITLE | Amphenol LTW 安費諾亮泰企業股份有限公司 | | ITEM NO. | DRAWN BY | DATE |
| | | Standard, Assy Screw 4Pin F Conn F Pin | | | BD-04BFFA-SL6001 | SamChang | 2012-03-19 |
| TOLERANCE | .X ± 0.25 .XX ± 0.1 .XXX ± 0.05 ANGLES $\pm 1^\circ$ | SCALE | SIZE | SHEET | OF | CHECKED BY | DATE |
| | | 1:1 | A4 | 1 | 1 | Jeffrey | 2012-03-26 |
| | | REV. A | WC-REV. A.2 | CC : Inspection item | | APPROVED BY | DATE |
| | | | | | ALTW | Kevin | 2012-03-26 |