

## MPCG1040LR56

Aliases (UPIB1040LR5600)

Not for New Design

KEMET, MPCG, Power, 0.56 uH, 20%, 4539

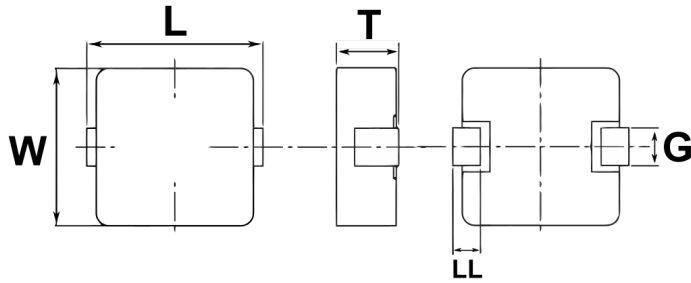

Click [here](#) for the 3D model.

### Dimensions

L	11.5mm MAX
W	10mm +/-0.3mm
T	4mm MAX
LL	2.1mm NOM
G	3.5mm +/-0.5mm

### Packaging Specifications

Packaging	T&R, 330mm
Packaging Quantity	500

### General Information

Series	MPCG
Style	SMD
Chip Size	4539
Description	Shielded, Surface Mount Inductor
Features	High Speed, Large Current DC/DC Converter
RoHS	Yes
Core	Composite

### Specifications

Inductance	0.56 uH
Inductance Tolerance	20%
Temperature Range	-40/+125°C
Rated Temperature	120°C
Shielded	Yes
Current	23 Amps (Isat, 20% Drop In Inductance), 23 Amps (Irms, 40C Rise By Self Heating)
DC Resistance	1.3 mOhms