

REV.	ECN NO.	DESCRIPTION	SIGN	DATE
C1	N/A	INITIAL DRAWING	Hary	2020/05/16

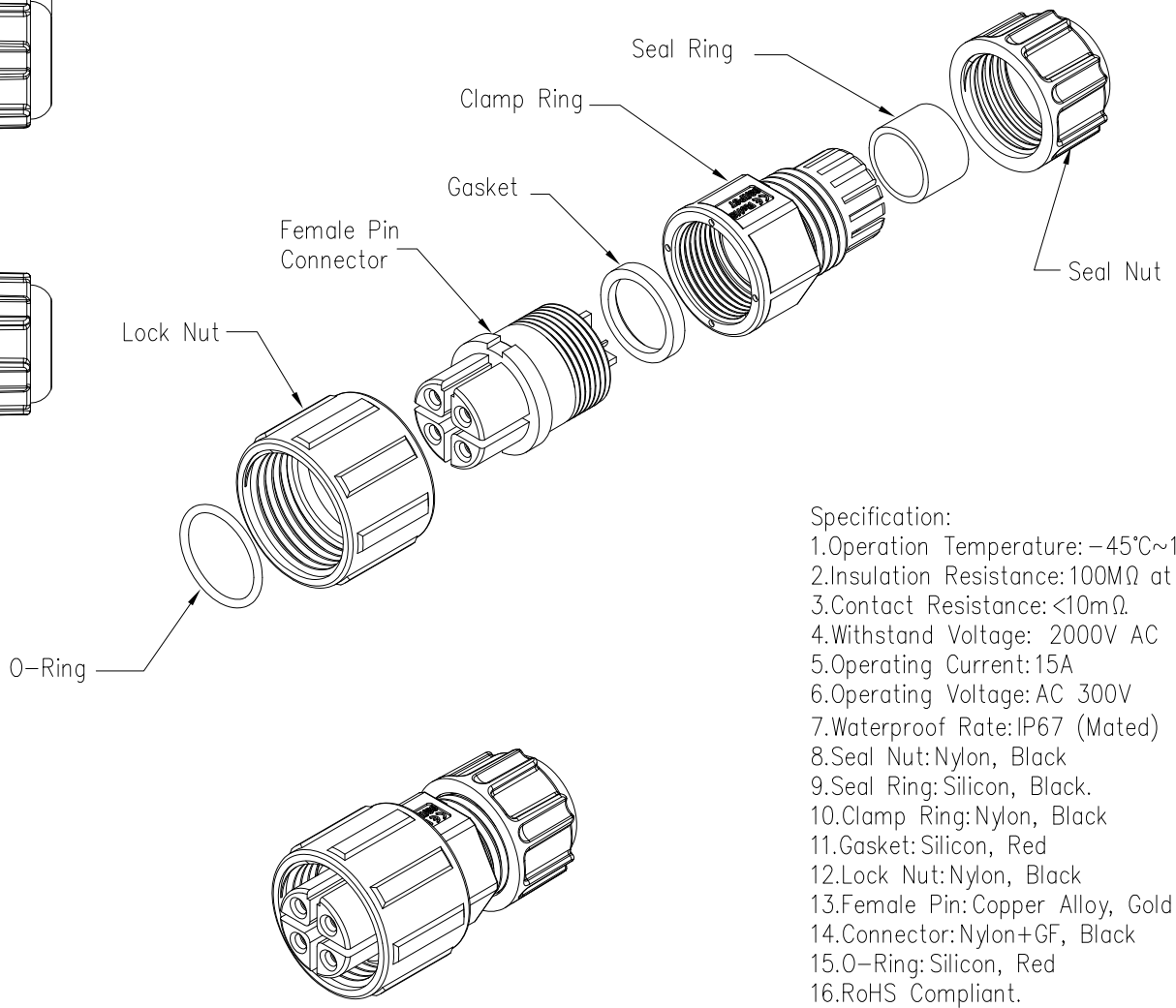

23XXX211-XX Cable Range OD  
 01 OD: φ3.5mm~φ6.5mm  
 02 OD: φ6.5mm~φ9.5mm  
 Pin Number

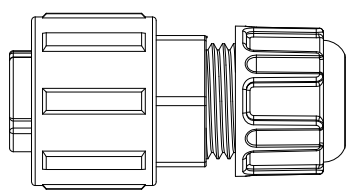
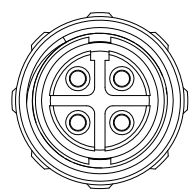
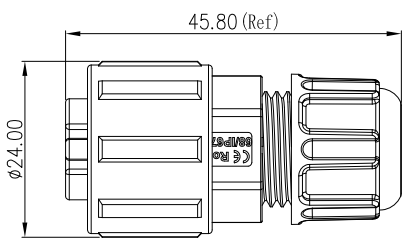
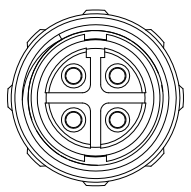

4 Pin

P/N: 23004211-XX

Pin Assignments  
Front View

- Specification:
- 1.Operation Temperature: -45°C~105°C.
  - 2.Insulation Resistance:100MΩ at DC500V.
  - 3.Contact Resistance:<10mΩ
  - 4.Withstand Voltage: 2000V AC
  - 5.Operating Current:15A
  - 6.Operating Voltage:AC 300V
  - 7.Waterproof Rate:IP67 (Mated)
  - 8.Seal Nut:Nylon, Black
  - 9.Seal Ring:Silicon, Black.
  - 10.Clamp Ring:Nylon, Black
  - 11.Gasket:Silicon, Red
  - 12.Lock Nut:Nylon, Black
  - 13.Female Pin:Copper Alloy, Gold Plated
  - 14.Connector:Nylon+GF, Black
  - 15.O-Ring:Silicon, Red
  - 16.RoHS Compliant.
  - 17.UL Compliant.
  - 18.Mating Cap:806-00026-01

UNIT:mm	
TOLERANCE	
.X	±0.25
.XX	±0.15
.XXX	±0.05
ANGLES	±1°

DESCRIPTION	Middle Series Screw Male Plug With Female Pin		
SCALE:	1:1	SHEET	X OF X
REV.	C1	SIZE	A4
			* :Inspection Item



PART NO	23004211-XX	DRAWN BY	Hary	DATE	2020/05/16
DWG NO		CHECKED BY	Mo	DATE	2020/05/16
CUSTOMER		APPROVED BY	Panson	DATE	2020/05/16

THIS INFORMATION IS CONFIDENTIAL AND IS DISCLOSED TO YOU ON CONDITION THAT NO FURTHER DISCLOSURE IS MADE BY YOU TO OTHER THAN CHOGORI PERSONNEL WITHOUT AUTHORIZATION FROM CHOGORI CORP.