

A - A

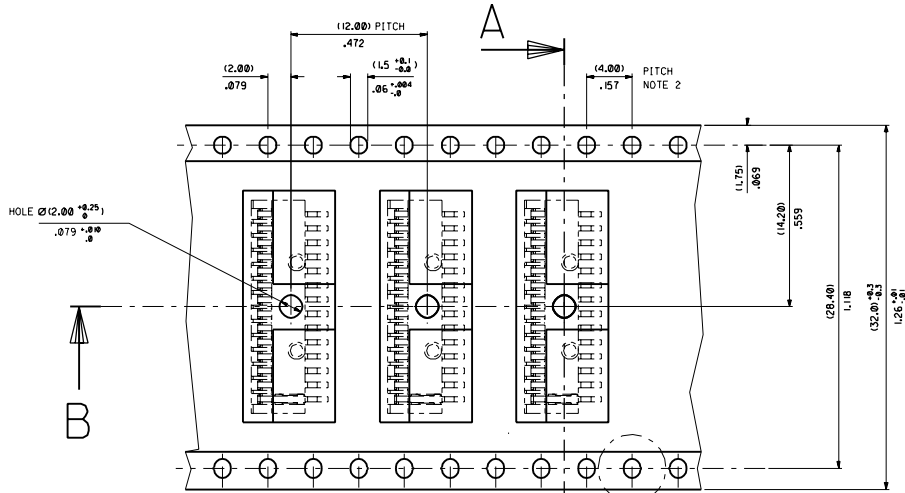

DIRECTION OF UNREELING →

REFERENCE ONLY

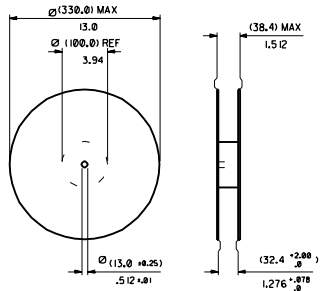

REEL DIMENSIONS

Do Not Scale

10000 PIECES PER REEL

1 FOUR REELS / CARDBOARD BOX (PCTN-38)

1 32000 PIECES PER CARDBOARD BOX

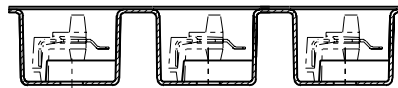
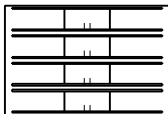

B - B

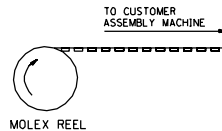

MOLEX REEL

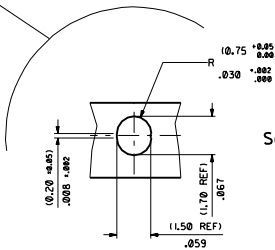

Scale 10:1

NOTES:

- 1) MATERIAL :
CARRIER TAPE : VOLUME CONDUCTIVE POLYCARBONATE , (0.34) .013 REF THICK , BLACK
COVER TAPE : COLD SEAL POLYESTER , (0.06) .002 REF THICK , TRANSPARENT
- 2) PITCH TOLERANCE OVER ANY 10 PITCHES ±(0.2) .000
- 3) PEEL FORCE OF THE COVER TAPE IS 0.1N TO 1.0N
AT A MAXIMUM PEEL SPEED OF (300) 11.81/min ±10%
- 4) PACKAGING SPEC. TBA
- 5) REFERENCE TO IEC 286-3

FOR PREVIOUS DRAWING ISSUES SEE MRL.

VARIOUS DIMS ECONOMIZER 95107-002	DESIGNER DAB	DATE 94/11/15
DESIGN A1	CHECKED DAB	DATE 94/11/15
SCALE 5:1	SCALE 5:1	SCALE 5:1

REVISE ONLY ON CAD SYSTEM		SCALE
DATE 94/11/15	DATE 94/11/15	SCALE 5:1
BLISTER PACKAGING FOR 95107-0002		
MOLEX EUROPE		
PART NO 95107-9002	REV NO 02	DATE 94/11/15
SDA-95107-9002 D		