

PART NUMBER	PLATING	RECOMMENDED WIRE SIZE	DIM 'A' HEIGHT	DIM 'B' WIDTH	RECOMMENDED CRIMP APPLICATOR	PACKAGE SIZE
173693-4634	30μ * GOLD STRIPE OVER 50μ * NICKEL OVERALL WITH 80-130μ * SELECT TIN	8 AWG (2) 12 AWG	7.42±0.5	5.84±0.5	63832-6300	1800 PARTS/ REEL
173693-4632		10-12 AWG (2) 14 AWG	5.97±0.5	5.33±0.5	63832-6000	2500 PARTS/ REEL
173693-4636		14-16 AWG (2) 16 AWG (2) 18 AWG	5.20±0.5	5.33±0.5	63832-6100	

- NOTES:
1. MATERIAL: COPPER ALLOY .032 IN THICK
 2. FINISH: PER MOLEX PLATING SPECIFICATION ES-88 - SEE CHART
 3. FOR CRIMP APPLICATOR SEE CHART
 4. FOR CRIMP TOOLING CONTACT MOLEX OR VISIT THE MOLEX WEBSITE AT: WWW.MOLEX.COM
 5. STANDARD PACKAGE SIZE: SEE CHART
 6. SEE PRODUCT SPECIFICATION: PS-173693-001 FOR MORE INFORMATION
 7. PARTS ARE RoHS COMPLIANT
 8. FOR MATING CONTACT: SEE CHART
 9. FOR CRIMP SET UP INFORMATION SEE MOLEX APPLICATION SPECIFICATION DOCUMENT:
- 8 AWG - ATS-638326300
10/12 AWG - ATS-638326000
14/16 AWG - ATS-638326100

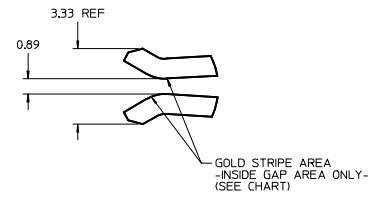

DETAIL 1
SCALE 10:1

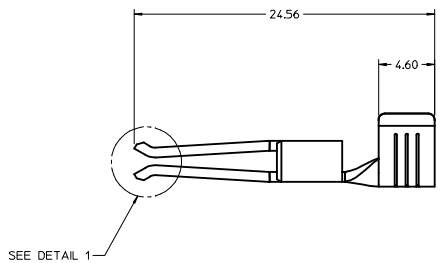
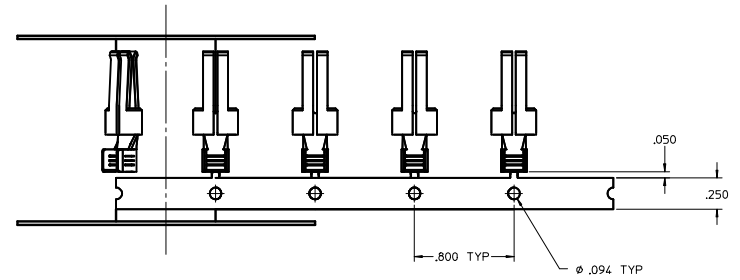
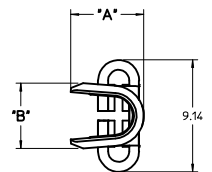
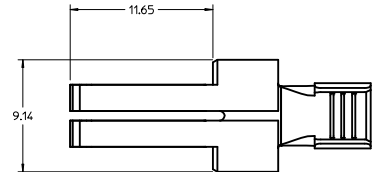
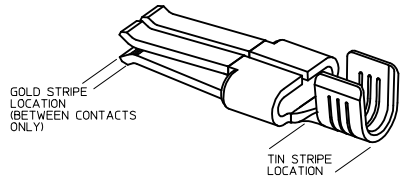
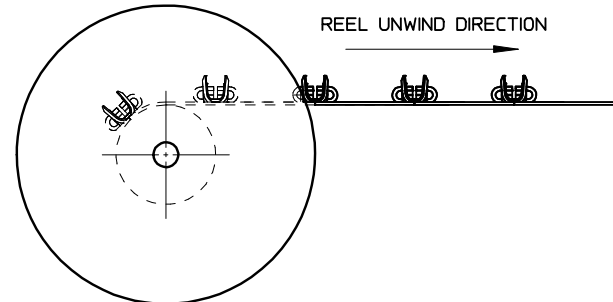

PRELIMINARY IEC NO. UCF2016-4071 DRAWN BY JSCHAFFER 2016/04/15 CHKD BY PI SZCZOR APPR: BPI SZCZOR 2016/10/03	QUALITY SYMBOLS	GENERAL TOLERANCES (UNLESS SPECIFIED)	DIMENSION STYLE	SCALE	DESIGN UNITS	THIRD ANGLE PROJECTION
	▽=0	4 PLACES ± --- INCH	MM ONLY	5:1	METRIC	☉
	▽=0	3 PLACES ± ---				
	▽=0	2 PLACES ± 0.13				
		1 PLACE ± 0.25				
		0 PLACE ± ---				
		ANGULAR ±1/2°				
		DRAFT WHERE APPLICABLE MUST REMAIN WITHIN DIMENSIONS				
			MATERIAL NO.	DOCUMENT NO.		
			SEE CHART	SD-173693-001		
						SHEET NO. 1 OF 1

PART NUMBER	PLATING	RECOMMENDED WIRE SIZE	DIM "A" HEIGHT	DIM "B" WIDTH	RECOMMENDED CRIMP APPLICATOR	PACKAGE SIZE
44262-4634	30μ * GOLD STRIPE OVER 50μ * NICKEL OVERALL WITH 80-130μ * SELECT TIN	8 AWG (2) 12 AWG	7.42±0.5	5.84±0.5	63832-6300	1800 PARTS/ REEL
44262-4632		10-12 AWG (2) 14 AWG	5.97±0.5	5.33±0.5	63832-6000	2500 PARTS/ REEL
44262-4636		14-16 AWG (2) 16 AWG (2) 18 AWG	5.20±0.5	5.33±0.5	63832-6100	

- NOTES:
1. MATERIAL: COPPER ALLOY .032 IN THICK
 2. FINISH: PER MOLEX PLATING SPECIFICATION ES-88 - SEE CHART
 3. FOR CRIMP APPLICATOR SEE CHART
 4. FOR CRIMP TOOLING CONTACT MOLEX OR VISIT THE MOLEX WEBSITE AT: WWW.MOLEX.COM
 5. STANDARD PACKAGE SIZE: SEE CHART
 6. SEE PRODUCT SPECIFICATION: PS-44262-001 FOR MORE INFORMATION
 7. PARTS ARE RoHS COMPLIANT
 8. FOR MATING CONTACT: SEE CHART
 9. FOR CRIMP SET UP INFORMATION SEE MOLEX APPLICATION SPECIFICATION DOCUMENT:
- 8 AWG - ATS-638326300
 10/12 AWG - ATS-638326000
 14/16 AWG - ATS-638326100

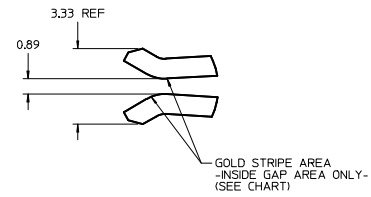
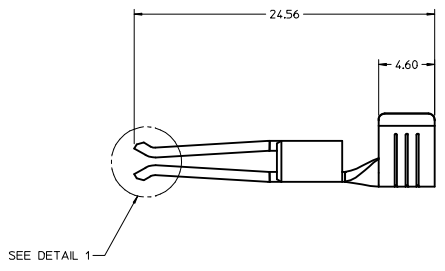
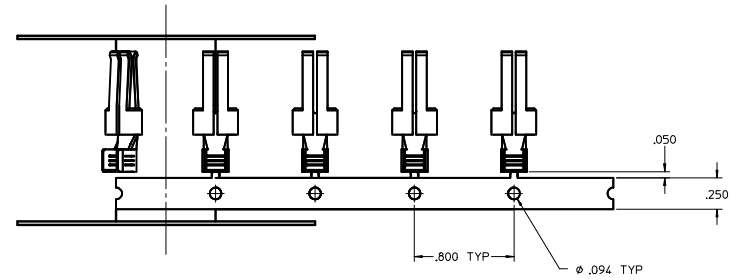
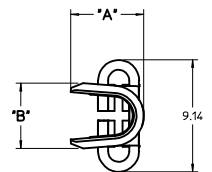
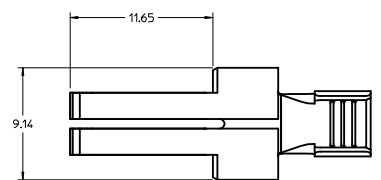
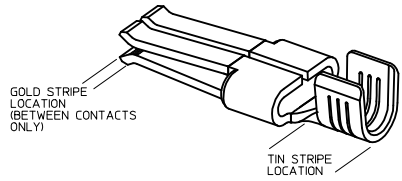

DETAIL 1
SCALE 10:1

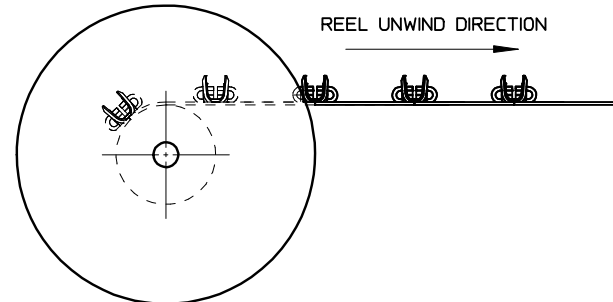

RELEASED IEC NO. UCF2015-4855 DRAWN BY JOUILLES 2015/05/19 CHKD BY BPSZCZOR 2015/05/21 APPR: APATEL 2015/06/11	QUALITY SYMBOLS ∇=0 ∇=0 ∇=0	GENERAL TOLERANCES (UNLESS SPECIFIED)		DIMENSION STYLE MM ONLY	SCALE 5:1	DESIGN UNITS METRIC	THIRD ANGLE PROJECTION
		4 PLACES ± .--- ± .--- 3 PLACES ± .--- ± .--- 2 PLACES ± 0.13 ± .--- 1 PLACE ± 0.25 ± .--- 0 PLACE ± .--- ± .---	mm INCH ± .--- ± .--- ± .--- ± .--- ± .--- ± .--- ± .--- ± .---	DRAWN BY JOUILLES 2015/05/19 CHECKED BY BPSZCZOR 2015/05/21 APPROVED BY APATEL 2015/06/11	DATE DATE DATE	MATERIAL NO. SEE CHART	DOCUMENT NO. SD-44262-2000

TITLE: TERMINAL - RECEPTACLE POWER CONTACT TEN60 POWER FAMILY

molex