

IF IN DOUBT ALWAYS ASK

NEXT HIGHER ASSY

J1 - Mains Input - Input Module

Barrier Connector - 6-32 Steel Screws

J2 - Global Signal - Input Module

Housing:

- Molex - Part # 0511101260
- 2.00mm (0.079"), 12Way Housing with Friction Lock
- or any direct equivalent

Terminal

- Molex - Part # 0503948051
- Crimp terminal, 24-30 AWG
- or any direct equivalent

J3/J4 - Output Power Terminal - Output Module

Terminal

- Various - Tab Size 0.80mm x 6.35mm
- Crimp Terminal Must have current rating higher than short circuit of output module e.g.
- $I_{sc} OP 1 = 25Amp * 1.25 = 31.25Amp$
- Always use appropriate wire size, See instruction Manual

J5 - Output Signal - Output Module

Housing

- Molex - Part # 01510210600
- 1.25 (0.049"), 6Way Housing
- or any direct equivalent

Terminal

- Molex - Part # 050058800
- Crimp Terminal, 28-32 AWG
- or any direct equivalent

J6 - Input Bias - Input Module

Housing

- Molex - Part # - 01510210500
- 1.25mm (0.049"), 5 Way housing
- or any direct equivalent

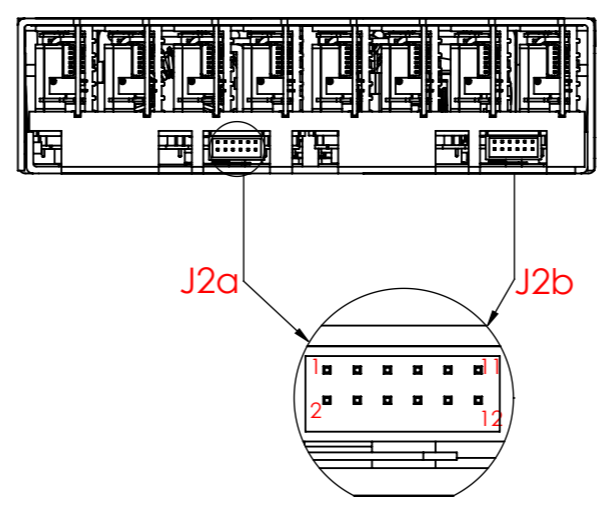

J2 - Global Signal

Pin	Signal
1	Module Power Good Slot A/E
2	Module Inhibit Slot A/E
3	Module Power Good Slot B/F
4	Module Inhibit Slot B/F
5	Module Power Good Slot C/G
6	Module Inhibit Slot C/G
7	Module Power Good Slot D/H
8	Module Inhibit Slot D/H
9	Global Inhibit Slots A-D/E-H
10	AC OK
11	Global Bias Supply +5V
12	GND

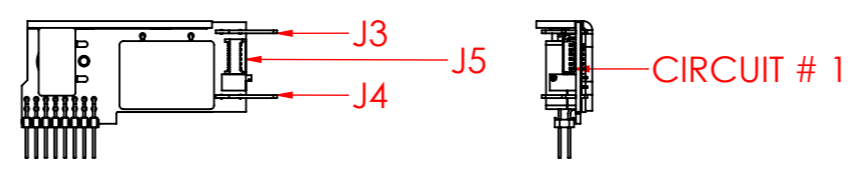

J5 - Global Signal

Pin	Signal
1	+ Sense
2	- Sense
3	Voltage Control
4	Current Out/ Current Control / Current Share
5	GND
6	Module Bias Supply +5V

J5 - Global Signal

Pin	Signal
1	Common
2	+ 5V Bias
3	Shut Down
4	Reserved
5	Reserved
6	Reserved

REV.	SIGNED	DATE	ECD#
02	RB	23-11-2020	NA
01	MP	22-10-2012	NA

UNLESS OTHERWISE SPECIFIED DIMENSIONS ARE IN MILLIMETERS

FINISH: NA

PART NUMBER: NA

MATERIAL: NA

TOLERANCES: As Per DIN 2768-1/-2CLASS M

TITLE: NEVO+1200 - 2D MECHANICAL DRAWING

DWG NO. DOC-DWG-005

Sheet 1 of 2 Not to Scale Scale 1:2

This document and its contents are the copyright property of VOX POWER Ltd. and may not be copied in whole or in part without written permission from VOX POWER Ltd.



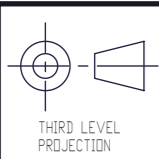

IF IN DOUBT ALWAYS ASK

NEXT HIGHER ASSY

SCREWS

MH1, MH2, MH3, MH4

Screw type -M4
 Tightening - Tighten to 0.55Nm torque
 Penetration Depth -M4

OUTPUT MODULES

Screw type - M3 x 5, C/sink, Posi, Stainless Steel
 Tightening - Tighten to 0.35Nm torque
 Penetration Depth - Defined by Screw

CHASSIS x 11

Screw type - M3 x 5, C/sink, Posi, Stainless Steel
 Tightening - Tighten to 0.35Nm torque
 Penetration Depth - Defined by Screw

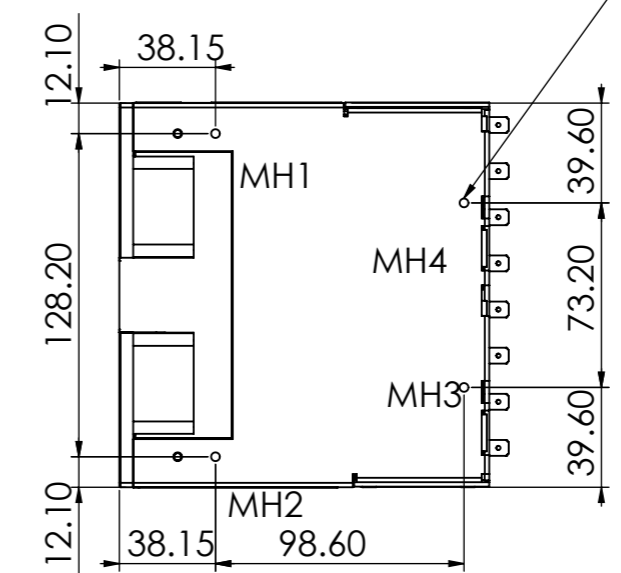
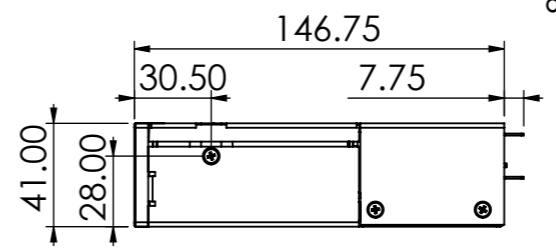
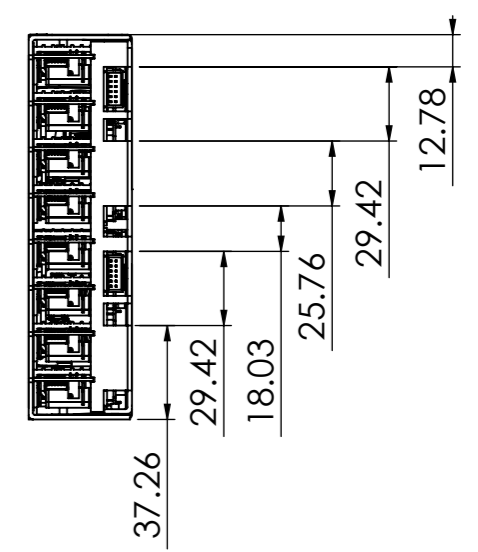
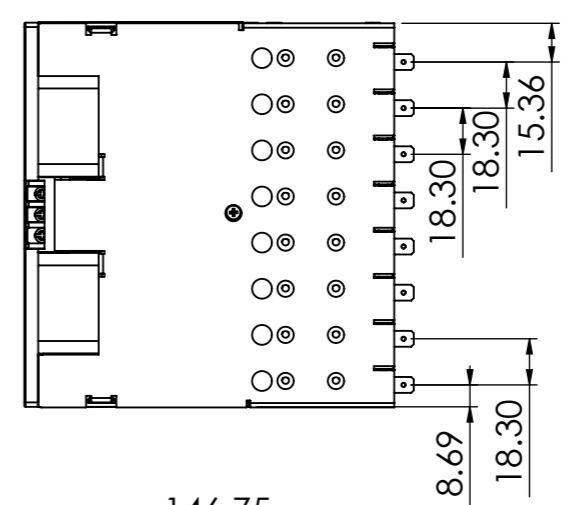
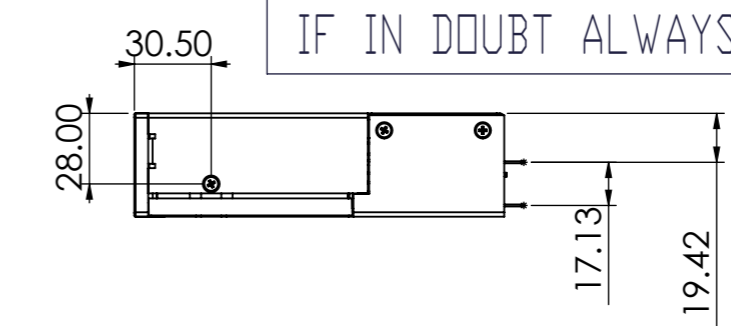
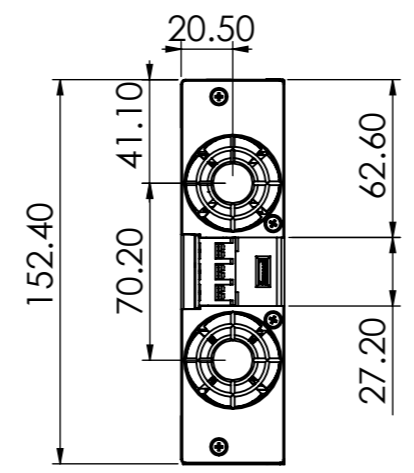

TOLERANCES unless otherwise stated - All dimensions in mm and according to DIN 2768-1/-2 CLASS C

REV.	SIGNED	DATE	ECD#
02	RB	23-11-2020	NA
01	MP	22-10-2012	NA

UNLESS OTHERWISE SPECIFIED DIMENSIONS ARE IN MILLIMETERS TOLERANCES: As Per DIN 2768-1/-2CLASS M	FINISH: NA	PART NUMBER: NA	TITLE: NEVO+1200 - 2D MECHANICAL DRAWING
		MATERIAL: NA	DWG NO. DOC-DWG-005
This document and its contents are the copyright property of VOX POWER Ltd. and may not be copied in whole or in part without written permission from VOX POWER Ltd.		Sheet 2 of 2	Not to Scale Scale 1:2

