

NOTES:

- MATERIALS**  
 HOUSING - HIGH TEMP. NYLON, GLASS-FILLED, UL 94V-0.  
 LATCH - HIGH TEMP. NYLON, GLASS-FILLED, UL 94V-0 - NATURAL  
 POLYSULFONE, UL 94HB - CLEAR  
 (COLOUR OF THE HOUSING AND LATCHES REFER TO TABLE ON SHEET 5 & 6).  
 TERMINAL - PHOSPHOR BRONZE
- FINISHES - CONTACT AREA - SEE TABLE IN SHEET 5.**  
 TAIL AREA - 15uIN(0.38uM) TO 60uIN(1.52uM) MIN.  
 TIN OVER 50uIN(1.27uM) MIN. NICKEL.
- REFER TO PRODUCT SPEC. PS-87746-002 FOR PERFORMANCE SPECIFICATIONS.
- PRODUCT SHALL BE PACKED IN TRAY.
- CARD SLOT ACCEPTS 1.27±0.10 MM MODULE THICKNESS. (MEASURED OVER P.C. PADS)
- RECOMMENDED MODULE LAYOUT SHALL BE AS PER JEDEC MO-237.
- RECOMMENDED PLATING ON MODULE PADS: 30uIN(0.76uM) MIN. HARD GOLD OVER 79uIN(2uM) MIN. NICKEL.
- DIMM MODULE SEATING PLANE FROM TOP OF PCB.
- PART NUMBER SHALL BE MARKED LEGIBLY AS : 87746 XXXX
- DATE CODE SHALL BE MARKED LEGIBLY AS SHOWN : YYDDD
- KEEP OUT CROSS HATCHED ARE RESERVED FOR SOCKET EJECTORS AT BOTH ENDS.
- KEEP OUT ZONE IS HEIGHT LIMITED PER 11.

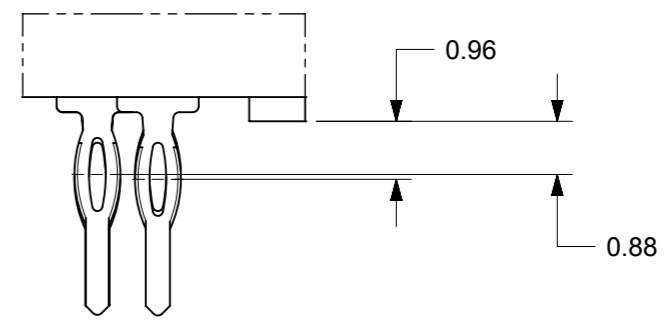

DETAIL A

|   |  |       |  |  |  |                        |  |                          |  |                          |  |
|---|--|-------|--|--|--|------------------------|--|--------------------------|--|--------------------------|--|
| THIS DRAWING CONTAINS INFORMATION THAT IS PROPRIETARY TO MOLEX ELECTRONIC TECHNOLOGIES, LLC AND SHOULD NOT BE USED WITHOUT WRITTEN PERMISSION |  |       |  |  |  |                        |  |                          |  |                          |  |
| DIMENSION UNITS   |  | SCALE |  | CURRENT REV DESC: OBSOLETE PART NUMBER AS PER PCN#508521 |  |                        |  |                          |  | <b>molex</b>             |  |
| mm  |  | NTS   |  |  |  |                        |  |                          |  |                          |  |
| GENERAL TOLERANCES (UNLESS SPECIFIED)   |  |       |  | EC NO: 667392  |  | 2021/04/23             |  | DDR2 DIMM, 1.00MM PITCH  |  | 240 CKTS, VERT. PRESSFIT |  |
|   |  |       |  | DRWN: ABHISP1  |  | 2021/07/05             |  |                          |  |                          |  |
|   |  |       |  | CHK'D: GGA   |  | 2021/07/05             |  |                          |  |                          |  |
|   |  |       |  | APPR: GGA  |  | 2021/07/05             |  |                          |  |                          |  |
|   |  |       |  | INITIAL REVISION:  |  |                        |  | PRODUCT CUSTOMER DRAWING |  |                          |  |
|   |  |       |  | DRWN: C GOH  |  | 2002/06/13             |  | DOCUMENT NUMBER          |  | SD-87746-001             |  |
|   |  |       |  | APPR: SKTOH  |  | 2002/08/08             |  | DOC TYPE                 |  | PSD                      |  |
|   |  |       |  | ANGULAR TOL ± 5.0°                                       |  |                        |  | DOC PART                 |  | 001                      |  |
|   |  |       |  | DRAFT WHERE APPLICABLE MUST REMAIN WITHIN DIMENSIONS     |  | THIRD ANGLE PROJECTION |  | REVISION                 |  | F                        |  |
|   |  |       |  |  |  | DRAWING                |  | SERIES                   |  | 87746                    |  |
|   |  |       |  |  |  | A3-SIZE                |  | MATERIAL NUMBER          |  | SEE TABLE                |  |
|   |  |       |  |  |  | CUSTOMER               |  | GENERAL MARKET           |  | SHEET NUMBER             |  |
|   |  |       |  |  |  |                        |  |                          |  | 1 OF 5                   |  |

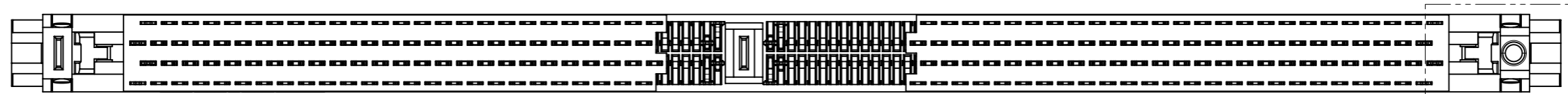

DETAIL B

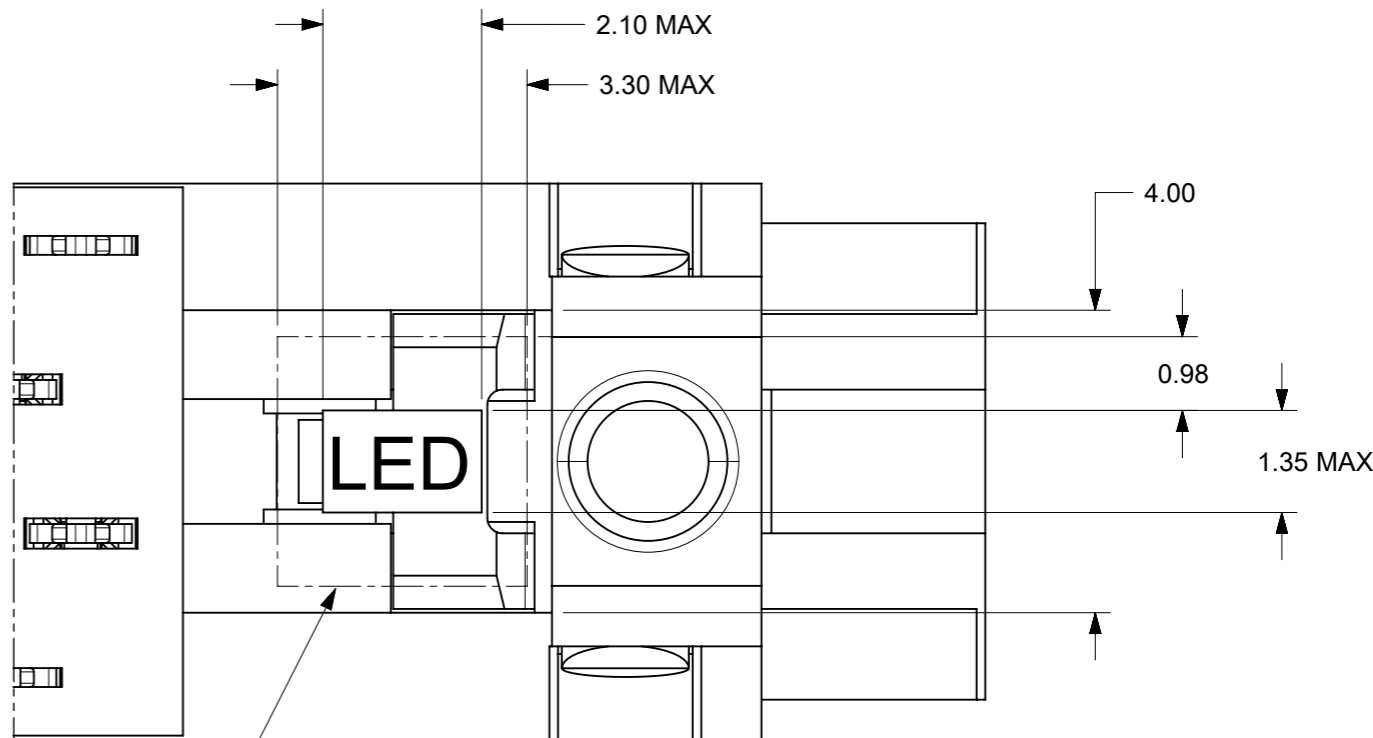

LED PLACEMENT AREA

DETAIL B

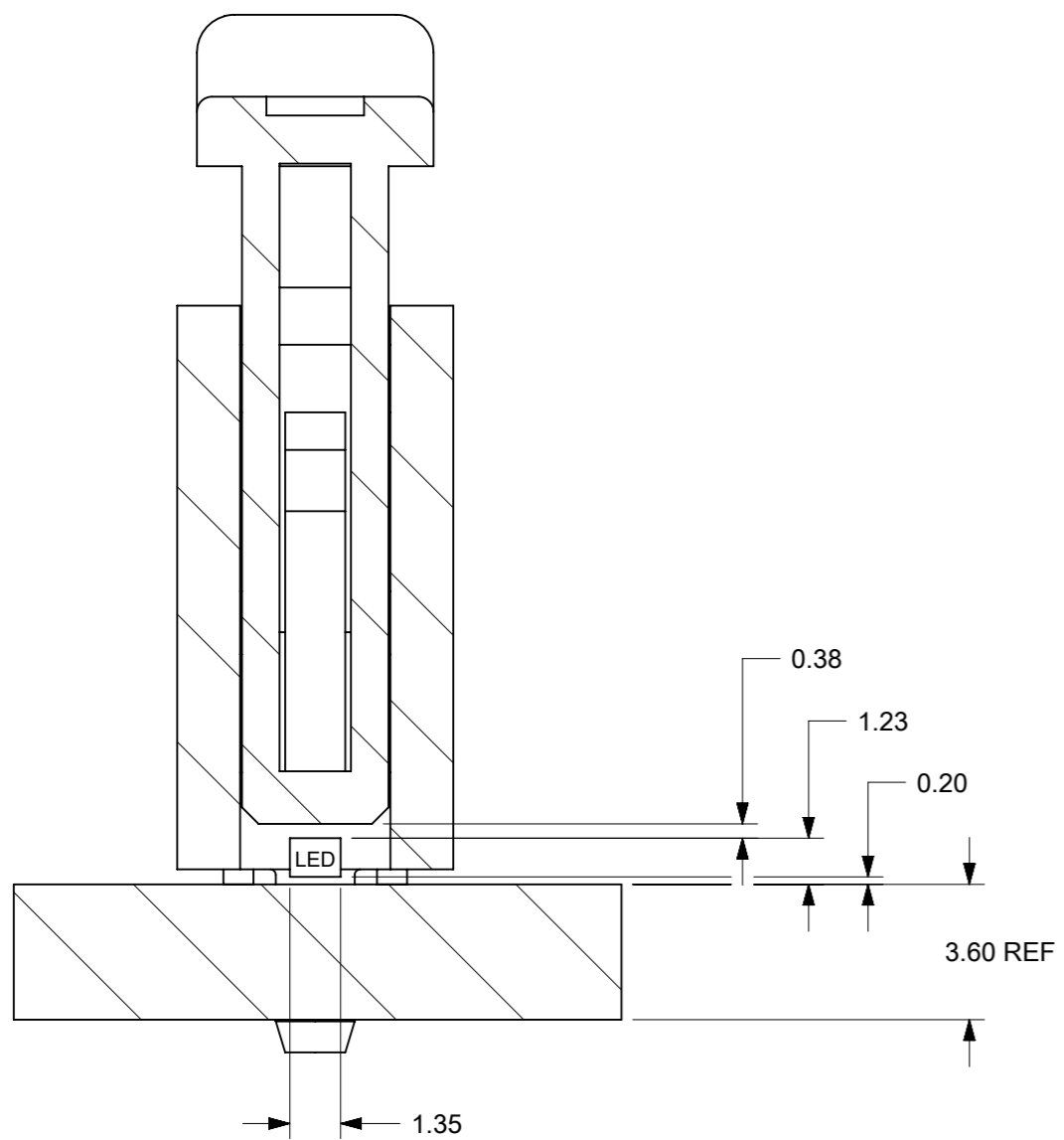

SECTION X-X

|   |  |       |  |  |  |                 |  |                          |  |
|---|--|-------|--|--|--|-----------------|--|--------------------------|--|
| THIS DRAWING CONTAINS INFORMATION THAT IS PROPRIETARY TO MOLEX ELECTRONIC TECHNOLOGIES, LLC AND SHOULD NOT BE USED WITHOUT WRITTEN PERMISSION |  |       |  |  |  |                 |  |                          |  |
| DIMENSION UNITS   |  | SCALE |  | CURRENT REV DESC: OBSOLETE PART NUMBER AS PER PCN#508521 |  |                 |  | <b>molex</b>             |  |
| mm  |  | NTS   |  |  |  |                 |  |                          |  |
| GENERAL TOLERANCES (UNLESS SPECIFIED)   |  |       |  | EC NO: 667392  |  | 2021/04/23      |  | DDR2 DIMM, 1.00MM PITCH  |  |
|   |  |       |  | DRWN: ABHISP1  |  | 2021/07/05      |  | 240 CKTS, VERT. PRESSFIT |  |
|   |  |       |  | CHK'D: GGA   |  | 2021/07/05      |  | PRODUCT CUSTOMER DRAWING |  |
|   |  |       |  | APPR: GGA  |  | 2021/07/05      |  |                          |  |
|   |  |       |  | INITIAL REVISION:  |  |                 |  |                          |  |
| 4 PLACES ±  |  |       |  | DRWN: C GOH  |  | 2002/06/13      |  | DOCUMENT NUMBER          |  |
| 3 PLACES ±  |  |       |  | APPR: SKTOH  |  | 2002/08/08      |  | SD-87746-001             |  |
| 2 PLACES ± 0.2  |  |       |  |  |  |                 |  | DOC TYPE                 |  |
| 1 PLACE ±   |  |       |  |  |  |                 |  | PSD                      |  |
| 0 PLACES ±  |  |       |  |  |  |                 |  | DOC PART                 |  |
| ANGULAR TOL ± 5.0°  |  |       |  |  |  |                 |  | 001                      |  |
| DRAFT WHERE APPLICABLE MUST REMAIN WITHIN DIMENSIONS  |  |       |  | THIRD ANGLE PROJECTION                                   |  | DRAWING         |  | REVISION                 |  |
|   |  |       |  | A3-SIZE  |  | SERIES          |  | F                        |  |
|   |  |       |  | 87746  |  | MATERIAL NUMBER |  | SHEET NUMBER             |  |
|   |  |       |  | SEE TABLE  |  | CUSTOMER        |  | 2 OF 5                   |  |
|   |  |       |  | GENERAL MARKET   |  |                 |  |                          |  |

|                 |    |              |            |          |
|-----------------|----|--------------|------------|----------|
| DOCUMENT STATUS | P1 | RELEASE DATE | 2021/07/05 | 08:39:54 |
|-----------------|----|--------------|------------|----------|



RECOMMENDED PCB HOLE PATTERN  
 SEE TABLE IN SHEET 5 FOR  
 RECOMMENDED PCB THICKNESS

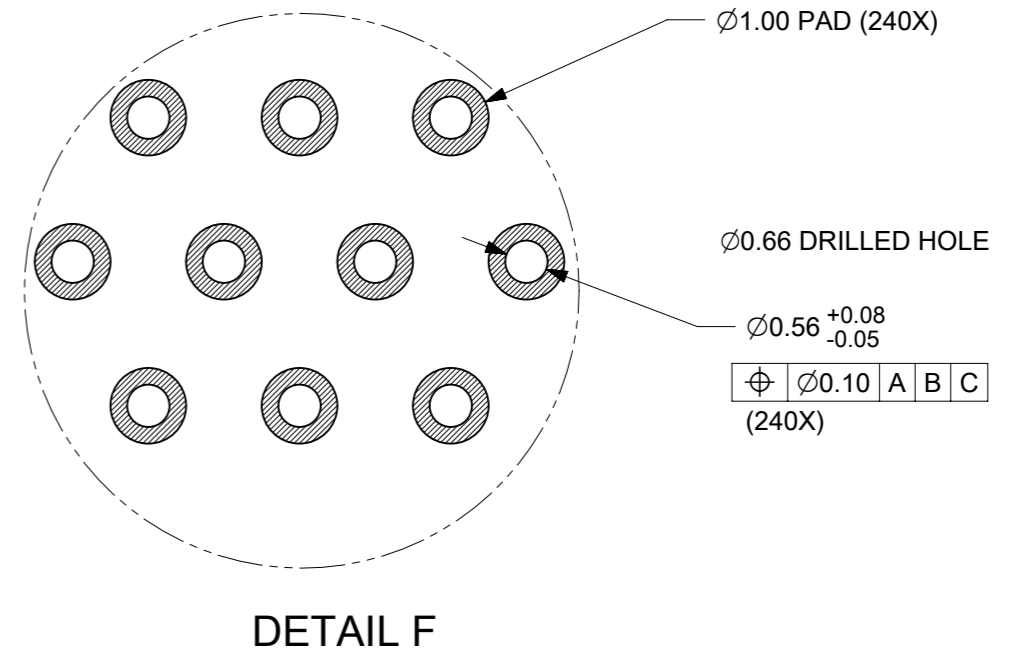
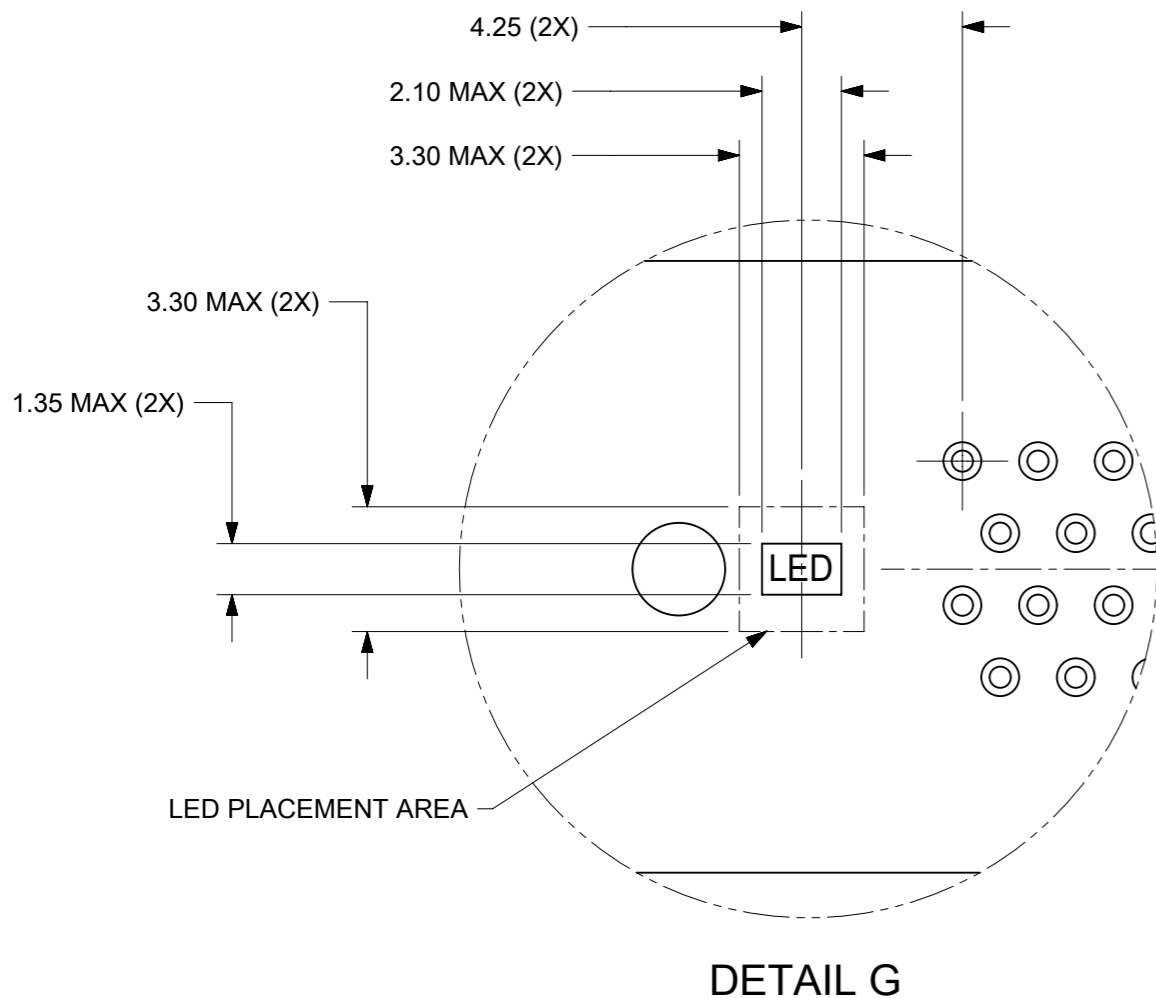
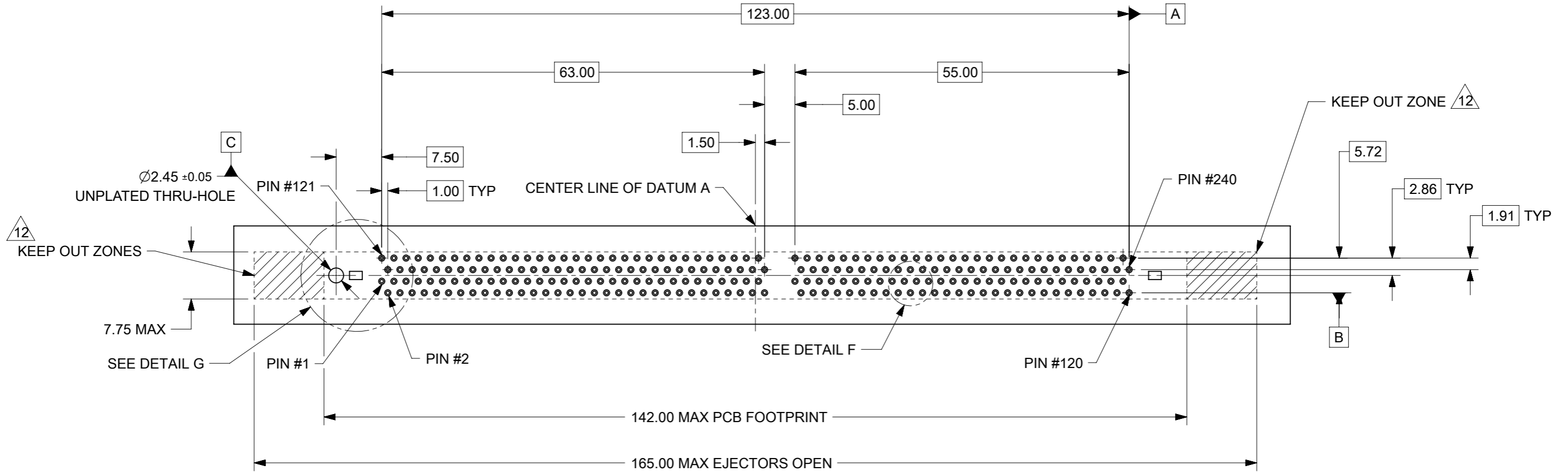

|   |  |       |  |  |  |                   |  |            |  |                          |  |
|---|--|-------|--|--|--|-------------------|--|------------|--|--------------------------|--|
| THIS DRAWING CONTAINS INFORMATION THAT IS PROPRIETARY TO MOLEX ELECTRONIC TECHNOLOGIES, LLC AND SHOULD NOT BE USED WITHOUT WRITTEN PERMISSION |  |       |  |  |  |                   |  |            |  |                          |  |
| DIMENSION UNITS   |  | SCALE |  | CURRENT REV DESC: OBSOLETE PART NUMBER AS PER PCN#508521 |  |                   |  |            |  |                          |  |
| mm  |  | NTS   |  |  |  |                   |  |            |  |                          |  |
| GENERAL TOLERANCES (UNLESS SPECIFIED)   |  |       |  |  |  |                   |  |            |  |                          |  |
|   |  | MM    |  | INCH   |  | EC NO: 667392     |  | 2021/04/23 |  | DOC TYPE                 |  |
| 4 PLACES  |  | ±     |  | ±  |  | DRWN: ABHISP1     |  | 2021/07/05 |  | DOC PART                 |  |
| 3 PLACES  |  | ±     |  | ±  |  | CHK'D: GGA        |  | 2021/07/05 |  | REVISION                 |  |
| 2 PLACES  |  | ±     |  | 0.2  |  | APPR: GGA         |  | 2021/07/05 |  | PRODUCT CUSTOMER DRAWING |  |
| 1 PLACE   |  | ±     |  | ±  |  | INITIAL REVISION: |  |            |  | DOCUMENT NUMBER          |  |
| 0 PLACES  |  | ±     |  | ±  |  | DRWN: C GOH       |  | 2002/06/13 |  | SD-87746-001             |  |
|   |  |       |  |  |  | APPR: SKTOH       |  | 2002/08/08 |  | PSD 001 F                |  |
| DRAFT WHERE APPLICABLE MUST REMAIN WITHIN DIMENSIONS  |  |       |  | THIRD ANGLE PROJECTION                                   |  | DRAWING           |  | SERIES     |  | MATERIAL NUMBER          |  |
|   |  |       |  |  |  | A3-SIZE           |  | 87746      |  | CUSTOMER                 |  |
|   |  |       |  |  |  |                   |  | SEE TABLE  |  | GENERAL MARKET           |  |
|   |  |       |  |  |  |                   |  |            |  | SHEET NUMBER             |  |
|   |  |       |  |  |  |                   |  |            |  | 4 OF 5                   |  |

| PART NO.   | VOLTAGE KEY POS. | VOLTAGE KEY TEXT | TAIL LENGTH P±0.20 | RECOMMENDED PCB THICKNESS | LUBRICATION | PLATING OPTION  | LATCH COLOR            | HOUSING COLOR |
|------------|------------------|------------------|--------------------|---------------------------|-------------|---|------------------------|---------------|
| 87746-8001 | CENTER           | 1.8V             | 4.20               | 4.57                      | NO          | SELECTIVE GOLD<br>0.38uM/ 15uIN MIN. GOLD<br>OVER 1.27uM/ 50uIN MIN. NICKEL | NATURAL<br>(OFF WHITE) | BLACK         |
| 87746-8091 | CENTER           | 1.8V             | 4.20               | 4.57                      | YES         | SELECTIVE GOLD<br>0.76uM/ 30uIN MIN. GOLD<br>OVER 1.27uM/ 50uIN MIN. NICKEL |                        |               |
| 87746-9091 |                  |                  | 3.30               | 3.60                      |             |   |                        |               |
| 87746-5201 | CENTER           | 1.8V             | 4.20               | 4.57                      | NO          | SELECTIVE GOLD<br>0.38uM/ 15uIN MIN. GOLD<br>OVER 1.27uM/ 50uIN MIN. NICKEL |                        |               |
| 87746-5301 |                  |                  | 3.30               | 3.60                      |             |   |                        |               |
| 87746-5211 | CENTER           | 1.8V             | 4.20               | 4.57                      | NO          | SELECTIVE GOLD<br>0.76uM/ 30uIN MIN. GOLD<br>OVER 1.27uM/ 50uIN MIN. NICKEL | CLEAR                  |               |
| 87746-5291 | CENTER           | 1.8V             | 4.20               | 4.57                      | YES         |   |                        |               |

|   |  |       |  |  |  |                |  |   |  |
|---|--|-------|--|--|--|----------------|--|---|--|
| THIS DRAWING CONTAINS INFORMATION THAT IS PROPRIETARY TO MOLEX ELECTRONIC TECHNOLOGIES, LLC AND SHOULD NOT BE USED WITHOUT WRITTEN PERMISSION |  |       |  |  |  |                |  |   |  |
| DIMENSION UNITS   |  | SCALE |  | CURRENT REV DESC: OBSOLETE PART NUMBER AS PER PCN#508521 |  |                |  | <b>molex</b>  |  |
| mm  |  | NTS   |  |  |  |                |  |   |  |
| GENERAL TOLERANCES (UNLESS SPECIFIED)   |  |       |  | EC NO: 667392  |  | 2021/04/23     |  | DDR2 DIMM, 1.00MM PITCH<br>240 CKTS, VERT. PRESSFIT |  |
|   |  |       |  | DRWN: ABHISP1  |  | 2021/07/05     |  |   |  |
|   |  |       |  | CHK'D: GGA   |  | 2021/07/05     |  |   |  |
|   |  |       |  | APPR: GGA  |  | 2021/07/05     |  | PRODUCT CUSTOMER DRAWING                            |  |
|   |  |       |  | INITIAL REVISION:  |  |                |  | DOCUMENT NUMBER                                     |  |
|   |  |       |  | DRWN: C GOH  |  | 2002/06/13     |  | SD-87746-001  |  |
|   |  |       |  | APPR: SKTOH  |  | 2002/08/08     |  | PSD 001 F   |  |
| ANGULAR TOL ± 5.0°  |  |       |  | THIRD ANGLE PROJECTION                                   |  | DRAWING        |  | SERIES  |  |
| DRAFT WHERE APPLICABLE MUST REMAIN WITHIN DIMENSIONS  |  |       |  |  |  | A3-SIZE        |  | 87746   |  |
|   |  |       |  | MATERIAL NUMBER  |  | CUSTOMER       |  | SHEET NUMBER  |  |
|   |  |       |  | SEE TABLE  |  | GENERAL MARKET |  | 5 OF 5  |  |