

P	LTR	DESCRIPTION	DATE	DWN	APVD
	B1	REDRAWN PER ECR 09-016745	28JUL09	JR	TM
	B2	REVISED PER ECO-17-007400	27NOV2017	RS	DR

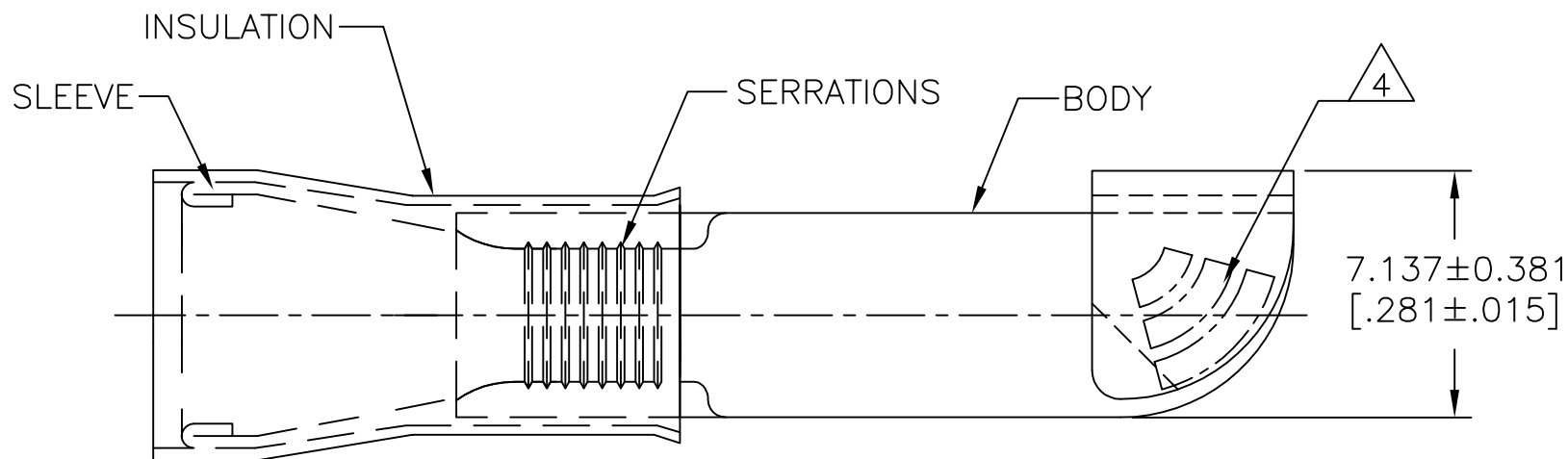

<b>AMP</b> WIRE RANGE	<b>RU</b> FILE E13288
12-10 AWG STRANDED	12-10 AWG STRANDED

- 1 WIRE INSUL  $\phi$ 3.810-5.842 [ $\phi$ .150-.230]
- 2 MATERIAL: BODY - CU PER ASTM B152  
SLEEVE - CU PER ASTM B152  
INSULATION - NYLON ASTM D4066 TYPE 1.
- 3 FINISH: BODY & SLEEVE: TIN PER ASTM B-545  
INSULATION - COLOR: YELLOW.
- 4 STAMP AMP 12-10\* 6-9 APPROX AS SHOWN.

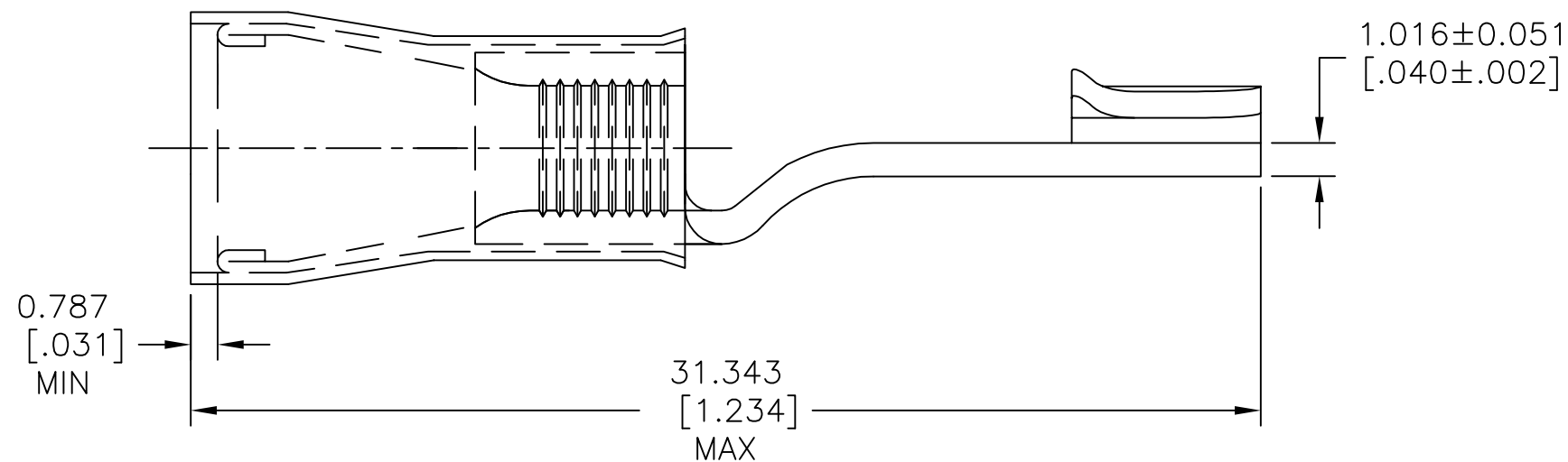

500	LOOSE PIECE	320620
QTY	PACKAGE TYPE	PART NO

MAX RECOMMENDED OPERATING TEMPERATURE: 105°C [221°F]  VOLTAGE RATING: 300 V MAX  CIRCULAR MIL AREA: 2.62-6.64mm <sup>2</sup> [5,180-13,100] STRANDED	THIS DRAWING IS A CONTROLLED DOCUMENT.		DWN jr_ruth 12JUN09	TE Connectivity  NAME TERMINAL, PIDG, KNIFE DISCONNECT, WIRE SIZE: 12-10					
	DIMENSIONS: mm [INCHES]	TOLERANCES UNLESS OTHERWISE SPECIFIED:	CHK TOM MICHIELUTTI 12JUN09						
	MATERIAL	FINISH	APVD TOM MICHIELUTTI 12JUN09	PRODUCT SPEC UL 486A-B	SIZE	CAGE CODE	DRAWING NO	RESTRICTED TO	
			APPLICATION SPEC 114-2157	A3	00779	C=320620			
			WEIGHT -	CUSTOMER DRAWING			SCALE 5:1	SHEET 1 OF 1	REV B2