

THIS DRAWING IS UNPUBLISHED. RELEASED FOR PUBLICATION  
 © COPYRIGHT - By - ALL RIGHTS RESERVED.

LOC		DIST		REVISIONS				
P	LTR	DESCRIPTION			DATE	DWN	APVD	
AF	50	C6	REVISED PER ECR-18-009392			01APR2019	BDA	SV

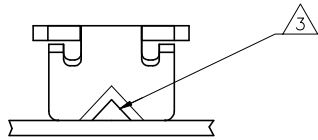

- 1 CONTINUOUS STRIP ON REELS WITH TERMINALS LOCATED ON 5.59±0.08 [.220±.003] CENTERS.
- 2 SLOT TERMINATES EITHER A SINGLE OR DOUBLE MAGNET WIRE OF THE SAME SIZE AND TYPE. COPPER RANGE: 0.64-0.81mm [#22-#20] AWG. ALUMINUM RANGE: 0.67-0.91mm [#22-#19] AWG. ALUMINUM WIRE RANGE IS APPLICABLE FOR POST TIN PLATED PART NOS ONLY
- 3 POKE-IN ACCEPTS A 0.81-1.02mm [#20-#18] AWG SOLID OR FUSED STRANDED LEAD WIRE.
- 4 SPECIAL CAVITY ANVIL HEIGHT REQUIRED 3.30±0.07 [.130±.003]. REFERENCE APPLICATION SPEC 114-2046, SEC 3.2, NOTE 7.

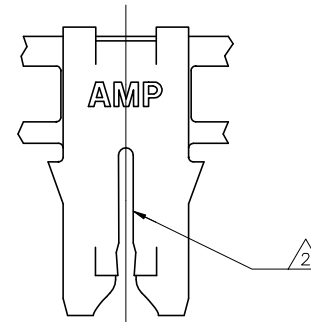
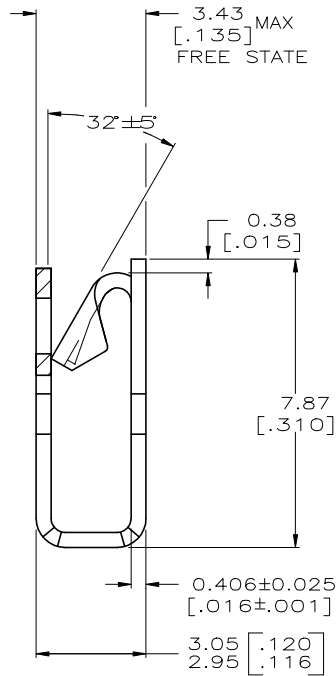
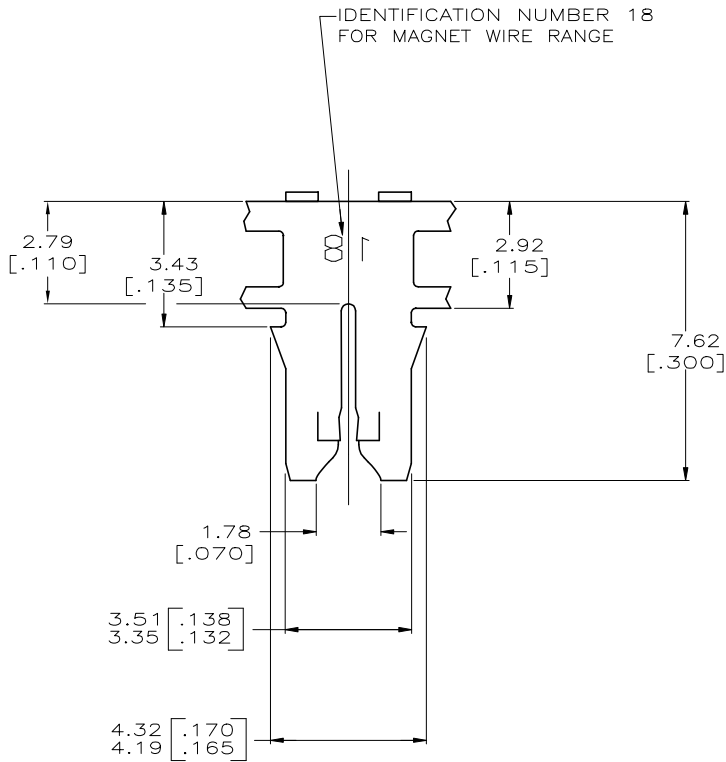

STANDARD		PAPER		CARDBOARD REEL		1217824-1																
REELING DIRECTION		SPLICE		REELING MATERIAL		PART NUMBER																
THIS DRAWING IS A CONTROLLED DOCUMENT.				DWN: MICHAEL S. FEHNER 18JUL2002																		
DIMENSIONS: mm [INCHES]				CHK: KURT A. RANDOLPH 18JUL2002				NAME: KURT A. RANDOLPH														
TOLERANCES UNLESS OTHERWISE SPECIFIED:				APVD: KURT A. RANDOLPH 18JUL2002				PRODUCT SPEC: 108-2012														
<table border="1"> <tr><td>0 PLC</td><td>±</td><td>-</td></tr> <tr><td>1 PLC</td><td>±</td><td>-</td></tr> <tr><td>2 PLC</td><td>±</td><td>0.25(.010)</td></tr> <tr><td>3 PLC</td><td>±</td><td>-</td></tr> <tr><td>4 PLC</td><td>±</td><td>-</td></tr> </table>				0 PLC	±	-	1 PLC	±	-	2 PLC	±	0.25(.010)	3 PLC	±	-	4 PLC	±	-	APPLICATION SPEC: 114-2046		RESTRICTED TO: -	
0 PLC	±	-																				
1 PLC	±	-																				
2 PLC	±	0.25(.010)																				
3 PLC	±	-																				
4 PLC	±	-																				
MATERIAL: BRASS				WEIGHT: -		SIZE: A2																
FINISH: TIN PLATE				CUSTOMER DRAWING		CAGE CODE: 00779																
				SCALE: 10:1		DRAWING NO: 1217824																
						SHEET: 1 of 1																
						REV: C6																