

7 6 5 4 3 2 1

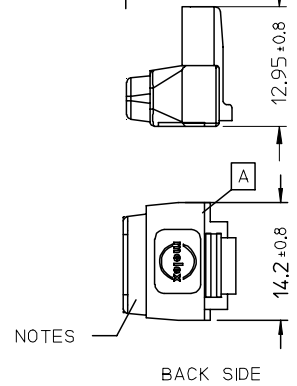
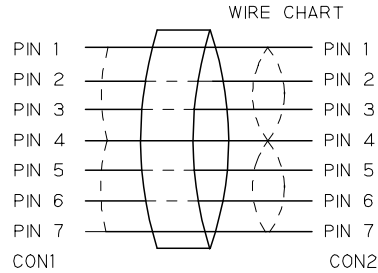
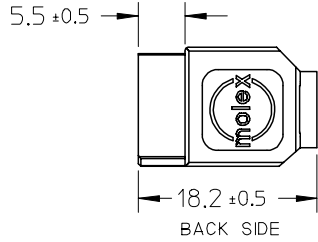
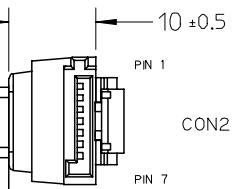
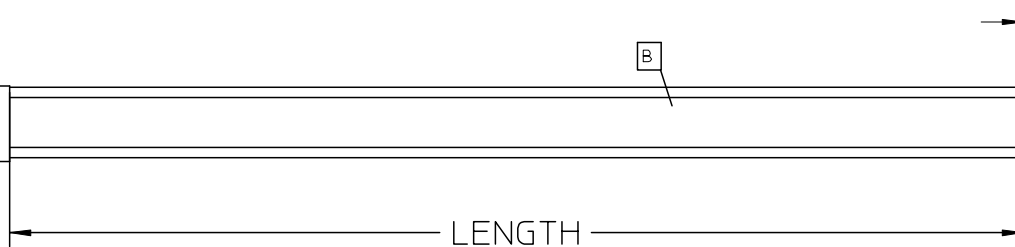
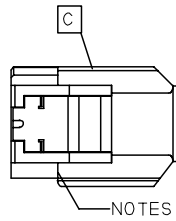
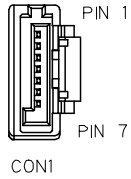

NOTE:  
 PHYSICAL  
 1. OUTER MOLD WITH BLACK PVC RESIN 887800042.  
 INNER MOLD WITH PE RESIN 887800008.  
 ELECTRICAL PERFORMANCE:  
 2. DIELECTRONIC STRENGTH:500V DC/0.01S.  
 3. INSULATION RESISTANCE:100M OHMS MIN.  
 4. CONDUCTIVE RESISTOR: 2 OHMS MAX.

| MOLEX P/N  | LENGTH (mm) | LENGTH (inch) | DESCRIPTION                               |
|------------|-------------|---------------|---|
| 68561-0017 | 1000+/-20   | 40.0+/-0.8    | S-ATA LATCHING STRAIGHT TO R/A CABLE. RED |
| 68561-0016 | 500+/-10    | 20.0+/-0.4    | S-ATA LATCHING STRAIGHT TO R/A CABLE. RED |

| ITEM | DESCRIPTION                        | QTY. |
|------|------------------------------------|------|
| C    | S-ATA STRAIGHT CONN. 674899002     | 1    |
| B    | 2PX26AWG S-ATA CABLE RED 887808052 | 1    |
| A    | S-ATA R/A CONN. 674890002          | 1    |

|  |  |                    |  |  |                        |                            |                  |   |   |
|--|--|--------------------|--|--|------------------------|----------------------------|------------------|---|---|
| ENTER DESCRIPTION<br>EC NO: DG2005-0125<br>DRWN: JLIU13<br>CHKD: TEDDY<br>APPR: TKAN | 2005/04/04<br>2005/04/04<br>2005/04/04 | DESCRIPTION<br>REV | QUALITY SYMBOLS  | GENERAL TOLERANCES (UNLESS SPECIFIED)  | DIMENSION STYLE        | SCALE                      | DESIGN UNITS     | THIRD ANGLE PROJECTION  |   |
|  |  |                    | ▼=0<br>□=0   | mm      INCH<br>4 PLACES ±--- ±---<br>3 PLACES ±--- ±---<br>2 PLACES ±--- ±---<br>1 PLACE ±--- ±---<br>ANGULAR ±---° | MM ONLY                | ---                        | METRIC           | DRAWN BY: JLIU13<br>DATE: 2005/04/04<br>CHECKED BY: TEDDY<br>DATE: 2005/04/04<br>APPROVED BY: BORON<br>DATE: 2005/04/04 | TITLE: S-ATA STRAIGHT LATCHING TO R/A LATCHING SIGNAL CBL RED,0.5M,1.0M<br>MOLEX INCORPORATED |
|  |  |                    | DRAFT WHERE APPLICABLE MUST REMAIN WITHIN DIMENSIONS   |  | MATERIAL NO. 685610017 | DOCUMENT NO. SD-68561-0017 | SHEET NO. 1 OF 1 |   |   |
|  |  |                    | SIZE A/4 THIS DRAWING CONTAINS INFORMATION THAT IS PROPRIETARY TO MOLEX INCORPORATED AND SHOULD NOT BE USED WITHOUT WRITTEN PERMISSION |  |                        |                            |                  |   |   |

6 5 4 3 2 1