

CABLE 234 RF: RP SMA STRAIGHT PLUG + RP SMA STRAIGHT BULKHEAD JACK W/O-RING RATED TO IP67/68 + MULTIPLE CABLE SIZES

SPECIFICATIONS :

- RP SMA STRAIGHT PLUG, P/N:
 FOR RG178 CABLE: RFCT-SMA017-M78.
 FOR $\phi 1.13\text{MM}$ CABLE: RFCT-SMA042-M13.
 FOR RG316 CABLE: RFCT-SMA017-M74.
- COAXIAL CABLE, SEE P/N FOR DETAIL.
- RP SMA STRAIGHT BULKHEAD JACK W/O-RING RATED TO IP67/68, P/N:
 FOR $\phi 1.13\text{MM}$ -RG178 CABLE: RFCT-SMA008-F78.
 FOR RG316 CABLE: RFCT-SMA008-F74.

USAGE PRECAUTIONS: CABLES USING 'MICRO' COAX ARE DELICATE:
 (i) HANDLE WITH CARE.
 (ii) DO NOT TWIST; APPLY EXCESSIVE FORCES OR SHARP BENDS TO THE CABLE. DO NOT FORCEFULLY DEFORM WIRES.
 (iii) CONSULT CONNECTOR MANUFACTURER'S DATASHEETS FOR DETAILED NOTES ON HANDLING INSTRUCTIONS.

ENVIRONMENTAL:

- A. BULKHEAD MOUNTED CONNECTOR (RFCT-SMA008-Fxx) TESTED TO THE FOLLOWING SPECIFICATION:
- IP6X - DUST TIGHT - NO PARTICLE INGRESS.
 - IPX7 WATERPROOF FOR 30 MINUTES UP TO 1 METER UNDERWATER.
 - IPX8 WATERPROOF FOR 48 HOURS AT 1 METER UNDERWATER.
 - IPX8 WATERPROOF FOR 12 HOURS AT 5 METERS UNDERWATER.
 - PRESSURE TEST - 1 BAR FOR 10 SECONDS.

NOTES:

- WORKING FREQUENCY RANGE: DC-3GHz.
- OPERATING TEMPERATURE: -40°C ~ $+125^{\circ}\text{C}$
- IMPEDANCE: 50 OHM.

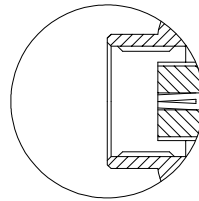
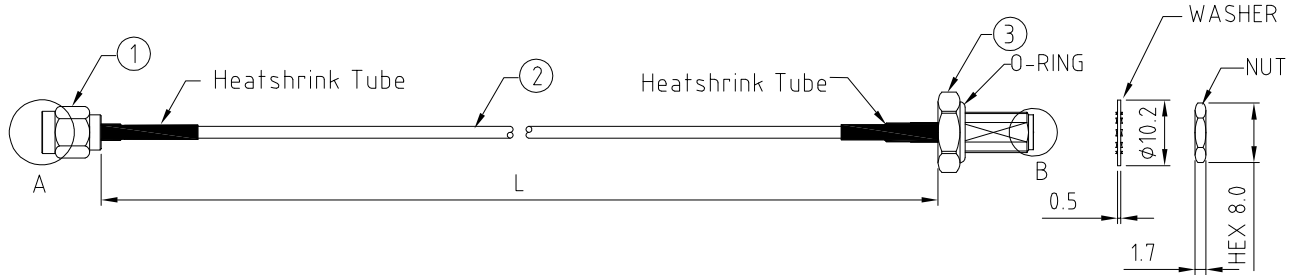

DETAIL A

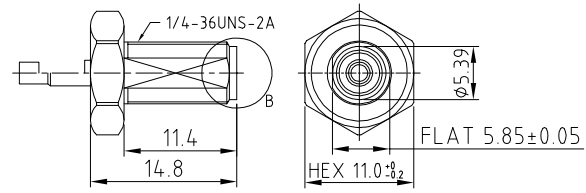

SMA JACK DETAIL DRAWING

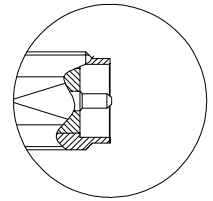

DETAIL B

HOW TO ORDER

CABLE 234 RF - X X X X - X - X

"L" LENGTH IN MM:
 eg: 100MM = 0100
 (MIN. 0050-MAX.2000)
 STANDARD = 0100, 0150, 0200)
 Tolerance: <50mm: $\pm 2\text{mm}$.
 51-200mm: $\pm 5\text{mm}$.
 201-500mm: $\pm 7\text{mm}$.
 >501mm: $\pm 10\text{mm}$.

CABLE SIZE OPTIONS:
 1 = RG178 CABLE, COLOR: BROWN.
 2 = $\phi 1.13\text{MM}$ CABLE, COLOR: GRAY.
 3 = RG316 CABLE, COLOR: BROWN.

WASHER AND NUT OPTIONS:
 BLANK = SEPARATELY PACKED (STANDARD)
 A = ALL ASSEMBLED WITH CONNECTOR

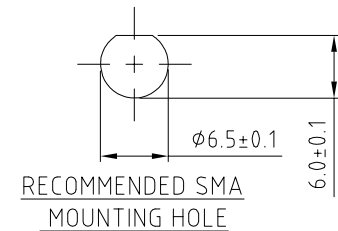

RECOMMENDED SMA MOUNTING HOLE

REV. DATE & DRN 10 26/05/16 - RJH RELEASE 11 20/02/17 - NYW ADD 1'S CABLE OPTION 12 08/04/18 - NYW ADD 0.5mm SMA DETAIL DRAWING 13 27/05/19 - NYW ADD OPERATING TEMP. 14 02/09/21 - NYW ADD IMPEDANCE 15 19/07/22 - NYW ADD CABLE SIZE 3 OPTION AMEND OPERATING TEMP.	Scale: NTS	THIRD ANGLE	Unstated X XX XXX ANGLES	Tolerances: N/A N/A N/A N/A			Type: Cable 234 RF	
	Drawn: RJH		Title CABLE ASSEMBLY				IP67/68 Rated Cables	www.gradconn.com
	App'd: XXX	Date: 19 JAN. '22	Revision: 15	Unit: mm		THIS DRAWING IS CONFIDENTIAL AND MUST NOT BE COPIED OR DISCLOSED WITHOUT WRITTEN CONSENT		Drawing Number:
								Sheet 1 of 1 Drawing © E and O E