

SIDE VIEW

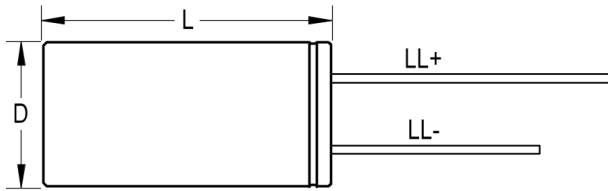

TERMINAL END VIEW

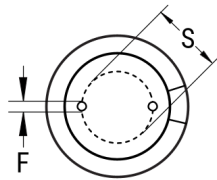

Click [here](#) for the 3D model.

Dimensions

D	10mm +/-0.5mm
L	15mm +2mm
S	5mm +/-0.5mm
LL Negative	15mm MIN
LL Positive	20mm MIN
F	0.6mm NOM

Packaging Specifications

Packaging	Bulk, Bag
Packaging Quantity	3000

General Information

Series	EST
Dielectric	Aluminum Electrolytic
Description	LowZ, Long Life, Single Ended Aluminum Electrolytic
Features	Low Z, Long Life, Low Impedance
RoHS	Yes
Lead	Wire Leads
AEC-Q200	No

Specifications

Capacitance	680 uF
Capacitance Tolerance	20%
Voltage DC	16 VDC, 20 VDC (Surge)
Temperature Range	-40/+105°C
Rated Temperature	105°C
Life	7000 Hrs
Dissipation Factor	16%
Resistance	0.084 Ohms (ESR, 100kHz 25C), 0.084 Ohms (Z, 100kHz 20C)
Ripple Current	1210 mAmps (100kHz 105C)
Leakage Current	108.8 uA (2min 20°C)
Impedance Ratio at -25C	2
Impedance Ratio at -40C	4