

REVISIONS					
P	LTR	DESCRIPTION	DATE	DWN	APVD
B		REVISED PER ECR-20-100642	19SEP2022	M.G	D.Z

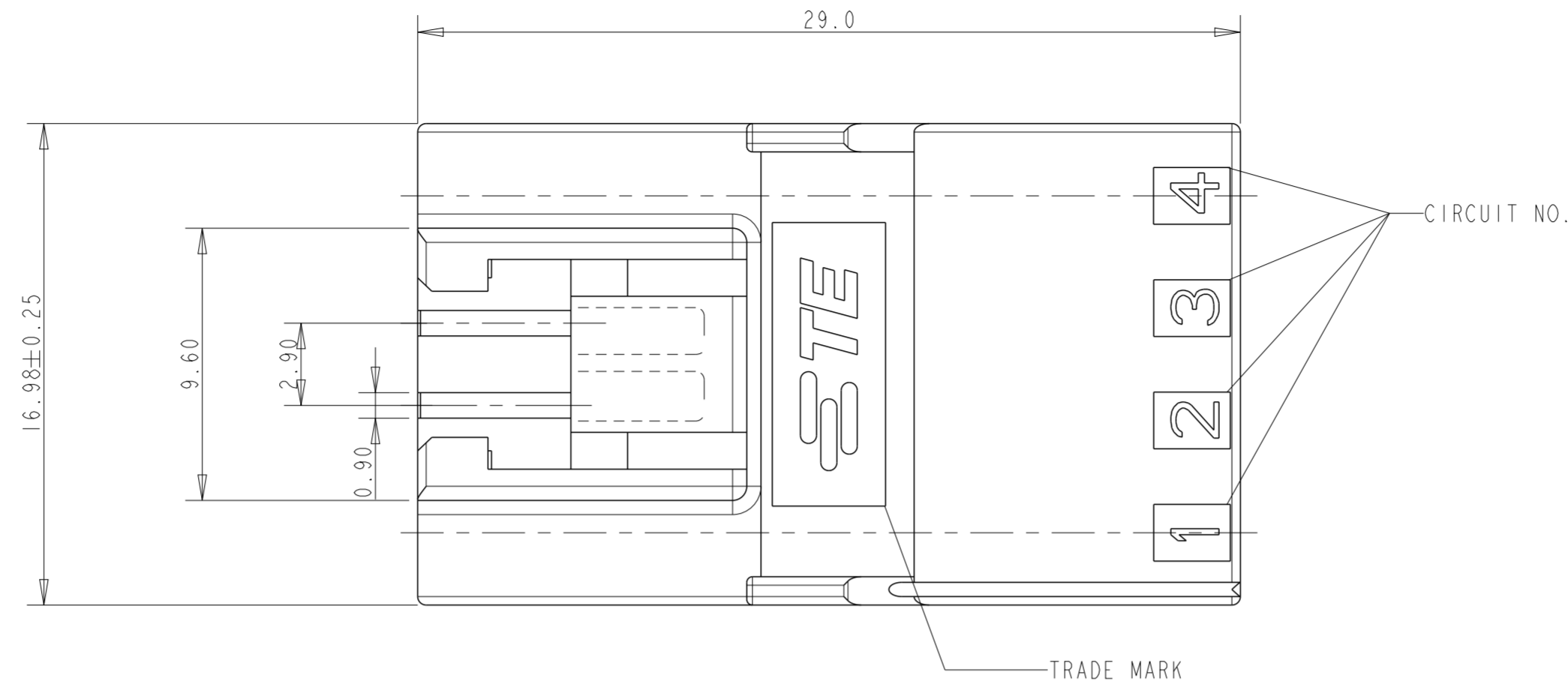

NOTES:

- APPLICABLE CONTACT P/N:  
 TAB CONTACT: 175150- (20-16 AWG)  
 175149- (26-22 AWG)
- MATING CONN. P/N:  
 PLUG HSG: 176278-  
 REC HSG: 175152- (20-16 AWG)  
 175151- (26-22 AWG)
- INSTRUCTION SHEET: IS-503J.

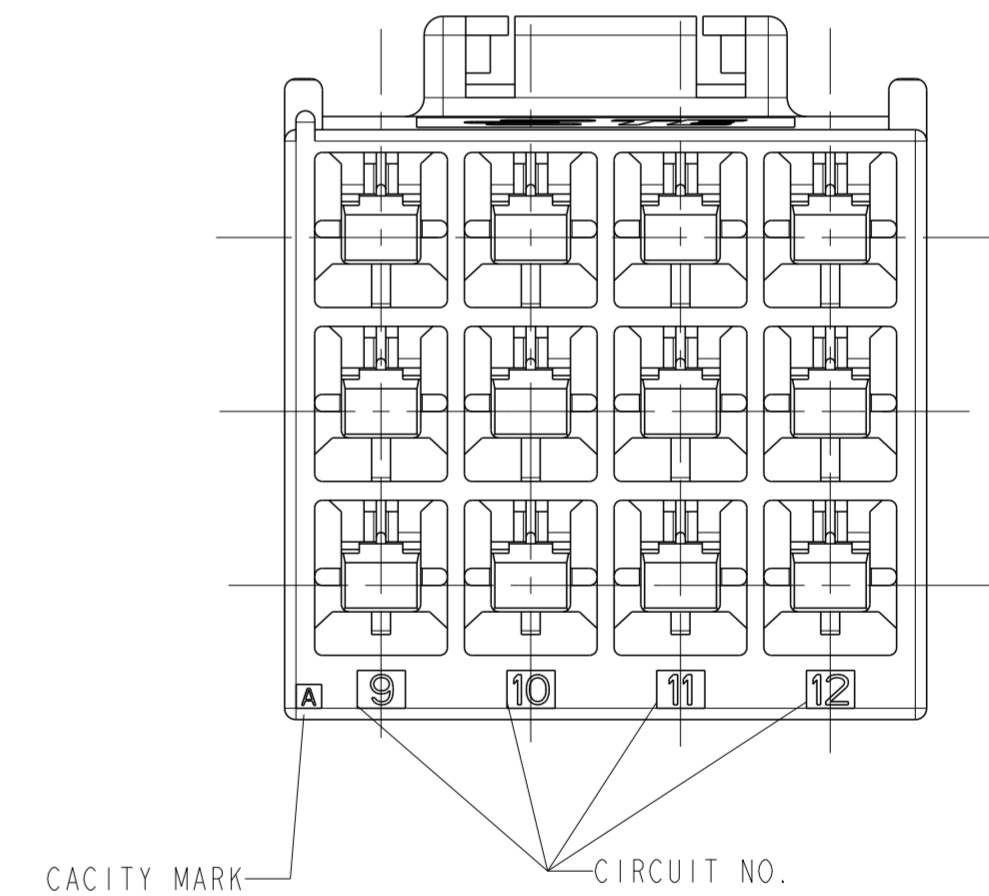
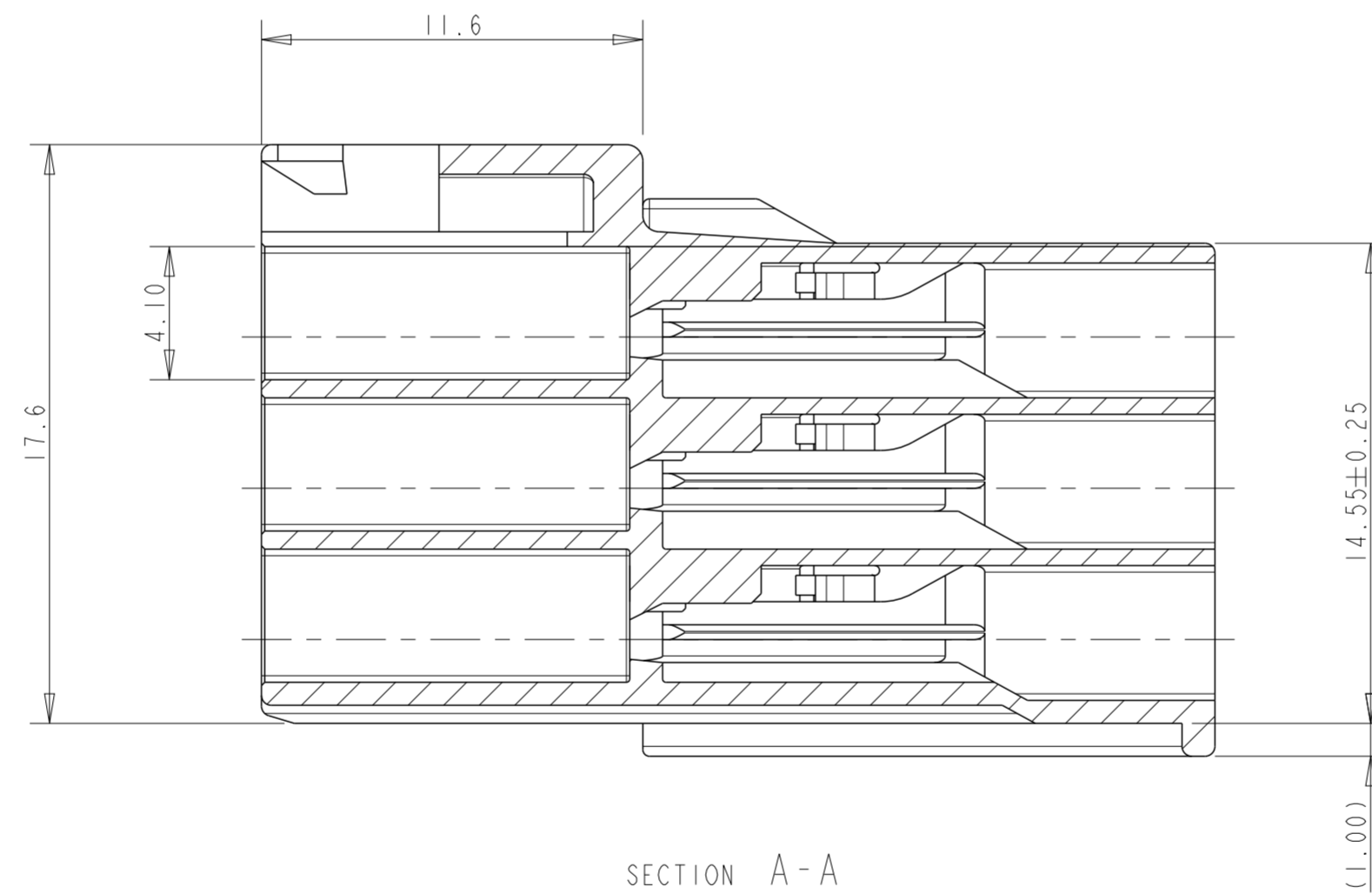
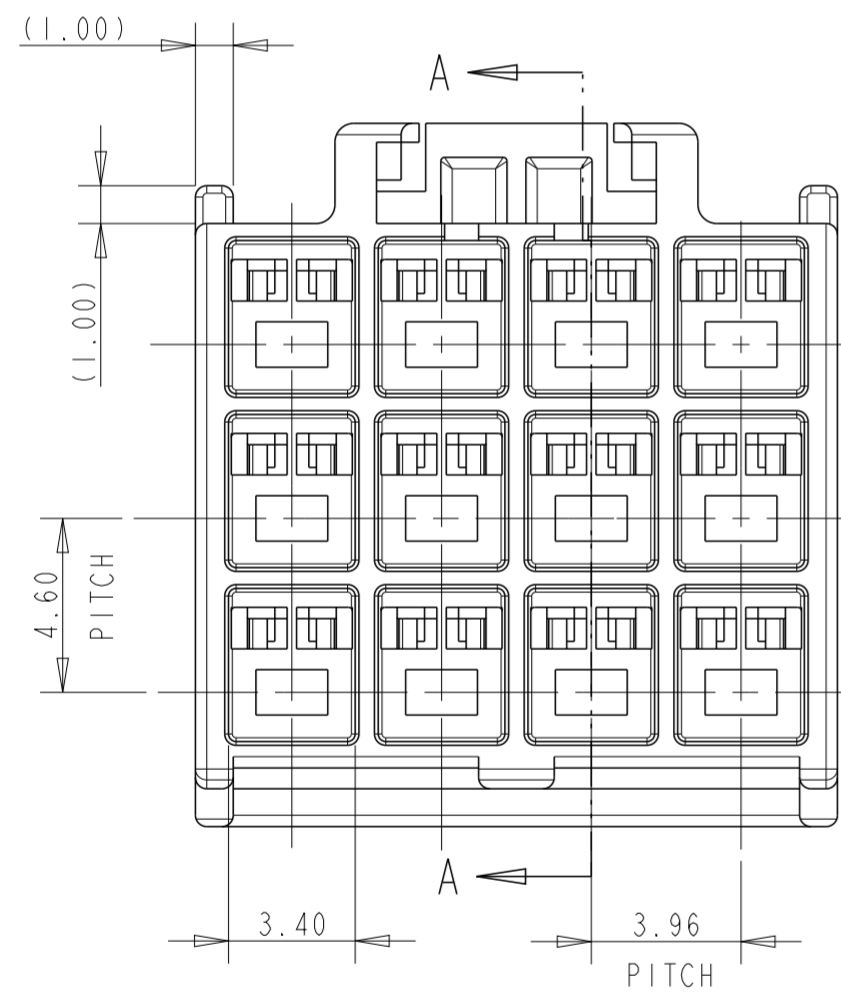

DEVELOPMENT	DISCONTINUED	DISCONTINUED	DISCONTINUED	HOUSING COLOR	POSITION	PART NUMBER
				BLACK	12	176289-9
				BLUE	12	176289-6
				YELLOW	12	176289-4
				RED	12	176289-2
				NATURAL	12	176289-1

THIS DRAWING IS A CONTROLLED DOCUMENT.		DWN M. SHINDO 23NOV1989	TE Connectivity															
DIMENSIONS: mm		CHK M. YOSHIDA 28NOV1989																
TOLERANCES UNLESS OTHERWISE SPECIFIED:		APVD N. ONQUE 28NOV1989	NAME AMP UNIVERSAL POWER CONN, 3.96mm PITCH CAP HOUSING 12 POS (TPL ROW)															
<table border="1"> <tr><td>0 PLC</td><td>±</td></tr> <tr><td>1 PLC</td><td>±0.25</td></tr> <tr><td>2 PLC</td><td>±0.2</td></tr> <tr><td>3 PLC</td><td>±</td></tr> <tr><td>4 PLC</td><td>±</td></tr> <tr><td>ANGLES</td><td>±3°</td></tr> <tr><td>FINISH</td><td>-</td></tr> </table>		0 PLC	±	1 PLC	±0.25	2 PLC	±0.2	3 PLC	±	4 PLC	±	ANGLES	±3°	FINISH	-	PRODUCT SPEC 108-5302	SIZE A2	
0 PLC	±																	
1 PLC	±0.25																	
2 PLC	±0.2																	
3 PLC	±																	
4 PLC	±																	
ANGLES	±3°																	
FINISH	-																	
MATERIAL 6/6 NYLON (UL94 V-0)		APPLICATION SPEC 114-5142	CAGE CODE 00779	DRAWING NO C-176289														
		WEIGHT -	RESTRICTED TO -															
		CUSTOMER DRAWING	SCALE 5:1	SHEET 1 OF 1														
			REV B															