

PART NO.		<b>RFD-43MS-HPL</b>		
REV	DESCRIPTION	DWN	DATE	APPROVED
B	UPDATED SPECS	CZS	09/09/20	JDMc

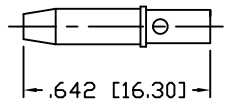

PIN TO BE SOLDER

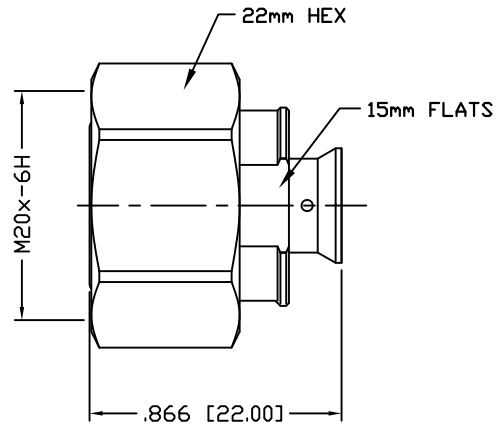
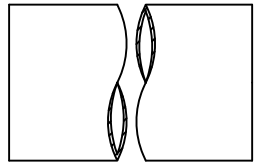
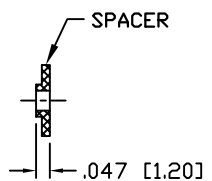

TUBING NOT TO SCALE

SPECIFICATIONS:

INTERFACE: IEC61169-54  
 IMPEDANCE: 50 Ohms  
 FREQUENCY RANGE: 0-6 GHz  
 MATING CYCLES: >100  
 COUPLING TORQUE: ≥ 3.7 FT-LB (≥5 Nm)  
 VSWR: <1.15:1 THRU 3 GHz  
 3rd ORDER IM: ≤-160 dBc @ 700 MHz & 1900 MHz  
 3rd ORDER IM TEST METHOD: 2x43 dBm CARRIERS  
 DC TEST VOLTAGE: 2500 V @ SEA LEVEL  
 INSULATION RESISTANCE: 5000 MΩ  
 TEMPERATURE RANGE: -55°C TO 90°C  
 NET WEIGHT: 0.08 lb  
 CERTIFICATIONS: RoHS  
 ENVIRONMENTAL: IEC 60529, IPX8 (2.5 BAR, 1 HOUR)  
 IEC 61169-1 CLAUSE 9.4.6 48 HOUR SALT MIST, 35°C  
 USED ON: SPP-250-LLPP, SPO-250, SCF14-50J, SPF-250,  
 FSJ1-50A, SCF14-50J, PTS1-50-P, TFT-401, EC1-50-HF

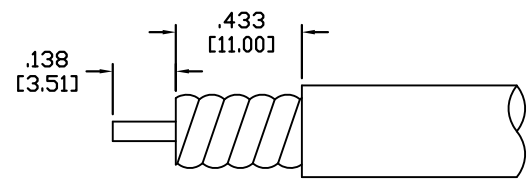

RECOMMENDED STRIPING DIMENSIONS

USE OF CABLE TRIM TOOL IS RECOMMENDED  
USE COMPATIBLE TRIM TOOL SUCH AS MCPT-1412

8	TUBING	1	HEAT SHRINK	BLACK
7	SHELL	1	BRASS	WHITE BRONZE
6	RETAINING RING	1	BeCu	WHITE BRONZE
5	O-RING	1	S.I. RUBBER	RED
4	SPACER	1	PTFE	NATURAL
3	INSULATOR	1	PTFE	NATURAL
2	PIN	1	BRASS	SILVER
1	BODY	1	BRASS	WHITE BRONZE
#	DESCRIPTION	QTY	MATERIAL	FINISH

CUSTOMER OUTLINE DRAWING	
ALL DIMENSIONS ARE REFERENCE ONLY	
UNLESS OTHERWISE SPECIFIED: DIMENSIONS ARE IN INCHES AND [MILLIMETERS]	
DRAWN C. ZUNIGA	09/09/20
CHECKED	
ORJ DRAWN C. ZUNIGA	10/12/15

**RoHS  
COMPLIANT**

PROPRIETARY AND CONFIDENTIAL  
 THIS DRAWING CONTAINS  
 INFORMATION PROPRIETARY TO  
 RF INDUSTRIES, ANY  
 UNAUTHORIZED USE OF THIS  
 DRAWING IS EXPRESSLY  
 PROHIBITED WITHOUT WRITTEN  
 PERMISSION FROM RF  
 INDUSTRIES. ANY VIOLATION IS  
 PUNISHABLE UNDER U.S.  
 COPYRIGHT LAWS.

**RFconnectors** 7610 MIRAMAR RD.  
 SAN DIEGO, CA 92126  
 (858) 549-6340  
 DIVISION OF RF INDUSTRIES, LTD. (858) 549-6345 FAX

**4.3/10 MALE**  
 FOR SPP-250LLPL

SIZE A	CABLE GROUP N/A	DWG NO. <b>RFD-43MS-HPL</b>	REVISION B
SCALE: NTS	ENGINEERING ID: 001787	SHEET 1 OF 1	