

FIRST CIRCUIT MARK  
(NOT SHOWING ON 2  
AND 3 CIRCUITS SERIES)

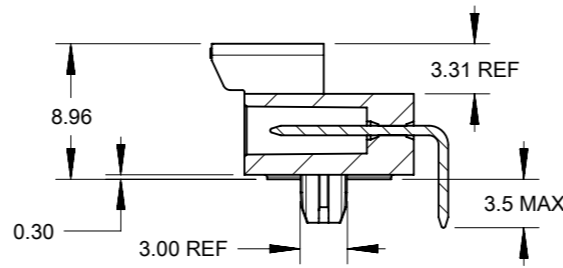

SECTION Y-Y

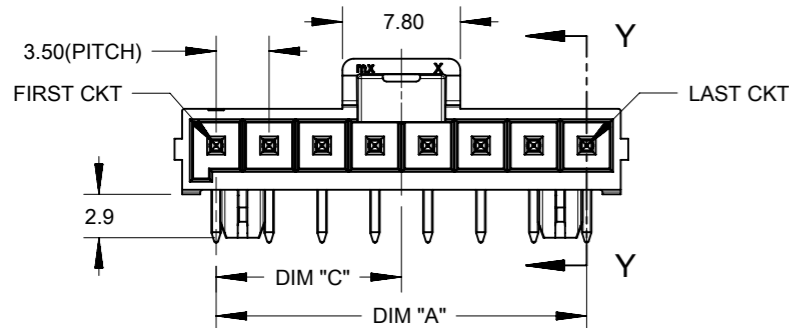
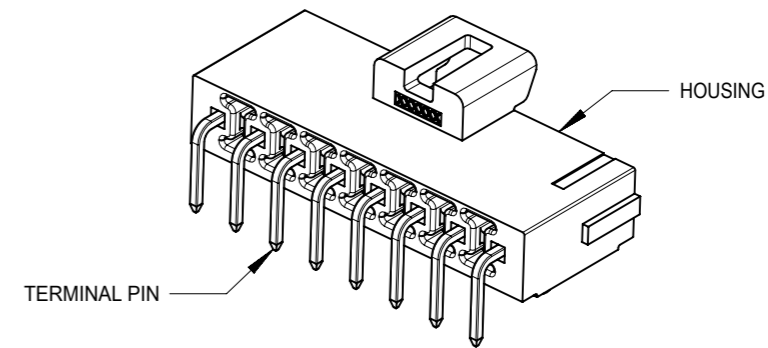
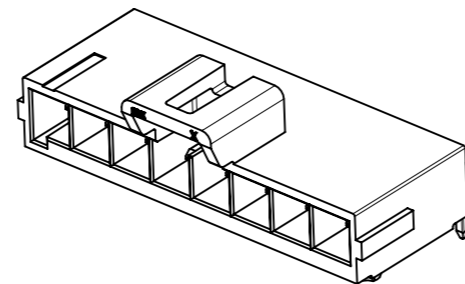
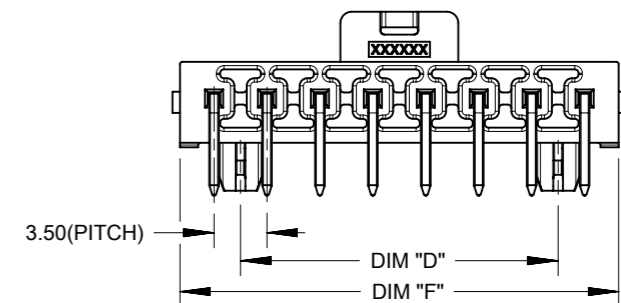

NOTES:

- MATERIAL :  
HOUSING  
OPTION 1: LCP BLACK, UL94 V-0  
OPTION 2: LCP NATURAL, UL94 V-0  
TERMINAL: COPPER ALLOY
- PLATING FINISH:  
OPTION 1 - 1.5µm(60µin)-2.5µm(100µin) TIN OVER  
1.25µm(50µin)-2.5µm(100µin) NICKEL OVERALL  
OPTION 2 - 0.35µm(15µin) GOLD CONTACT AREA,  
1.5µm(60µin)-2.5µm(100µin) TIN TAIL AREA OVER  
1.25µm(50µin)-2.5µm(100µin) NICKEL OVERALL  
OPTION 3 - 0.70µm(30µin) GOLD CONTACT AREA,  
1.5µm(60µin)-2.5µm(100µin) TIN TAIL AREA OVER  
1.25µm(50µin)-2.5µm(100µin) NICKEL OVERALL
- PARTS TO BE PACKAGED PER PK-172310-9001
- PRODUCT SPECIFICATION PS-172323-0001
- PART MATES WITH MOLEX RECEPTACLE HOUSING 172256 AND 172260
- PART CONFORMS TO CLASS "C" REQUIREMENTS OF SPECIFICATION PS-45499-002 WITH 0.13 MM MAXIMUM FLASH ALLOWED IN CORE HOLES AND FRONT SURFACE.
- DISCOLORATION IN THE BANDOLIER AREA OF THE PIN IS INHERENT TO THE PLATING PROCESS AND IS DUE TO THE MASKING EFFECT OF THE CARRIER. THIS DISCOLORATION IS IN A NON-FUNCTIONAL AREA OF THE PIN AND WILL NOT AFFECT THE PERFORMANCE OF THE HEADER ASSEMBLY.
- ASSEMBLY SPECIFICATION: AS-172323-0001

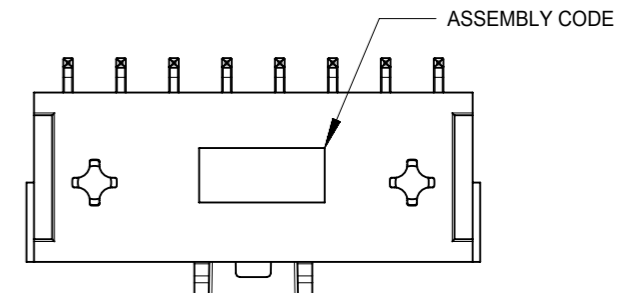
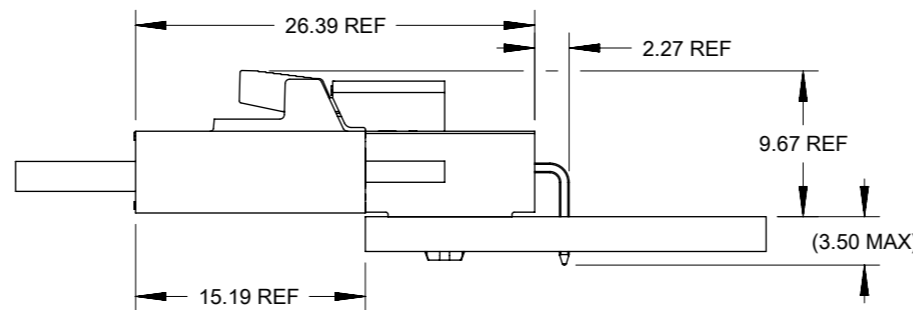

FUNCTIONAL SYMBOLS	THIS DRAWING CONTAINS INFORMATION THAT IS PROPRIETARY TO MOLEX ELECTRONIC TECHNOLOGIES, LLC AND SHOULD NOT BE USED WITHOUT WRITTEN PERMISSION			
	DIMENSION UNITS	SCALE		
$\nabla_A = 0$	mm			
$\nabla_F = 0$	GENERAL TOLERANCES (UNLESS SPECIFIED)			
$\nabla_E = 0$	ANGULAR TOL ± °			
DIVISIONAL SYMBOLS	4 PLACES ±	EC NO: 704776	2022/04/05	
	3 PLACES ±	DRWN: SUGEEB	2022/05/24	
	2 PLACES ± 0.25	CHK'D: GGA	2022/05/24	
	1 PLACE ± 0.5	APPR: GGA		
	0 PLACES ±	INITIAL REVISION:		
DRAFT WHERE APPLICABLE MUST REMAIN WITHIN DIMENSIONS		DRWN: DROSCA	2014/03/05	
THIRD ANGLE PROJECTION		APPR: JCOMERCI	2014/04/24	
DRAWING		SERIES	DOCUMENT NUMBER	
A3-SIZE		172310	SD-172310-1000	
MATERIAL NUMBER		CUSTOMER	DOC TYPE   DOC PART   REVISION	
		GENERAL MARKET	PSD   000   C4	
			SHEET NUMBER	
			1 OF 3	

**molex**

ULTRA-FIT R/A HEADER  
2-8 CKTS SINGLE ROW

PRODUCT CUSTOMER DRAWING

DOCUMENT NUMBER: SD-172310-1000  
DOC TYPE: PSD  
DOC PART: 000  
REVISION: C4

MATERIAL NUMBER: GENERAL MARKET  
CUSTOMER: GENERAL MARKET  
SHEET NUMBER: 1 OF 3

10 9 8 7 6 5 4 3 2 1

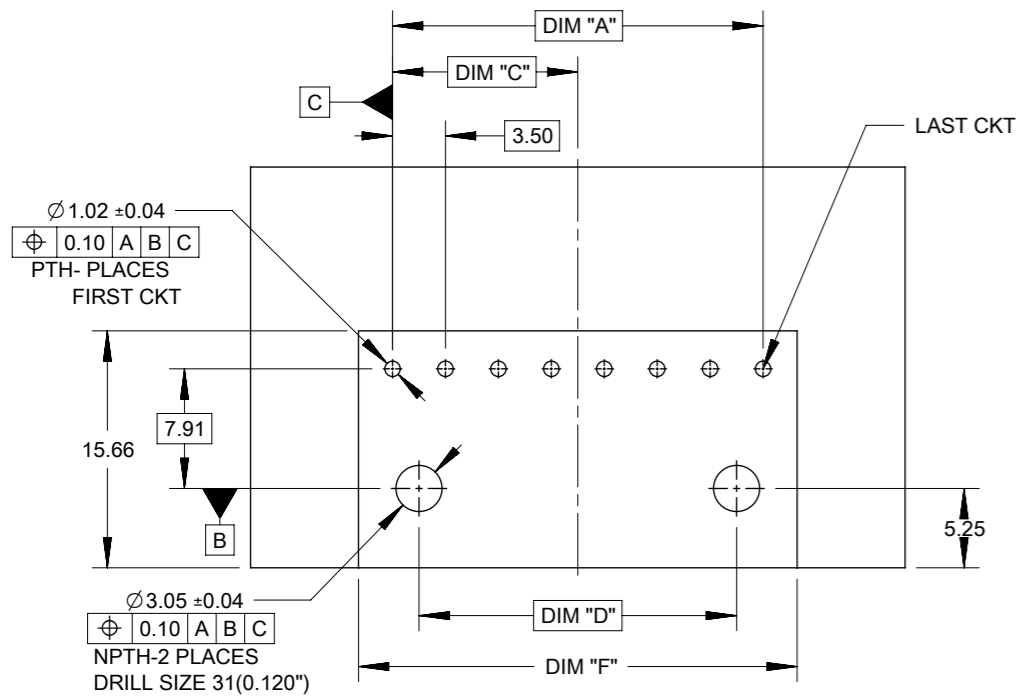

PCB LAYOUT 4,5,6,7 AND 8 COMPONENT SIDE  
RECOMENDED PCB THICKNESS 1.60MM-2.40MM

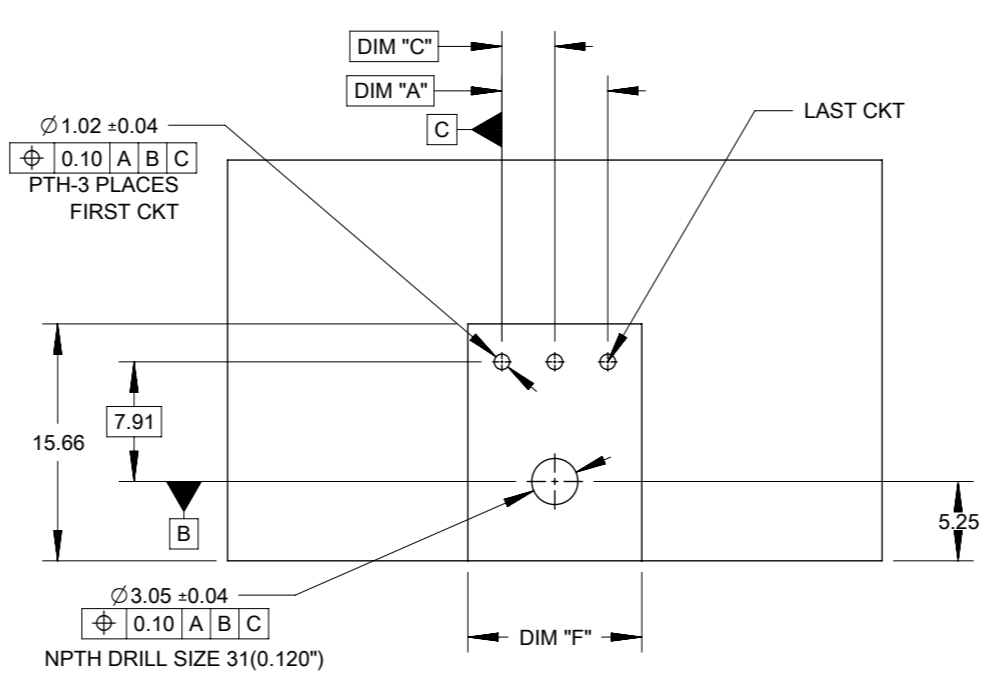

PCB LAYOUT 3 CIRCUIT COMPONENT SIDE  
RECOMENDED PCB THICKNESS 1.60MM-2.40MM

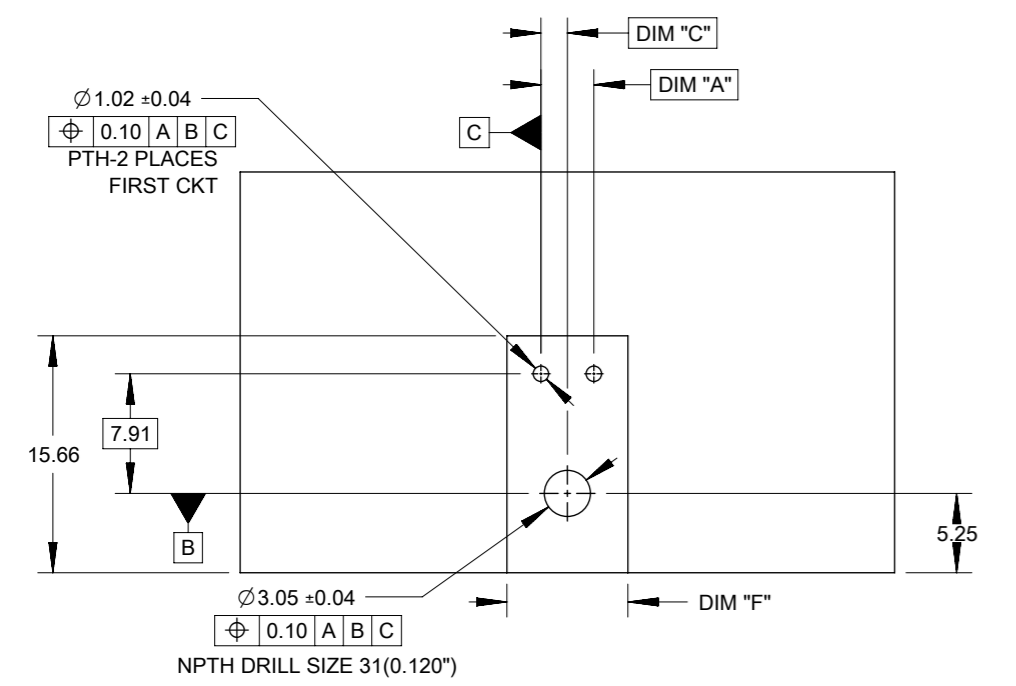

PCB LAYOUT 2 CIRCUIT COMPONENT SIDE  
RECOMENDED PCB THICKNESS 1.60MM-2.40MM

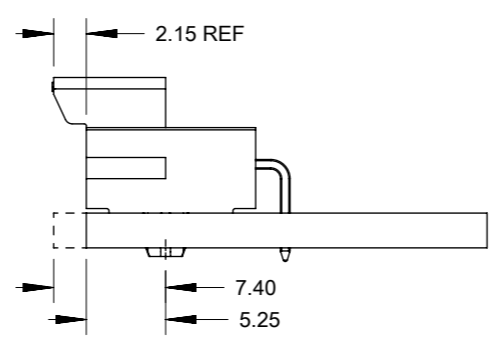

OPTION 1: LATCH FLUSH WITH PCB EDGE  
OPTION 2: HOUSING BODY FLUSH WITH PCB EDGE

NOTE: DATUM -A- IS ON PCB COMPONENT SIDE

TIN PLATING							
PART NO.	COLOR	CIRCUIT SIZE	KEY OPTION	DIM A	DIM F	DIM C	DIM D
172310-1102	BLACK	2	KEY A	3.50	8.00	1.75	0.00
172310-1103	BLACK	3	KEY A	7.00	11.50	3.50	0.00
172310-1104	BLACK	4	KEY A	10.50	15.00	5.25	7.00
172310-1105	BLACK	5	KEY A	14.00	18.50	7.00	10.50
172310-1106	BLACK	6	KEY A	17.50	22.00	8.75	14.00
172310-1107	BLACK	7	KEY A	21.00	25.50	10.50	17.50
172310-1108	BLACK	8	KEY A	24.50	29.00	12.25	21.00
172310-2105	NATURAL	5	KEY B	14.00	18.50	7.00	10.50

15 MICROINCH GOLD PLATING							
PART NO.	COLOR	CIRCUIT SIZE	KEY OPTION	DIM A	DIM F	DIM C	DIM D
172310-1202	BLACK	2	KEY A	3.50	8.00	1.75	0.00
172310-1203	BLACK	3	KEY A	7.00	11.50	3.50	0.00
172310-1204	BLACK	4	KEY A	10.50	15.00	5.25	7.00
172310-1205	BLACK	5	KEY A	14.00	18.50	7.00	10.50
172310-1206	BLACK	6	KEY A	17.50	22.00	8.75	14.00
172310-1207	BLACK	7	KEY A	21.00	25.50	10.50	17.50
172310-1208	BLACK	8	KEY A	24.50	29.00	12.25	21.00
172310-2204	NATURAL	4	KEY B	10.50	15.00	5.25	7.00
172310-2205	NATURAL	5	KEY B	14.00	18.50	7.00	10.50
172310-2207	NATURAL	7	KEY B	21.00	25.50	10.50	17.50

30 MICROINCH GOLD PLATING							
PART NO.	COLOR	CIRCUIT SIZE	KEY OPTION	DIM A	DIM F	DIM C	DIM D
172310-1302	BLACK	2	KEY A	3.50	8.00	1.75	0.00
172310-1303	BLACK	3	KEY A	7.00	11.50	3.50	0.00
172310-1304	BLACK	4	KEY A	10.50	15.00	5.25	7.00
172310-1305	BLACK	5	KEY A	14.00	18.50	7.00	10.50
172310-1306	BLACK	6	KEY A	17.50	22.00	8.75	14.00
172310-1307	BLACK	7	KEY A	21.00	25.50	10.50	17.50
172310-1308	BLACK	8	KEY A	24.50	29.00	12.25	21.00
172310-2304	NATURAL	4	KEY B	10.50	15.00	5.25	7.00

FUNCTIONAL SYMBOLS	THIS DRAWING CONTAINS INFORMATION THAT IS PROPRIETARY TO MOLEX ELECTRONIC TECHNOLOGIES, LLC AND SHOULD NOT BE USED WITHOUT WRITTEN PERMISSION	CURRENT REV DESC: OBSOLETE PART NUMBER AS PER PCN#509988		<b>molex</b>			
	DIMENSION UNITS: mm	SCALE:	EC NO: 704776				
	GENERAL TOLERANCES (UNLESS SPECIFIED)	ANGULAR TOL ± °		DRWN: SUGEEB 2022/04/05		ULTRA-FIT R/A HEADER 2-8 CKTS SINGLE ROW	
	4 PLACES ±	3 PLACES ±		CHK'D: GGA 2022/05/24		PRODUCT CUSTOMER DRAWING	
DIVISIONAL SYMBOLS	2 PLACES ± 0.25	1 PLACE ± 0.5		APPR: GGA 2022/05/24		DOCUMENT NUMBER: SD-172310-1000	
1 PLACE ± 0.5	0 PLACES ±		INITIAL REVISION: DRWN: DROSCA 2014/03/05		DOC TYPE: PSD		
DRAFT WHERE APPLICABLE MUST REMAIN WITHIN DIMENSIONS		THIRD ANGLE PROJECTION		DRAWING: A3-SIZE		DOC PART: 000	
		SERIES: 172310		MATERIAL NUMBER: JCOMERCI		REVISION: C4	
				CUSTOMER: GENERAL MARKET		SHEET NUMBER: 2 OF 3	

9 8 7 6 5 4 3 2 1

10

9

8

7

6

5

4

3

2

1

F

F

E

E

D

D

C

C

B

B

A

A

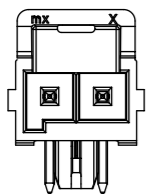

2 CKT

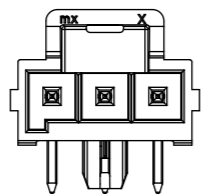

3 CKT

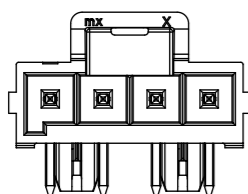

4 CKT

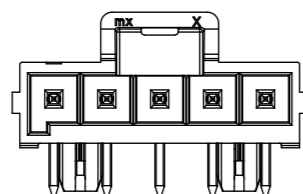

5 CKT

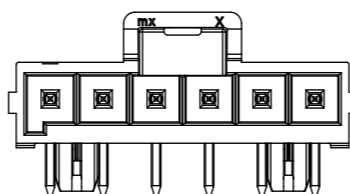

6 CKT

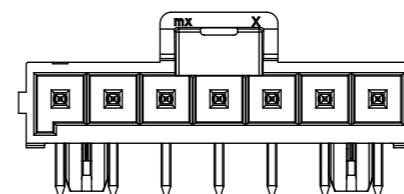

7 CKT

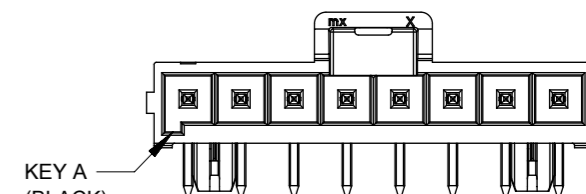

8 CKT

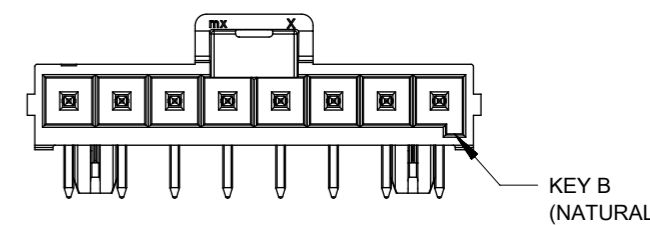

KEY B (NATURAL)

FUNCTIONAL SYMBOLS	THIS DRAWING CONTAINS INFORMATION THAT IS PROPRIETARY TO MOLEX ELECTRONIC TECHNOLOGIES, LLC AND SHOULD NOT BE USED WITHOUT WRITTEN PERMISSION										
	$\nabla_A = 0$ $\nabla_F = 0$ $\nabla_P = 0$	DIMENSION UNITS <b>mm</b>	SCALE	CURRENT REV DESC: OBSOLETE PART NUMBER AS PER PCN#509988							
GENERAL TOLERANCES (UNLESS SPECIFIED)			EC NO: 704776							2022/04/05	
ANGULAR TOL ± °			DRWN: SUGEEB							2022/05/24	
4 PLACES ±			CHK'D: GGA							2022/05/24	
3 PLACES ±			APPR: GGA							2022/05/24	
2 PLACES ± 0.25			INITIAL REVISION:							DOCUMENT NUMBER	
1 PLACE ± 0.5			DRWN: DROSCA							SD-172310-1000	
0 PLACES ±			APPR: JCOMERCI							DOC TYPE DOC PART REVISION	
DRAFT WHERE APPLICABLE MUST REMAIN WITHIN DIMENSIONS			THIRD ANGLE PROJECTION	DRAWING	SERIES	MATERIAL NUMBER	CUSTOMER		SHEET NUMBER		
				A3-SIZE	172310		GENERAL MARKET		3 OF 3		

DOCUMENT STATUS	P1	RELEASE DATE	2022/05/24	10:34:52
-----------------	----	--------------	------------	----------

9

8

7

6

5

4

3

2

1

FORMAT: master-b-prod-A3

REVISION: 11

DATE: 2021/05/01