



# Product Change Notification (PCN)

PCN Number	508249	Date Issued	March 06, 2020
Reason for Change	Equipment Transfer, Production Transfer or Rearrangement		
Change Type Description	This letter is to inform you that production of the part(s) identified in this notice is being moved to a different production location. No changes will be made to the product as a result of this move.		
Reason for Short Notice	Special Request		
Assessment of Change	Product will be fully qualified before it is shipped. Qualification reports will be available after below listed date		
Internal Molex Qualification Date	May 31, 2020		
Sample Availability Date (Changed Part)	May 31, 2020		
Planned Implementation Date	June 30, 2020		
Method of Identifying Change	Lot information on label		

RELEASED

Before Change

After Change

**Power Edge Product View**

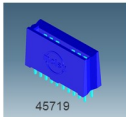

45719  
POWER ONLY,  
SOLDER TAIL

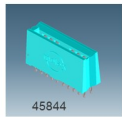

45844  
SIGNAL ONLY SOLDER  
TAILS



45911  
POWER/SIGNAL MIX,  
SOLDER TAILS



45714  
POWER ONLY,  
CPI TAILS



45845  
SIGNAL ONLY, CPI  
TAILS



45912  
POWER/SIGNAL MIX,  
CPI TAILS

**Overview**

- Molex will outsource the assembly process for the below part numbers. The existing in-house assembly equipment will be transferred to the new location. All other production conditions will remain the same, meaning the same components from the same sources, the same process monitoring systems and the same quality control plan.
- Product Impact
  - no impact to fit, form or function
- Part Number Impact
  - no impact to fit, form or function
- Qualification Reports and samples available upon request after the date shown above



## Product Change Notification (PCN)

---

You may address any technical inquiries regarding this PCN by sending E-mail to [pcn\\_coordinator@molex.com](mailto:pcn_coordinator@molex.com) or your Local Sales Engineer.

Note: While responding, please retain "**PCN Notification:508249**" in the e-mail Subject line for faster response.

RELEASED

**Molex, LLC**  
2222 Wellington Court  
Lisle, IL 60532  
TEL: 630-969-4747  
[www.molex.com](http://www.molex.com)

PCN #	Molex Part #
508249	457140001
508249	457190005
508249	457190007
508249	457190008
508249	457190009
508249	458440004
508249	459110001
508249	459110007
508249	459110012
508249	459110025
508249	459120007
508249	459120027
508249	459120027