

spec ref	-			dr	Laurence Zang	2017/07/28	projection	MM	size	A3	scale	10:1
tolerance std	TOLERANCES UNLESS OTHERWISE SPECIFIED			eng	Laurence Zang	2017/08/24			ecn no		-	
ISO 406				chr	-	-			rel level		Released	
ISO 1101				appr	Tim Yao	2017/08/24	product family					
surface	linear	0.X	±0.30	Amphenol FCI www.fci.com			title 0.5Pitch BTB CONN. PLUG		dwg no 10144851		rev A	
		0.XX	±0.20									
		0.XXX	±0.10									
ISO 1302	angular	0°	±2°	cat. no.			Product - Customer Drw		sheet 1 of 2			

NOTES:

1. HOUSING MATERIAL: HIGH TEMP PLASTIC UL94 V-0 BLACK
2. TERMINAL MATERIAL: COPPER ALLOY
3. PLATING SEE PRODUCT DESCRIPTION
4. PACKING: 24MM WIDTH CARRIER TAPE & REEL W/O PICK-UP CAP
5. PRODUCT SPEC: GS-12-1298
6. (SPC) MARKED ARE SPEC DIMENSION, NEED TO MEET CPK 1.50
7. THIS PRODUCT MEETS EUROPEAN UNION DIRECTIVES AND OTHE COUNTRY REGULATIONS AS DESCRIPED IN GS-22-008
8. THE HOUSING WILL WITHSTAND EXPOSURE TO 260°C TEMPERATURE FOR 40 SECONDS IN A CONVENCTION OR VAPOR PHASE REFLOW OVEN

10144851-AA B C D E LF

AA	POSITION
05	50

B	DESCRIPTION
1	MATING HEIGHT: 3MM MATING WITH 10144852-051XXXLF

D	LOCATOR	HOLD DOWN
0	NO	NO

E	PACKAGE
0	TAPE AND REEL W/O CAP

SEE NOTE 4

C	PLATING OPTION ON CONTACT AREA AND SOLDER AREA
1	CONTACT AREA: 2U" MIN. AU PLATING OVER 15U" MIN. PA-NI PLATING SOLDER AREA: 2U" MIN AU PLATING UNDER PLATING: NICKEL PLATING

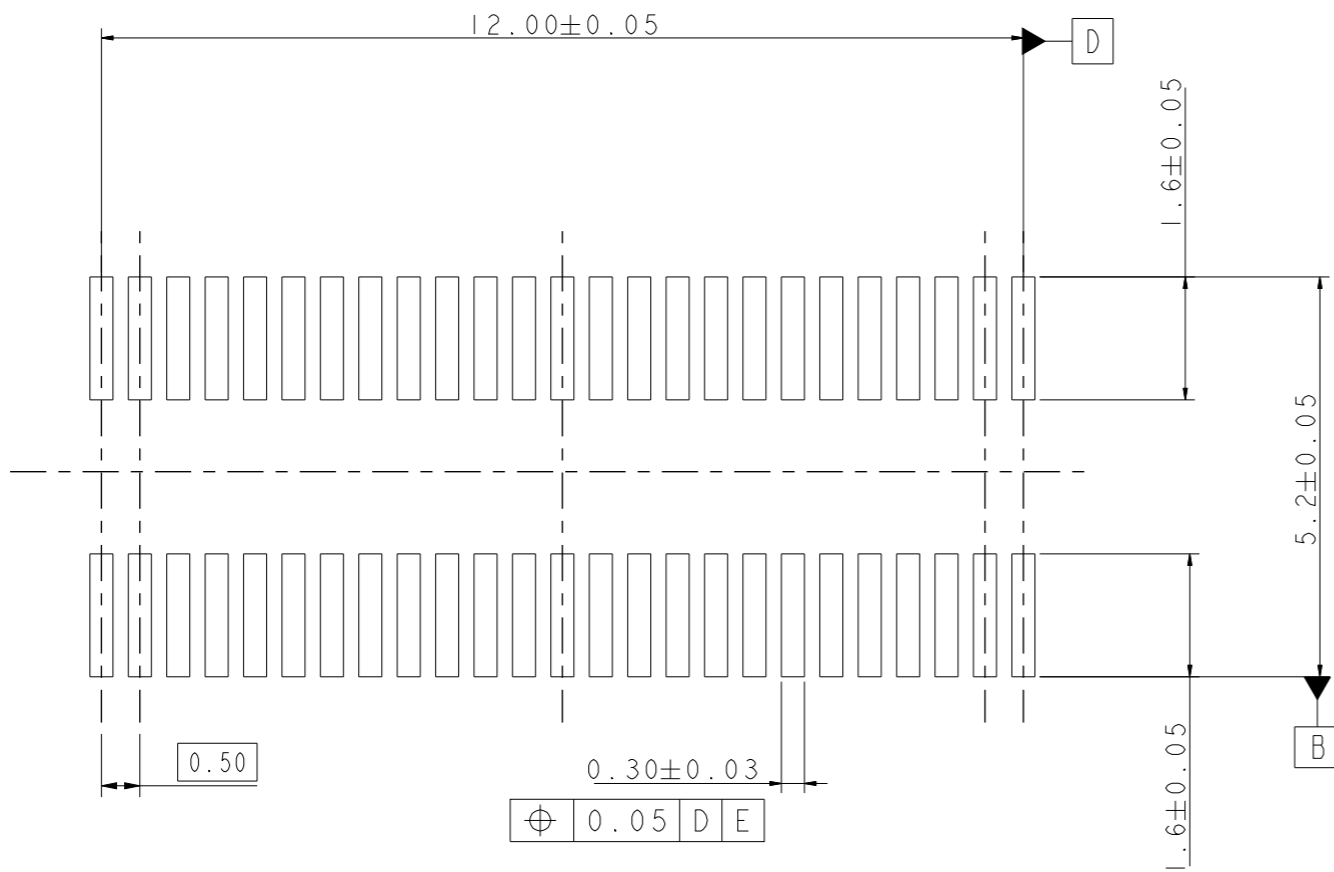

RECOMMENDED PCB LAY-OUT

spec ref	-	dr	Laurence Zang	2017/07/28	projection	MM	size	A3	scale	10:1
tolerance std	ISO 406 ISO 1101	eng	Laurence Zang	2017/08/24			ecn no		rel level	
TOLERANCES UNLESS OTHERWISE SPECIFIED		chr	-	-			-		Released	
surface	linear	appr	Tim Yao	2017/08/24	product family		0.5Pitch BTB CONN.		dwg no	10144851
	angular				PLUG				rev	A
ISO 1302	0.X ±0.30 0.XX ±0.20 0.XXX ±0.10 0° ±2°	www.fci.com		cat. no.	Product - Customer Drw			sheet 2 of 2		