

| REVISIONS |     |                  |           |            |
|-----------|-----|------------------|-----------|------------|
| REV       | ECO | DESCRIPTION      | DATE      | BY APPR    |
| A1        | -   | RELEASED DRAWING | Jul-16-18 | Flan Tommy |

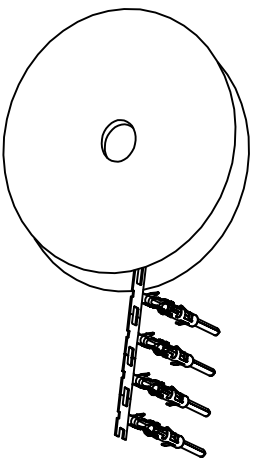

CONTACT ORIENTATION ON ROLL(3000PCS/COIL)

NOTES : (UNLESS OTHERWISE SPECIFIED)

- MATERIAL :
  - CONTACT BODY : COPPER ALLOY.
  - OUTER SPRING : STAINLESS STEEL.
- SPECIFICATIONS :
  - CURRENT RATING : 13A MAX.
  - TERMINATION TYPE : CRIMPING.
  - WIRE RANGE : 22~20AWG.
  - WIRE INSULATION DIA(MAX) :  $\phi$ 2.5mm.
- RoHS COMPLIANT.
- ALL DIMENSIONS ARE FOR REFERENCE USE ONLY.
- AVAILABLE TOOLS :
  - HAND CRIMPER : MFX-3954.
  - CRIMP APPLICATOR : MFX-3957.
  - EXTRACTION TOOL : QXRT16.

| P/N       | CONTACT PLATING(MATING AREA)        |
|-----------|-------------------------------------|
| SP20M2T   | TIN PLATING OVER NICKEL.            |
| SP20M2N   | NICKEL PLATING OVER COPPERIZE.      |
| SP20M2F   | GOLD FLASH PLATING OVER NICKEL.     |
| SP20M2G5  | 5 $\mu$ "GOLD PLATING OVER NICKEL.  |
| SP20M2G10 | 10 $\mu$ "GOLD PLATING OVER NICKEL. |
| SP20M2G15 | 15 $\mu$ "GOLD PLATING OVER NICKEL. |
| SP20M2G30 | 30 $\mu$ "GOLD PLATING OVER NICKEL. |

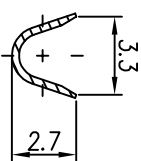
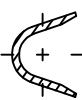
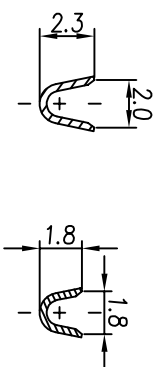
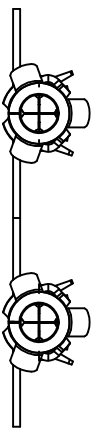
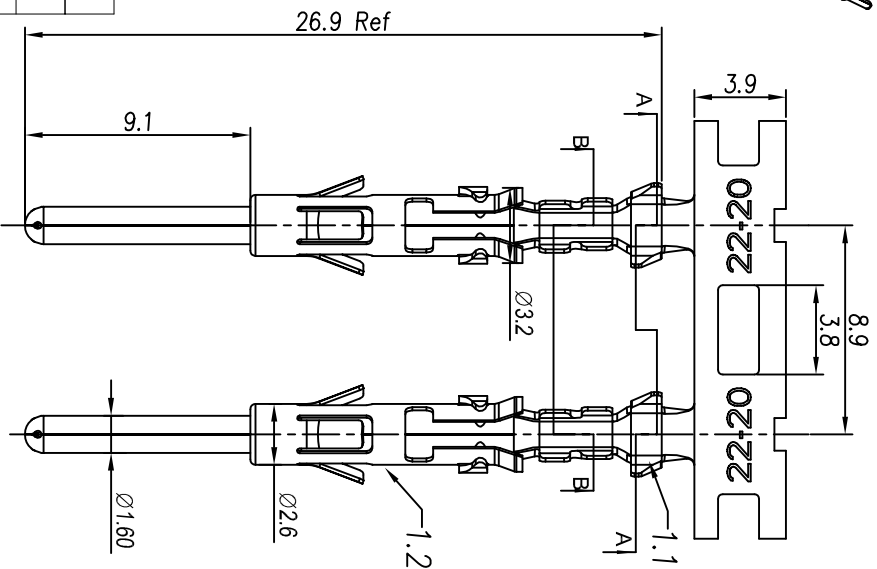

SECTION A-A

SECTION B-B

| QUANTITY | PART NUMBER | DESCRIPTION | ITEM |
|----------|-------------|-------------|------|
|          |             |             |      |

| UNLESS OTHERWISE SPECIFIED   |                        |           |  |
|--|------------------------|-----------|--|
| 1) All dimensions are in millimeters.  | SIGNATURES             | DATE      |  |
| 2) Tolerances are as follows: 0.01mm, 0.05mm, 0.1mm, 0.2mm, 0.5mm, 1.0mm, 1.5mm, 2.0mm, 3.0mm, 4.0mm, 5.0mm, 6.0mm, 8.0mm, 10.0mm, 15.0mm, 20.0mm, 30.0mm, 40.0mm, 50.0mm, 60.0mm, 80.0mm, 100.0mm, 150.0mm, 200.0mm, 300.0mm, 400.0mm, 500.0mm, 600.0mm, 800.0mm, 1000.0mm. | DRAWN: Flan            | Jul-16-18 |  |
| 3) Note reference = $\Delta$   | CHECKED: Tod           | Jul-16-18 |  |
|  | ENGINEER: Tommy        | Jul-16-18 |  |
|  | APPROVAL: Tommy        | Jul-16-18 |  |
|  | CUSTOMER: Sine Systems |           |  |

| MATERIAL SPECIFICATIONS              |  |  |  |
|--------------------------------------|--|--|--|
| PROCESS SPECIFICATIONS:              |  |  |  |
| NEXT ASSY:                           |  |  |  |
| MATERIAL SPECIFICATIONS:             |  |  |  |
| TEST SPECIFICATIONS:                 |  |  |  |
| SPECIFICATIONS AND PERFORMANCE DATA: |  |  |  |
| REVISIONS:                           |  |  |  |
| SCALE: NONE                          |  |  |  |
| SHEET 1 OF 1                         |  |  |  |

**Amphenol**  
Sine Systems - www.amphenol-sine.com  
44724 Morley Drive  
Clinton Township, MI 48036

ECO-MATE PIN CONTACT.  
STAMPED.22-20AWG.SIZE 16