

MOLEX LOGO

CKT NO.

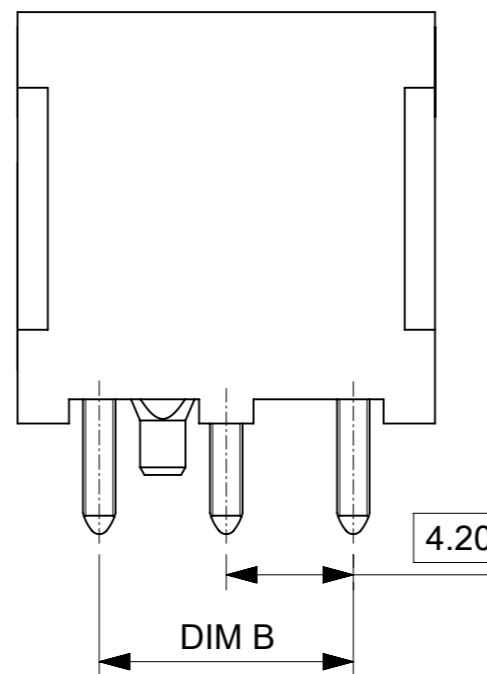
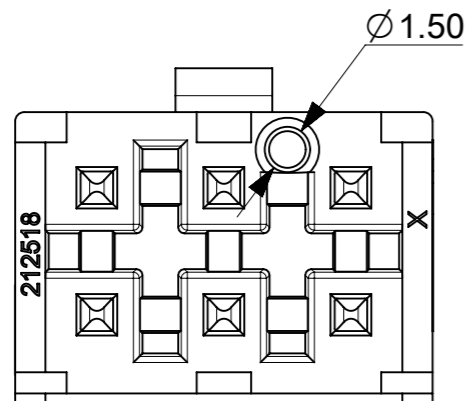
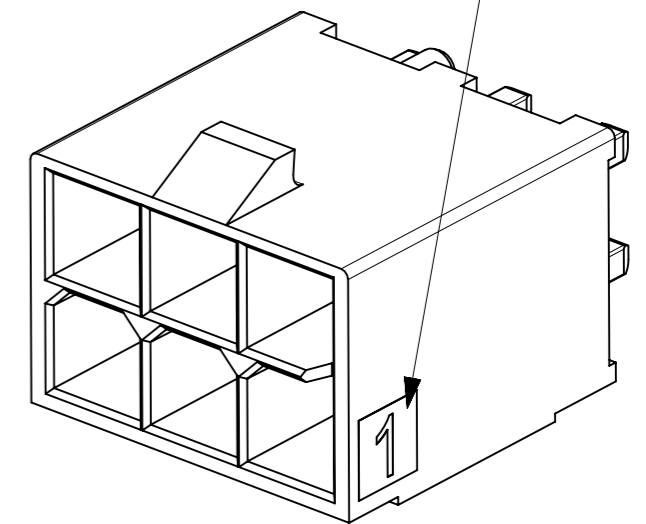

NOTES:

- MATERIALS:  
HOUSING - LCP UL94V-0, COLOR: SEE CHART  
TERMINAL - COPPER ALLOY
- TERMINAL PLATING: TIN OVER NICKEL OVERALL.
- PRODUCT SPECIFICATION: 2125150000-PS.
- PACKAGING SPECIFICATION: TRAY PACK PER: 212520001-PK
- PART MATES WITH MINI-FIT MAX RECEPTACLE SERIES 212514.
- DISCOLORIZATION IN THE BANDOLIER CARRIER AREA OF THE PIN IS INHERENT TO THE PLATING PROCESS AND IS DUE TO THE MASKING EFFECT OF THE CARRIER. THIS DISCOLORIZATION IS A NON-FUNCTIONAL AREA OF THE PIN AND WILL NOT AFFECT THE PERFORMANCE OF THE HEADER ASSEMBLY.
- CONNECTORS ARE NOT TO BE MATED OR UNMATED WHILE CIRCUITS ARE LIVE.
- PARTS ARE NOT DESIGNED FOR CURRENT SHARING.
- THIS PART CONFORMS TO CLASS "B" REQUIREMENTS OF COSMETIC SPECIFICATION PS-45499-002.
- TEXT ON PART IS FOR REFERENCE ONLY. TEXT AND TEXT LOCATION MAY VARY DEPENDING ON PART NUMBER AND/OR TOOL.

FUNCTIONAL SYMBOLS	THIS DRAWING CONTAINS INFORMATION THAT IS PROPRIETARY TO MOLEX ELECTRONIC TECHNOLOGIES, LLC AND SHOULD NOT BE USED WITHOUT WRITTEN PERMISSION		CURRENT REV DESC:		<b>molex</b>
	MM	SCALE			
FA = 0	mm	4:1			MINI-FIT MAX DR HDR VERTICAL VERT. HEADER ASSY 2-12 CKT
FE = 0	GENERAL TOLERANCES (UNLESS SPECIFIED)				
FE = 0	ANGULAR TOL ± °				PRODUCT CUSTOMER DRAWING
FE = 0	4 PLACES ±				
DIVISIONAL SYMBOLS	3 PLACES ±		EC NO: 679543		DOCUMENT NUMBER
	2 PLACES ± 0.25		DRWN: ZIXUAQ 2021/09/28		
	1 PLACE ± 0.5		CHK'D: XQZHANG 2021/09/29		DOC PART
	0 PLACES ±		APPR: XQZHANG 2021/09/29		
	DRAFT WHERE APPLICABLE MUST REMAIN WITHIN DIMENSIONS		INITIAL REVISION:		2125200001-SD
THIRD ANGLE PROJECTION		DRWN: SCHEN76 2020/04/24		PSD	
DRAWING		APPR: YXZHENG 2020/05/13		000	B1
A3-SIZE		SERIES		GENERAL MARKET	SHEET NUMBER
212520		MATERIAL NUMBER		SEE TABLE	1 OF 2
		CUSTOMER		GENERAL MARKET	

TIN PLATING				
CKT SIZE	PART NO.	DIM A	DIM B	DIM C
2	212520-1002	5.40	NA	NA
4	212520-1004	9.60	4.2	2.10
6	212520-1006	13.80	8.40	4.20
8	212520-1008	18.00	12.60	6.30
10	212520-1010	22.20	16.80	8.40
12	212520-1012	26.40	21.00	10.50

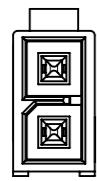

2 CKT

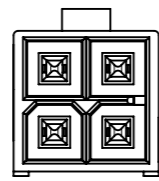

4 CKT

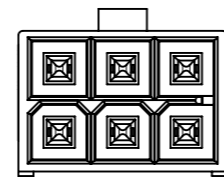

6 CKT

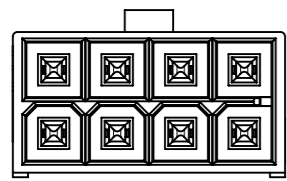

8 CKT

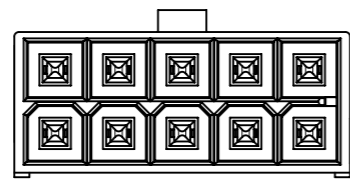

10 CKT

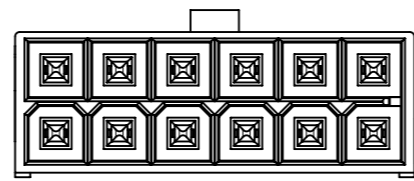

12 CKT

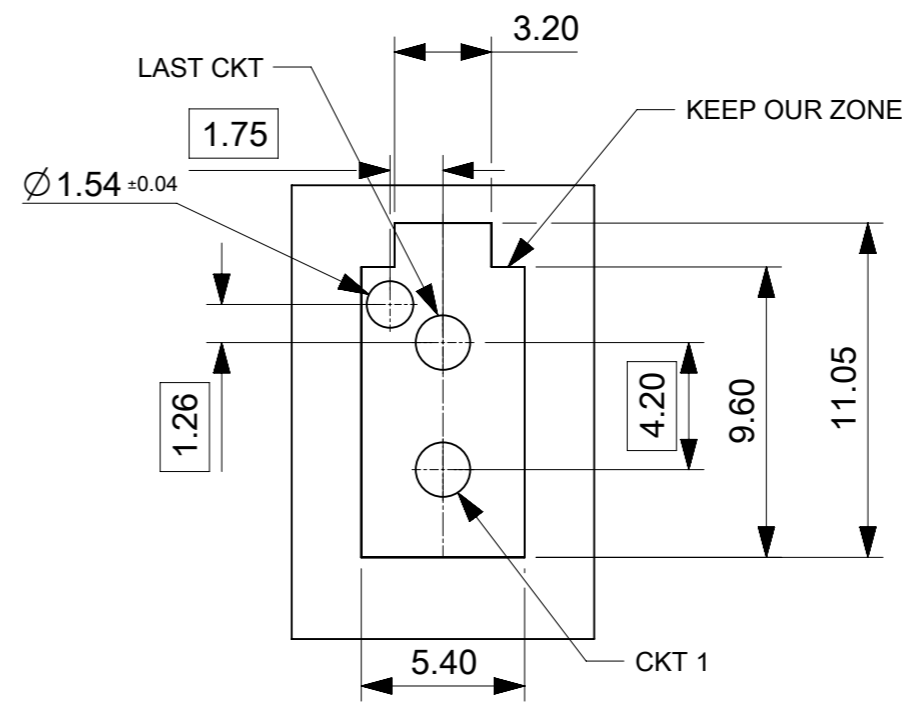
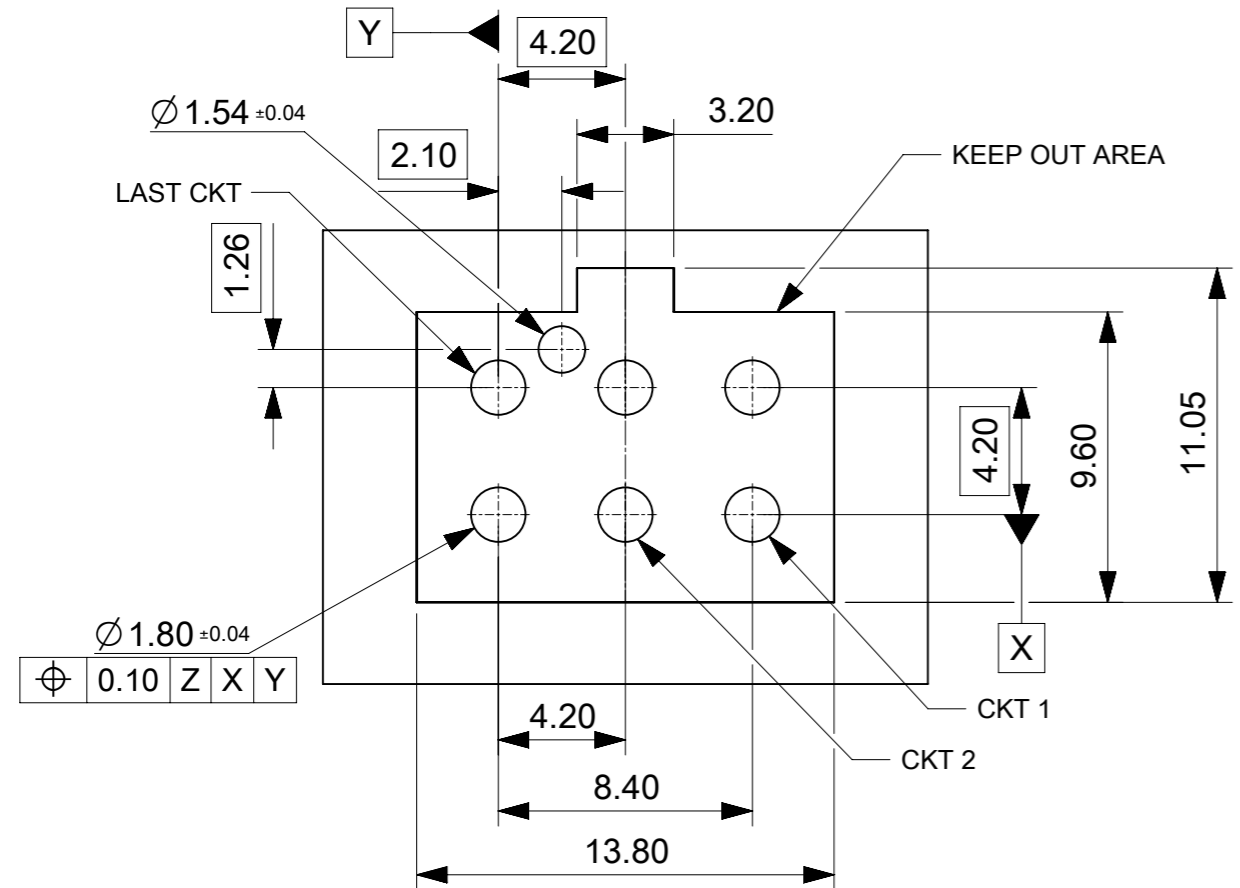

FOR 4 TO 12CKTS

PCB LAYOUT COMPONENT SIDE  
RECOMENDED PCB THICKNESS 1.60MM-2.40MM

NOTE: DATUM -Z- IS ON PCB COMPONENT SIDE

FOR 2CKTS

FUNCTIONAL SYMBOLS	THIS DRAWING CONTAINS INFORMATION THAT IS PROPRIETARY TO MOLEX ELECTRONIC TECHNOLOGIES, LLC AND SHOULD NOT BE USED WITHOUT WRITTEN PERMISSION	CURRENT REV DESC:		<b>molex</b>																																																		
	<table border="1"> <tr> <th>FUNCTIONAL SYMBOLS</th> <th>DIMENSION UNITS</th> <th>SCALE</th> </tr> <tr> <td><math>\nabla_A = 0</math></td> <td>mm</td> <td>4:1</td> </tr> <tr> <td colspan="3">GENERAL TOLERANCES (UNLESS SPECIFIED)</td> </tr> <tr> <td><math>\nabla_E = 0</math></td> <td colspan="2">ANGULAR TOL ± °</td> </tr> <tr> <td><math>\nabla_F = 0</math></td> <td>4 PLACES</td> <td>±</td> </tr> <tr> <td rowspan="4">DIVISIONAL SYMBOLS</td> <td>3 PLACES</td> <td>±</td> </tr> <tr> <td>2 PLACES</td> <td>± 0.25</td> </tr> <tr> <td>1 PLACE</td> <td>± 0.5</td> </tr> <tr> <td>0 PLACES</td> <td>±</td> </tr> </table>	FUNCTIONAL SYMBOLS	DIMENSION UNITS		SCALE	$\nabla_A = 0$	mm	4:1	GENERAL TOLERANCES (UNLESS SPECIFIED)			$\nabla_E = 0$	ANGULAR TOL ± °		$\nabla_F = 0$	4 PLACES	±	DIVISIONAL SYMBOLS	3 PLACES	±	2 PLACES	± 0.25	1 PLACE	± 0.5	0 PLACES	±	<table border="1"> <tr> <td>EC NO: 679543</td> <td>2021/09/28</td> </tr> <tr> <td>DRWN: ZIXUAG</td> <td>2021/09/29</td> </tr> <tr> <td>CHK'D: XQZHANG</td> <td>2021/09/29</td> </tr> <tr> <td>APPR: XQZHANG</td> <td>2021/09/29</td> </tr> </table>		EC NO: 679543	2021/09/28	DRWN: ZIXUAG	2021/09/29	CHK'D: XQZHANG	2021/09/29	APPR: XQZHANG	2021/09/29	<table border="1"> <tr> <td colspan="3">INITIAL REVISION:</td> </tr> <tr> <td>DRWN: SCHEN76</td> <td>2020/04/24</td> <td></td> </tr> <tr> <td>APPR: YXZHENG</td> <td>2020/05/13</td> <td></td> </tr> </table>		INITIAL REVISION:			DRWN: SCHEN76	2020/04/24		APPR: YXZHENG	2020/05/13		<table border="1"> <tr> <th>DOCUMENT NUMBER</th> <th>DOC TYPE</th> <th>DOC PART</th> <th>REVISION</th> </tr> <tr> <td>2125200001-SD</td> <td>PSD</td> <td>000</td> <td>B1</td> </tr> </table>	DOCUMENT NUMBER	DOC TYPE	DOC PART	REVISION	2125200001-SD	PSD
FUNCTIONAL SYMBOLS	DIMENSION UNITS	SCALE																																																				
$\nabla_A = 0$	mm	4:1																																																				
GENERAL TOLERANCES (UNLESS SPECIFIED)																																																						
$\nabla_E = 0$	ANGULAR TOL ± °																																																					
$\nabla_F = 0$	4 PLACES	±																																																				
DIVISIONAL SYMBOLS	3 PLACES	±																																																				
	2 PLACES	± 0.25																																																				
	1 PLACE	± 0.5																																																				
	0 PLACES	±																																																				
EC NO: 679543	2021/09/28																																																					
DRWN: ZIXUAG	2021/09/29																																																					
CHK'D: XQZHANG	2021/09/29																																																					
APPR: XQZHANG	2021/09/29																																																					
INITIAL REVISION:																																																						
DRWN: SCHEN76	2020/04/24																																																					
APPR: YXZHENG	2020/05/13																																																					
DOCUMENT NUMBER	DOC TYPE	DOC PART	REVISION																																																			
2125200001-SD	PSD	000	B1																																																			
DRAFT WHERE APPLICABLE MUST REMAIN WITHIN DIMENSIONS		THIRD ANGLE PROJECTION	DRAWING	SERIES	MATERIAL NUMBER	CUSTOMER	SHEET NUMBER																																															
			A3-SIZE	212520	SEE TABLE	GENERAL MARKET	2 OF 2																																															