

MATERIALS AND FINISHES

BODY: BERYLLIUM COPPER
PLATED GOLD

CENTER CONTACT: BERYLLIUM COPPER
PLATED GOLD

INSULATOR: TEFLON

CRIMP TUBE: BRASS
PLATED NICKEL

EMI RING: BRASS
PLATED GOLD

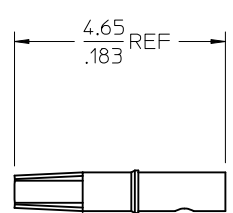
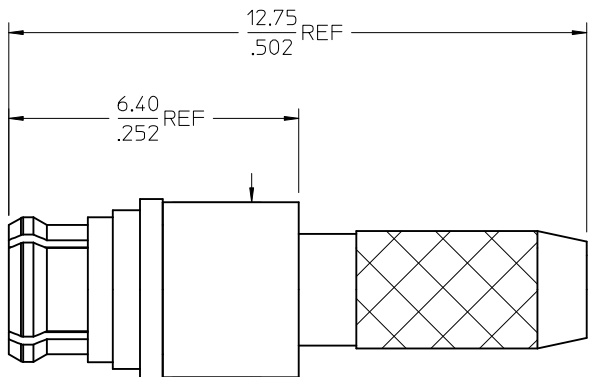
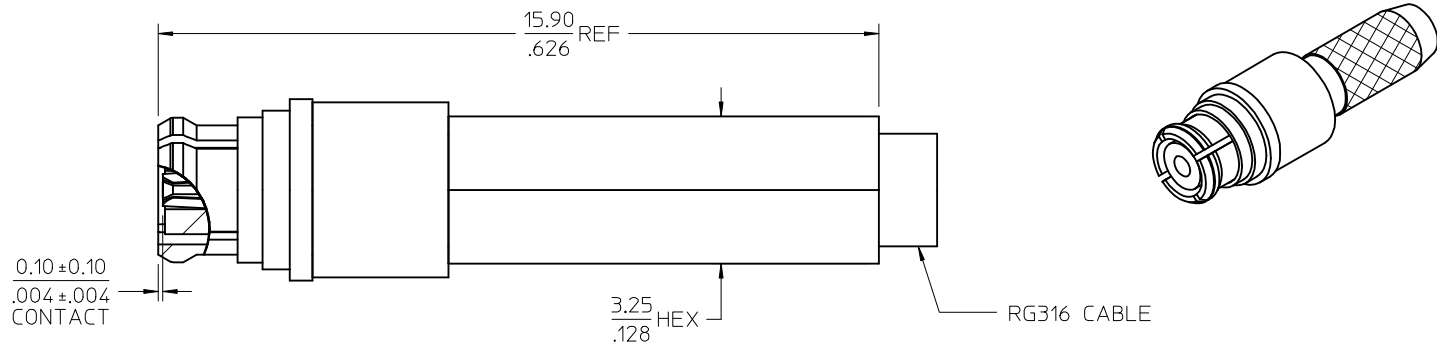

CENTER CONTACT

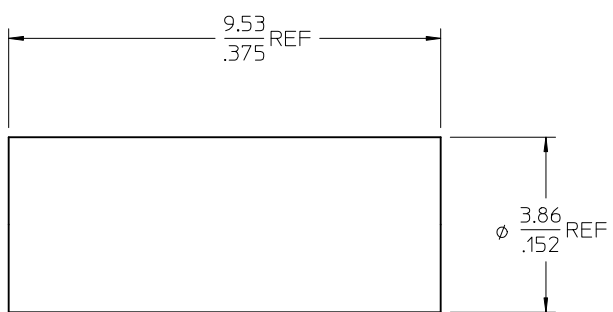

CRIMP TUBE

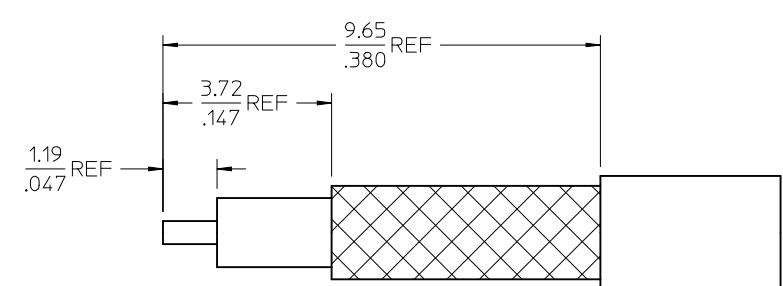

RECOMMENDED CABLE
STRIP DIMENSIONS

PART # 73415-4810

MIL-STD-348A, FIG. 326.1a	INTERFACE
SPECIFICATION	DESCRIPTION

CHG: UPDATE CONTACT DEPICTION EC NO: URF2010-0157 DRWN: WIENER 2009/09/21 CHKD: SHAH 2009/09/21 APPR: WIENER 2009/09/21	QUALITY SYMBOLS ▽=0 ▽=0	GENERAL TOLERANCES (UNLESS SPECIFIED) mm INCH 4 PLACES ± --- ± --- 3 PLACES ± --- ± --- 2 PLACES ± --- ± --- 1 PLACE ± --- ± --- ANGULAR ± 2°	DIMENSION STYLE MM/IN DRAWN BY DATE TEF 2006/11/27 CHECKED BY DATE SSS 2006/11/27 APPROVED BY DATE JDW 2006/11/27	SCALE DESIGN UNITS METRIC THIRD ANGLE PROJECTION	TITLE SMP JACK, STR, 50 OHMS FOR RG316 CABLE SMP-JC
		DRAFT WHERE APPLICABLE MUST REMAIN WITHIN DIMENSIONS	MATERIAL NO. 734154810	MOLEX INCORPORATED	SHEET NO. 1 OF 1
		SIZE C	THIS DRAWING CONTAINS INFORMATION THAT IS PROPRIETARY TO MOLEX INCORPORATED AND SHOULD NOT BE USED WITHOUT WRITTEN PERMISSION		
		A1	DOCUMENT NO. SD-73415-481		