



# TAI-SAW TECHNOLOGY CO., LTD.

No. 3, Industrial 2nd Rd., Ping-Chen Industrial District,  
Taoyuan, 324, Taiwan, R.O.C.

TEL: 886-3-4690038 FAX: 886-3-4697532

E-mail: [tstsales@mail.taisaw.com](mailto:tstsales@mail.taisaw.com) Web: [www.taisaw.com](http://www.taisaw.com)

## Approval Sheet For Product Specification

Issued Date:

Product Name: SAW IF Filter 130.06 MHz

TST Parts No.: TB0682A ( package 5.0mm x7.0 mm )

Customer Parts No.: \_\_\_\_\_

Company: _____
Division: _____
Approved by : _____
Date: _____

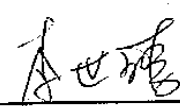
Checked by: \_\_\_\_\_ Kazuma Lee 

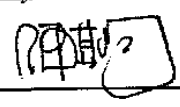
Approval by: \_\_\_\_\_ Francis Chen 

Date: \_\_\_\_\_ 04 / 06 / 2009



# TAI-SAW TECHNOLOGY CO., LTD.

No. 3, Industrial 2nd Rd., Ping-Chen Industrial District,  
Taoyuan, 324, Taiwan, R.O.C.

TEL: 886-3-4690038 FAX: 886-3-4697532

E-mail: [tstsales@mail.taisaw.com](mailto:tstsales@mail.taisaw.com) Web: [www.taisaw.com](http://www.taisaw.com)

IF SAW Filter 130.06MHz(BW=160KHz) SMD 5.0X7.0mm

MODEL NO.: TB0682A

REV. NO.1

## A. MAXIMUM RATING:

1. Operating Temperature: -10 °C ~ 50 °C
2. Storage Temperature: -40 °C ~ +85 °C
3. Input Power Level : 10 dBm

RoHS Compliant  
Lead free  
Lead-free soldering

## B. Characteristics :

1. Ambient Temperature: 25 °C

Characteristics	Value			Note
	Min.	Typ.	Max.	
Center frequency FC MHz	-	130.06	-	-
Minimum Insertion loss I.L. dB	-	7.3	8.5	-
1 dB Bandwidth KHz	-	167	-	-
3 dB Bandwidth KHz	160	239	250	-
40 dB Bandwidth KHz	-	692	850	-
Passband Ripple Fc ± 40KHz dB	-	0.4	1.0	-
Temp Coefficient ppm/K <sup>2</sup>	-	-0.036	-	-

## C. Frequency Characteristics :

### 1. S21 Response

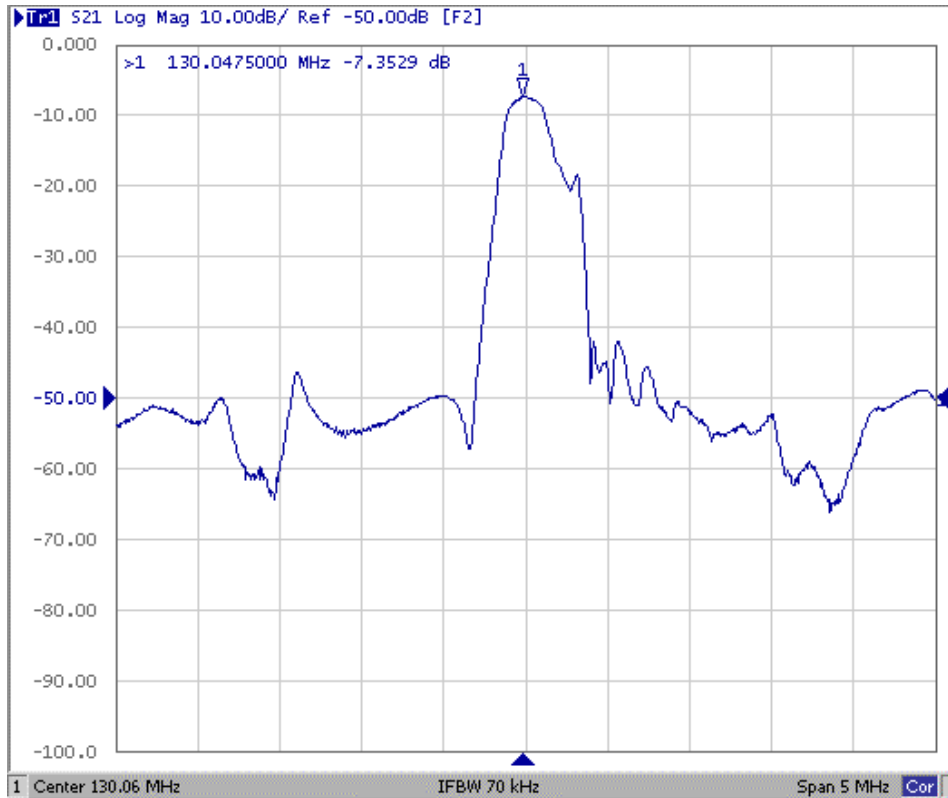

Fig1. Horizontal: 0.5MHz/Div Vertical: 10dB/Div

### 2. Passband Response and Group Delay Response

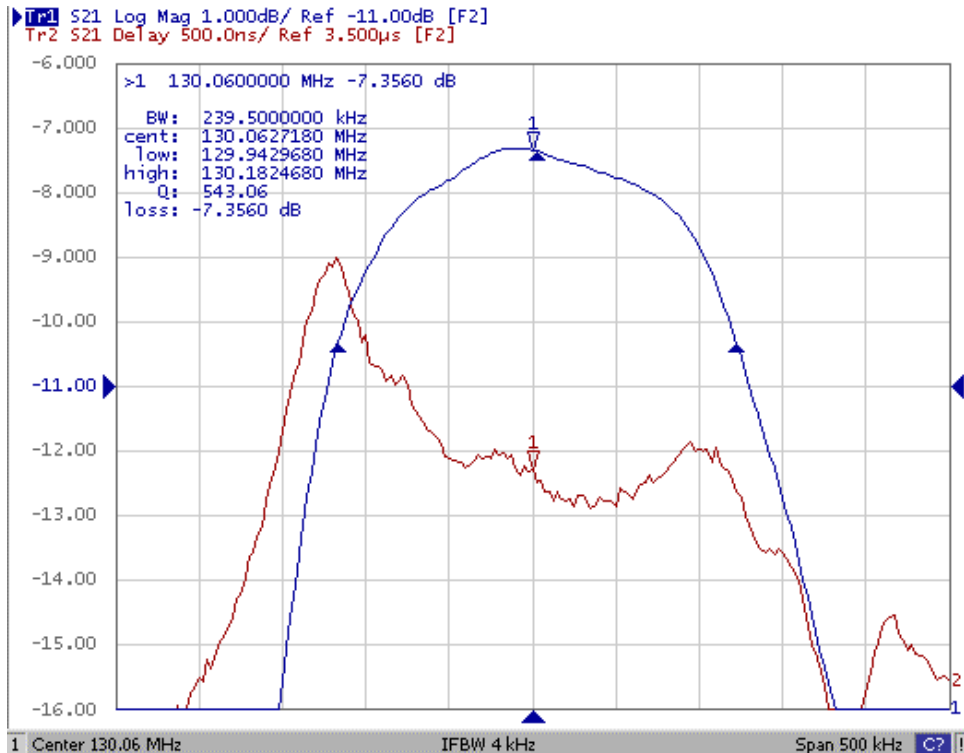
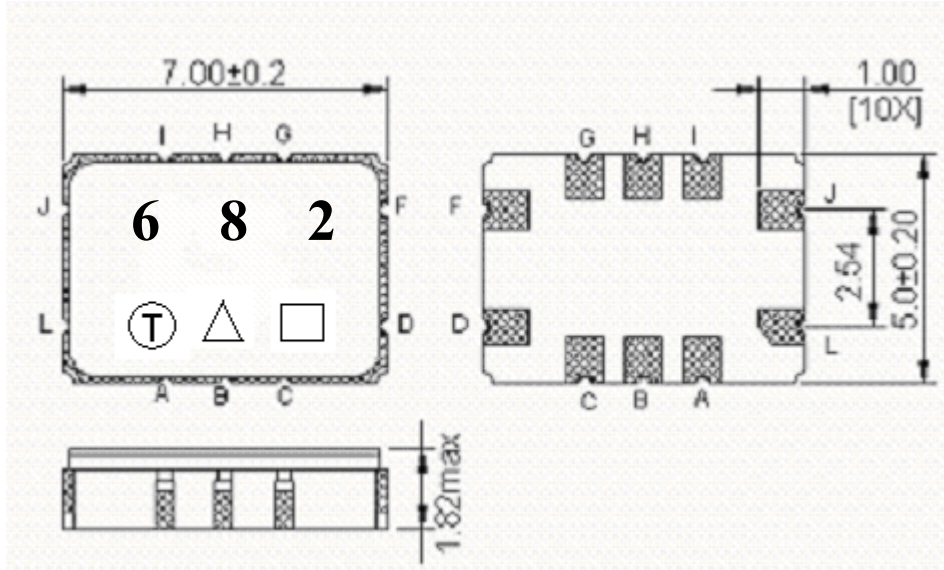

Fig2. Horizontal: 0.05MHz/Div Vertical 1: 1dB/Div  
Vertical 2: 500nS/Div

**D. Outline Drawing:**



Pin J –RF input

Pin L –RF input ground

Pin D –RF output

Pin F –RF output ground

Pin A,B,C,G,H,I - Ground

□ : Week Code (Follow the table from planner each year)

Unit : mm

△ : Product / Year Code

Year	2005 2009	2006 2010	2007 2011	2008 2012
Product Code	B	b	<u>B</u>	<u>b</u>

**E. Matching Circuit:**

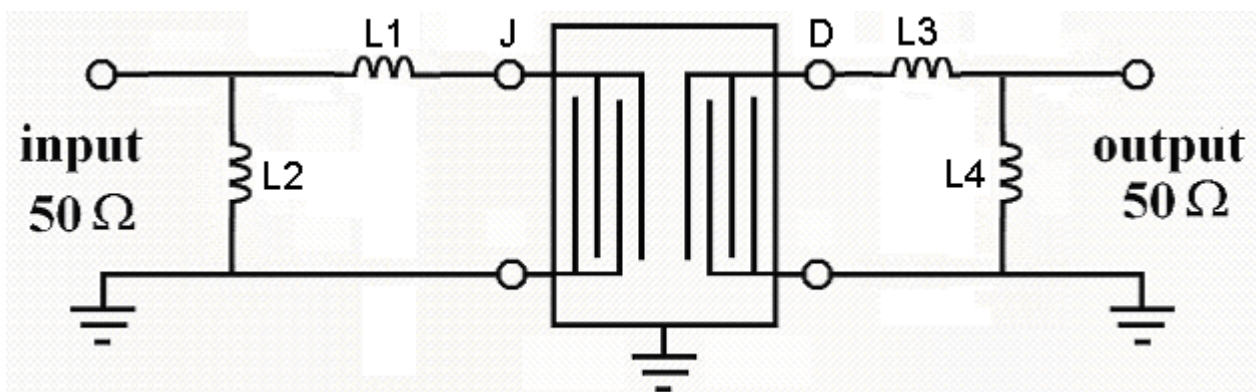

L1=130nH, L2=56pF, L3=127nH, L4=56pF

**F. PCB Footprint:**

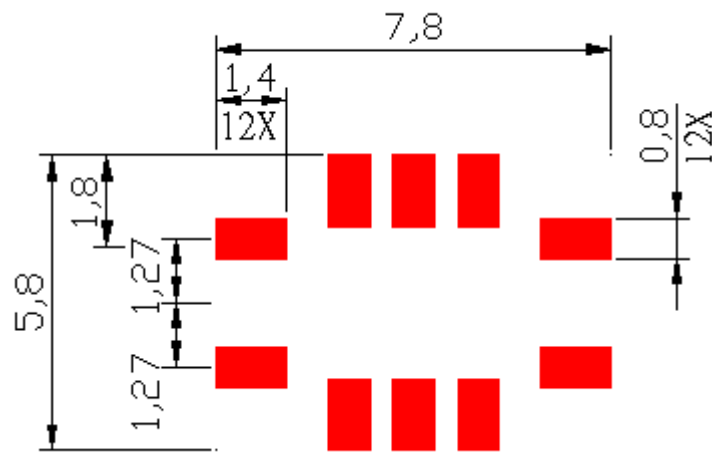

**G. Packing:**

1. Reel Dimension

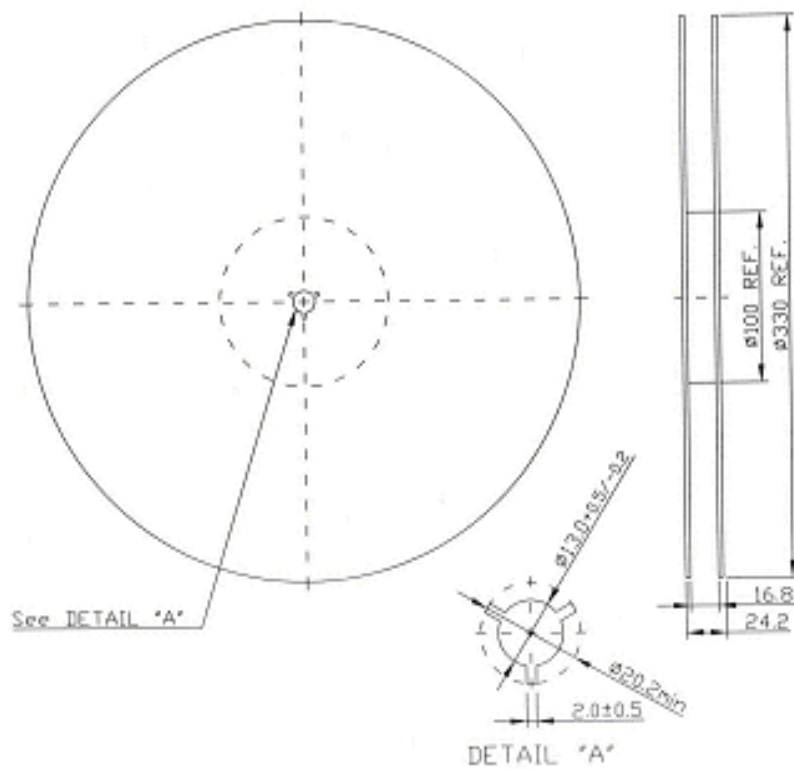

## 2. Tape Dimension

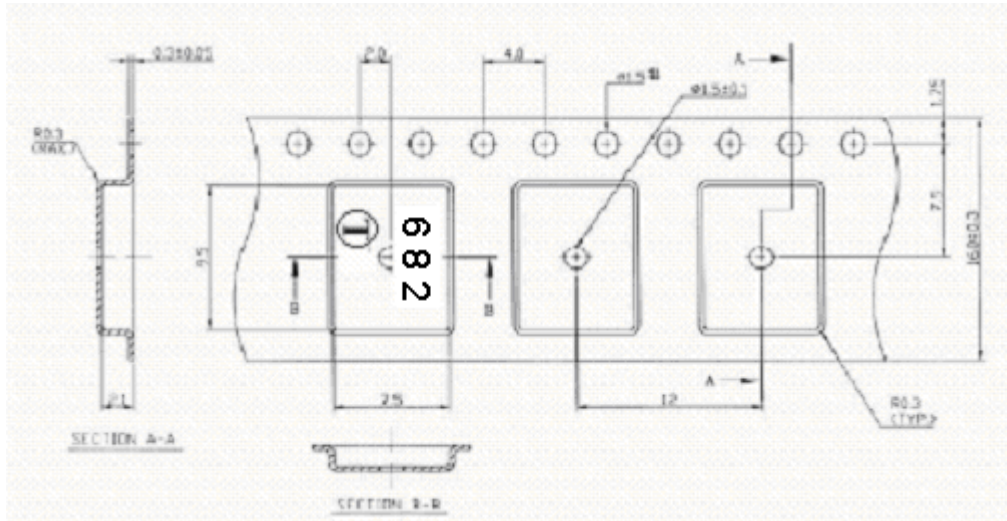

## H. RECOMMENDED REFLOW PROFILE :

