

- 1 RECOMMENDED SPARE PARTS.
- 2 ITEMS NOT SHOWN.
- 3 ONLY QUALIFY 3(18) DURING SET-UP.
- 4 SEE TERMINAL CUSTOMER DRAWING FOR WIRE RANGE AND CRIMP HEIGHTS.

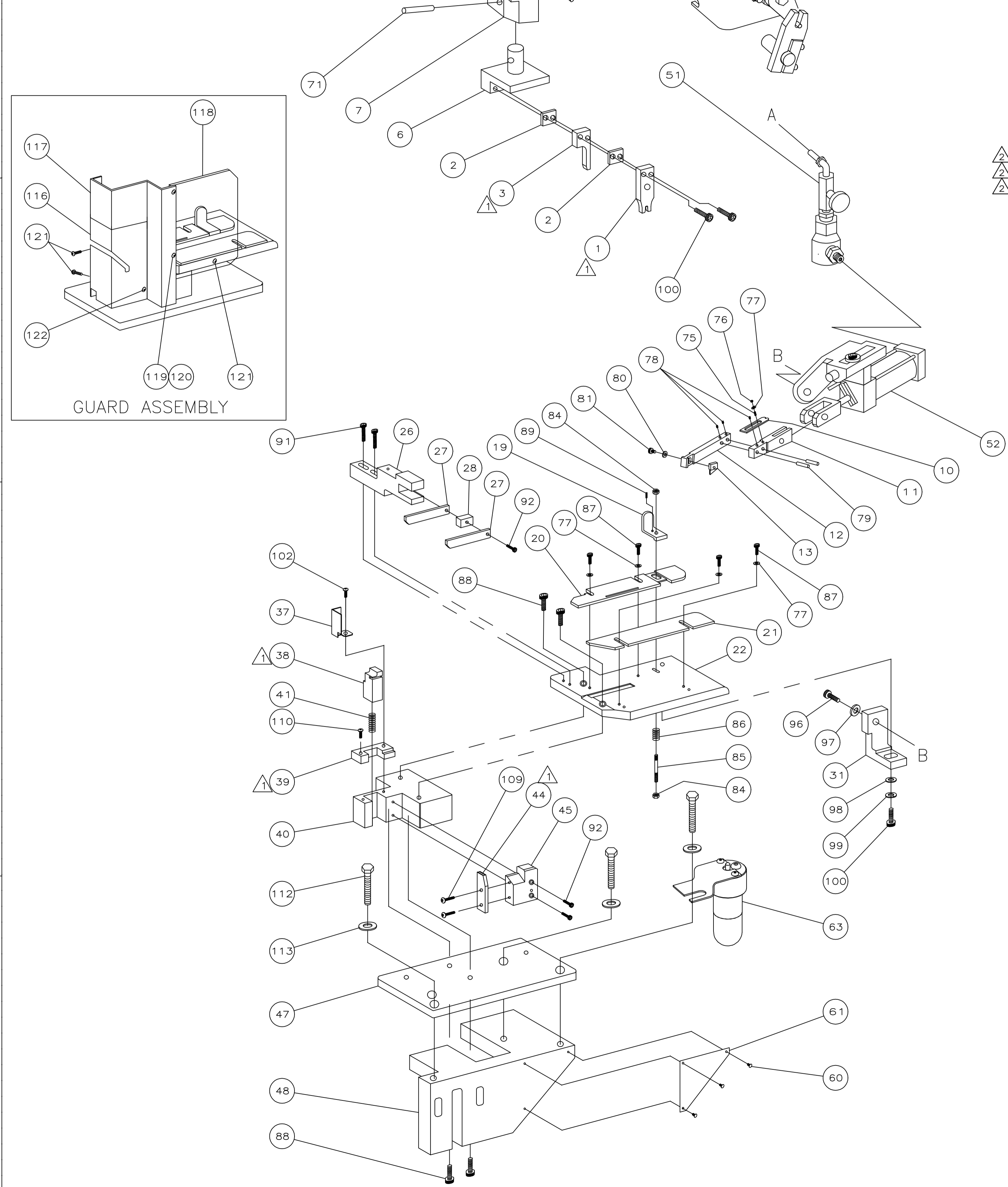

TERMINAL NAME:		CRIMPING DATA			
SPLICE		CRIMP HEIGHT		WIRE SIZE	
485043		.087±0.02		(3) #18	
		.077±0.02		(3) #20	
		-		-	
		-		-	
CRIMP	SIZE	TYPE	RANGE		
WIRE	.140		CMA 3000-8400		
INSUL	-	-	-		
FEED	APPL INST	SET UP GAGE	LAYOUT		
	A1 408-8012	-	-		
WIRE STRIP LENGTH .280-.320					
TERM APPL SPEC 114-2088					

QTY	REV	DESCRIPTION	ITEM NO
1	-	B 815933-1 MOUNT, REEL BRACKET	125
1	-	B 461903-1 BRACKET, AIR SWITCH SHROUD	124
1	-	C 461904-1 SHROUD, AIR SWITCH	123
1	-	A 2-21002-2 BHCS, 8-32 x .50	122
5	-	A 2-21002-0 BHCS, 8-32 x .25	121
2	-	A 21018-4 NUT, 4-40	120
2	-	A 1-21002-3 BHCS, 4-40 x .25	119
1	-	B 816303-2 SIDE GUARD	118
1	-	D 768494-1 TOP GUARD	117
1	-	B 768562-1 GUARD ASSEMBLY	116
-	-	-	115
-	-	-	114
3	-	A 371178 BASE MOUNT WASHER	113
3	-	A 3-21015-1 SCR, HEX HD 3/8-16 X 1.00	112
-	-	-	111
1	-	A 1-21002-9 SCR, BHC 6-32 x .62	110
2	-	A 2-21002-1 SCR, BHC 8-32 X .38	109
-	-	-	108
-	-	-	107
-	-	-	106
-	-	-	105
-	-	-	104
-	-	-	103
1	-	A 2-21002-4 SCR, BHC 8-32 X .75	102
-	-	-	101
3	-	A 21001-6 SCR, SHC 1/4-20 X 1.00	100
1	-	A 21024-6 WASHER, LOCK #1/4	99
1	-	A 21055-8 WASHER, FLAT #1/4	98
1	-	A 21024-8 WASHER, LOCK #3/8	97
1	-	A 3-21001-6 SCR, SHC 3/8-16 X 1.25	96
-	-	-	95
-	-	-	94
-	-	-	93
3	-	A 2-21000-8 SCR, SHC 8-32 X .63	92
2	-	A 3-21000-0 SCR, SHC 8-32 X .88	91
-	-	-	90
1	-	A 3-21008-0 SCR,SET SELF-LOC 6-32 X .32	89
4	-	A 21001-3 SCR,SHC 1/4-20 X .62	88
4	-	A 2-21000-7 SCR, SHC 8-32 X .50	87
1	-	A 373469 STOCK DRAG SPRING	86
1	-	B 370573 DRAG STUD	85
2	-	A 21021-4 NUT,HEX, SELF-LOC 10-32	84
-	-	-	83
-	-	-	82
1	-	A 2-21000-6 SCR, SHC 8-32 X .38	81
1	-	A 21024-4 WASHER, LOCK #8	80
2	-	A 1-21030-5 FEED FINGER PIN, DOWEL	79
3	-	A 3-21006-8 SCR,SET 8-32 X .25	78
5	-	A 21055-6 WASHER, FLAT #8	77
1	-	A 21018-6 NUT, JAM 8-32	76
1	-	A 4-21006-4 SCR, SET 8-32 X .50	75
-	-	-	74
-	-	-	73
1	-	A 2-21549-3 SCR,SET SELF-LOC 1/4-20 X .50	72
1	-	A 6-21029-9 PIN,SLOTTED SPR .312 X 1.50	71
-1	U/M	DWG SIZE PART NO DESCRIPTION ITEM NO	
REVISION OF EACH ASSY NO (WHEN BLANK, USE DWG REVISION)			

QTY	REV	DESCRIPTION	ITEM NO
-	-	-	70
-	-	-	69
-	-	-	68
-	-	-	67
-	-	-	66
-	-	-	65
-	-	-	64
1	-	D 1-465184-9 LUBRICATOR ASSY	63
-	-	-	62
1	-	B 452373-1 PLATE I.D.	61
3	-	A 21017-6 SCR, RH DRIVE	60
-	-	-	59
-	-	-	58
-	-	-	57
-	-	-	56
-	-	-	55
-	-	-	54
-	-	-	53
1	-	B 692653-1 AIR FEED CYLINDER SUB-ASSY	52
1	-	C 692655-5 AIR FEED VALVE SUB-ASSY	51
-	-	-	50
-	-	-	49
1	-	C 570238 BASE MOUNT	48
1	-	B 465317-1 BASE PLATE	47
-	-	-	46
1	-	B 314893-3 ANVIL HOLDER	45
1	-	C 2-689722-3 ANVIL	44
-	-	-	43
-	-	-	42
1	-	A 387083 SHEAR SPRING	41
1	-	B 314835-1 BASE BLOCK	40
1	-	B 314892-1 SHEAR, PLATE	39
1	-	B 314891-1 SHEAR, FLOATING	38
1	-	B 314897-1 SHEAR, DEFLECTOR	37
-	-	-	36
-	-	-	35
-	-	-	34
-	-	-	33
-	-	-	32
1	-	B 815872-1 BRACKET, FEED MOUNTING	31
-	-	-	30
-	-	-	29
1	-	B 692968-1 SPACER, STRIPPER	28
2	-	A 314898-1 STRIPPER	27
1	-	B 692875-4 MOUNT, STRIPPER	26
-	-	-	25
-	-	-	24
-	-	-	23
1	-	B 815932-1 STRIP GUIDE PLATE	22
1	-	B 465320-5 FRONT STRIP GUIDE	21
1	-	B 465350-9 REAR STRIP GUIDE	20
1	-	B 387650-4 DRAG, STOCK	19
-	-	-	18
-	-	-	17
-	-	-	16
-	-	-	15
-	-	-	14
1	-	A 811645-1 TIP, FEED FINGER	13
1	-	B 811644-1 FINGER, FEED	12
1	-	A 810131 ARM, FEED FINGER	11
1	-	A 374999 TENSION ADJUSTING PLATE	10
-	-	-	9
-	-	-	8
1	-	B 471167 RAM	7
1	-	B 314894-1 TOOL HOLDER	6
-	-	-	5
-	-	-	4
1	-	B 314895-1 SHEAR DEPRESSOR	3
2	-	B 314896-1 SPACER	2
1	-	C 1803716-3 CRIMPER, MODIFIED STANDARD APPLICATOR	1
-1	U/M	DWG SIZE PART NO DESCRIPTION ITEM NO	
REVISION OF EACH ASSY NO (WHEN BLANK, USE DWG REVISION)			

MACHINE REF: STD APPL

THIS DRAWING IS A CONTROLLED DOCUMENT.

DIMENSIONS: INCHES	TOLERANCES UNLESS OTHERWISE SPECIFIED:	DWG NO: 1-25-93	DATE: 1/28/93
0 PLC ± .005	1 PLC ± .002	APPROVED: C. ERISMAN	NAME: BA WOLFE
1 PLC ± .002	2 PLC ± .001	DATE: 1/29/93	PRODUCT SPEC
3 PLC ± .001	4 PLC ± .0005	APPLICATION SPEC	SIZE: A1
ANGLES FINISH		WEIGHT	CAGE CODE: 00779
			DRAWING NO: 566376
			RESTRICTED TO: -
			CUSTOMER DRAWING
			SCALE: 1:4 SHEET 1 OF 1 REV: G

TE Connectivity
 STD APPL. (45 DEG ROTATED SPLICE)