

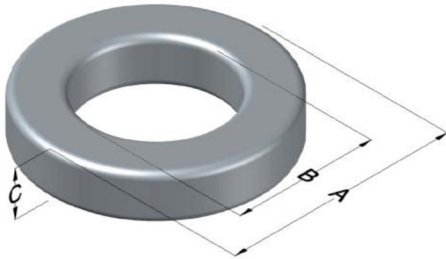

0077140A7

110 Delta Drive
 Pittsburgh, PA 15238
 NAFTA Sales: (1)800-245-3984
 HK Sales : (852)3102-9337
 magnetics@spang.com
 www.mag-inc.com



Kool M μ Permeability (μ)	A _L (nH/T ²)	Core Marking			Coating Color
		Lot Number	Part Number	Inductance Grade	
125	26 ± 15%	N/A	N/A	N/A	Black

Dimensions	Uncoated		Coated Limits			Packaging
	(mm)	(in)	(mm)	(in)		
OD (A)	3.56	0.140	4.19	0.165	max	Bulk Pack 5 vials/box Box Qty= 7500 pcs
ID (B)	1.78	0.070	1.27	0.050	min	
HT (C)	1.52	0.060	2.16	0.085	max	

Electrical Characteristics			Physical Characteristics						
Watt Loss @ 100 kHz, 100mT max(mW/cm ³)	DC Bias min (oersteds)		Voltage Breakdown wire to wire min (V _{AC})	Break Strength min (kg)	Window Area W _A (mm ²)	Cross Section A _e (mm ²)	Path Length L _e (mm)	Volume V _e (mm ³)	Weight (g)
	750	80%							
	14.0	35.0							

Winding Information					Temperature Rating		
Winding Length Per Turn				Wound Coil Dimensions (mm)		Curie Temp: 500°C	
Winding Factor	(mm)	Winding Factor	(mm)	40% Winding Factor		Coating Temp (Continuous up to): 200°C	
				OD	4.30	Notes:	
				HT	2.56		*No voltage breakdown min for A2 or A7 with OD ≤4.65mm
				Completely Full Window			
				Max OD	4.95		
0%	7.24	40%	7.89	Max HT	2.74		
20%	7.56	45%	7.98	Surface Area (mm ²)			
25%	7.65	50%	8.08	Unwound Core		60	
30%	7.70	60%	8.27	40% Winding Factor		70	
35%	7.81	70%	8.48				

