

THIS DOCUMENT IS THE PROPERTY OF KEYSTONE ELECTRONICS CORP. AND SHALL NOT BE REPRODUCED, DISTRIBUTED OR USED AS A BASIS FOR MANUFACTURE WITHOUT PRIOR WRITTEN PERMISSION FROM KEYSTONE ELECTRONICS CORP.

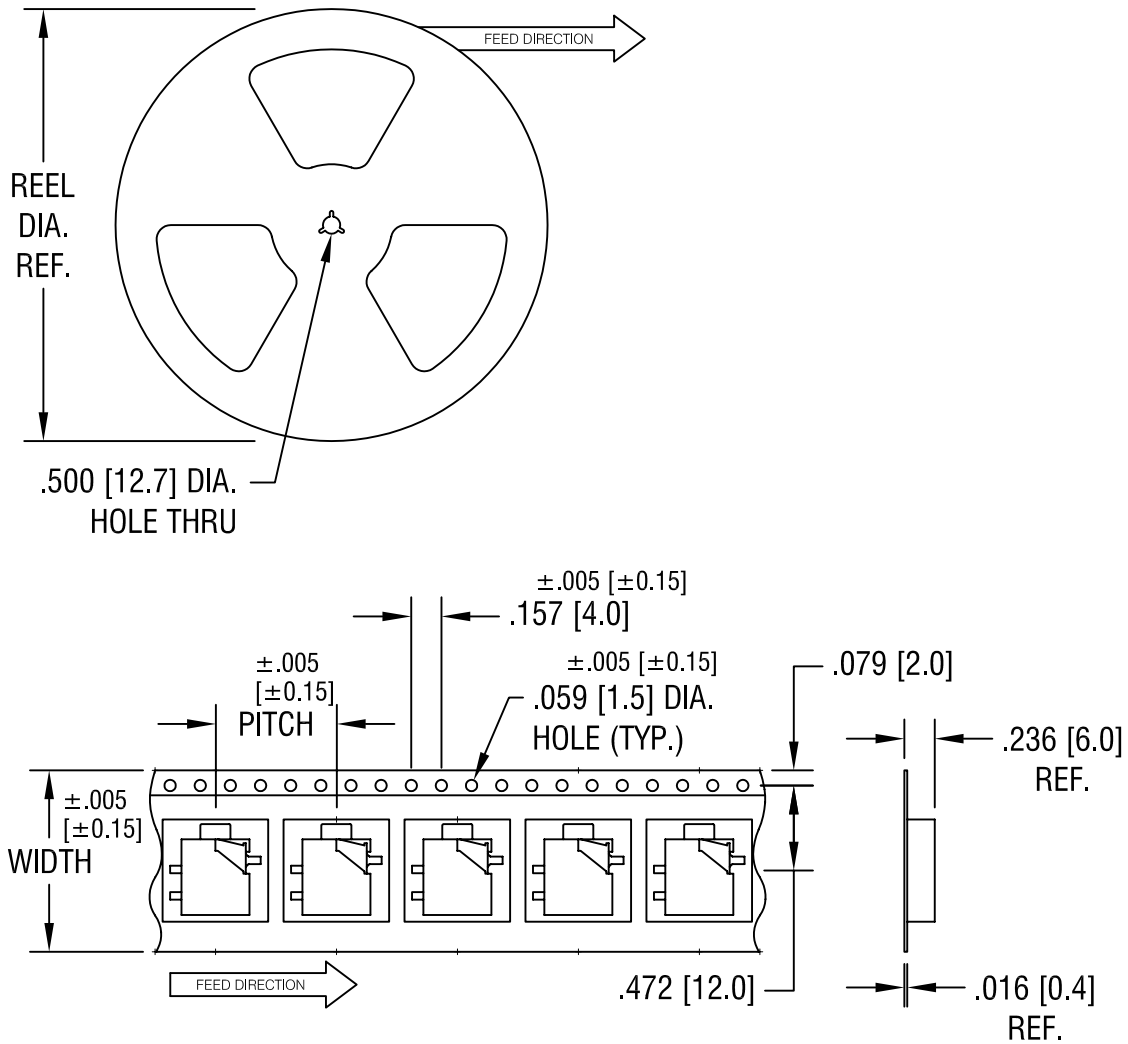

**NOTES:**

**TAPE AND REEL SPECIFICATIONS:**

1. TAPE:  
 MAT'L - ALL CONDUCTIVE POLYSTYRENE CARRIER  
 ANSI/EIA-481 STANDARD  
 .945 [24.0] WIDE; .630 [16.0] PITCH
2. REEL:  
 15.0 [381.0] DIA. 1000 PIECES OF  
 PART NO. 982 PER REEL.

<b>KEYSTONE ELECTRONICS CORP.</b>			
ASTORIA, N.Y. 11105-2017			
PART NAME			
2.5mm SM MONO JACK ON TAPE			
MATERIAL			
AS NOTED			
FINISH		DRN BY	DATE
AS NOTED		BOONE	2.28.00
		APP'D	SCALE
		LN	X
TOLERANCES	INCH [MM]	CODE	DWG NO.
DECIMAL	± .015 [± 0.38]	C/M	<b>982TR</b>
ANGULAR	± 1°		
UNLESS OTHERWISE SPECIFIED			

10.17.06	CHANGE AS PER ECN 06-066	A
DATE	DESCRIPTION	REV.

THIS DOCUMENT IS THE PROPERTY OF KEYSTONE ELECTRONICS CORP. AND SHALL NOT BE REPRODUCED, DISTRIBUTED OR USED AS A BASIS FOR MANUFACTURE WITHOUT PRIOR WRITTEN PERMISSION FROM KEYSTONE ELECTRONICS CORP.

**ACTUAL SIZE**

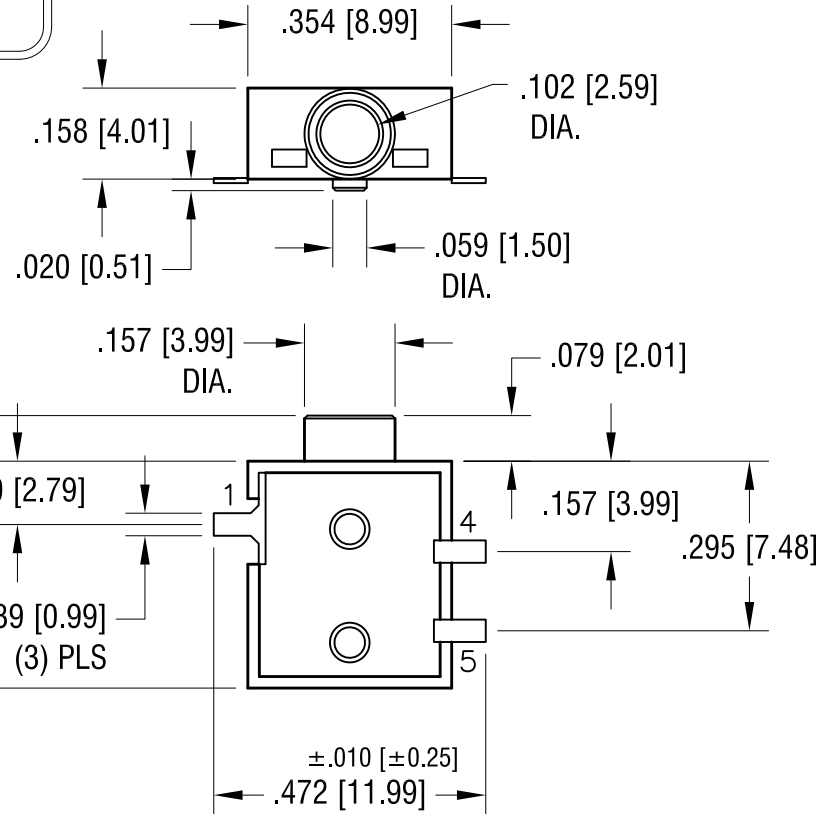
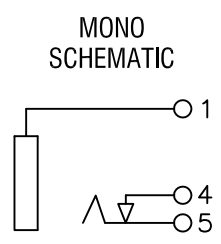
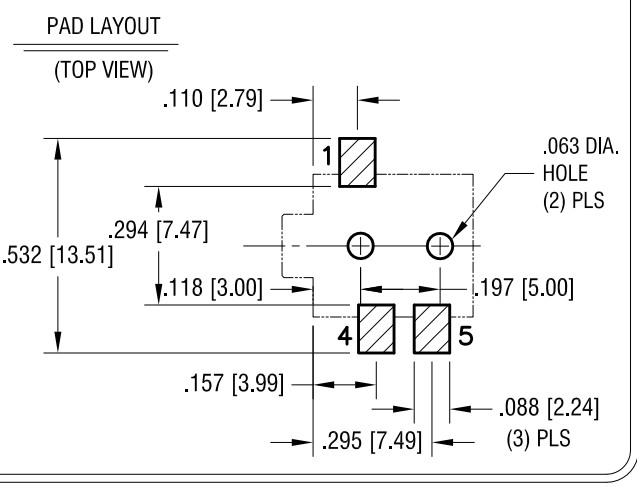
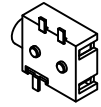

- NOTES:**
- MAT'L:**  
HOUSING: MAT'L- LCP, UL 94V-0  
GROUND TERMINAL: .012 [0.3] TH'K BRASS ①  
SPRING CONTACT: .008 [0.2] TH'K PHOSPHOR BRONZE ⑤  
SHUNT TERMINAL: .012 [0.3] TH'K BRASS ④
  - TAPE SPECIFICATIONS:**  
MAT'L - ALL CONDUCTIVE POLYSTYRENE CARRIER  
ANSI/EIA-481 STANDARD  
24MM (.945) WIDE; 16MM (.630) PITCH
  - REEL SPECIFICATION:**  
15 INCH DIA. 1000 PIECES

5.20.13	HOUSING WAS POLYAMIDE CHANGE AS PER ECR 13-041	A
DATE	DESCRIPTION	REV.

<b>KEYSTONE ELECTRONICS CORP.</b>			
www.keyelco.com • ASTORIA, N.Y. 11105-2017 • Tel (718) 956-8900			
PART NAME 2.5mm SURFACE MOUNT MONO JACK			
MATERIAL AS NOTED			
FINISH GOLD FLASH		DRN BY BOONE	DATE 7.20.98
		APP'D LN	SCALE 3X
TOLERANCES	INCH [MM]	CODE	DWG NO.
DECIMAL	± .005 [± 0.13]	C	982
ANGULAR ± 1° UNLESS OTHERWISE SPECIFIED			