

MATERIALS AND FINISHES

BODY REAR ZINC ALLOY
PLATED TIN

BODY FRONT BRASS
PLATED NICKEL

CENTER CONTACT PHOSPHOR BRONZE
PLATED GOLD

OUTER CASING HIGH TEMPERATURE PLASTIC
KEYING SEE TABLE
COLOR SEE TABLE

INSULATOR TEFLON

PACKAGING BY TRAY

RETENTION SPECIFICATION

THE FAKRA CONNECTOR SHROUD WILL WITHSTAND
A LONGITUDINAL FORCE OF 110 N (24.75 LBS)

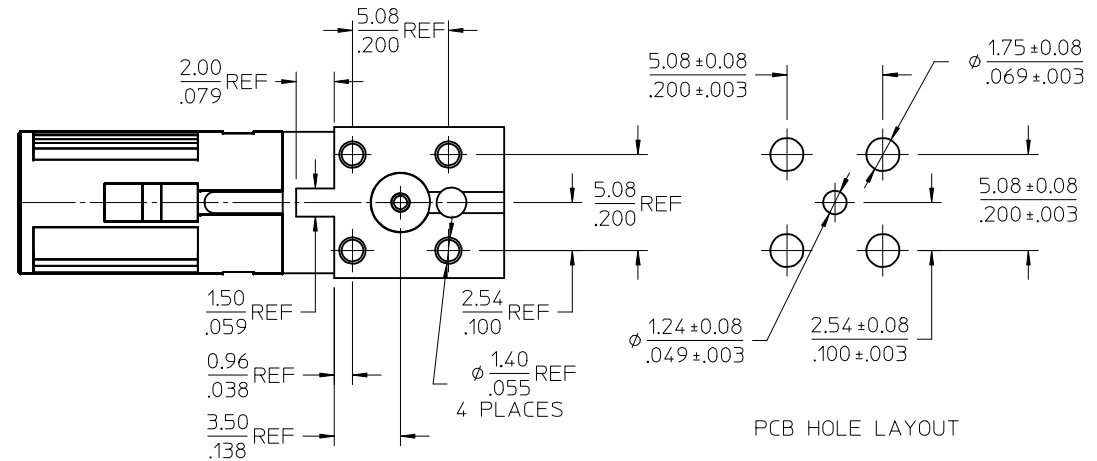
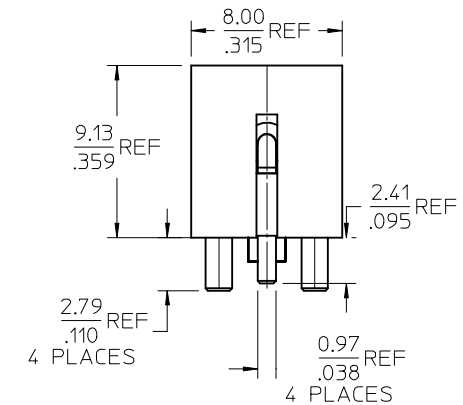
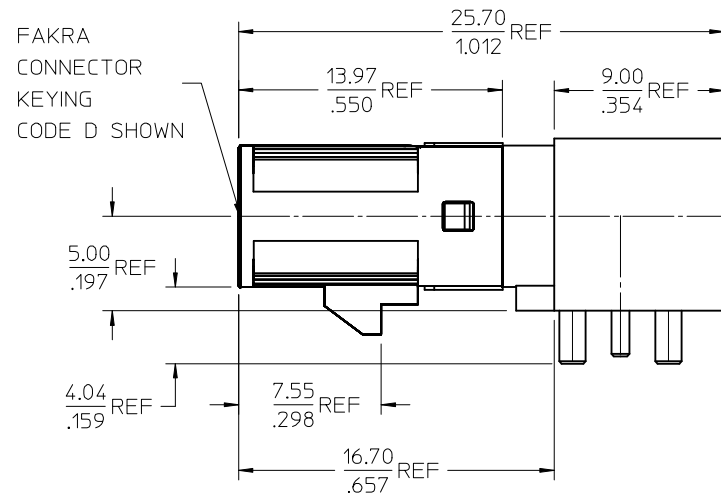
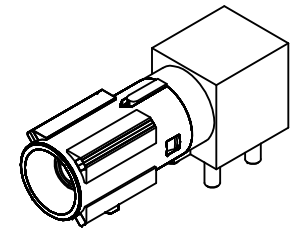

MIL-STD-348A, FIG. 311.1	INTERFACE SPECIFICATION
SPECIFICATION	DESCRIPTION

CHG: NEW RELEASED EC NO: URF2009-0724 DRAWN: MCHANOS 2009/06/11 CHKD: 2009/06/11 APPR: MHIANG 2009/06/12	DESCRIPTION REV: A	QUALITY SYMBOLS ▽=0 ▽=0	GENERAL TOLERANCES (UNLESS SPECIFIED)		DIMENSION STYLE MM/IN		SCALE METRIC	DESIGN UNITS METRIC		THIRD ANGLE PROJECTION			
			4 PLACES ± --- ± --- 3 PLACES ± --- ± --- 2 PLACES ± --- ± --- 1 PLACE ± --- ± ---		DRAWN BY MICHAEL		DATE 2009/05/11		TITLE SMB JACK, R/A FAKRA, PCB 50 OHMS, REVERSE SHROUD SMB-J/PCB/RA				
			ANGULAR ± 2 °		CHECKED BY JUDY		DATE 2009/05/11		APPROVED BY MI SEN				
			DRAFT WHERE APPLICABLE MUST REMAIN WITHIN DIMENSIONS		MATERIAL NO. SEE TABLE		DATE 2009/05/11		MOLEX INCORPORATED		DOCUMENT NO. SD-73403-531		SHEET NO. 1 OF 2

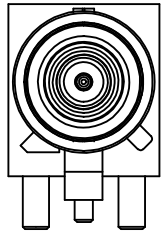

CODE-A

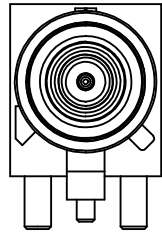

CODE-B

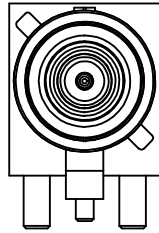

CODE-C

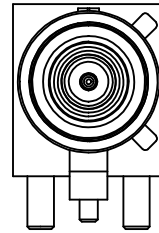

CODE-D

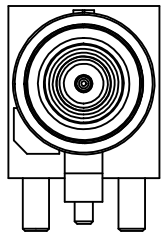

CODE-E

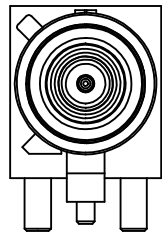

CODE-F

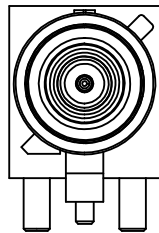

CODE-G

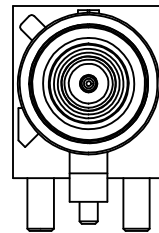

CODE-H

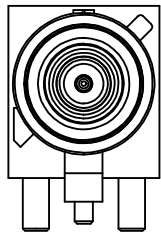

CODE-I

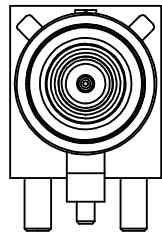

CODE-K

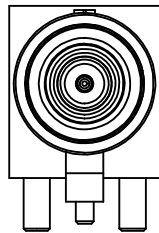

CODE-Z

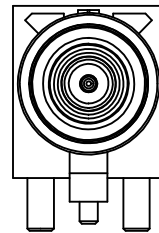

CODE-L

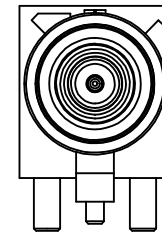

CODE-M

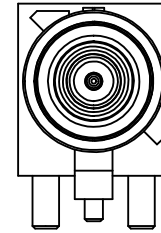

CODE-N

N	PASTEL GREEN	73403-5323
M	PASTEL ORANGE	73403-5322
L	CARMINE RED	73403-5321
Z	WATER BLUE	73403-5320
K	CURRY YELLOW	73403-5319
I	BEIGE	73403-5318
H	VIOLET	73403-5317
G	GRAY	73403-5316
F	BROWN	73403-5315
E	GREEN	73403-5314
D	BORDEAUXVIOLET	73403-5313
C	BLUE	73403-5312
B	NATURAL	73403-5311
A	BLACK	73403-5310
KEYING CODE	COLOR	PART NO.

SEE SHEET 1 EC NO: URF2009-0724 DRAWN: CHANOS 2009/06/11 CHKD: 2009/06/11 APPR: MHUANG 2009/06/12	QUALITY SYMBOLS ▽=0 ▽=0	GENERAL TOLERANCES (UNLESS SPECIFIED) <table border="1"> <tr> <td></td> <td>mm</td> <td>INCH</td> </tr> <tr> <td>4 PLACES</td> <td>± ---</td> <td>± ---</td> </tr> <tr> <td>3 PLACES</td> <td>± ---</td> <td>± ---</td> </tr> <tr> <td>2 PLACES</td> <td>± ---</td> <td>± ---</td> </tr> <tr> <td>1 PLACE</td> <td>± ---</td> <td>± ---</td> </tr> </table>		mm	INCH	4 PLACES	± ---	± ---	3 PLACES	± ---	± ---	2 PLACES	± ---	± ---	1 PLACE	± ---	± ---	DIMENSION STYLE MM/IN	SCALE DESIGN UNITS METRIC	THIRD ANGLE PROJECTION
		mm	INCH																	
	4 PLACES	± ---	± ---																	
	3 PLACES	± ---	± ---																	
2 PLACES	± ---	± ---																		
1 PLACE	± ---	± ---																		
DRAFT WHERE APPLICABLE MUST REMAIN WITHIN DIMENSIONS	MATERIAL NO. SEE TABLE	DRAWN BY MICHAEL	DATE 2009/05/11	TITLE SMB JACK, R/A FAKRA, PCB 50 OHMS, REVERSED SHROUD SMB-J/PCB/RA	SHEET NO. 2 OF 2															
REV A	DESCRIPTION APPR: MHUANG 2009/06/12	ANGULAR ± 2 °	APPROVED BY MISEN	DATE 2009/05/11	MOLEX MOLEX INCORPORATED															
			MATERIAL NO. SEE TABLE	DATE 2009/05/11	DOCUMENT NO. SD-73403-531															