

6

5

4

3



2

1

MATERIAL AND FINISH:

Insulator: Polycarbonate, UL-94V-0 rated
Contacts: Brass, Nickel plated

ELECTRICAL SPECIFICATIONS:

Current rating: 16 A 
Voltage rating: 250 VAC
Current rating: 20 A  
Voltage rating: 250 VAC
Insulation resistance: 100 Mohm min. at 500 VDC
Dielectric withstanding voltage: 2000 VAC for one minute

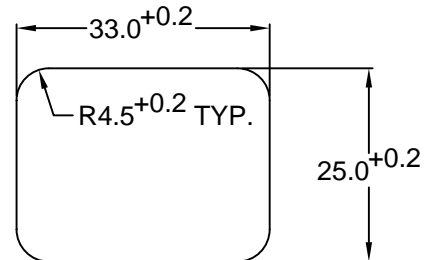
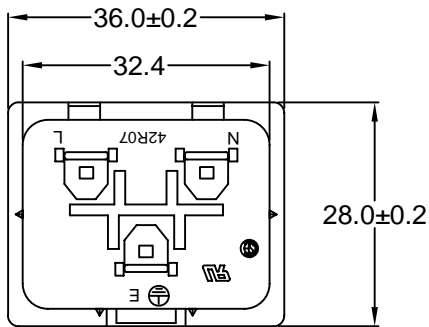

RECOMMENDED
PANEL CUTOUT



ORDERING CODE:

42R07-3 2 -
 1 2 3

1) COLOR

- 1 = BLACK
- 2 = GRAY

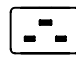
2) ELECTRICAL CIRCUIT CONFIGURATION

- 1 = 20A 250V 70°C 2+GROUND 
- 2 = 20A 250V 155°C 2+GROUND 
- 3 = 20A 250V 70°C 2 POLE 

3) PANEL THICKNESS

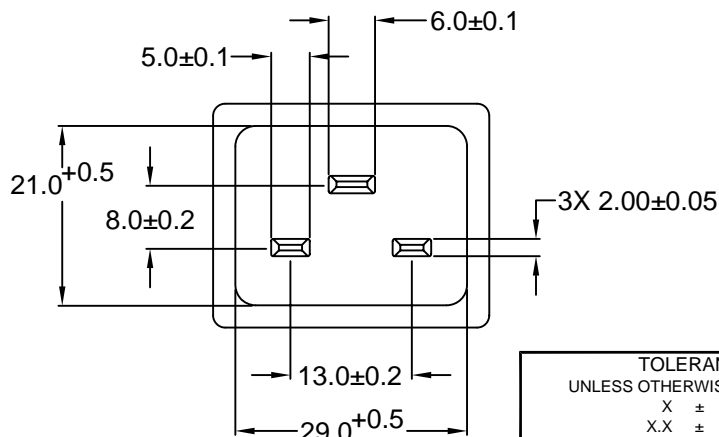
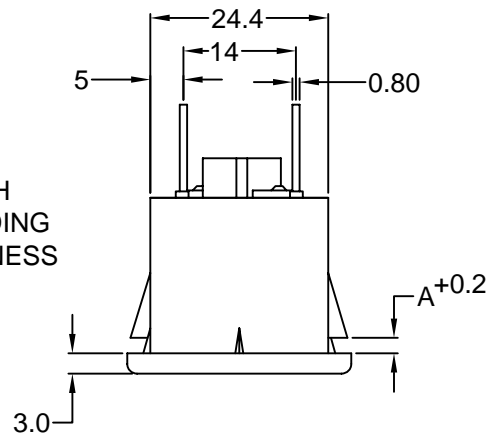
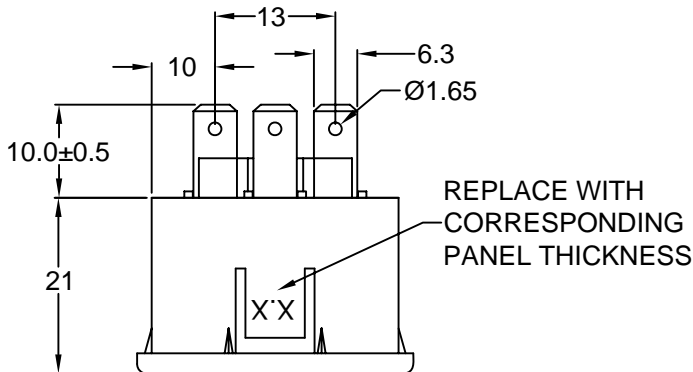

P/N	A	MAX. PANEL THICKNESS
42R07-3X2X-150	1.5	1.5
42R07-3X2X-200	2.0	2.0
42R07-3X2X-250	2.5	2.5

ADDITIONAL PANEL THICKNESS
AVAILABLE ON REQUEST

TOLERANCE UNLESS OTHERWISE SPECIFIED	
X	± 1
X.X	± 0.4
X.XX	± 0.20

Power Dynamics, Inc.

Phone: 973 560-0019 Whippany, New Jersey Fax: 973 560-0076

PART: 16/20A IEC 60320 APPL. INLET; QC
TERMINALS; SNAP-IN, PANEL MOUNT

DRAWN BY	GQ	DATE:	08/24/01
CHECK BY	TD	DATE:	08/29/01
APPR BY	PB	DATE:	08/29/01

PART #:	42R07-3X2X-XXX	SHEET	1 of 1
SIZE:	A	ALL DIMENSIONS FOR REFERENCE ONLY DIMENSIONS ARE IN MILLIMETERS	REV: C
SCALE:	NTS		

**RoHS
COMPLIANT**

D

C

B

A

REV	DATE	CHANGE		CHNG CHECK APPR	
		ADD	DEL	TD	PB
A	11/24/04				

B	12/2/04	9/3/07	CHG REF DIM TO DIM		P POLE ORDERING CODE WAS 4	
			TD	PB	TD	PB