

PLEASE CHECK WWW.MOLEX.COM FOR LATEST PART INFORMATION

Part Number: [0191600022](#)
Status: **Active**
Overview: [Splices](#)
Description: Closed-End Connector Insert for 12-22 AWG Wire

Documents:

[Drawing \(PDF\)](#) [RoHS Certificate of Compliance \(PDF\)](#)
[Product Specification PS-19902-013-001 \(PDF\)](#)

General

Product Family	Splices
Series	19160
Crimp Quality Equipment	Yes
Overview	Splices
Product Name	Closed-End Connector Insert
UPC	800755091526

Physical

Barrel Type	Closed
Insulation	None
Material - Metal	Copper
Material - Plating Mating	Tin
Material - Plating Termination	Tin
Net Weight	0.359/g
Packaging Type	Bag
Temperature Range - Operating	149°C
Wire Insulation Diameter	N/A
Wire Size AWG	12, 14, 16, 18, 20, 22

Material Info

Engineering Number CE-2212

Reference - Drawing Numbers

Product Specification	PS-19902-013-001
Sales Drawing	SD-19160-009

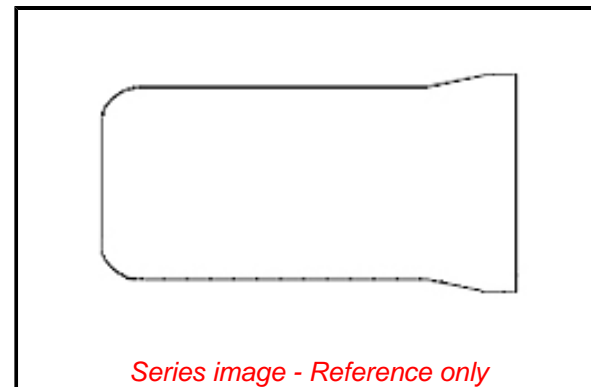

EU ELV

Not Relevant

EU RoHS

Compliant

REACH SVHC

Not Contained Per -
ED/71/2019 (16 July
2019)

Halogen-Free

Status

Low-Halogen

For more information, please visit [Contact US](#)

China ROHS

ELV

RoHS Phthalates

China RoHS

Green Image

Not Relevant

Not Contained

Search Parts in this Series

[19160 Series](#)