

MATERIALS AND FINISHES

BODY: BERYLLIUM COPPER  
 PLATED: GOLD 30 MICROINCH MIN

CENTER CONTACT: BERYLLIUM COPPER  
 PLATED: GOLD 30 MICROINCH MIN

INSULATOR: TEFLON

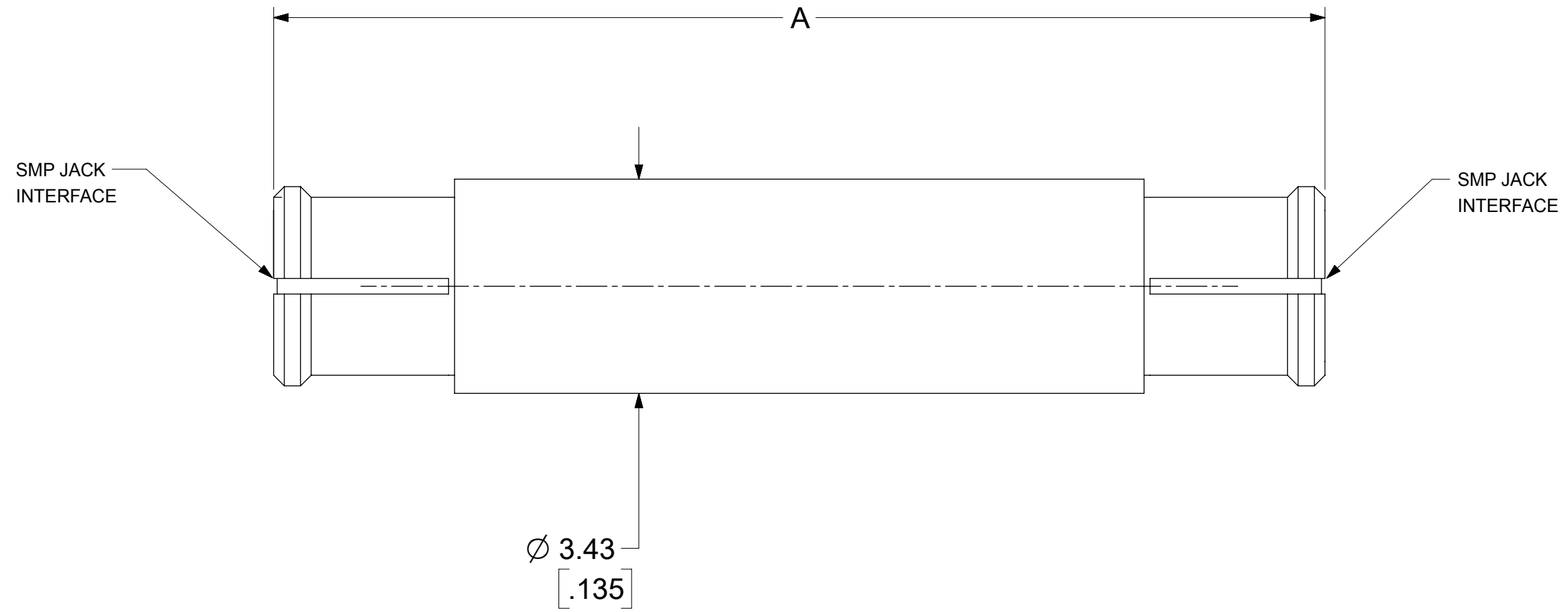

73415-4791	.760 REF	19.31 REF	ONE PER BAG	895420470
73415-4790	.760 REF	19.31 REF	TRAY	895420040
PART #	DIM A		PACKAGING	PACKING SPEC

PS-89675-3320	PRODUCT SPECIFICATION
MIL-STD-348A, FIG 326.1	INTERFACE
SPECIFICATION	DESCRIPTION

FUNCTIONAL SYMBOLS $\nabla_A = 0$ $\nabla_C = 0$ $\nabla_P = 0$	THIS DRAWING CONTAINS INFORMATION THAT IS PROPRIETARY TO MOLEX ELECTRONIC TECHNOLOGIES, LLC AND SHOULD NOT BE USED WITHOUT WRITTEN PERMISSION			
	DIMENSION UNITS	SCALE	CURRENT REV DESC:	
	MM/INCH	NTS	EWR # 15321-E ADDED -4791 PART NO	
	GENERAL TOLERANCES (UNLESS SPECIFIED)		EC NO: 718007	
ANGULAR TOL $\pm 2.0^\circ$		DRWN: JSU18 2022/08/11		
4 PLACES $\pm$		CHK'D: YCHENG 2022/08/24		
3 PLACES $\pm$		APPR: YCHENG 2022/08/24		
2 PLACES $\pm 0.13$		INITIAL REVISION:		
1 PLACE $\pm 0.25$		DRWN: CLLI 2005/01/12		
0 PLACES $\pm$		APPR: MHUANG 2005/01/17		
DRAFT WHERE APPLICABLE MUST REMAIN WITHIN DIMENSIONS		THIRD ANGLE PROJECTION	DRAWING	SERIES
			C-SIZE	73415
DOCUMENT STATUS		DOC TYPE	DOC PART	REVISION
P1	RELEASE DATE	PSD	001	C1
2022/08/24 02:17:38	MATERIAL NUMBER		CUSTOMER	SHEET NUMBER
	SD-73415-479		GENERAL MARKET	1 OF 1

**molex**

SMP JACK ADAPTER  
 SMP-J/J/ADP

PRODUCT CUSTOMER DRAWING