

Venting element

JDAExxESzzzz

Body	Stainless steel 1.4305
Membrane	Polyether sulphone PES
O-ring	Nitrile rubber NBR
Connecting thread	metric, as per EN 60423
Sleeve	Stainless steel 1.4305 (M12x1,5) Polyamide PA6 (M20x1,5 and M40x1,5)

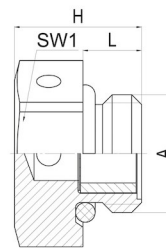

Properties

	<ul style="list-style-type: none"> • protection for hermetically sealed electro-technical and electronic enclosures against condensation water from alternating temperature and pressure • pressure, continuous ventilation and adaption of the inner pressure • hydrophobic and oleophobic PES-membrane
Water entry pressure	> 0,83 bar (dynamic WEP, 30 seconds)
Temperature range	-40 °C +100 °C
Protection grade	IP66/ IP68 - 0,6 bar (60 min.)/ IP69
Comment	The venting element has no function if it is blocked with dust and / or submerged in water.

Features

Connecting thread short

A	L	SW1	H	RQ*		Part No.
M12x1,5	6	17	13	ca. 6	25	JDAE12ES4305
M20x1,5	6	24	13	ca. 11	10	JDAE20ES4305
M40x1,5	8	45	18	ca. 75	5	JDAE40ES4305

*RQ = theoretical air flow through usable surface at $\Delta p = 0,07$ bar