

PICK AND PLACE CAP (BIG)

PICK AND PLACE CAP (SMALL)

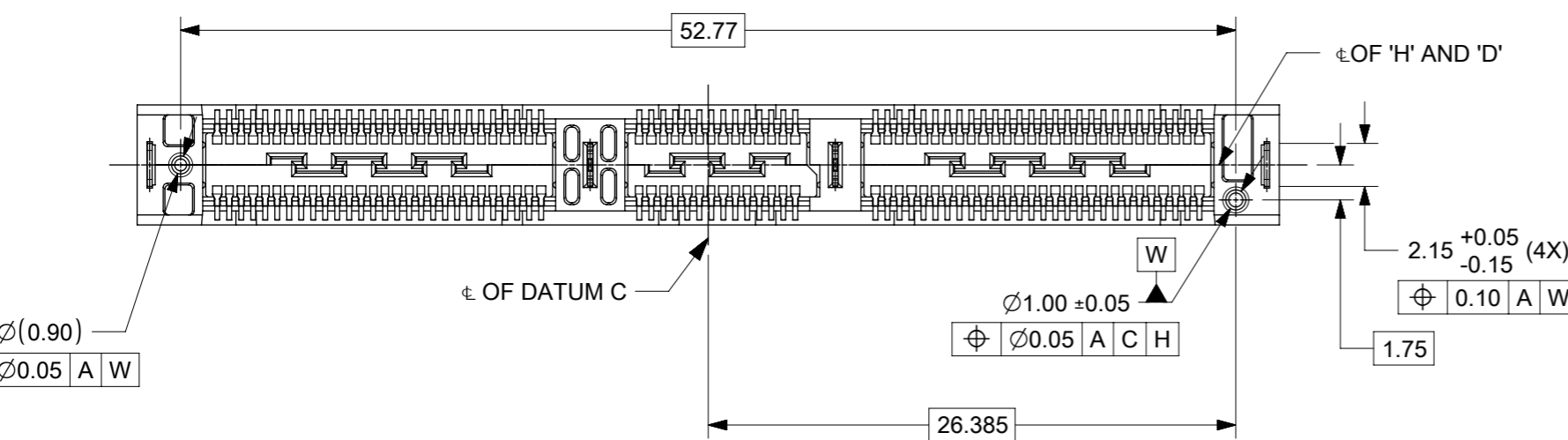
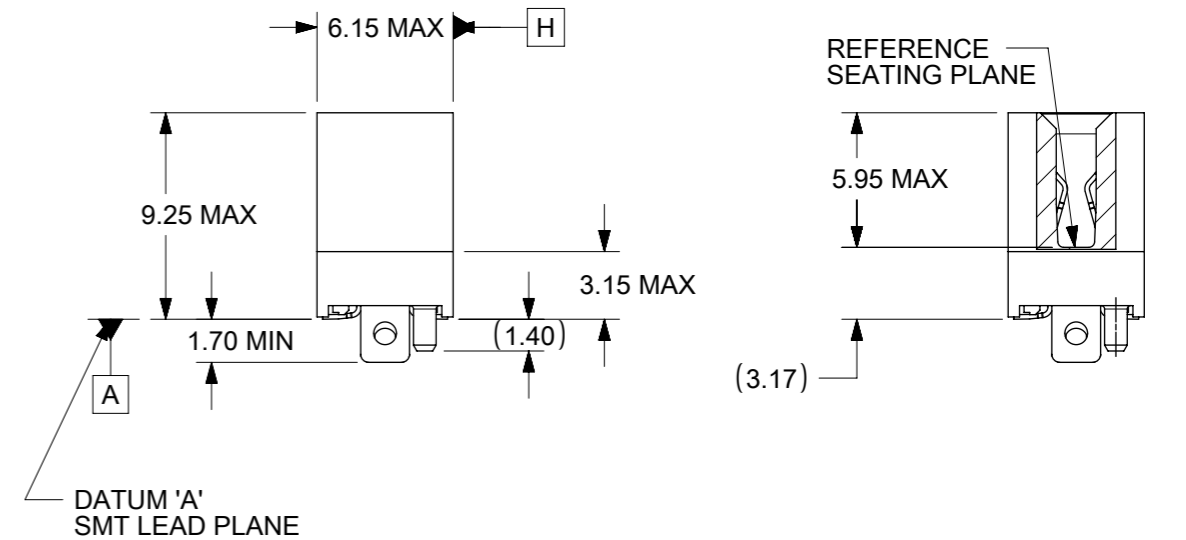
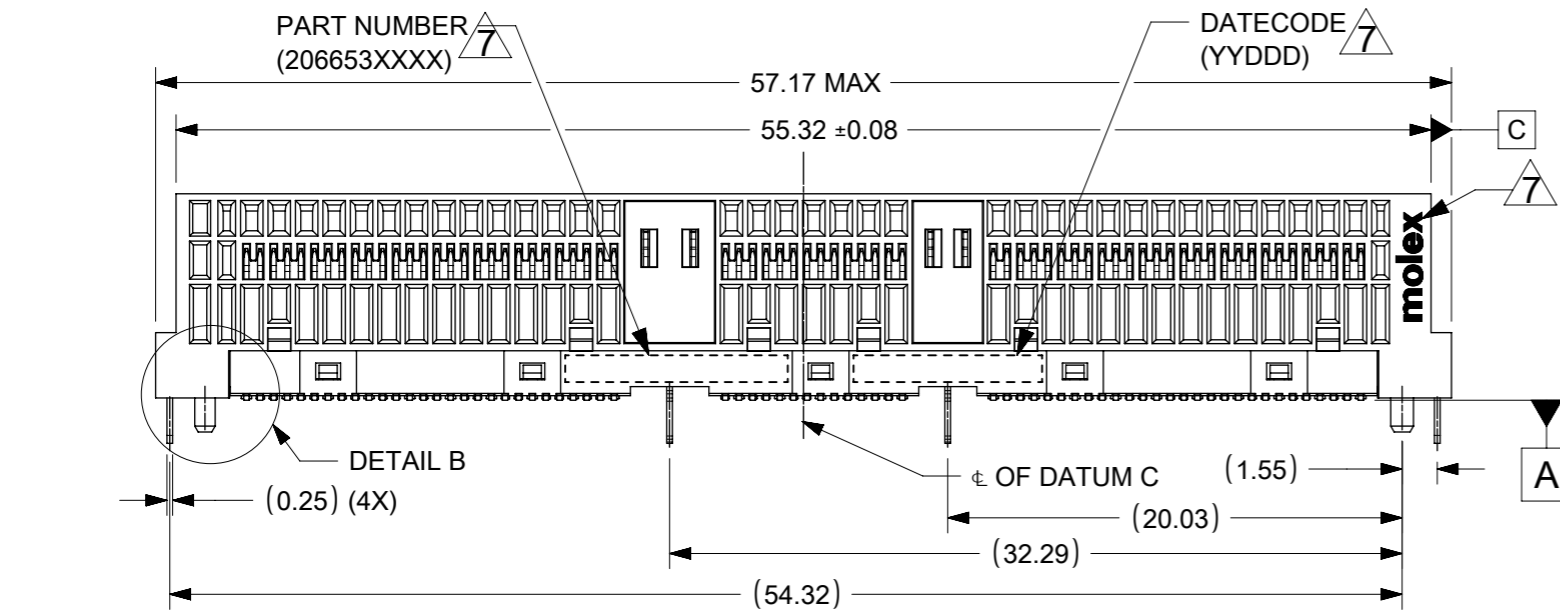
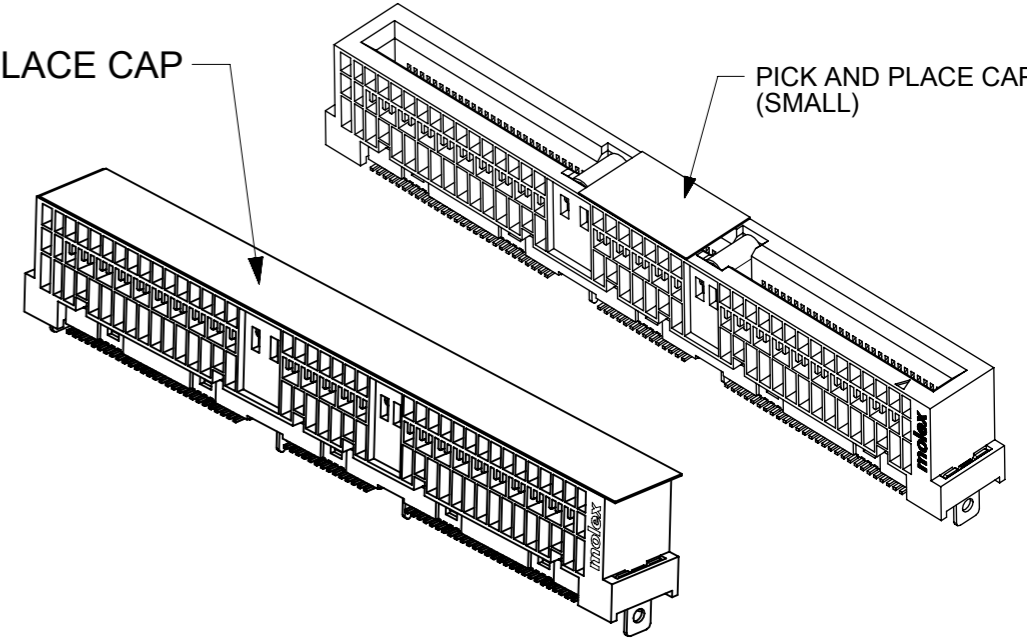

- NOTES:
- MATERIAL:
HOUSING - GLASS FILLED LIQUID CRYSTAL POLYMER, 94-V0, BLACK
TERMINALS - COPPER ALLOY
 - FINISH : REFER TABLE
 - PRODUCT SPECIFICATION : REFER TABLE
 - PACKAGING SPECIFICATION : REFER TABLE
PRODUCT SHALL BE PACKED IN TAPE AND REEL.
 - APPLICATION SPECIFICATION : REFER TABLE
 - MATING CARD THICKNESS : 1.57 ±0.13mm
 - MOLEX LOGO, DATECODE & PART NUMBER INDICATED ON HOUSING.

THIS DESIGN IS BASED ON DESIGN OBJECTIVES AND IS STRICTLY TENTATIVE. IT MAY CHANGE BASED ON RESULT OF ADDITIONAL DESIGN REVIEWS AND VERIFICATIONS

FUNCTIONAL SYMBOLS	DIMENSION UNITS	SCALE	CURRENT REV DESC:		
$\nabla A = 0$	mm	NTS	EC NO: 709328		
$\nabla E = 0$	GENERAL TOLERANCES (UNLESS SPECIFIED)		DRWN: LTONG02	2022/05/23	
$\nabla F = 0$	ANGULAR TOL ± 3.0°		CHK'D: MFAN08	2022/06/07	
DIVISIONAL SYMBOLS	4 PLACES ±		APPR: XQHE	2022/06/08	
	3 PLACES ±		INITIAL REVISION:		
	2 PLACES ±	0.2	DRWN: KUCHILA	2018/02/02	
	1 PLACE ±		APPR: SHLENI	2019/01/15	
	0 PLACES ±		DRAFT WHERE APPLICABLE MUST REMAIN WITHIN DIMENSIONS		
	THIRD ANGLE PROJECTION		DRAWING	SERIES	MATERIAL NUMBER
			A3-SIZE	206653	SEE TABLE
			CUSTOMER		SHEET NUMBER
			GENERAL MARKET		1 OF 5

molex

SALES DRAWING, VERT, 140 POS
EDGE LINE SLIVER, 4C, SMT (1.57 EDGE CARD)

PRODUCT CUSTOMER DRAWING

DOCUMENT NUMBER	DOC TYPE	DOC PART	REVISION
2066530140	PSD	000	C3

RECOMMENDED 4C VERTICAL PCB FOOT PRINT AS PER SFF TA-1002 CONNECTOR SPECIFICATIONS

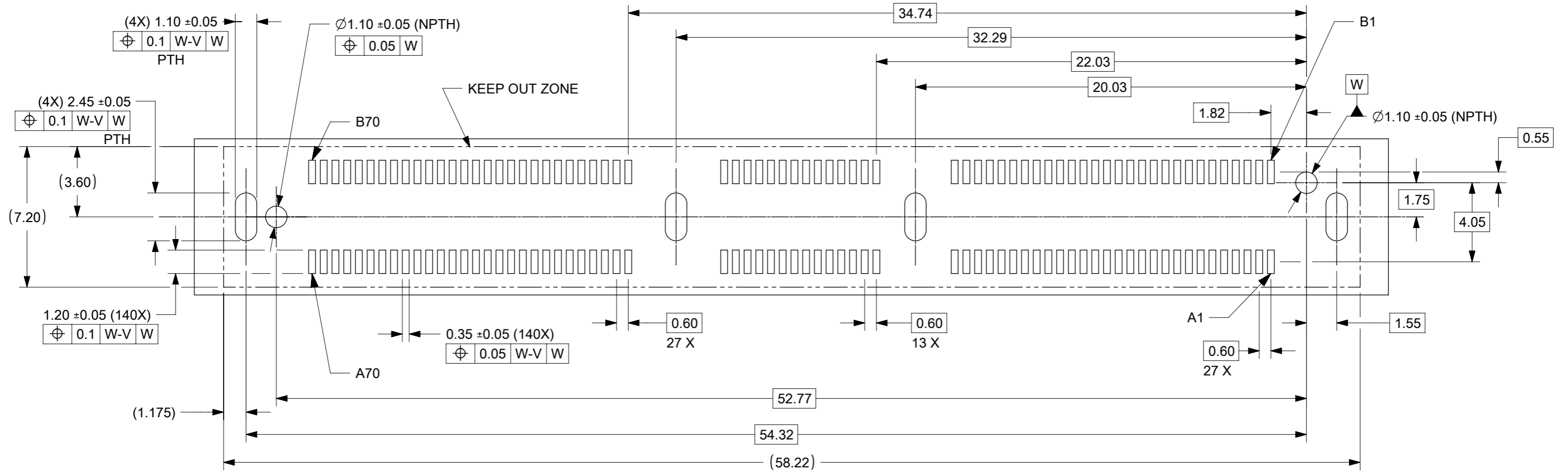

FUNCTIONAL SYMBOLS		THIS DRAWING CONTAINS INFORMATION THAT IS PROPRIETARY TO MOLEX ELECTRONIC TECHNOLOGIES, LLC AND SHOULD NOT BE USED WITHOUT WRITTEN PERMISSION	
$\nabla_A = 0$	mm	SCALE	NTS
$\nabla_B = 0$	GENERAL TOLERANCES (UNLESS SPECIFIED)		
$\nabla_C = 0$	ANGULAR TOL $\pm 3.0^\circ$		
DIVISIONAL SYMBOLS		CURRENT REV DESC:	
4 PLACES	\pm	EC NO: 709328	
3 PLACES	\pm	DRWN: LTONG02	2022/05/23
2 PLACES	± 0.2	CHK'D: MFAN08	2022/06/07
1 PLACE	\pm	APPR: XQHE	2022/06/08
0 PLACES	\pm	INITIAL REVISION:	
DRAFT WHERE APPLICABLE MUST REMAIN WITHIN DIMENSIONS		DRWN: KUCHILA	2018/02/02
THIRD ANGLE PROJECTION		APPR: SHLENI	2019/01/15
DRAWING		SERIES	MATERIAL NUMBER
A3-SIZE		206653	2066530140
CUSTOMER		DOCUMENT NUMBER	DOC TYPE
GENERAL MARKET		PSD	000
SHEET NUMBER		REVISION	
2 OF 5		C3	

molex

SALES DRAWING, VERT, 140 POS
EDGELINE SLIVER, 4C, SMT (1.57 EDGE CARD)

PRODUCT CUSTOMER DRAWING

RECOMMENDED VERTICAL 4C MATING CARD AS PER SFF TA-1002 CONNECTOR SPECIFICATIONS

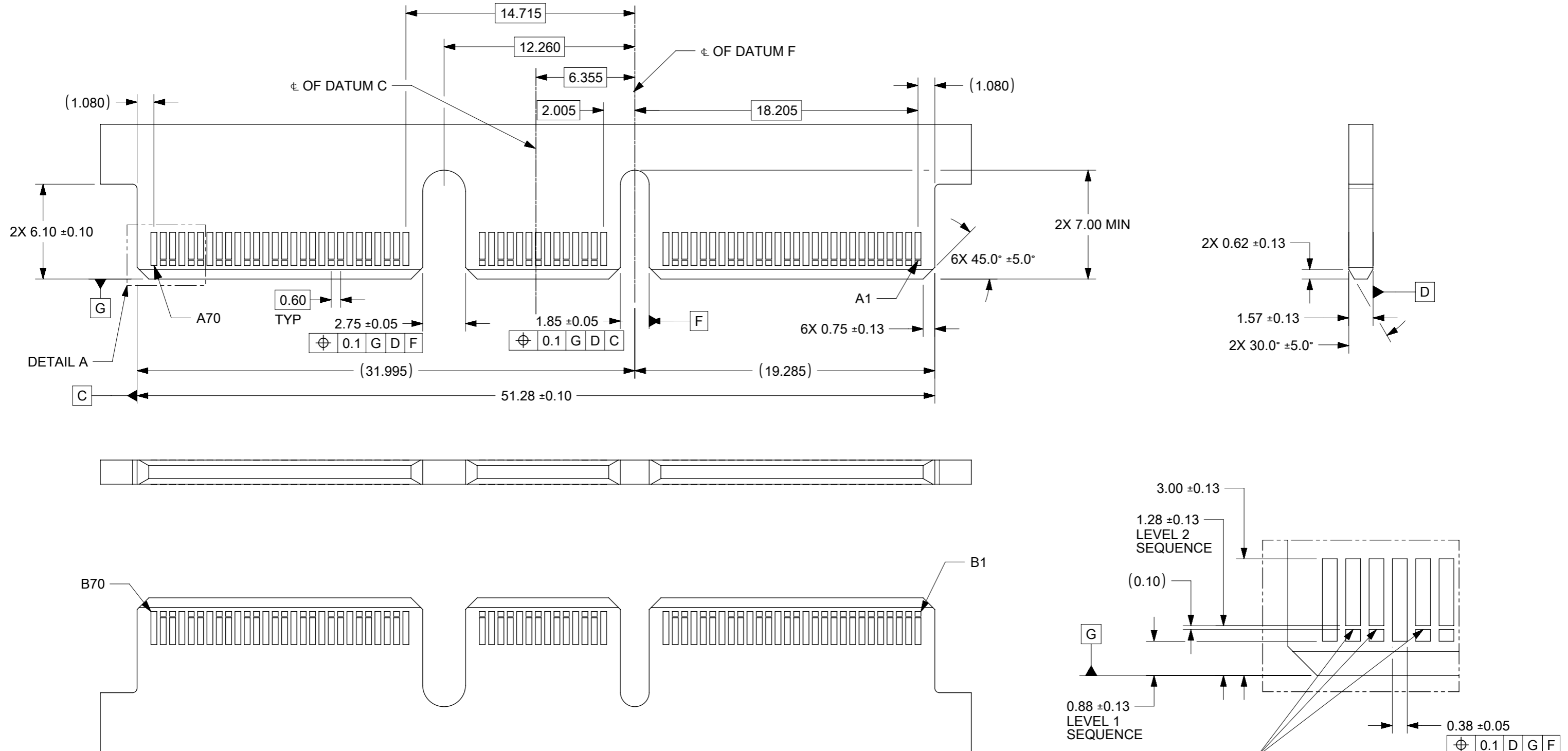

FUNCTIONAL SYMBOLS $\nabla_A = 0$ $\nabla_F = 0$ $\nabla_F = 0$	THIS DRAWING CONTAINS INFORMATION THAT IS PROPRIETARY TO MOLEX ELECTRONIC TECHNOLOGIES, LLC AND SHOULD NOT BE USED WITHOUT WRITTEN PERMISSION	SCALE mm NTS	CURRENT REV DESC:		
	GENERAL TOLERANCES (UNLESS SPECIFIED) ANGULAR TOL ± 3.0°	EC NO: 709328 DRWN: LTONG02 CHK'D: MFAN08 APPR: XQHE	2022/05/23 2022/06/07 2022/06/08	molex	
DIVISIONAL SYMBOLS	SALES DRAWING, VERT, 140 POS EDGE LINE SLIVER, 4C, SMT (1.57 EDGE CARD)	4 PLACES ± 3 PLACES ± 2 PLACES ± 0.2 1 PLACE ± 0 PLACES ±	INITIAL REVISION: DRWN: KUCHILA APPR: SHLENI	2018/02/02 2019/01/15	PRODUCT CUSTOMER DRAWING
DRAFT WHERE APPLICABLE MUST REMAIN WITHIN DIMENSIONS	THIRD ANGLE PROJECTION	DRAWING	SERIES	MATERIAL NUMBER	CUSTOMER
	A3-SIZE	206653	206653	SEE TABLE	GENERAL MARKET
				DOCUMENT NUMBER	DOC TYPE DOC PART REVISION
				2066530140	PSD 000 C3
					SHEET NUMBER
					3 OF 5

10

9

8

7

6

5

4

3

2

1

ASSEMBLY PART NO.	PICK AND PLACE CAP	PLATING OPTION	PRODUCT SPECIFICATION	PACKAGING SPECIFICATION	APPLICATION SPECIFICATION
2066530140	YES(SMALL)	0.76 MICROMETER /30 MICROINCH MIN. GOLD ON CONTACT. 2.54 MICROMETER /100 MICROINCH MIN. PURE MATTE TIN ON SOLDER TAILS OVER 1.27 MICROMETER /50 MICROINCH MIN. NICKEL UNDERPLATE	2066530001-PS	2066530140	2066530001-AS
2066531140	YES(BIG)				
2066535140	NO			2066535140-PK	

FUNCTIONAL SYMBOLS	THIS DRAWING CONTAINS INFORMATION THAT IS PROPRIETARY TO MOLEX ELECTRONIC TECHNOLOGIES, LLC AND SHOULD NOT BE USED WITHOUT WRITTEN PERMISSION	
$\nabla_A = 0$	DIMENSION UNITS	SCALE
$\nabla_B = 0$	mm	NTS
$\nabla_C = 0$	CURRENT REV DESC:	
	GENERAL TOLERANCES (UNLESS SPECIFIED)	
	ANGULAR TOL $\pm 3.0^\circ$	
	4 PLACES	\pm
	3 PLACES	\pm
	2 PLACES	± 0.2
	1 PLACE	\pm
	0 PLACES	\pm
DIVISIONAL SYMBOLS	EC NO: 709328	
	DRWN: LTONG02 2022/05/23	
	CHK'D: MFAN08 2022/06/07	
	APPR: XQHE 2022/06/08	
	INITIAL REVISION:	
	DRWN: KUCHILA 2018/02/02	
	APPR: SHLENI 2019/01/15	
	DRAFT WHERE APPLICABLE MUST REMAIN WITHIN DIMENSIONS	THIRD ANGLE PROJECTION
		DRAWING
		SERIES
		MATERIAL NUMBER
		CUSTOMER
		SHEET NUMBER

molex

SALES DRAWING, VERT, 140 POS
EDGELINE SLIVER, 4C, SMT (1.57 EDGE CARD)

PRODUCT CUSTOMER DRAWING

DOCUMENT NUMBER	DOC TYPE	DOC PART	REVISION
2066530140	PSD	000	C3

DOCUMENT STATUS	P1	RELEASE DATE	2022/06/08 04:35:42
-----------------	----	--------------	---------------------

9

8

7

6

5

4

3

2

1

FORMAT: master-ib-prod-A3
REVISION: 11
DATE: 2021/05/01

REVISION HISTORY			
DATE	REV	DESCRIPTION	ENGINEER
2021/12/02	C2	CORRECT THE DIMENSION FROM 19.50 TO 18.62@F6 ON SHEET 1	TONYTONG
2022/05/23	C3	ADD P/N 2066531140	TONYTONG

FUNCTIONAL SYMBOLS = 0 = 0 = 0	THIS DRAWING CONTAINS INFORMATION THAT IS PROPRIETARY TO MOLEX ELECTRONIC TECHNOLOGIES, LLC AND SHOULD NOT BE USED WITHOUT WRITTEN PERMISSION		molex			
	DIMENSION UNITS: mm SCALE: NTS	CURRENT REV DESC:			SALES DRAWING, VERT, 140 POS EDGELINE SLIVER, 4C, SMT (1.57 EDGE CARD)	
	GENERAL TOLERANCES (UNLESS SPECIFIED) ANGULAR TOL ± 3.0°		EC NO: 709328 DRWN: LTONG02 CHK'D: MFAN08 APPR: XQHE	2022/05/23 2022/06/07 2022/06/08	PRODUCT CUSTOMER DRAWING	
	DIVISIONAL SYMBOLS	4 PLACES ± 3 PLACES ± 2 PLACES ± 0.2 1 PLACE ± 0 PLACES ±	INITIAL REVISION: DRWN: KUCHILA APPR: SHLENI	2018/02/02 2019/01/15	DOCUMENT NUMBER: 2066530140 DOC TYPE: PSD DOC PART: 000 REVISION: C3	
DRAFT WHERE APPLICABLE MUST REMAIN WITHIN DIMENSIONS		THIRD ANGLE PROJECTION 	DRAWING: A3-SIZE	SERIES: 206653	MATERIAL NUMBER: SEE TABLE CUSTOMER: GENERAL MARKET	SHEET NUMBER: 5 OF 5