

Lot No. with Laser(Month Day)

Month	JAN-SEP	OCT	NOV	DEC
Marking	1-9	A	B	C

**C01A**  
 MACHINE NO.  
 DAY(1~31)  
 MONTH

**NOTES**

- MATERIAL**  
 HOUSING : LIQUID CRYSTAL POLIMER UL94V-0 (COLOR : BLACK)  
 TERMINAL : COPPER ALLOY  
 FITTING NAIL : COPPER ALLOY
- PLATING**  
**TERMINAL :**  
 CONTACT AREA : SEPERATED GOLD PLATING(0.1µm MINIMUM)  
 SOLDER TAIL AREA : SEPERATED GOLD PLATING(0.05µm MINIMUM)  
 UNDER PLATING : NICKEL OVERALL(1.0µm MINIMUM)  
 \* DIVIED INTO PARTS THE GOLD PLATING OF THE CONTACT AND THE TAIL PART BY THE NICKEL PLATING.  
**FITTING NAIL :**  
 CONTACT AREA : SEPERATED GOLD PLATING(0.1µm MINIMUM)  
 SOLDER TAIL AREA : SEPERATED GOLD PLATING(0.05µm MINIMUM)  
 UNDER PLATING : NICKEL OVERALL(1.0µm MINIMUM)  
 \* DIVIED INTO PARTS THE GOLD PLATING OF THE CONTACT AND THE TAIL PART BY THE NICKEL PLATING.
- MATE WITH : 2166560\*\*0**
- TAIL AND FITTING NAIL COPLANARITY TO BE 0.08 MAXIMUM.**
- PROHIBITED AREA OF PATTERN WIRING AND SOLDER.**  
 (FOR EACH AREA, THE WIRING THAT TOUCHES ON THE SOLDER CAN BE ATTACHED, THEN COVERED WITH A FILM TO KEEP SOLDER OUT)

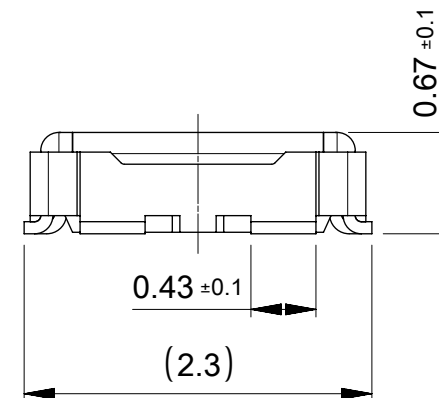
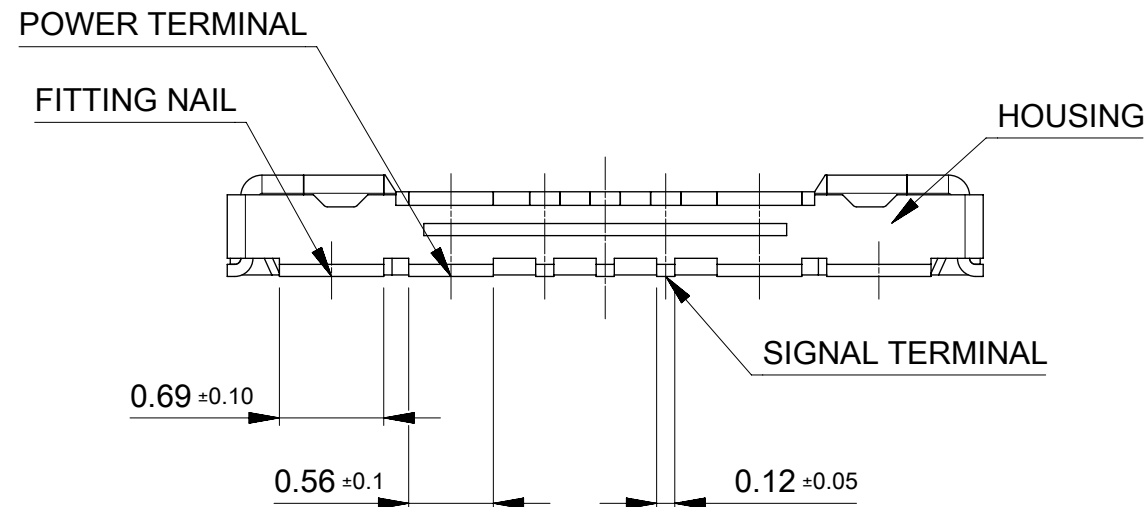

0.80	2.04	3.44	5.00	2166560109	O	---	6+4P	
				EMBOSSSED TAPE PACKAGE	HIGH VOL. TOOL	LOW VOL. TOOL		
				ORDER No.	SAMPLE PREPARATION		Ckts	
					O : TOOLED			
					□ : WORK PROCESS			
					--- : TOOLING TO BE CONFIRMED			
<b>CONNECTOR SERIES No. : 2166560**0</b>								

FUNCTIONAL SYMBOLS ▽A = 0 ▽E = 0 ▽P = 0	THIS DRAWING CONTAINS INFORMATION THAT IS PROPRIETARY TO MOLEX ELECTRONIC TECHNOLOGIES, LLC AND SHOULD NOT BE USED WITHOUT WRITTEN PERMISSION	SCALE mm 20:1		CURRENT REV DESC:				<b>molex</b>			
	GENERAL TOLERANCES (UNLESS SPECIFIED)	ANGULAR TOL ± 3.0°		EC NO: 746459 DRWN: JHCHANG 2022/06/30 CHK'D: JBJIN 2023/04/19 APPR: JBJIN 2023/04/20							
	DIVISIONAL SYMBOLS	4 PLACES ± 0.1	3 PLACES ± 0.1	2 PLACES ± 0.1	1 PLACE ± 0.1	0 PLACES ± 0.2	INITIAL REVISION: DRWN: JHCHANG 2020/10/26 APPR: SHCHU 2021/09/03				
	DRAFT WHERE APPLICABLE MUST REMAIN WITHIN DIMENSIONS	THIRD ANGLE PROJECTION	DRAWING	SERIES	MATERIAL NUMBER	CUSTOMER	SHEET NUMBER	DOCUMENT NUMBER: 2166560100-SD DOC TYPE: PSD DOC PART: 001 REVISION: A3			

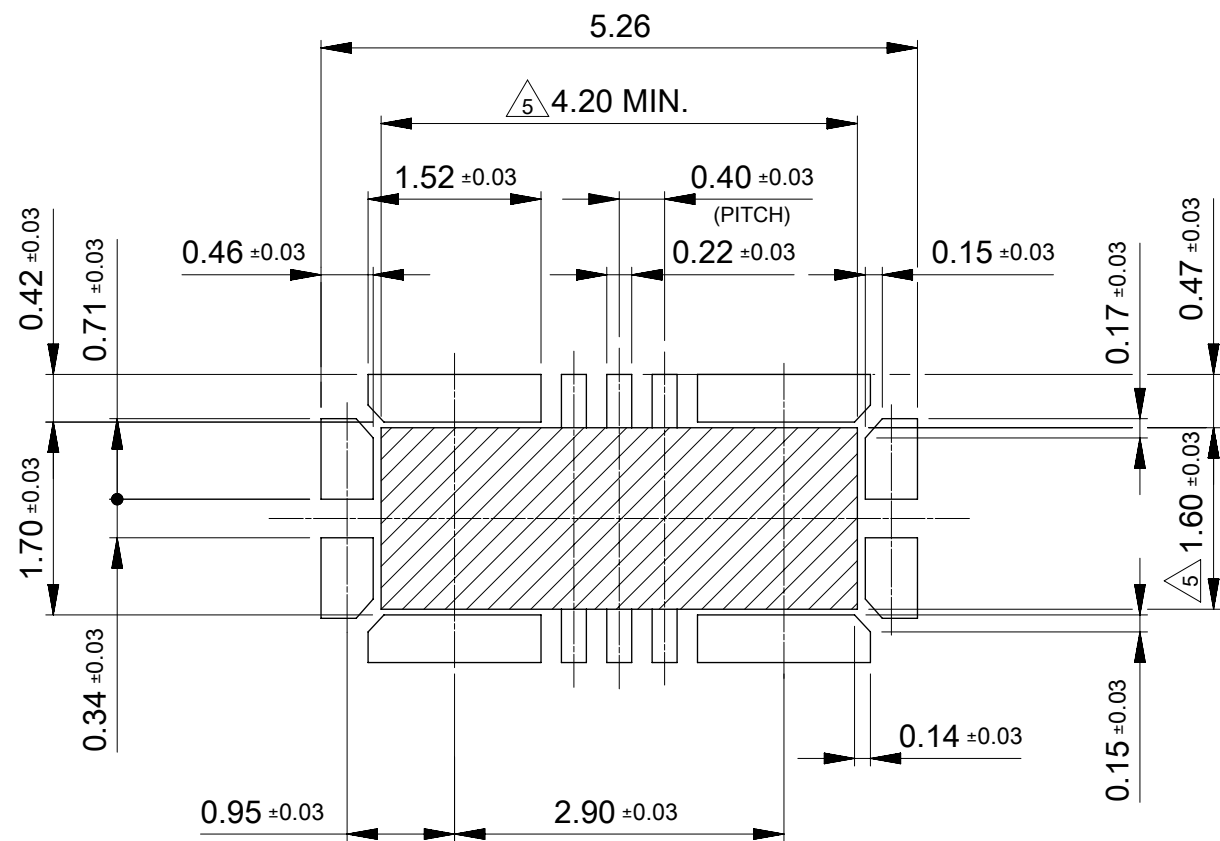

**RECOMMENDED P.C. BOARD PATTERN LAYOUT**  
(FOR REFERENCE)

 SOLDERING PROHIBITED AREA.  
WHEN WIRING IS LOCATED,  
THE WIRING MUST BE MASKED BY COVER LAY OR RESIST FILM.

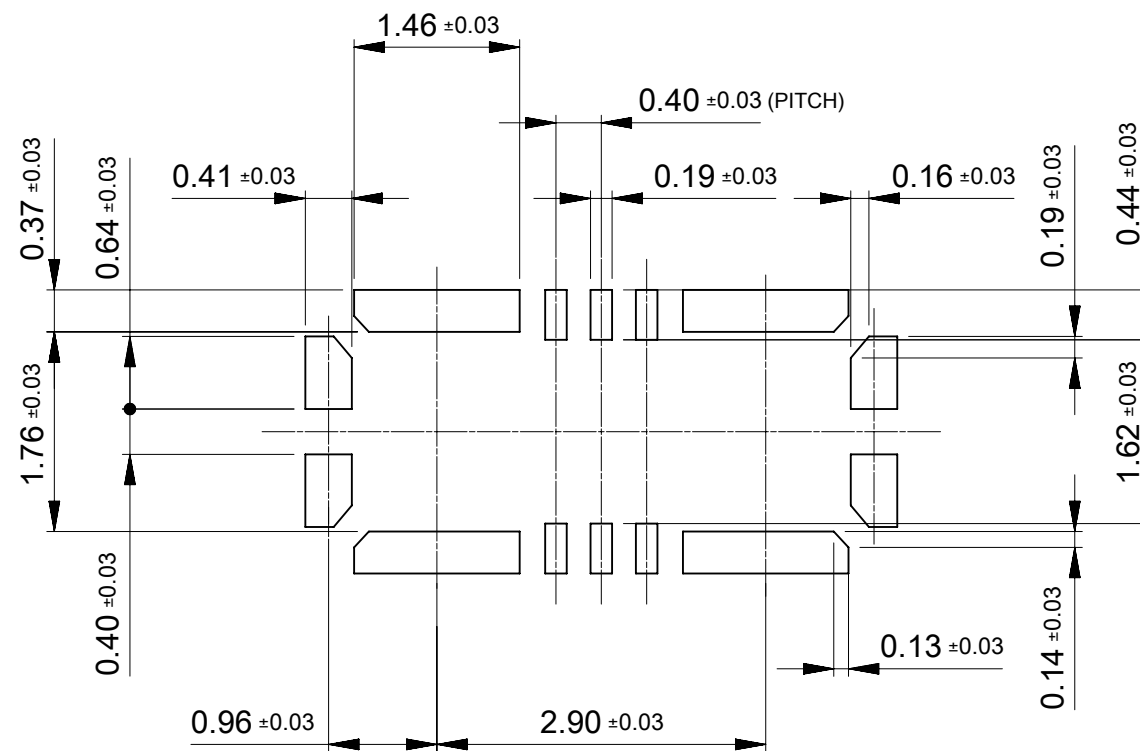

**RECOMMENDED METAL MASK LAYOUT**  
(FOR REFERENCE)

RECOMMENDED THICKNESS : 0.08mm  
RECOMMENDED APERTURE DIMENSION IS JUST SAME AS SHOWN FIGURE ABOVE.  
FOR THIS DIMENSION, APERTURE RATIO ARE POWER, SIGNAL TERMINAL AND  
FITTING NAIL ALL 80%.

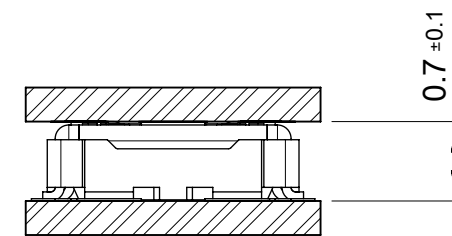
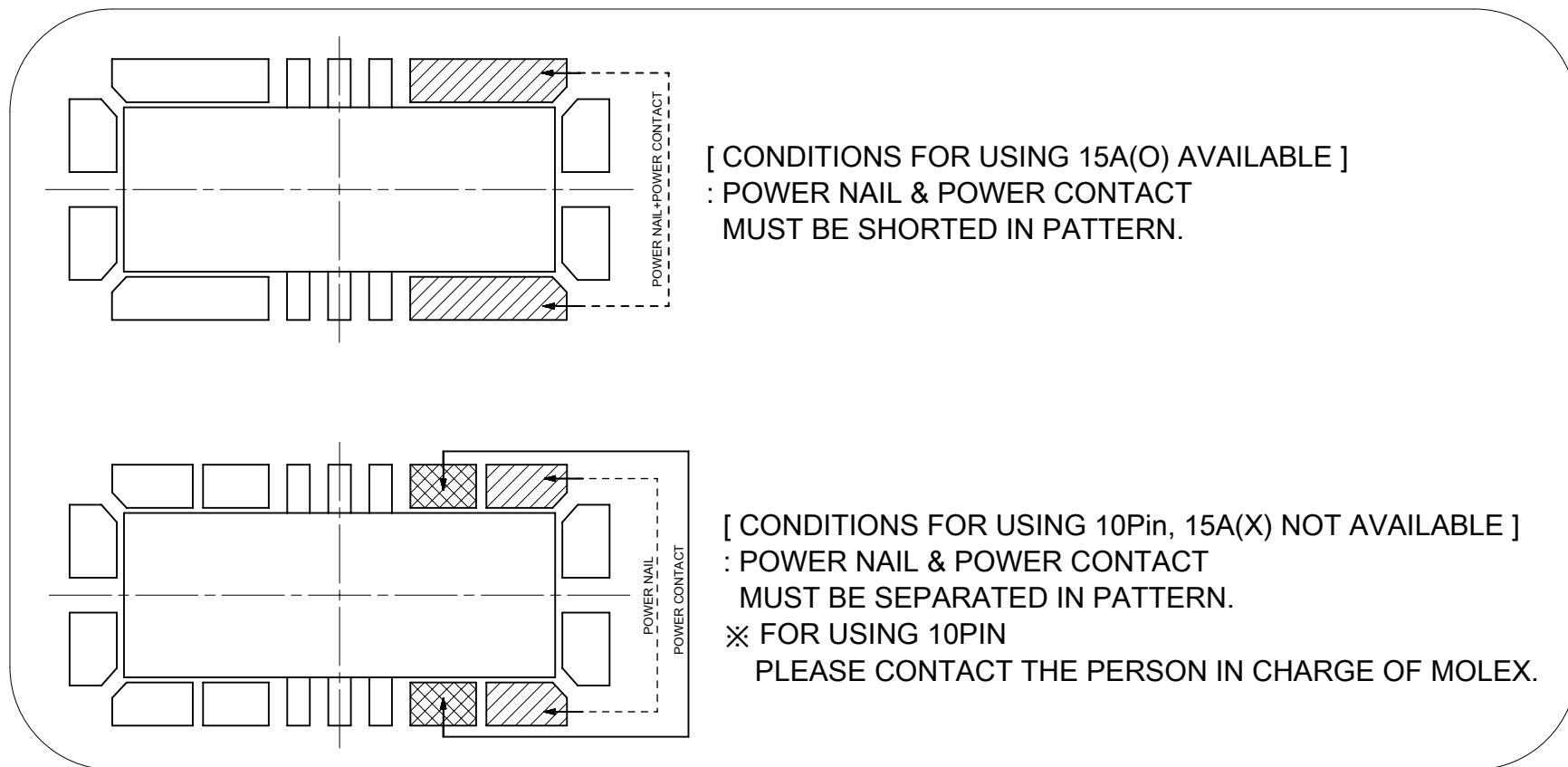

**MATING CONDITION**

THIS DIMENSION SHOWS A DIMENSION  
BETWEEN THE TAIL TO TAIL.

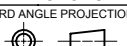
FUNCTIONAL SYMBOLS	THIS DRAWING CONTAINS INFORMATION THAT IS PROPRIETARY TO MOLEX ELECTRONIC TECHNOLOGIES, LLC AND SHOULD NOT BE USED WITHOUT WRITTEN PERMISSION		
	△A = 0	mm	SCALE 15:1
DIVISIONAL SYMBOLS	△E = 0	CURRENT REV DESC:	
	△F = 0	GENERAL TOLERANCES (UNLESS SPECIFIED)	
DIVISIONAL SYMBOLS	4 PLACES	± 0.1	ANGULAR TOL ± 3.0°
	3 PLACES	± 0.1	EC NO: 746459
	2 PLACES	± 0.1	DRWN: JHCHANG 2022/06/30
	1 PLACE	± 0.1	CHK'D: JBJIN 2023/04/19
	0 PLACES	± 0.2	APPR: JBJIN 2023/04/20
DRAFT WHERE APPLICABLE MUST REMAIN WITHIN DIMENSIONS		THIRD ANGLE PROJECTION	DRAWING SERIES MATERIAL NUMBER CUSTOMER SHEET NUMBER
			A3-SIZE 216656 SEE CHART GENERAL 2 OF 2

**molex**

0.4 BB CONN. H=0.7 NEW GCB7 REC ASSY FOR BATTERY(15A)

PRODUCT CUSTOMER DRAWING

DOCUMENT NUMBER 2166560100-SD DOC TYPE PSD DOC PART 001 REVISION A3

PULL OUT DIRECTION

REEL

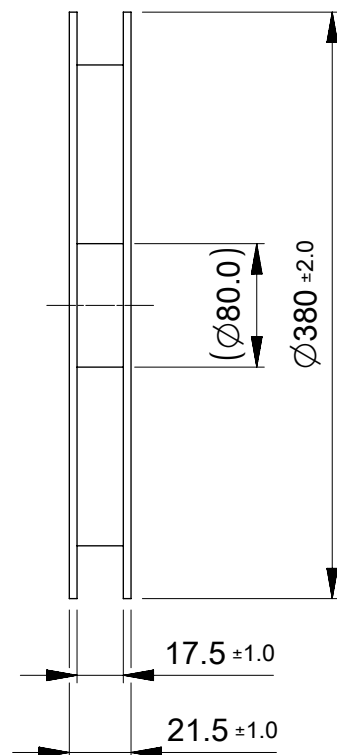
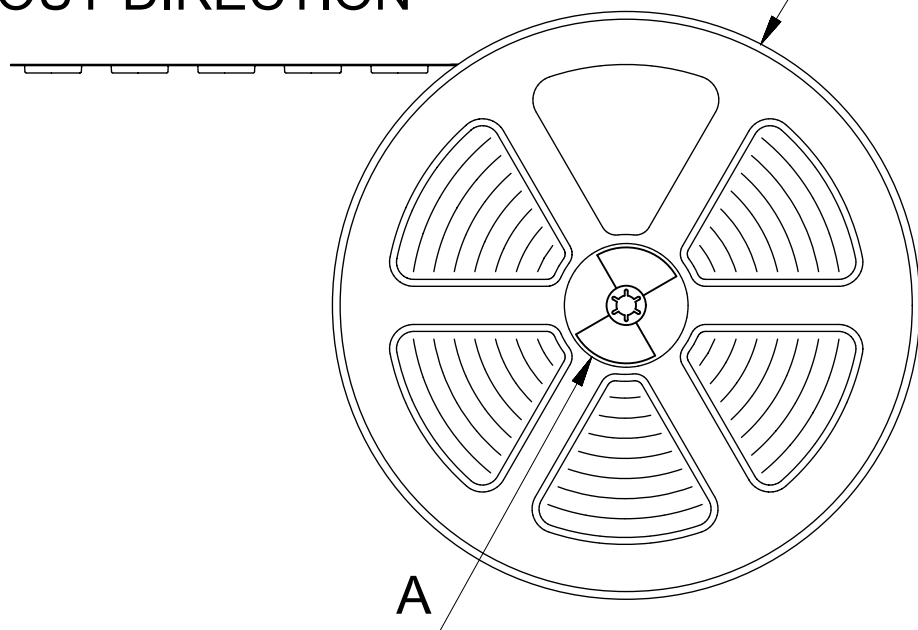

NOTES

1. RE DETAILED DIMENSION, SEE PRODUCT DRAWING.
2. NUMBER OF CONNECTORS : 15,000PCS/REEL
3. LEAD TAPE LENGTH :

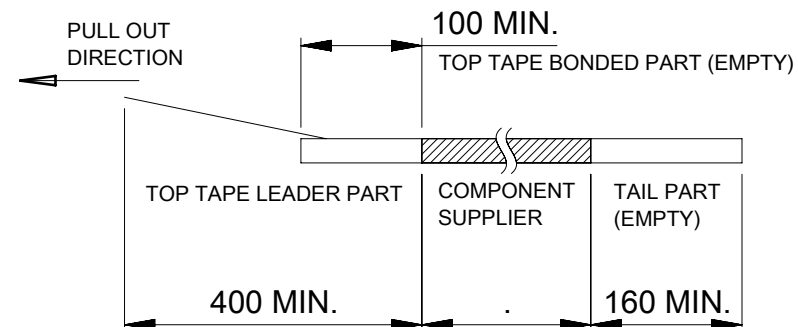

4. PEEL OFF FORCE OF THE TOP TAPE IS DEFINED BY IEC 60286-3.
5. MATERIAL
  - CARRIER TAPE : POLYSTYRENE OR PET
  - TOP TAPE : PET, OTHER
  - REEL : POLYSTYRENE(PS) [RECYCLE MATERIAL CONTAINED]

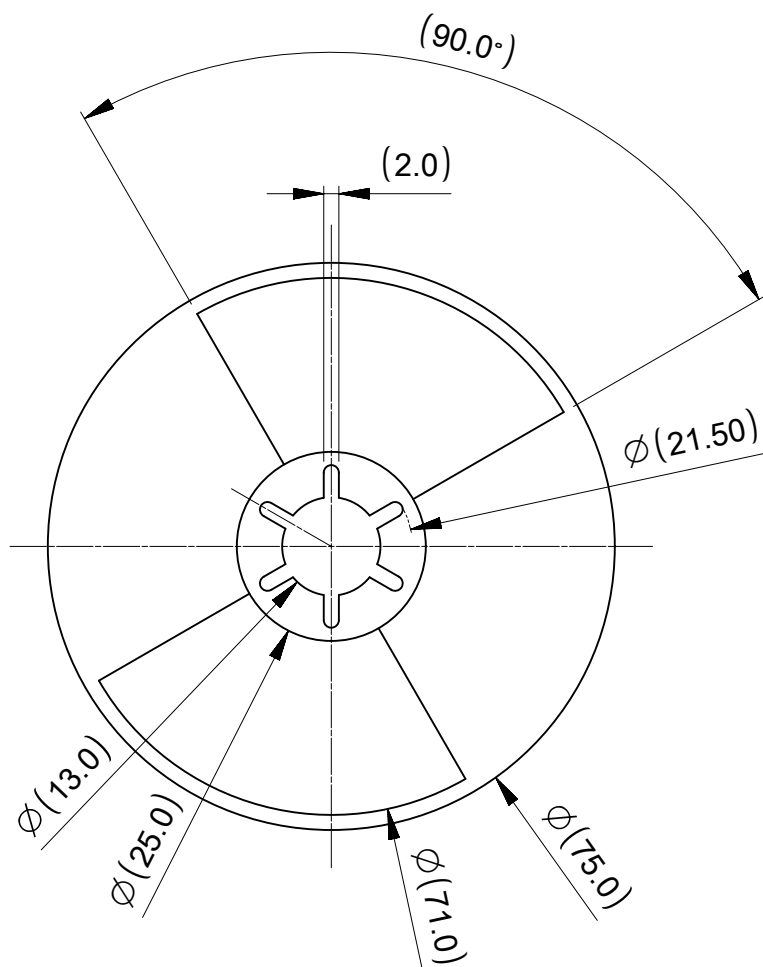

DETAIL "A"

FUNCTIONAL SYMBOLS	THIS DRAWING CONTAINS INFORMATION THAT IS PROPRIETARY TO MOLEX ELECTRONIC TECHNOLOGIES, LLC AND SHOULD NOT BE USED WITHOUT WRITTEN PERMISSION		CURRENT REV DESC:		<b>molex</b>
	$\nabla_A = 0$ $\nabla_E = 0$ $\nabla_P = 0$	DIMENSION UNITS: <b>mm</b> SCALE: <b>1:1</b>	GENERAL TOLERANCES (UNLESS SPECIFIED) ANGULAR TOL $\pm 3.0^\circ$ 4 PLACES $\pm 0.1$ 3 PLACES $\pm 0.1$ 2 PLACES $\pm 0.1$ 1 PLACE $\pm 0.1$ 0 PLACES $\pm 0.2$		
DIVISIONAL SYMBOLS	INITIAL REVISION: DRWN: JHCHANG 2023/04/17 APPR: JBJIN 2023/04/20		DOCUMENT NUMBER: <b>2166560101-SD</b> DOC TYPE: PSD DOC PART: 000 REVISION: A		PRODUCT CUSTOMER DRAWING
DRAFT WHERE APPLICABLE MUST REMAIN WITHIN DIMENSIONS		THIRD ANGLE PROJECTION	DRAWING: <b>A3-SIZE</b>	SERIES: <b>216656</b>	

← PULL OUT DIRECTION

EMBOSS CARRIER TAPE

TOP TAPE

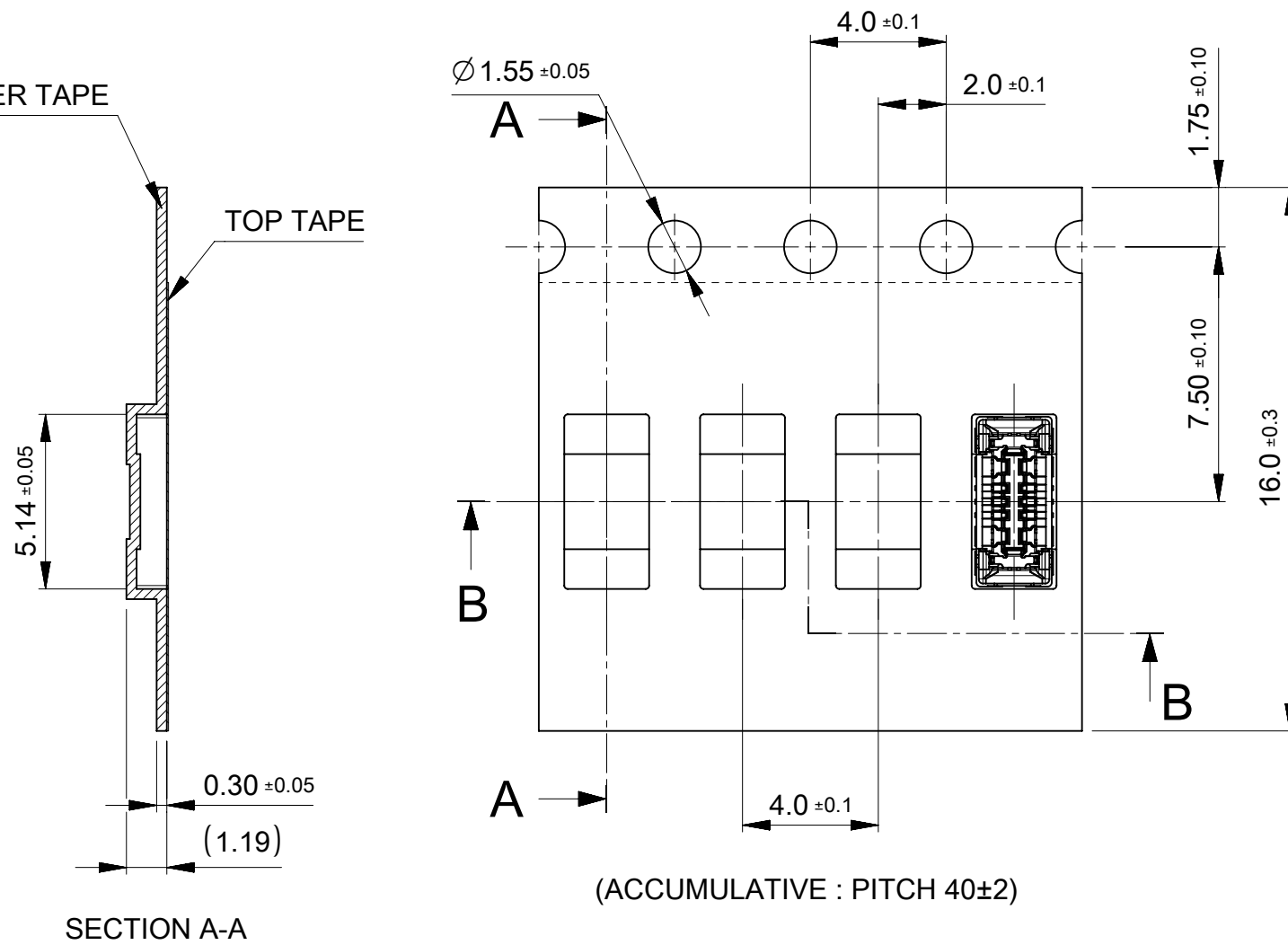

SECTION A-A

(ACCUMULATIVE : PITCH 40±2)

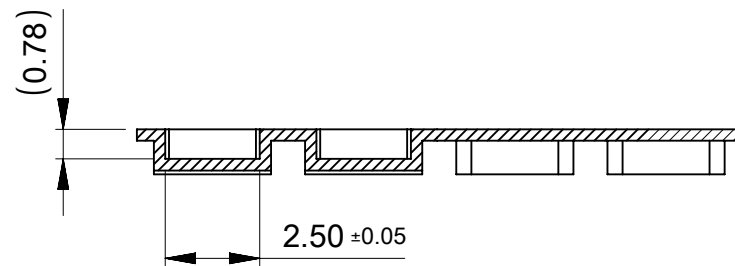

SECTION B-B

2166560109	O	---	6+4P
EMBOSSED TAPE PACKAGE	HIGH VOL. TOOL	LOW VOL. TOOL	Ckts
ORDER No.	SAMPLE PREPARATION		
	O : TOOLED		
	□ : WORK PROCESS		
		---	
CONNECTOR SERIES No. : 2166560**0			

FUNCTIONAL SYMBOLS	THIS DRAWING CONTAINS INFORMATION THAT IS PROPRIETARY TO MOLEX ELECTRONIC TECHNOLOGIES, LLC AND SHOULD NOT BE USED WITHOUT WRITTEN PERMISSION		CURRENT REV DESC:		<b>molex</b>				
	△/A = 0	mm							SCALE 5:1
DIVISIONAL SYMBOLS	GENERAL TOLERANCES (UNLESS SPECIFIED)		EC NO: 746459		0.4 BB H=0.7 GCB7-PLUS REC ASSY PKG FOR BATTERY(15A)				
	△/E = 0	ANGULAR TOL ± 3.0°		DRWN: JHCHANG					2023/04/19
DIVISIONAL SYMBOLS	4 PLACES	± 0.1	CHK'D: JBJIN	2023/04/19	PRODUCT CUSTOMER DRAWING				
	3 PLACES	± 0.1	APPR: JBJIN	2023/04/20					
	2 PLACES	± 0.1	INITIAL REVISION:		DOCUMENT NUMBER		DOC TYPE	DOC PART	REVISION
	1 PLACE	± 0.1	DRWN: JHCHANG	2023/04/17	2166560101-SD		PSD	000	A
0 PLACES	± 0.2	APPR: JBJIN	2023/04/20	MATERIAL NUMBER		CUSTOMER		SHEET NUMBER	
DRAFT WHERE APPLICABLE MUST REMAIN WITHIN DIMENSIONS		THIRD ANGLE PROJECTION	DRAWING	SERIES	MATERIAL NUMBER	CUSTOMER		SHEET NUMBER	
			A3-SIZE	216656	SEE SHEET2	GENERAL		2 OF 2	