



**ANATECH ELECTRONICS INC**  
RF & Microwave Filters & Products

# Cellular 900 MHz Bandpass

**Part Number: AB915B494**



## Electrical specifications

**Center Frequency:** 915 MHz  
**Bandwidth:** 26 MHz  
**Input / Output Impedance:** 50 Ohms  
**Passband:** 902-928 MHz  
**Passband Insertion Loss:** 1.5dB  
**Passband Ripple:** <0.2 dB  
**Passband Return Loss:** 20dB  
**Rejection @ 850~894MHz:** >45dB  
**Rejection @ 936~950MHz:** >45dB  
**Power Handling:** 30 W

## Mechanical

**Mounting Method:** Threaded Mounting Holes  
**Connector Type:** N-Type Female  
**Dimensions:** 120 x 60 x 48 mm

## Environmental

**Operating Temperature:** -45 to +85 deg.C  
**Storage Temperature:** -55 to +95 deg.C  
**Shock:** 20 G. 11ms  
**Vibration:** 20 G. 5 to 200 Hz

## Outline Drawing:

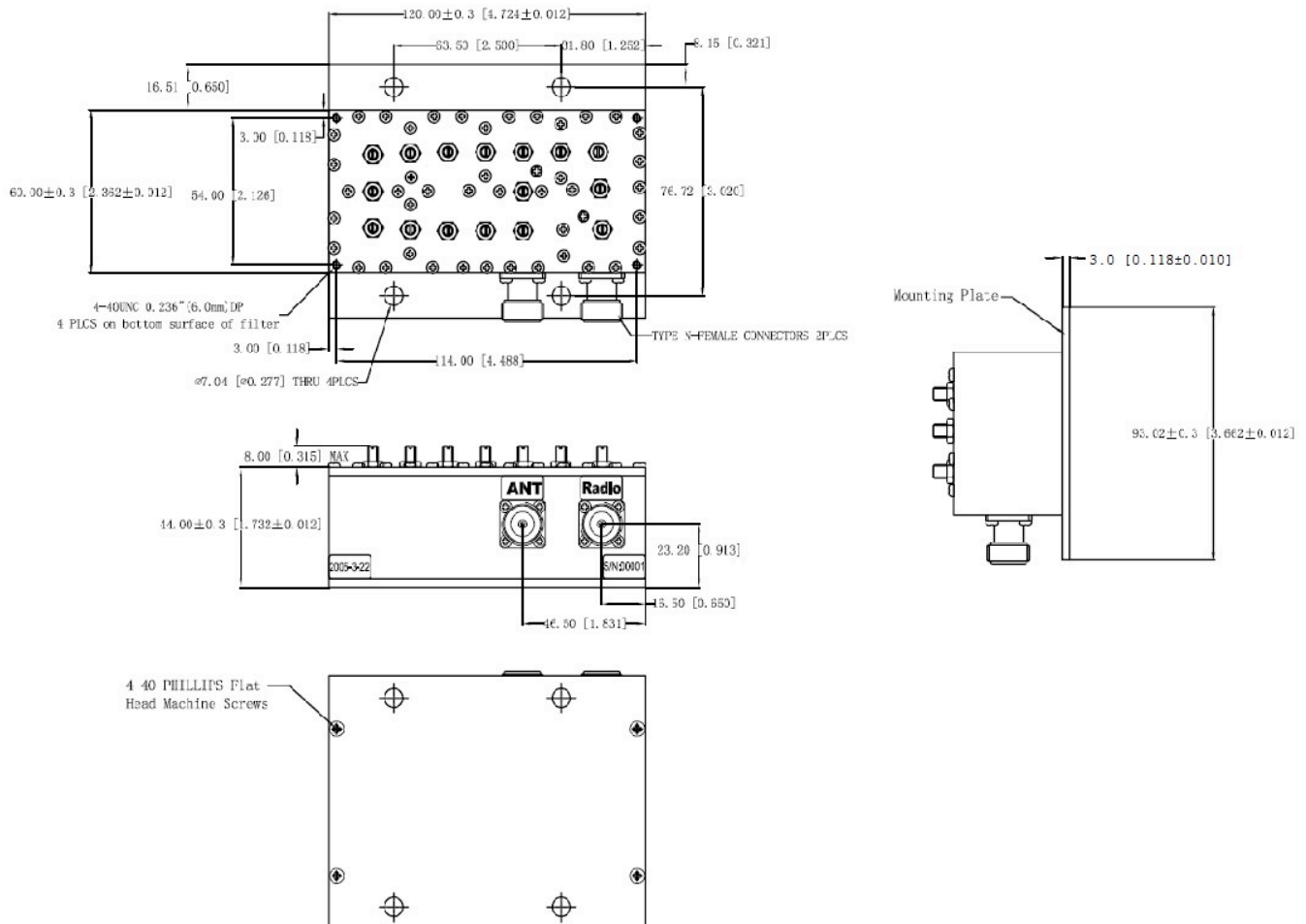

Tolerance: +/-0.01 inches [+/- 0.3mm]

Angles: +/- 1 Deg.

\*Tolerance as shown unless otherwise specified in the datasheet electrical specification tables above.

\*When max dimensions are called out the above tolerances do not apply as long as it is under the max call out.



**ANATECH ELECTRONICS INC**  
RF & Microwave Filters & Products

# Cellular 900 MHz Bandpass

**Part Number: AB915B494**



## Response Plot:

