

# 3824X625H

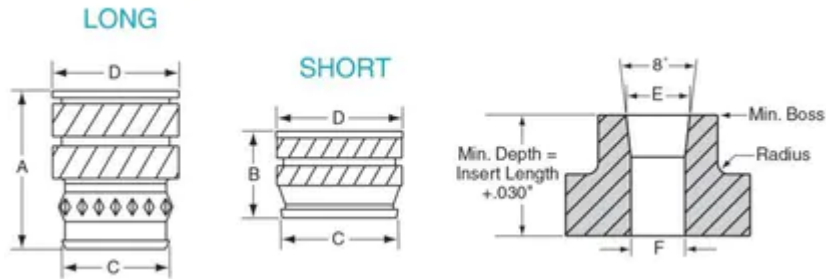

|             |          |
|-------------|----------|
| A           | 0.625 in |
| Boss Size   | 1.08 in  |
| Brand       | RAF      |
| C           | 0.493 in |
| D           | 0.563 in |
| F           | 0.488 in |
| Finish      | None     |
| Length E    | 0.54 in  |
| Material    | Brass    |
| Series      | H        |
| Thread Size | 3/8-24   |

## PRODUCT OPTIONS

|                                            |
|--------------------------------------------|
| <b>Finish</b>                              |
| None                                       |
| Black Oxide (25)                           |
| Bright Dip (13)                            |
| Bright Tin over Copper<br>Flash (14)       |
| Cad Plate - Clear<br>Chromate (2)          |
| Cad Plate - Clear<br>Chromate - Commercial |



|                                        |
|----------------------------------------|
| (1)                                    |
| Cad Plate - Yellow<br>Chromate (3)     |
| Chrome - Bright (10)                   |
| Chrome - Satin (11)                    |
| Chrome over Nickel (4)                 |
| Electro Tin (16)                       |
| Electro Tin - Nickel<br>Undercoat (44) |
| Electro Tin - Solder 60/40<br>(27)     |
| Hot Tin Dip (15)                       |
| Nickel (5)                             |
| Nickel - Ductile (37)                  |
| Zinc - Black (42)                      |
| Zinc - Blue (43)                       |
| Zinc - Clear Chromate<br>(12)          |
| Zinc - Yellow Chromate<br>(28)         |

