

MATERIAL: STEEL

FINISH: COMMERCIAL ZINC PLATING

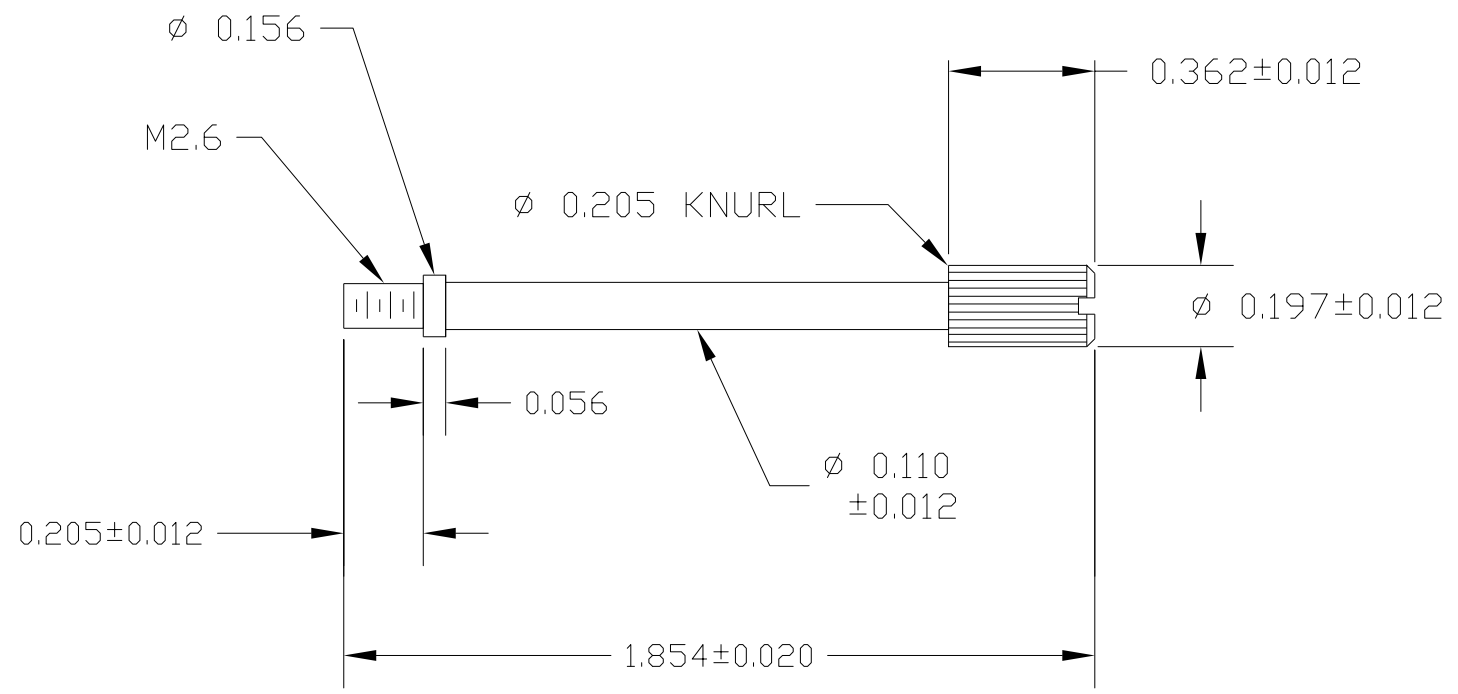

FOR USE IN SERIES\*\* #'S: 952, 970, 971\*, 972  
 \*FOR 971, CAN ONLY BE USED TO REPLACE (1) SCREW DUE TO INTERFERENCE  
 \*\* PLEASE ENSURE FIT AND FUNCTION ARE SUITABLE FOR YOUR APPLICATION

RoHS COMPLIANT

UNITS = INCHES [MM] DO NOT SCALE FROM DRAWING



THESE DRAWINGS AND SPECIFICATIONS ARE THE PROPERTY OF NorComp AND SHALL NOT BE REPRODUCED, COPIED OR USED AS THE BASIS FOR THE MANUFACTURE OR SALE OF APPARATUS WITHOUT WRITTEN PERMISSION.

DRAWN:  
 J. KADEL  
 DATE:  
 10/29/2018

**NorComp**

SCALE: NTS	SHEET 1	OF 1	REV 8
DWG NO.		160-000-060R031	