

# ERK610Z221KYRD

Aliases (C811YR221K440X, ERK610RK3220KYRD)

Obsolete

ERK610 SFTY X1-440 Y2-300, Ceramic, 220 pF, 10%, 440 VAC (X1), 300 VAC (Y2), Y5T, Lead Spacing = 10mm

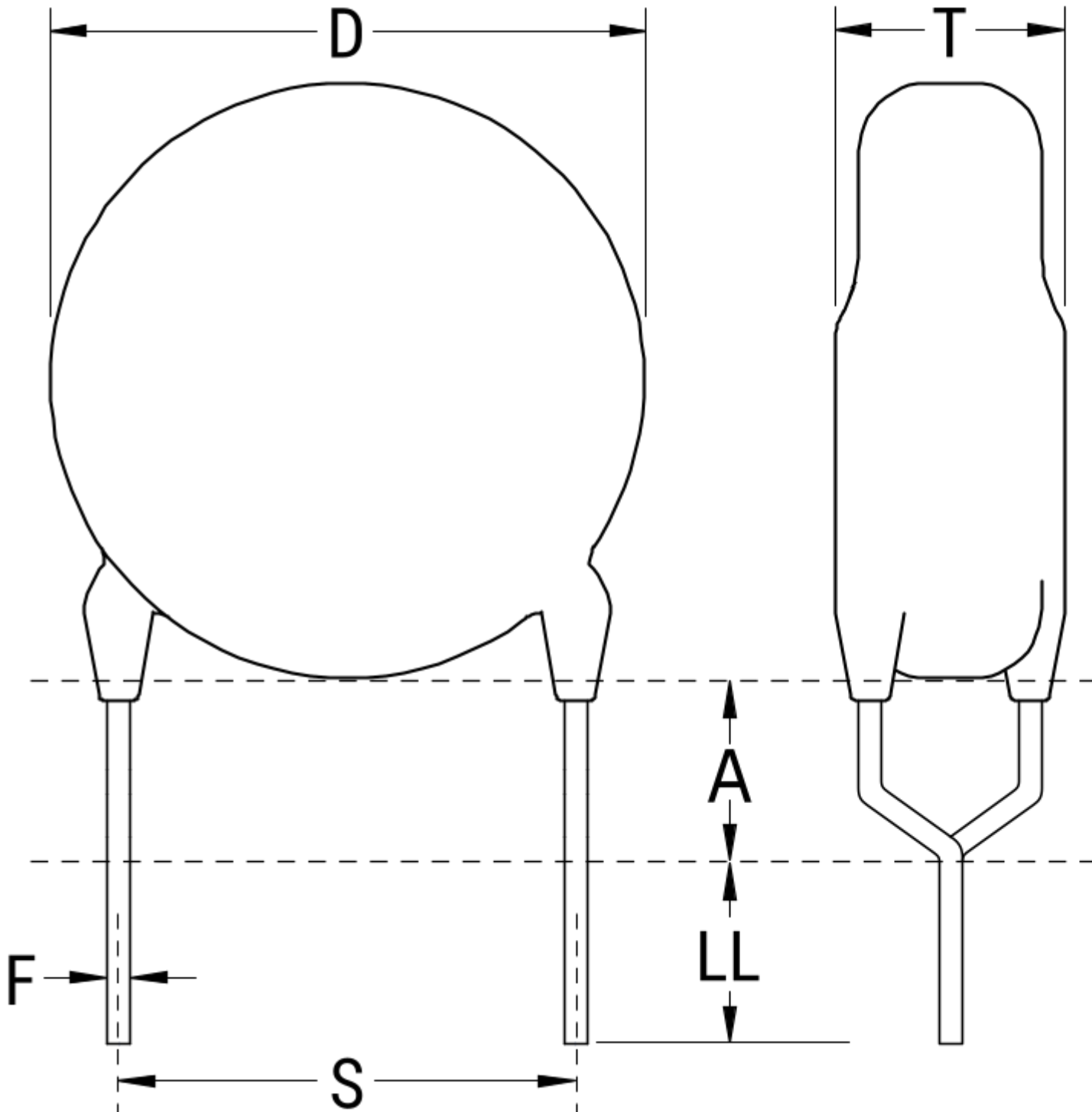

Click [here](#) for the 3D model.

### Dimensions

D 8mm MAX  
T 6mm MAX  
S 10mm +/-0.8mm  
H0 16mm +/-0.5mm  
F 0.6mm +/-0.05mm  
A 6mm MAX  
V 1.9mm +/-0.5mm

### Packaging Specifications

Packaging T&R, H0 = 16mm, Component Pitch = 25.4mm

### General Information

Series ERK610 SFTY X1-440 Y2-300  
Style Radial Disc  
Description Ceramic Single Layer Safety Disc Capacitors  
RoHS Yes  
Termination Tin  
Qualifications UL, CSA, CAN, ENEC, VDE  
AEC-Q200 No  
Notes Please See Bulletin For Taping Information. H0 Dimension Refers to Seating Plane To Center Hole of Tape.

### Specifications

Capacitance 220 pF  
Capacitance Tolerance 10%  
Voltage AC 440 VAC (X1), 300 VAC (Y2)  
Temperature Range -40/+125°C  
Temperature Coefficient Y5T  
Dissipation Factor 2.5%  
Insulation Resistance 6 GOhms  
Safety Class X1/Y2

Statements of suitability for certain applications are based on our knowledge of typical operating conditions for such applications, but are not intended to constitute - and we specifically disclaim - any warranty concerning suitability for a specific customer application or use. This Information is intended for use only by customers who have the requisite experience and capability to determine the correct products for their application. Any technical advice inferred from this Information or otherwise provided by us with reference to the use of our products is given gratis, and we assume no obligation or liability for the advice given or results obtained.

Generated 5/18/2023 - 7af80288-a92f-432f-b57d-8234842d3a81  
© 2006 - 2023 KEMET  
Generated 5/18/2023 - 7af80288-a92f-432f-b57d-8234842d3a81  
© 2006 - 2023 KEMET