

4

3

2

1

THIS DRAWING IS UNPUBLISHED.

RELEASED FOR PUBLICATION

ALL RIGHTS RESERVED.

© COPYRIGHT - By -

REVISIONS

P	LTR	DESCRIPTION	DATE	DWN	APVD
G1		REVISED PER ECO-14-003208	14MAR2014	NK	DR
G2		REVISED PER ECO-17-008114	05JUN2018	RS	DR

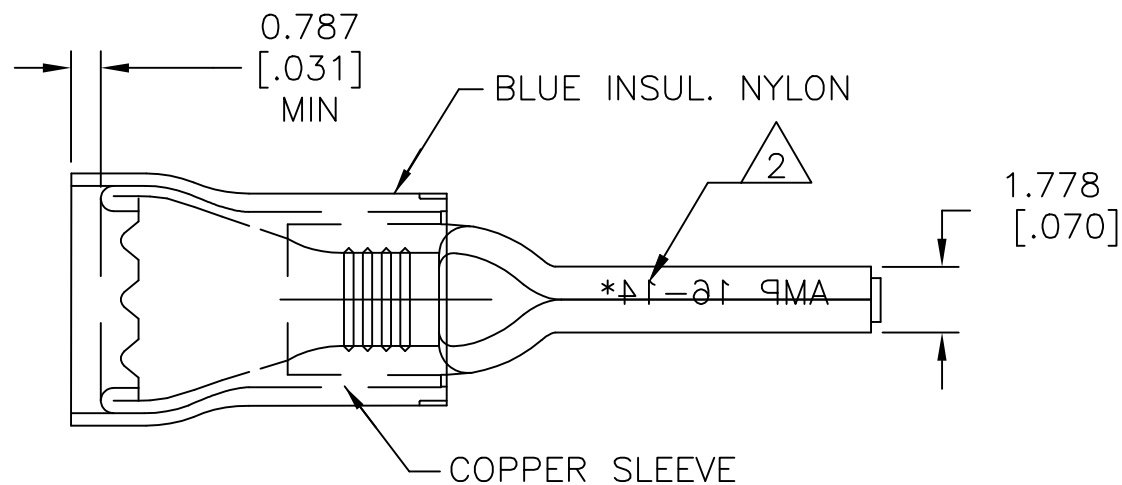

AMP WIRE RANGE	RA FILE E13288
1.0-2.6mm ² (16-14 AWG) STRANDED	16-14 AWG STRANDED

- 1 WIRE INSULATION DIA "A" MAX, SEE TABLE
- △ 2 STAMP AMP 16-14* APPROX AS SHOWN
- 3 MAX OPERATING TEMPERATURE 105°C [221°F]

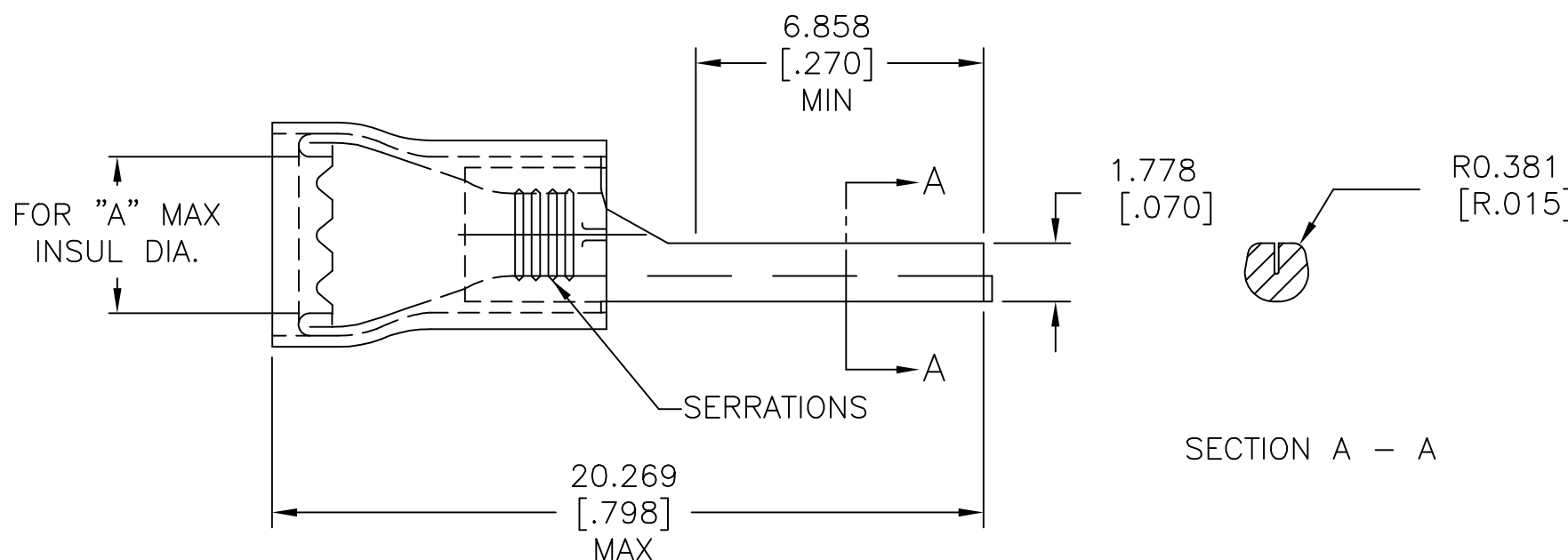

1000	4.394 [.173]	TIN PLATED	COPPER	165046
PACKAGE QTY	DIM "A"	FINISH	MATERIAL	PART NO

THIS DRAWING IS A CONTROLLED DOCUMENT.		DWN JR RUTH 01JUN07	TE TE Connectivity Ltd.	
DIMENSIONS: mm [INCHES]		CHK T MICHIELUTTI 01JUN07		
TOLERANCES UNLESS OTHERWISE SPECIFIED:		APVD T MICHIELUTTI 01JUN07	NAME PIDG WIRE PIN 16-14 AWG	
0 PLC ± - 1 PLC ± - 2 PLC ± - 3 PLC ± 0.127 [.005] 4 PLC ± - ANGLES ± -		PRODUCT SPEC UL 486 A-B	SIZE A3	
MATERIAL SEE TABLE		APPLICATION SPEC 114-2157	CAGE CODE 00779	DRAWING NO 165046
FINISH SEE TABLE		WEIGHT -	RESTRICTED TO -	
CUSTOMER DRAWING			SCALE 5:1	SHEET 1 of 1
			REV G2	