

SIGN	DATE	DESCRIPTION	APPROVER
△	2016.11.13	Part change Rev. D	SHIN
△	2018.10.23	Corrected dimension of board lock to pcb pin	SHIN
<i>THIS IS CAD DRAWING, DO NOT REVISE MANUALLY!!</i>			

**Material**

- Insulator: Glass filled Polyester
- Flammability: UL94V-0
- Contacts: Phosphor Bronze
- Contact Plating: See options
- Shell: Copper Alloy, 80u Ni over 50u Cu

**Ratings**

- Current: 1.5A
- Voltage: 30V AC(r.m.s.)
- Dielectric Withstanding Voltage: 500V AC at sea level
- Contact Resistance: <math>\lt; 30\text{m}\Omega</math>
- Insulation Resistance: >1,000 MΩ
- Operating Temperature: -55° ~ +85°
- Mating Force: 3.5Kg Max
- Umating Force: 1Kg. Min

RoHS Compliant

PART NUMBER:

**USB-A1VSXX**

COLOR:  
B: Black  
W: White

PLATING:  
6: Selective Au Flash/50u" Ni  
8: Selective 30u" Au/50u" Ni (USB 2.0)

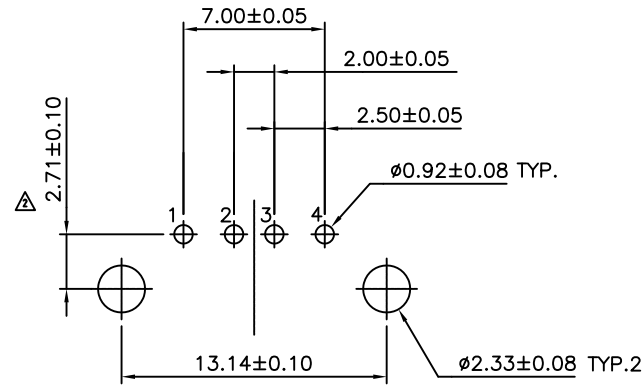
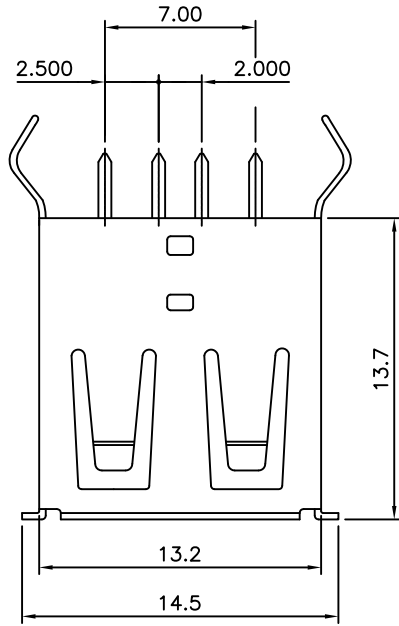

Recommended P.C. Board Layout

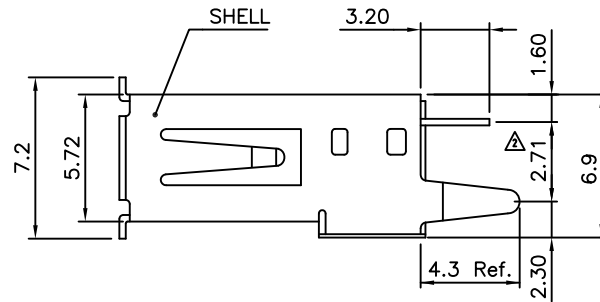
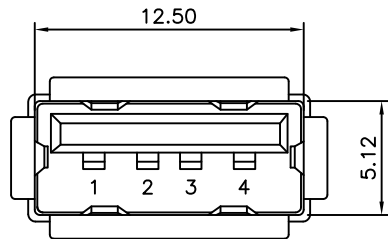

THESE DRAWINGS AND SPECIFICATIONS ARE THE PROPERTY OF ON-SHORE TECHNOLOGY, INC. AND SHALL NOT BE REPRODUCED, COPIED OR USED IN ANY MANNER WITHOUT THE PRIOR WRITTEN CONSENT OF ON-SHORE TECHNOLOGY, INC.



TITLE		USB - A type, Vertical, thru hole, single port		
PART NO.	USB-A1VSXX	DWG NO.	USB-A1VSXX.DWG	
APPROVED	CHECKED	DESIGNED	DRAWN	4050
	Sandy 2016.03.04	Sandy 2016.03.04	Sandy 2016.03.04	Tolerance
				X° ±1°
				XX ±0.30
				XXX ±0.25
				XXXX ±0.15
			SHEET: 01/01	UNIT: mm
				SCALE: NONE
				REV.: D