

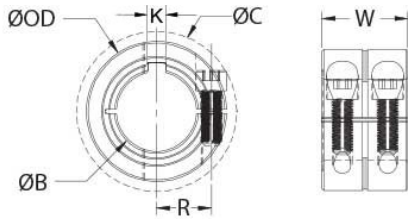

MWCLK-8-F

Ruland MWCLK-8-F, 8mm Double Wide Shaft Collar, Black Oxide Steel, One-Piece Clamp Style with Keyway, 18mm OD, 19.6mm Width



Description

Ruland MWCLK-8-F is a one-piece shaft collar with a 8mm bore, 2mm keyway, 18mm OD, and 19.6mm width. The clamp style design does not mar the shaft, is easy to remove, and is indefinitely adjustable. It is commonly used for guiding, spacing, stopping, mounting, and component alignment. Equipment manufacturers benefit from the tightly controlled face to bore perpendicularity (TIR of ? .05mm). Perpendicularity is critical for alignment when the shaft collar is used as a load bearing face, mechanical stop, or for mounting components such as gears or bearings. Proprietary processes have been developed by Ruland to maintain superior fit, finish, and holding power. MWCLK-8-F is stamped with the Ruland name and bore size for ease of identification. This double wide shaft collar has 25% higher axial holding power than a round bore of equivalent size. It can also be used as a short rigid coupling for applications where a traditional rigid coupling is too long. Forged screws test beyond DIN 912 12.9 standards to ensure maximum holding power. MWCLK-8-F is machined from solid bar stock to a fine burr free finish and sourced exclusively from North American mills. Ruland uses 1215 lead-free steel with a proprietary black oxide finish that produces a fine glossy finish while increasing holding power and resisting corrosion. It is RoHS3 and REACH compliant and manufactured in our Marlborough, MA factory under strict controls using proprietary processes.

Product Specifications

Bore (B)	8 mm	Bore Tolerance	+0.050 mm / +0.012 mm
Keyway (K)	2 mm	Width (W)	19.6 mm
Outer Diameter (OD)	18 mm	Width Tolerance	+0.076 mm / -0.254 mm
Clearance Diameter (C) MAX	22.4 mm	Recommended Shaft Tolerance	+0.000 mm / -0.013 mm
Forged Clamp Screw	M3	Screw Material	Alloy Steel
Hex Wrench Size	2.5 mm	Screw Finish	Black Oxide
Seating Torque	2.1 Nm	Screw Location (R)	6.50 mm
Number of Screws	2 ea	Material Specification	1215 Carbon Steel Bar
Temperature	-40°F to 350°F (-40°C to 176°C)	Finish Specification	Hot Process Black Oxide, Impregnated with Naphthenic Oil, Centrifugally Dried
Moment of Inertia	$1.360 \times 10^{-6} \text{ kg-m}^2$	Manufacturer	Ruland Manufacturing
Country of Origin	USA	Weight (lbs)	0.060800
UPC	634529305591	UNSPC	31162811
Tariff Code	8483.60.8000		
Note 1	Performance ratings are for guidance only. The user must determine suitability for a particular application.		
Prop 65	⚠ WARNING This product can expose you to the chemical Ethylene Thiourea		

Installation Instructions

1. Use the MWCLK-8-F double wide shaft collar as it is received.
2. Wipe the bore clean.
3. Apply a thin coat of light oil to the shaft.
4. Tighten the screws in two stages, starting with the inside screws. Using a torque wrench with 2.5 mm bit, tighten the inside screws to 1.05 Nm which is half the recommended seating torque. Repeat for the outside screws, again tightening to half of the recommended seating torque.
5. Tighten the screws to the full recommended seating torque of 2.1 Nm following the same pattern, starting with the inside screws first.