

**DESCRIPTION: SCSI 1 FEMALE RIGHT ANGLE CONNECTOR/BACKSHELL KIT**

**A B C D**

36	DISCONTINUED			
50	3.780	2.538	1.325	.646
	96.00	64.47	33.65	16.40

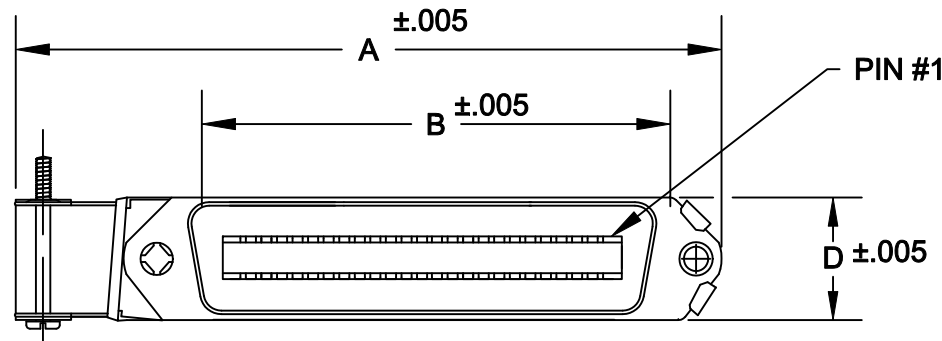
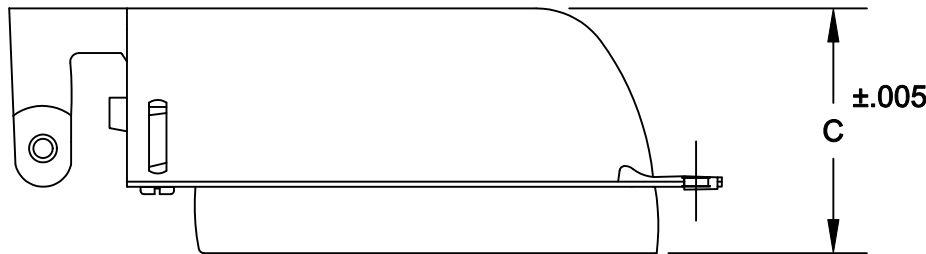

**KIT INCLUDES:**

**SOLDER CUP CONNECTOR  
BACKSHELL/HARDWARE**

112-YYY-203L021

SERIES \_\_\_\_\_

POSITIONS \_\_\_\_\_

050 \_\_\_\_\_

GENDER \_\_\_\_\_

2 = FEMALE \_\_\_\_\_

TERMINATION \_\_\_\_\_

0 = SOLDER CUP \_\_\_\_\_

SHELL PLATING \_\_\_\_\_

3 = NICKEL \_\_\_\_\_

HARDWARE OPTIONS \_\_\_\_\_

02 = PIN #1 OPPOSITE CABLE ENTRY \_\_\_\_\_

PLATING OPTIONS \_\_\_\_\_

1 = GOLD FLASH \_\_\_\_\_

**MATERIALS:**

**INSULATOR: GLASS-FILLED THERMOPLASTIC  
UL RATED 94V-0**

**CONTACTS: COPPER ALLOY**

**SHELL: STEEL, NICKEL PLATED**

**CONTACT PLATING: GOLD FLASH IN THE MATING AREA  
BRIGHT TIN IN THE SOLDER AREA**

**RoHS COMPLIANT**

**ELECTRICALS:**

**CONTACT CURRENT RATING: 5 AMPS**

**DIELECTRIC WITHSTANDING VOLTAGE: AC 1200 R.M.S.**

**INSULATION RESISTANCE: 1000 mohms MINIMUM AT 500V DC**

**CONTACT RESISTANCE: 30 mOHMS MAXIMUM**

**OPERATING TEMPERATURE: -55°C TO +125°C**

**NOTE: PLEASE NOTE ORIENTATION OF CONNECTOR IN REGARDS TO  
CABLE ENTRY.**



THESE DRAWINGS AND SPECIFICATIONS ARE THE PROPERTY OF NorComp AND SHALL NOT BE REPRODUCED, COPIED OR USED AS THE BASIS FOR THE MANUFACTURE OF SALE OF APPARATUS WITHOUT WRITTEN PERMISSION.

DRAWN:  
**WAYNE ROBBINS**

DATE:  
**9-15-05**

CHECKED:

DATE:

**NorComp**

SCALE:  
1:1

SHEET **1** OF **1**

REV  
**3**

DWG NO. **112-YYY-203L021**