



- 1
- 2
- 3
- 4
- 5
- 6
- 7
- 8
- 9
- 10
- 11
- 12
- 13
- 14
- 15
- 16
- 17
- 18

STANDARD EXECUTIONS

- **DVA.4:** threaded stud and base plate in polished zinc-plated steel, vibration-damper body in natural rubber NR, black colour, hardness 40, 55, 70 Shore A ±5.
- **DVA.4-SST:** threaded stud and base plate in INOX AISI 304 stainless steel, vibration-damper body in natural rubber NR, black colour, hardness 55 Shore A ±5.

FEATURES AND APPLICATIONS

The rubber buffers have been designed to damp vibrations, shocks and noises produced by moving bodies or non-balanced vibrating masses of equipment and machines which can cause:

- malfunctioning and reduction of the machine lifespan and/or of the adjacent ones;
- damage to health;
- noise.

Load diagrams for each single code are available on request. See Technical data and guidelines for the choice (on page 728).

SPECIAL EXECUTIONS ON REQUEST

Natural rubber NR, hardness 40, 70 tolerance ±5 Shore A for executions with AISI 304 stainless steel base.

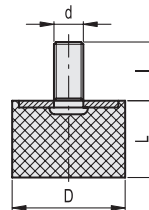

DVA.4

* Complete the description with the desired hardness: 40, 55 or 70 tolerance ±5 Shore A.

DVA.4 - 8 - 8 - M3 - 6 - 55
 D L d l Shore A

| Conversion Table | | | | | |
|-------------------|------|-----|------|----|------|
| 1 mm = 0.039 inch | | | | | |
| D | | | L | | |
| mm | inch | mm | inch | mm | inch |
| 8 | 0.31 | 50 | 1.97 | 8 | 0.31 |
| 10 | 0.39 | 60 | 2.36 | 10 | 0.39 |
| 15 | 0.59 | 70 | 2.76 | 13 | 0.51 |
| 20 | 0.79 | 75 | 2.95 | 15 | 0.59 |
| 25 | 0.98 | 80 | 3.12 | 17 | 0.67 |
| 30 | 1.18 | 100 | 3.94 | 20 | 0.79 |
| 40 | 1.57 | 125 | 4.92 | 25 | 0.98 |

DVA.4



| Description | D | L | d | l | ⚖️ | Hardness 40 Shore A | | | Hardness 55 Shore A | | | Hardness 70 Shore A | | | | | |
|--------------------|----|----|----|----|----|---------------------|--------------|---------------------|---------------------|--------|--------------|---------------------|------------------|--------|--------------|---------------------|------------------|
| | | | | | | Code | Max load [N] | Max deflection [mm] | Stiffness [N/mm] | Code | Max load [N] | Max deflection [mm] | Stiffness [N/mm] | Code | Max load [N] | Max deflection [mm] | Stiffness [N/mm] |
| DVA.4-8-8-M3-6* | 8 | 8 | M3 | 6 | 3 | 415201 | 34 | 2 | 17 | 412700 | 55 | 2 | 28 | 417901 | 141 | 2 | 71 |
| DVA.4-8-13-M3-6* | 8 | 13 | M3 | 6 | 1 | 415205 | 33 | 3 | 10 | 412699 | 50 | 3 | 15 | 417905 | 133 | 3 | 41 |
| DVA.4-10-10-M4-10* | 10 | 10 | M4 | 10 | 2 | 415211 | 54 | 3 | 21 | 412701 | 88 | 3 | 35 | 417911 | 217 | 3 | 87 |
| DVA.4-10-15-M4-10* | 10 | 15 | M4 | 10 | 3 | 415221 | 69 | 4 | 18 | 412703 | 92 | 4 | 25 | 417921 | 175 | 4 | 47 |
| DVA.4-10-20-M4-10* | 10 | 20 | M4 | 10 | 3 | 415223 | 54 | 5 | 11 | 412705 | 95 | 5 | 19 | 417923 | 156 | 5 | 31 |
| DVA.4-15-10-M4-10* | 15 | 10 | M4 | 10 | 4 | 415231 | 110 | 2 | 55 | 412706 | 168 | 2 | 84 | 417931 | 410 | 2 | 205 |
| DVA.4-15-15-M4-10* | 15 | 15 | M4 | 10 | 5 | 415241 | 141 | 4 | 38 | 412709 | 259 | 4 | 69 | 417941 | 384 | 4 | 102 |
| DVA.4-15-20-M4-10* | 15 | 20 | M4 | 10 | 7 | 415251 | 134 | 5 | 27 | 412711 | 223 | 5 | 45 | 417951 | 590 | 5 | 118 |
| DVA.4-15-30-M4-10* | 15 | 30 | M4 | 10 | 9 | 415261 | 125 | 8 | 17 | 412716 | 258 | 8 | 34 | 417961 | 392 | 8 | 52 |
| DVA.4-20-5-M6-18* | 20 | 5 | M6 | 18 | 12 | 415266 | 1148 | 1 | 918 | 412718 | 11840 | 1 | 9472 | 417967 | 3250 | 1 | 2600 |
| DVA.4-20-8-M6-18* | 20 | 8 | M6 | 18 | 14 | 415267 | 560 | 2 | 280 | 412719 | 882 | 2 | 441 | 417969 | 1713 | 2 | 856 |
| DVA.4-20-10-M6-18* | 20 | 10 | M6 | 18 | 15 | 415271 | 390 | 3 | 156 | 412721 | 645 | 3 | 258 | 417971 | 940 | 3 | 376 |
| DVA.4-20-15-M6-18* | 20 | 15 | M6 | 18 | 10 | 415281 | 289 | 4 | 77 | 412741 | 468 | 4 | 125 | 417981 | 704 | 4 | 188 |
| DVA.4-20-20-M6-18* | 20 | 20 | M6 | 18 | 13 | 415291 | 258 | 5 | 52 | 412746 | 367 | 5 | 73 | 417991 | 809 | 5 | 162 |
| DVA.4-20-25-M6-18* | 20 | 25 | M6 | 18 | 17 | 415296 | 250 | 6 | 40 | 412748 | 345 | 6 | 55 | 417996 | 857 | 6 | 137 |
| DVA.4-20-30-M6-18* | 20 | 30 | M6 | 18 | 23 | 415301 | 237 | 8 | 32 | 412751 | 420 | 8 | 56 | 418001 | 848 | 8 | 113 |
| DVA.4-25-15-M6-18* | 25 | 15 | M6 | 18 | 18 | 415311 | 485 | 4 | 129 | 412756 | 797 | 4 | 213 | 418011 | 1627 | 4 | 434 |
| DVA.4-25-17-M6-18* | 25 | 17 | M6 | 18 | 20 | 415321 | 422 | 4 | 99 | 412761 | 833 | 4 | 196 | 418021 | 1726 | 4 | 406 |
| DVA.4-25-20-M6-18* | 25 | 20 | M6 | 18 | 20 | 415331 | 416 | 5 | 83 | 412766 | 581 | 5 | 116 | 418031 | 1382 | 5 | 276 |
| DVA.4-25-25-M6-18* | 25 | 25 | M6 | 18 | 23 | 415336 | 410 | 6 | 65 | 412768 | 645 | 6 | 103 | 418036 | 1500 | 6 | 240 |
| DVA.4-25-25-M8-18* | 25 | 25 | M8 | 18 | 22 | 415346 | 532 | 6 | 85 | 412773 | 650 | 6 | 104 | 418056 | 1120 | 6 | 179 |
| DVA.4-25-30-M6-18* | 25 | 30 | M6 | 18 | 25 | 415341 | 290 | 8 | 39 | 412771 | 591 | 8 | 79 | 418041 | 1186 | 8 | 158 |

Vibration damping elements

DVA.4

METRIC

| Description | D | L | d | I | △ | Hardness 40 Shore A | | | Hardness 55 Shore A | | | Hardness 70 Shore A | | | | | |
|-----------------------|-----|----|-----|----|------|---------------------|--------------|---------------------|---------------------|--------|--------------|---------------------|------------------|--------|--------------|---------------------|------------------|
| | | | | | | Code | Max load [N] | Max deflection [mm] | Stiffness [N/mm] | Code | Max load [N] | Max deflection [mm] | Stiffness [N/mm] | Code | Max load [N] | Max deflection [mm] | Stiffness [N/mm] |
| DVA.4-30-15-M8-20-* | 30 | 15 | M8 | 20 | 30 | 415351 | 746 | 4 | 199 | 412776 | 1023 | 4 | 273 | 418051 | 2610 | 4 | 696 |
| DVA.4-30-17-M8-20-* | 30 | 17 | M8 | 20 | 31 | 415361 | 772 | 4 | 182 | 412781 | 1275 | 4 | 300 | 418061 | 2447 | 4 | 576 |
| DVA.4-30-20-M8-20-* | 30 | 20 | M8 | 20 | 35 | 415371 | 567 | 5 | 113 | 412801 | 1014 | 5 | 203 | 418071 | 1878 | 5 | 376 |
| DVA.4-30-22-M8-20-* | 30 | 22 | M8 | 20 | 36 | 415376 | 689 | 5 | 125 | 412806 | 1103 | 5 | 200 | 418076 | 1996 | 5 | 362 |
| DVA.4-30-25-M8-20-* | 30 | 25 | M8 | 20 | 38 | 415381 | 576 | 6 | 92 | 412811 | 1026 | 6 | 164 | 418081 | 1591 | 6 | 255 |
| DVA.4-30-30-M8-20-* | 30 | 30 | M8 | 20 | 43 | 415391 | 601 | 8 | 80 | 412821 | 776 | 8 | 103 | 418091 | 1616 | 8 | 215 |
| DVA.4-30-40-M8-20-* | 30 | 40 | M8 | 20 | 48 | 415396 | 580 | 10 | 58 | 412826 | 910 | 10 | 91 | 418096 | 1780 | 10 | 178 |
| DVA.4-40-20-M8-23-* | 40 | 20 | M8 | 23 | 55 | 415401 | 1200 | 5 | 240 | 412831 | 2500 | 5 | 500 | 418101 | 4750 | 5 | 950 |
| DVA.4-40-20-M10-23-* | 40 | 20 | M10 | 23 | 54 | 415433 | 1027 | 5 | 205 | 412866 | 1907 | 5 | 381 | 418133 | 3230 | 5 | 646 |
| DVA.4-40-25-M8-23-* | 40 | 25 | M8 | 23 | 60 | 415411 | 1170 | 6 | 187 | 412836 | 1660 | 6 | 266 | 418111 | 4130 | 6 | 661 |
| DVA.4-40-25-M10-23-* | 40 | 25 | M10 | 23 | 59 | 415434 | 975 | 6 | 156 | 412868 | 1925 | 6 | 308 | 418134 | 2880 | 6 | 460 |
| DVA.4-40-28-M8-23-* | 40 | 28 | M8 | 23 | 62 | 415435 | 1012 | 7 | 145 | 412838 | 1748 | 7 | 249 | 418116 | 3060 | 7 | 437 |
| DVA.4-40-30-M8-23-* | 40 | 30 | M8 | 23 | 73 | 415421 | 1140 | 8 | 152 | 412841 | 1480 | 8 | 197 | 418121 | 2830 | 8 | 377 |
| DVA.4-40-35-M10-23-* | 40 | 35 | M10 | 23 | 78 | 415436 | 940 | 8 | 107 | 412871 | 1572 | 8 | 179 | 418135 | 3680 | 8 | 420 |
| DVA.4-40-38-M8-23-* | 40 | 38 | M8 | 23 | 80 | 415437 | 970 | 9 | 102 | 412851 | 1492 | 9 | 157 | 418126 | 3370 | 9 | 354 |
| DVA.4-40-40-M8-23-* | 40 | 40 | M8 | 23 | 83 | 415431 | 995 | 10 | 100 | 412861 | 1403 | 10 | 140 | 418131 | 3150 | 10 | 315 |
| DVA.4-40-40-M10-23-* | 40 | 40 | M10 | 23 | 82 | 415438 | 1040 | 10 | 104 | 412875 | 1575 | 10 | 157 | 418136 | 3130 | 10 | 313 |
| DVA.4-40-45-M10-23-* | 40 | 45 | M10 | 23 | 85 | 415439 | 1005 | 11 | 89 | 412878 | 1665 | 11 | 148 | 418137 | 2640 | 11 | 234 |
| DVA.4-50-20-M10-28-* | 50 | 20 | M10 | 28 | 90 | 415441 | 2680 | 5 | 536 | 412881 | 3460 | 5 | 692 | 418141 | 7450 | 5 | 1490 |
| DVA.4-50-25-M10-28-* | 50 | 25 | M10 | 28 | 98 | 415446 | 1867 | 6 | 298 | 412891 | 2970 | 6 | 475 | 418146 | 5130 | 6 | 820 |
| DVA.4-50-30-M10-28-* | 50 | 30 | M10 | 28 | 118 | 415451 | 1820 | 8 | 243 | 412901 | 2520 | 8 | 336 | 418151 | 5420 | 8 | 723 |
| DVA.4-50-35-M10-28-* | 50 | 35 | M10 | 28 | 125 | 415456 | 1705 | 8 | 194 | 412911 | 2800 | 8 | 320 | 418156 | 4920 | 8 | 562 |
| DVA.4-50-40-M10-28-* | 50 | 40 | M10 | 28 | 140 | 415461 | 1430 | 10 | 143 | 412921 | 2760 | 10 | 276 | 418161 | 4950 | 10 | 495 |
| DVA.4-50-45-M10-28-* | 50 | 45 | M10 | 28 | 158 | 415466 | 1627 | 11 | 144 | 412922 | 2455 | 11 | 218 | 418166 | 4600 | 11 | 408 |
| DVA.4-50-50-M10-28-* | 50 | 50 | M10 | 28 | 155 | 415463 | 1366 | 13 | 109 | 412923 | 2700 | 13 | 216 | 418163 | 4190 | 13 | 335 |
| DVA.4-60-20-M10-28-* | 60 | 20 | M10 | 28 | 219 | 415471 | 1885 | 5 | 377 | 412931 | 3850 | 5 | 770 | 418171 | 11990 | 5 | 2398 |
| DVA.4-60-25-M10-28-* | 60 | 25 | M10 | 28 | 223 | 415473 | 2550 | 6 | 408 | 412933 | 5000 | 6 | 800 | 418173 | 8020 | 6 | 1283 |
| DVA.4-60-36-M10-28-* | 60 | 36 | M10 | 28 | 263 | 415476 | 2428 | 9 | 269 | 412935 | 4110 | 9 | 456 | 418176 | 6690 | 9 | 743 |
| DVA.4-60-40-M10-28-* | 60 | 40 | M10 | 28 | 295 | 415481 | 2600 | 10 | 260 | 412936 | 3540 | 10 | 354 | 418181 | 4640 | 10 | 464 |
| DVA.4-60-45-M10-28-* | 60 | 45 | M10 | 28 | 300 | 415486 | 2378 | 11 | 211 | 412937 | 4200 | 11 | 373 | 418186 | 8020 | 11 | 712 |
| DVA.4-60-60-M10-28-* | 60 | 60 | M10 | 28 | 312 | 415485 | 2530 | 15 | 169 | 412939 | 3480 | 15 | 232 | 418185 | 8110 | 15 | 541 |
| DVA.4-70-30-M10-28-* | 70 | 30 | M10 | 28 | 280 | 415490 | 4930 | 8 | 657 | 412940 | 7170 | 8 | 956 | 418190 | 13070 | 8 | 1743 |
| DVA.4-70-35-M10-28-* | 70 | 35 | M10 | 28 | 285 | 415489 | 3450 | 9 | 383 | 412942 | 6680 | 9 | 763 | 418189 | 9850 | 9 | 1125 |
| DVA.4-70-40-M10-28-* | 70 | 40 | M10 | 28 | 290 | 415491 | 3850 | 10 | 385 | 412941 | 6280 | 10 | 628 | 418191 | 15280 | 10 | 1528 |
| DVA.4-70-50-M10-28-* | 70 | 50 | M10 | 28 | 320 | 415496 | 3680 | 12 | 294 | 412946 | 5550 | 12 | 444 | 418196 | 14960 | 12 | 1196 |
| DVA.4-70-55-M10-28-* | 70 | 55 | M10 | 28 | 357 | 415501 | 3320 | 14 | 241 | 412951 | 5770 | 14 | 420 | 418201 | 9510 | 14 | 692 |
| DVA.4-70-70-M10-28-* | 70 | 70 | M10 | 28 | 380 | 415506 | 3200 | 17 | 182 | 412966 | 5370 | 17 | 306 | 418206 | 13770 | 17 | 786 |
| DVA.4-75-25-M12-37-* | 75 | 25 | M12 | 37 | 270 | 415511 | 6560 | 6 | 1050 | 412961 | 9660 | 6 | 1546 | 418211 | 20780 | 6 | 3325 |
| DVA.4-75-40-M12-37-* | 75 | 40 | M12 | 37 | 310 | 415521 | 5010 | 10 | 501 | 412971 | 6680 | 10 | 668 | 418221 | 9170 | 10 | 917 |
| DVA.4-75-50-M12-37-* | 75 | 50 | M12 | 37 | 340 | 415531 | 3970 | 13 | 318 | 412981 | 5570 | 13 | 446 | 418231 | 13550 | 13 | 1084 |
| DVA.4-80-30-M14-37-* | 80 | 30 | M14 | 37 | 320 | 415533 | 6130 | 7 | 817 | 412991 | 10080 | 7 | 1344 | 418233 | 21100 | 7 | 2813 |
| DVA.4-80-40-M14-37-* | 80 | 40 | M14 | 37 | 330 | 415535 | 4750 | 10 | 475 | 412994 | 9260 | 10 | 926 | 418235 | 17050 | 10 | 1705 |
| DVA.4-80-80-M14-37-* | 80 | 80 | M14 | 37 | 390 | 415537 | 3200 | 20 | 160 | 412997 | 6970 | 20 | 348 | 418237 | 15560 | 20 | 778 |
| DVA.4-100-40-M16-41-* | 100 | 40 | M16 | 41 | 570 | 415541 | 9430 | 10 | 943 | 413001 | 12110 | 10 | 1211 | 418241 | 24190 | 10 | 2419 |
| DVA.4-100-50-M16-41-* | 100 | 50 | M16 | 41 | 655 | 415551 | 8320 | 13 | 666 | 413011 | 14040 | 13 | 1123 | 418251 | 22900 | 13 | 1832 |
| DVA.4-100-60-M16-41-* | 100 | 60 | M16 | 41 | 830 | 415561 | 7440 | 15 | 496 | 413021 | 12950 | 15 | 863 | 418261 | 21450 | 15 | 1430 |
| DVA.4-125-55-M16-41-* | 125 | 55 | M16 | 41 | 1055 | 415581 | 19700 | 14 | 1433 | 413025 | 23790 | 14 | 1730 | 418271 | 25000 | 14 | 2212 |
| DVA.4-125-75-M16-41-* | 125 | 75 | M16 | 41 | 1425 | 415591 | 17600 | 19 | 939 | 413027 | 20123 | 19 | 1073 | 418281 | 24780 | 19 | 1322 |



Vibration damping elements

- 1
- 2
- 3
- 4
- 5
- 6
- 7
- 8
- 9
- 10
- 11
- 12
- 13
- 14
- 15
- 16
- 17
- 18

DVA.4 - 8 - 8 - SST - M3 - 6 - 55
 D L Stainless steel d l Shore A

DVA.4-SST

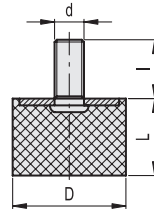

| D | | L | |
|----|------|-----|------|
| mm | inch | mm | inch |
| 8 | 0.31 | 50 | 1.97 |
| 10 | 0.39 | 60 | 2.36 |
| 15 | 0.59 | 70 | 2.76 |
| 20 | 0.79 | 75 | 2.95 |
| 25 | 0.98 | 80 | 3.12 |
| 30 | 1.18 | 100 | 3.94 |
| 40 | 1.57 | 125 | 4.92 |

DVA.4-SST

INOX STAINLESS STEEL METRIC

| Description | D | L | d | l | ⚖️ | Hardness 40 Shore A | | | Hardness 55 Shore A | | | Hardness 70 Shore A | | | | | |
|--------------------------|----|----|----|----|----|---------------------|--------------|---------------------|---------------------|--------|--------------|---------------------|------------------|------|--------------|---------------------|------------------|
| | | | | | | Code | Max load [N] | Max deflection [mm] | Stiffness [N/mm] | Code | Max load [N] | Max deflection [mm] | Stiffness [N/mm] | Code | Max load [N] | Max deflection [mm] | Stiffness [N/mm] |
| DVA.4-8-8-SST-M3-6-55 | 8 | 8 | M3 | 6 | 3 | | 34 | 2 | 17 | 410301 | 55 | 2 | 28 | | 141 | 2 | 71 |
| DVA.4-8-13-SST-M3-6-55 | 8 | 13 | M3 | 6 | 1 | | 33 | 3 | 10 | 410303 | 50 | 3 | 15 | | 133 | 3 | 41 |
| DVA.4-10-10-SST-M4-10-55 | 10 | 10 | M4 | 10 | 2 | | 54 | 3 | 21 | 410305 | 88 | 3 | 35 | | 217 | 3 | 87 |
| DVA.4-10-15-SST-M4-10-55 | 10 | 15 | M4 | 10 | 3 | | 69 | 4 | 18 | 410307 | 92 | 4 | 25 | | 175 | 4 | 47 |
| DVA.4-10-20-SST-M4-10-55 | 10 | 20 | M4 | 10 | 3 | | 54 | 5 | 11 | 410309 | 95 | 5 | 19 | | 156 | 5 | 31 |
| DVA.4-15-10-SST-M4-10-55 | 15 | 10 | M4 | 10 | 4 | | 110 | 2 | 55 | 410311 | 168 | 2 | 84 | | 410 | 2 | 205 |
| DVA.4-15-15-SST-M4-10-55 | 15 | 15 | M4 | 10 | 5 | | 141 | 4 | 38 | 410313 | 259 | 4 | 69 | | 384 | 4 | 102 |
| DVA.4-15-20-SST-M4-10-55 | 15 | 20 | M4 | 10 | 7 | | 134 | 5 | 27 | 410315 | 223 | 5 | 45 | | 590 | 5 | 118 |
| DVA.4-15-30-SST-M4-10-55 | 15 | 30 | M4 | 10 | 9 | | 125 | 8 | 17 | 410317 | 258 | 8 | 34 | | 392 | 8 | 52 |
| DVA.4-20-5-SST-M6-18-55 | 20 | 5 | M6 | 18 | 12 | | 1148 | 1 | 918 | 410318 | 11840 | 1 | 9472 | | 3250 | 1 | 2600 |
| DVA.4-20-8-SST-M6-18-55 | 20 | 8 | M6 | 18 | 14 | | 560 | 2 | 280 | 410319 | 882 | 2 | 441 | | 1713 | 2 | 856 |
| DVA.4-20-10-SST-M6-18-55 | 20 | 10 | M6 | 18 | 15 | | 390 | 3 | 156 | 410321 | 645 | 3 | 258 | | 940 | 3 | 376 |
| DVA.4-20-15-SST-M6-18-55 | 20 | 15 | M6 | 18 | 10 | | 289 | 4 | 77 | 410323 | 468 | 4 | 125 | | 704 | 4 | 188 |
| DVA.4-20-20-SST-M6-18-55 | 20 | 20 | M6 | 18 | 13 | | 258 | 5 | 52 | 410325 | 367 | 5 | 73 | | 809 | 5 | 162 |
| DVA.4-20-25-SST-M6-18-55 | 20 | 25 | M6 | 18 | 17 | | 250 | 6 | 40 | 410326 | 345 | 6 | 55 | | 857 | 6 | 137 |
| DVA.4-20-30-SST-M6-18-55 | 20 | 30 | M6 | 18 | 23 | | 237 | 8 | 32 | 410327 | 420 | 8 | 56 | | 848 | 8 | 113 |
| DVA.4-25-15-SST-M6-18-55 | 25 | 15 | M6 | 18 | 18 | | 485 | 4 | 129 | 410331 | 797 | 4 | 213 | | 1627 | 4 | 434 |
| DVA.4-25-17-SST-M6-18-55 | 25 | 17 | M6 | 18 | 20 | | 422 | 4 | 99 | 410333 | 833 | 4 | 196 | | 1726 | 4 | 406 |
| DVA.4-25-20-SST-M6-18-55 | 25 | 20 | M6 | 18 | 20 | | 416 | 5 | 83 | 410335 | 581 | 5 | 116 | | 1382 | 5 | 276 |
| DVA.4-25-25-SST-M6-18-55 | 25 | 25 | M6 | 18 | 23 | | 410 | 6 | 65 | 410336 | 645 | 6 | 103 | | 1500 | 6 | 240 |
| DVA.4-25-25-SST-M8-18-55 | 25 | 25 | M8 | 18 | 22 | | 532 | 6 | 85 | 410338 | 650 | 6 | 104 | | 1120 | 6 | 179 |
| DVA.4-25-30-SST-M6-18-55 | 25 | 30 | M6 | 18 | 25 | | 290 | 8 | 39 | 410337 | 591 | 8 | 79 | | 1186 | 8 | 158 |

Vibration damping elements

DVA.4-SST



| Description | D | L | d | l | ⚖️ | Hardness 40 Shore A | | | Hardness 55 Shore A | | | Hardness 70 Shore A | | | | | |
|----------------------------|-----|----|-----|----|------|---------------------|--------------|---------------------|---------------------|--------|--------------|---------------------|------------------|------------|--------------|---------------------|------------------|
| | | | | | | Code | Max load [N] | Max deflection [mm] | Stiffness [N/mm] | Code | Max load [N] | Max deflection [mm] | Stiffness [N/mm] | Code | Max load [N] | Max deflection [mm] | Stiffness [N/mm] |
| DVA.4-30-15-SST-M8-20-55 | 30 | 15 | M8 | 20 | 30 | | 746 | 4 | 199 | 410341 | 1023 | 4 | 273 | | 2610 | 4 | 696 |
| DVA.4-30-17-SST-M8-20-55 | 30 | 17 | M8 | 20 | 31 | | 772 | 4 | 182 | 410343 | 1275 | 4 | 300 | | 2447 | 4 | 576 |
| DVA.4-30-20-SST-M8-20-55 | 30 | 20 | M8 | 20 | 35 | | 567 | 5 | 113 | 410345 | 1014 | 5 | 203 | | 1878 | 5 | 376 |
| DVA.4-30-22-SST-M8-20-55 | 30 | 22 | M8 | 20 | 36 | | 689 | 5 | 125 | 410346 | 1103 | 5 | 200 | | 1996 | 5 | 362 |
| DVA.4-30-25-SST-M8-20-55 | 30 | 25 | M8 | 20 | 38 | | 576 | 6 | 92 | 410347 | 1026 | 6 | 164 | | 1591 | 6 | 255 |
| DVA.4-30-30-SST-M8-20-55 | 30 | 30 | M8 | 20 | 43 | | 601 | 8 | 80 | 410349 | 776 | 8 | 103 | | 1616 | 8 | 215 |
| DVA.4-30-40-SST-M8-20-55 | 30 | 40 | M8 | 20 | 48 | | 580 | 10 | 58 | 410350 | 910 | 10 | 91 | | 1780 | 10 | 178 |
| DVA.4-40-20-SST-M8-23-55 | 40 | 20 | M8 | 23 | 55 | | 1200 | 5 | 240 | 410351 | 2500 | 5 | 500 | | 4750 | 5 | 950 |
| DVA.4-40-20-SST-M10-23-55 | 40 | 20 | M10 | 23 | 54 | | 1027 | 5 | 205 | 410352 | | | | | 3230 | 5 | 646 |
| DVA.4-40-25-SST-M8-23-55 | 40 | 25 | M8 | 23 | 60 | | 1170 | 6 | 187 | 410353 | 1660 | 6 | 266 | | 4130 | 6 | 661 |
| DVA.4-40-25-SST-M10-23-55 | 40 | 25 | M10 | 23 | 23 | | 975 | 6 | 156 | 410354 | 1925 | 6 | 308 | | 2880 | 6 | 460 |
| DVA.4-40-28-SST-M8-23-55 | 40 | 28 | M8 | 23 | 22 | | 1012 | 7 | 145 | 410356 | 1748 | 7 | 249 | | 3060 | 7 | 437 |
| DVA.4-40-30-SST-M8-23-55 | 40 | 30 | M8 | 23 | 73 | | 1140 | 8 | 152 | 410355 | 1480 | 8 | 197 | | 2830 | 8 | 377 |
| DVA.4-40-35-SST-M10-23-55 | 40 | 35 | M10 | 23 | 78 | | 940 | 8 | 107 | 410358 | 1572 | 8 | 179 | | 3680 | 8 | 420 |
| DVA.4-40-38-SST-M8-23-55 | 40 | 38 | M8 | 23 | 80 | | 970 | 9 | 102 | 410359 | 1492 | 9 | 157 | | 3370 | 9 | 354 |
| DVA.4-40-40-SST-M8-23-55 | 40 | 40 | M8 | 23 | 83 | | 995 | 10 | 100 | 410357 | 1403 | 10 | 140 | | 3150 | 10 | 315 |
| DVA.4-40-40-SST-M10-23-55 | 40 | 40 | M10 | 23 | 82 | | 1040 | 10 | 104 | 410360 | 1575 | 10 | 157 | | 3130 | 10 | 313 |
| DVA.4-40-45-SST-M10-23-55 | 40 | 45 | M10 | 23 | 85 | | 1005 | 11 | 89 | 410362 | 1665 | 11 | 148 | | 2640 | 11 | 234 |
| DVA.4-50-20-SST-M10-28-55 | 50 | 20 | M10 | 28 | 90 | | 2680 | 5 | 536 | 410361 | 3460 | 5 | 692 | | 7450 | 5 | 1490 |
| DVA.4-50-25-SST-M10-28-55 | 50 | 25 | M10 | 28 | 98 | | 1867 | 6 | 298 | 410364 | 2970 | 6 | 475 | | 5130 | 6 | 820 |
| DVA.4-50-30-SST-M10-28-55 | 50 | 30 | M10 | 28 | 118 | | 1820 | 8 | 243 | 410363 | 2520 | 8 | 336 | | 5420 | 8 | 723 |
| DVA.4-50-35-SST-M10-28-55 | 50 | 35 | M10 | 28 | 125 | | 1705 | 8 | 194 | 410366 | 2800 | 8 | 320 | | 4920 | 8 | 562 |
| DVA.4-50-40-SST-M10-28-55 | 50 | 40 | M10 | 28 | 140 | ON REQUEST | 1430 | 10 | 143 | 410365 | 2760 | 10 | 276 | ON REQUEST | 4950 | 10 | 495 |
| DVA.4-50-45-SST-M10-28-55 | 50 | 45 | M10 | 28 | 148 | | 1627 | 11 | 144 | 410368 | 2455 | 11 | 218 | | 4600 | 11 | 408 |
| DVA.4-50-50-SST-M10-28-55 | 50 | 50 | M10 | 28 | 155 | | 1366 | 13 | 109 | 410367 | 2700 | 13 | 216 | | 4190 | 13 | 335 |
| DVA.4-60-20-SST-M10-28-55 | 60 | 20 | M10 | 28 | 219 | | 1885 | 5 | 377 | 410371 | 3850 | 5 | 770 | | 11990 | 5 | 2398 |
| DVA.4-60-25-SST-M10-28-55 | 60 | 25 | M10 | 28 | 223 | | 2550 | 6 | 408 | 410370 | 5000 | 6 | 800 | | 8020 | 6 | 1283 |
| DVA.4-60-36-SST-M10-28-55 | 60 | 36 | M10 | 28 | 263 | | 2428 | 9 | 269 | 410372 | 4110 | 9 | 456 | | 6690 | 9 | 743 |
| DVA.4-60-40-SST-M10-28-55 | 60 | 40 | M10 | 28 | 195 | | 2600 | 10 | 260 | 410373 | 3540 | 10 | 354 | | 4640 | 10 | 464 |
| DVA.4-60-45-SST-M10-28-55 | 60 | 45 | M10 | 28 | 300 | | 2378 | 11 | 211 | 410374 | 4200 | 11 | 373 | | 8020 | 11 | 712 |
| DVA.4-60-60-SST-M10-28-55 | 60 | 60 | M10 | 28 | 312 | | 2530 | 15 | 169 | 410375 | 3480 | 15 | 232 | | 8110 | 15 | 541 |
| DVA.4-70-30-SST-M10-28-55 | 70 | 30 | M10 | 28 | 280 | | 4930 | 8 | 657 | 410376 | 7170 | 8 | 956 | | 13070 | 8 | 1743 |
| DVA.4-70-35-SST-M10-28-55 | 70 | 35 | M10 | 28 | 285 | | 3450 | 9 | 383 | 410378 | 6680 | 9 | 763 | | 9850 | 9 | 1125 |
| DVA.4-70-40-SST-M10-28-55 | 70 | 40 | M10 | 28 | 265 | | 3850 | 10 | 385 | 410377 | 6280 | 10 | 628 | | 15280 | 10 | 1528 |
| DVA.4-70-50-SST-M10-28-55 | 70 | 50 | M10 | 28 | 320 | | 3680 | 12 | 294 | 410380 | 5550 | 12 | 444 | | 14960 | 12 | 1196 |
| DVA.4-70-55-SST-M10-28-55 | 70 | 55 | M10 | 28 | 357 | | 3320 | 14 | 241 | 410379 | 5770 | 14 | 420 | | 9510 | 14 | 692 |
| DVA.4-70-70-SST-M10-28-55 | 70 | 70 | M10 | 28 | 380 | | 3200 | 17 | 182 | 410382 | 5370 | 17 | 306 | | 13770 | 17 | 786 |
| DVA.4-75-25-SST-M12-37-55 | 75 | 25 | M12 | 37 | 223 | | 6560 | 6 | 1050 | 410381 | 9660 | 6 | 1546 | | 20780 | 6 | 3325 |
| DVA.4-75-40-SST-M12-37-55 | 75 | 40 | M12 | 37 | 310 | | 5010 | 10 | 501 | 410383 | 6680 | 10 | 668 | | 9170 | 10 | 917 |
| DVA.4-75-50-SST-M12-37-55 | 75 | 50 | M12 | 37 | 340 | | 3970 | 13 | 318 | 410385 | 5570 | 13 | 446 | | 13550 | 13 | 1084 |
| DVA.4-80-30-SST-M14-37-55 | 80 | 30 | M14 | 37 | 320 | | 6130 | 7 | 817 | 410387 | 10080 | 7 | 1344 | | 21100 | 7 | 2813 |
| DVA.4-80-40-SST-M14-37-55 | 80 | 40 | M14 | 37 | 330 | | 4750 | 10 | 475 | 410388 | 9260 | 10 | 926 | | 17050 | 10 | 1705 |
| DVA.4-80-80-SST-M14-37-55 | 80 | 80 | M14 | 37 | 390 | | 3200 | 20 | 160 | 410389 | 6970 | 20 | 348 | | 15560 | 20 | 778 |
| DVA.4-100-40-SST-M16-41-55 | 100 | 40 | M16 | 41 | 570 | | 9430 | 10 | 943 | 410391 | 12110 | 10 | 1211 | | 24190 | 10 | 2419 |
| DVA.4-100-50-SST-M16-41-55 | 100 | 50 | M16 | 41 | 655 | | 8320 | 13 | 666 | 410393 | 14040 | 13 | 1123 | | 22900 | 13 | 1832 |
| DVA.4-100-60-SST-M16-41-55 | 100 | 60 | M16 | 41 | 830 | | 7440 | 15 | 496 | 410395 | 12950 | 15 | 863 | | 21450 | 15 | 1430 |
| DVA.4-125-55-SST-M16-41-55 | 125 | 55 | M16 | 41 | 1055 | | 19700 | 14 | 1433 | 410396 | 23790 | 14 | 1730 | | 25000 | 14 | 2212 |
| DVA.4-125-75-SST-M16-41-55 | 125 | 75 | M16 | 41 | 1425 | | 17600 | 19 | 939 | 410397 | 20123 | 19 | 1073 | | 24780 | 19 | 1322 |



Vibration damping elements