

PART NO. 92311-0002
 DWG. NO. SDA-92311-0002

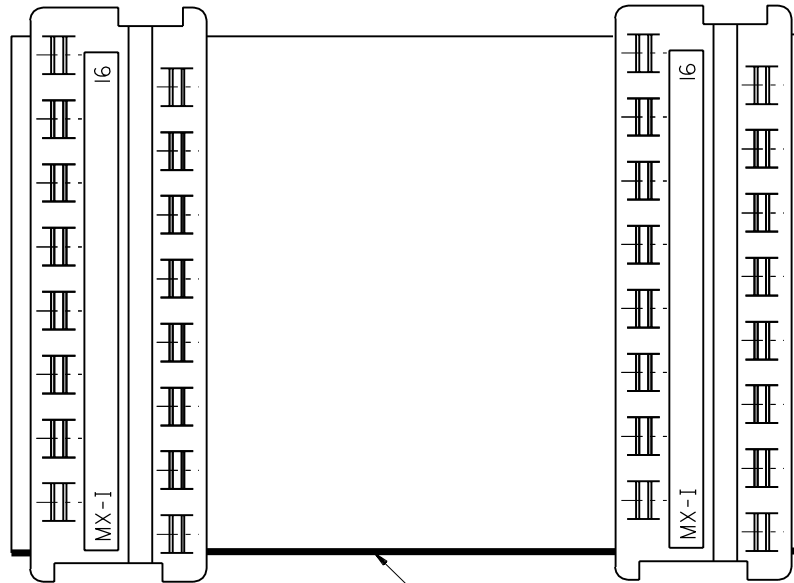
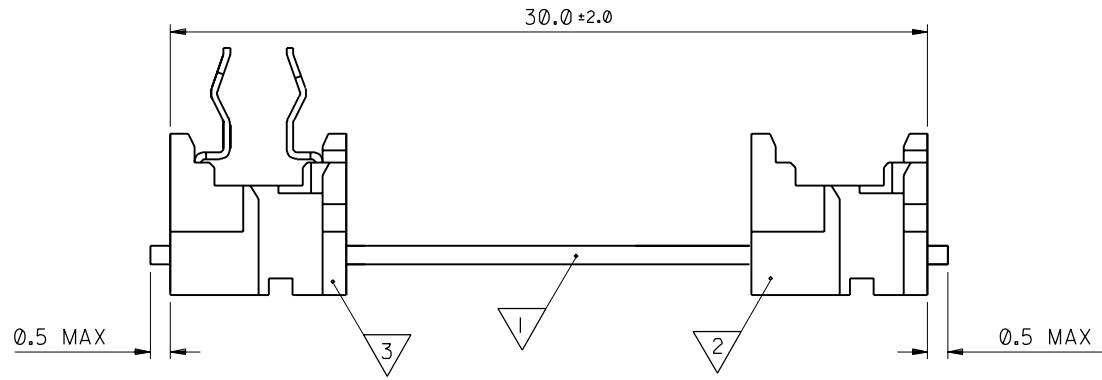

CIRCUIT IDENTIFICATION

| ITEM | COMPONENT | DESCRIPTION | QUANTITY | NOTE |
|------|------------|---|----------|---------|
| ▽ | 99026-0001 | 16 CKT 28 AWG STRANDED TINNED RIBBON CABLE | 1 | 1, 4, 5 |
| ▽ | 90327-0316 | PICOFLEX FEMALE IDT CONNECTOR | 1 | 1, 2, 5 |
| ▽ | 90584-1316 | PICOFLEX BOARD-IN IDT CONNECTOR | 1 | 1, 3, 5 |

NOTES:

- SEE PRODUCT SPECIFICATION PS-99020-0011.
- SEE TERMINATION SPECIFICATION ES-99033-0001.
- SEE TERMINATION SPECIFICATION ES-99033-0002.
- SEE CABLE SPECIFICATION ES-99027-0006.
- HARNESSES TO BE 100% ELECTRICALLY TESTED.

THIRD ANGLE PROJECTION REVISE ONLY ON CAD SYSTEM SH. REV.

DIMENSIONS SHOWN (METRIC) INCH
 UNLESS OTHERWISE SPECIFIED
 TOLERANCES: ANGULAR ±2°

| PLACE | TOLERANCE | UNIT |
|---------|-----------|------|
| 3 PLACE | ± | |
| 2 PLACE | ± | |
| 1 PLACE | ± | |

DRAFT WHERE APPLICABLE MUST
 REMAIN WITHIN DIMENSIONS

| | |
|----------------------------------|---|
| DESIGN DIMENSION (PRIMARY) | <input checked="" type="checkbox"/> (MM) <input type="checkbox"/> IN. |
| EQUIVALENT DIMENSION (SECONDARY) | <input type="checkbox"/> (MM) <input type="checkbox"/> IN. |

DRWG BY
AMc

CHK'D BY

APP'D BY

SCALE
5:1

CAD/CAM FILENAME
 S92311X2 DGN
 THIS DRAWING CONTAINS INFORMATION THAT IS PROPRIETARY TO
 MOLEX INC. & SHOULD NOT BE USED WITHOUT WRITTEN PERMISSION

TITLE
**16CKT PICOFLEX CABLE
 HARNESS**

MOLEX EUROPE SHEET NO. DATE
 10F1 97/04/07

PART NO. DWG NO. SIZE
92311-0002 SDA-92311-0002 B

CHANGE HARNESS LENGTH
 ECN 2002-0283
 01/09/21 LC
 D LTR REVISIONS