

PART NO.

RFD-1604-2L2

REV

DESCRIPTION

DWN DATE

APPROVED

C | UPDATED CONNECTOR DWG & CABLE STRIP DIMENSIONS

DM 3/17/20

JDMc

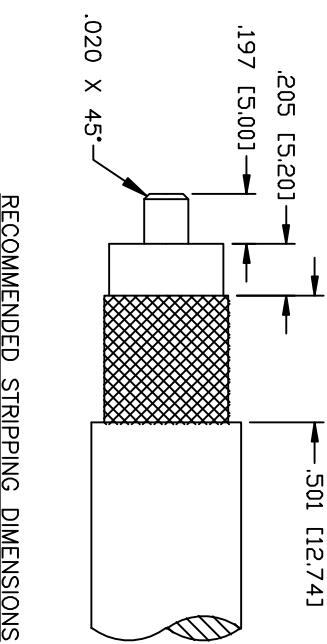
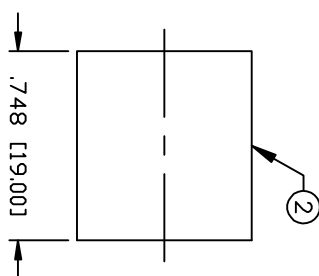
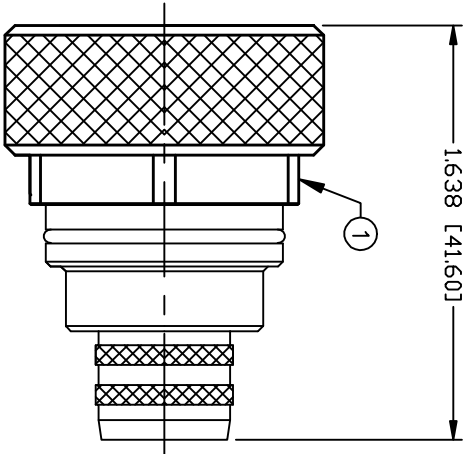

RECOMMENDED CRIMP DIE: .60"

RECOMMENDED STRIPPING DIMENSIONS

SPECIFICATIONS:

IMPEDANCE: 50 Ohms
 FREQUENCY RANGE: 0-7.5 GHz
 PEAK POWER: 13.2 KW max.
 AVERAGE POWER: 3.0 KW max.
 TEMPERATURE RANGE: -55°C TO 85°C
 FOR TIMES LMR-600 & T-COM-600
 ROHS COMPLIANT

#	DESCRIPTION	MATERIAL	FINISH
1	7/16 MALE CONNECTOR	BRASS	SILVER
2	FERRULE	BRASS	SILVER

CUSTOMER
 OUTLINE DRAWING
 ALL DIMENSIONS
 ARE REFERENCE ONLY
 UNLESS OTHERWISE SPECIFIED:
 DIMENSIONS ARE IN INCHES
 AND [MILLIMETERS]

PROPRIETARY AND CONFIDENTIAL
 THIS DRAWING CONTAINS TO
 INFORMATION PROPRIETARY TO
 RF INDUSTRIES. ANY
 UNAUTHORIZED USE OF THIS
 DRAWING IS EXPRESSLY
 PROHIBITED WITHOUT WRITTEN
 PERMISSION FROM RF
 INDUSTRIES. ANY VIOLATION IS
 PUNISHABLE UNDER U.S.
 COPYRIGHT LAWS.

RF Industries
 DIVISION OF RF INDUSTRIES, LTD. (858) 548-6346 FAX
 RFINDUSTRIES.COM
 7610 MIRAMAR RD.
 SAN DIEGO, CA 92126
 (858) 548-6340

7-16 DIN PLUG, CRIMP

BRASS
 D.McREYNOLDS 3/17/20
 CHECKED

600 DRAWN
 D. McREYNOLDS 3/6/00

CABLE GROUP DWG #
 L2 RFD-1604-2L2 REVISION
 C
 FORMAT SCALE CONTROL # SHEET 1 OF 1
 A NTS 000000