

** Not all features are shown in this drawing. For more detailed information, please contact your Fair-Rite representative.

UNCONTROLLED ~CATALOG~ DRAWING

SIZE	PART NO.	REV.
B	9367055002	~

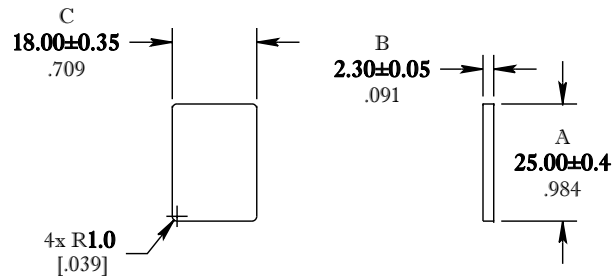

ELECTRICAL SPECIFICATIONS						
$\Sigma l/A(\text{mm}^{-1})$	l_e (mm)	A_e (mm ²)	A_{Min} (mm ²)	V_e (mm ³)	A_L (nH) @10kHz <10gauss	Q @ 50MHz <1gauss
0.293	26.4	90.3	82.8	2380	132 Min.	> 50
MATE WITH FR# 9567250602: CLAMPING FORCE = 10 lbs.						

POWER LOSS @ 25°C

f = 5 MHz, 100g P.L. <0.29 Watts
f = 10 MHz, 100g P.L. <0.81 Watts

DIMENSIONS
BOLD NUMBERS ARE IN MILLIMETERS
LIGHT NUMBERS ARE IN INCHES

FR# 67

FAIR-RITE PRODUCTS CORP.						
TITLE "1" CORE						
DRAWN BY D. FOOTE	DATE 4/3/2019	SIZE	PART NO.	REV.		
CHKD BY		B	9367055002	~		
APPRVD BY		SCALE	NONE	SHEET	1 of 1	