

| REVISIONS | | | | | |
|-----------|-----|---------------------------|-----------|-----|------|
| P | LTR | DESCRIPTION | DATE | DWN | APVD |
| | L1 | REV PER ECO-12-014455 | 13SEP12 | KH | DR |
| | L2 | REVISED PER ECO-17-014338 | 29MAR2018 | RS | DR |

| | | |
|--------------------------------|--------------------------------|--------------------------------|
| AMP WIRE RANGE | Listed FILE E13288 | LR7189 Certified |
| 16-14 AWG SOLID OR STRANDED | 16-14 AWG SOLID OR STRANDED | 16-14 AWG SOLID OR STRANDED |

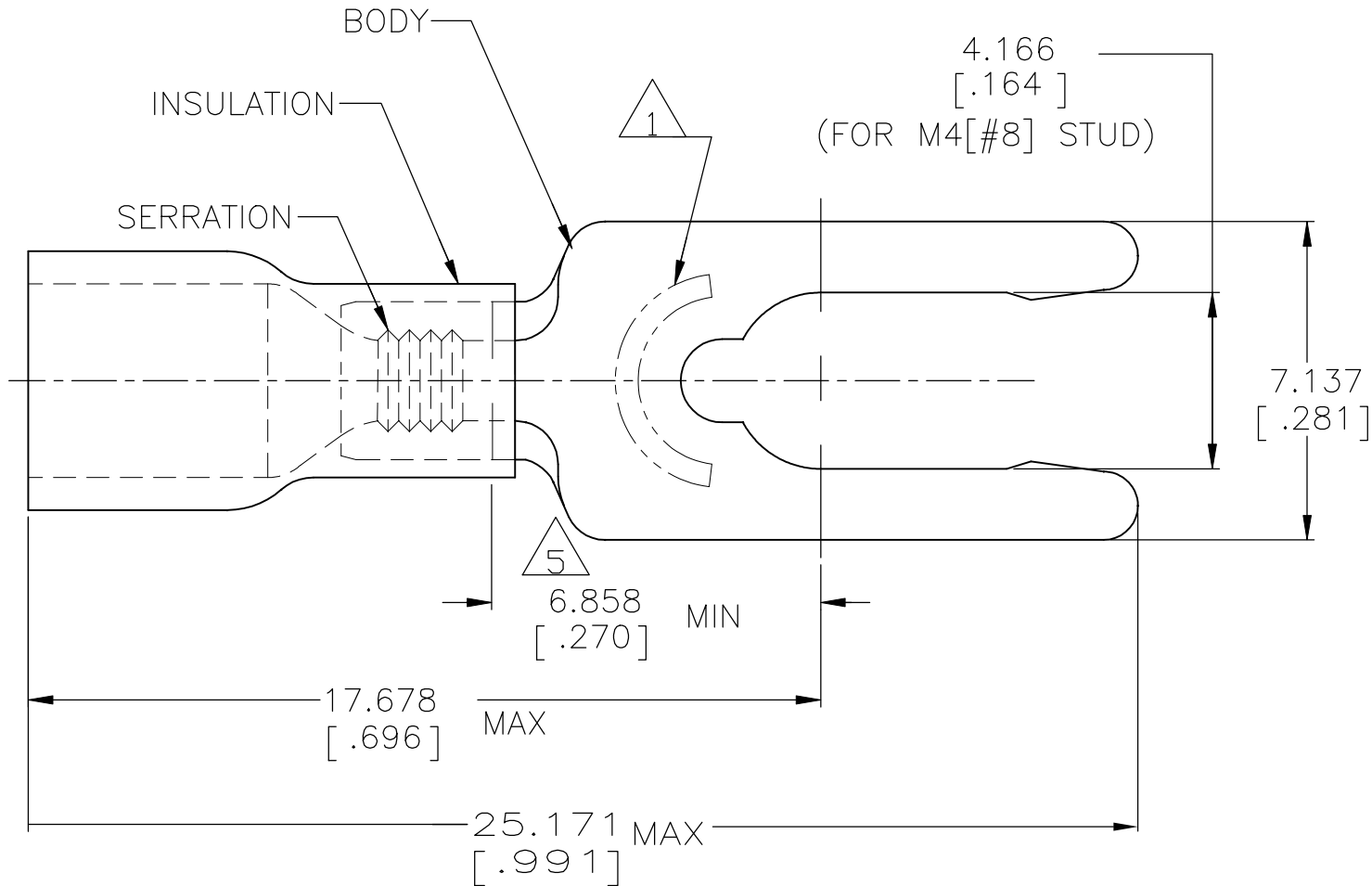

- △ 1 STAMP 8SAMP 16-14* APPROX AS SHOWN
- 2 WIRE INSUL DIA, 2.997-4.902 [.118-.193]
- 3 BODY MATL THK, 0.787±0.051 [.031±.002]
- △ 4 MATERIAL: BODY - BRASS PER ASTM B36
INSULATION - PVC
- △ 5 APPLIES FROM CENTER OF STUD HOLE TO
EDGE OF METAL WIRE BARREL

| | | |
|------|---------------|---------|
| 5000 | ON TAPE, REEL | 52464-1 |
| 1000 | LOOSE PIECE | 52464 |
| QTY | PACKAGE TYPE | PART NO |

| | | | | | | | | | | |
|--|--|---|--|---|----------------------------|---|--------------------|-----------------------|--------------------|--------|
| AMP INCORPORATED CUSTOMER SERVICE SYSTEMS | | MAX RECOMMENDED OPERATING TEMPERATURE: 105°C [221° F] | THIS DRAWING IS A CONTROLLED DOCUMENT. | | DWN L OLMEDA 26JUN95 | TE Connectivity Ltd. | | | | |
| FOR ADDITIONAL PRODUCT INFORMATION OR COPIES OF DRAWINGS AND TECHNICAL DOCUMENTS | PRODUCT INFORMATION CENTER 1-800-522-6752 | VOLTAGE RATING: 600V MAX (1000V FIXTURE OR SIGN) | DIMENSIONS: mm [INCHES] | TOLERANCES UNLESS OTHERWISE SPECIFIED: | CHK M ELLIS 26JUN95 | | | | NAME | |
| FOR APPLICATION TOOLING INFORMATION | TOOLING ASSISTANCE CENTER 1-800-722-1111 | CIRCULAR MIL AREA: 1.04-2.62mm² [2,050-5,180] SOLID OR STRANDED | | 0 PLC ± - 1 PLC ± - 2 PLC ± - 3 PLC ± 0.127[.005] 4 PLC ± - ANGLES ± - | APVD G NGO 26JUN95 | TERMINAL, SPRING SPADE, LONG, PLASTI-GRIP, WIRE SIZE: 16-14 AWG | | | | |
| FOR ORDER ENTRY | 1-800-526-5142 | THIS DRAWING IS A CONTROLLED DOCUMENT FOR AMP INCORPORATED. IT IS SUBJECT TO CHANGE AND THE CONTROLLING ENGINEERING ORGANIZATION SHOULD BE CONTACTED FOR THE LATEST REVISION. | MATERIAL △ 4 | FINISH BODY: TIN PER ASTM B545 INSULATION: COLOR-BLUE | PRODUCT SPEC UL 486A-B | SIZE A3 | CAGE CODE 00779 | DRAWING NO C-52464 | RESTRICTED TO - | |
| | | | | | WEIGHT | SCALE 6:1 | | | SHEET 1 OF 1 | REV L2 |