

CONTACT ORIENTATION ON ROLL
 NOTES: (UNLESS OTHERWISE SPECIFIED)

1. MATERIAL:
 - 1.1. CONTACT BODY: COPPER ALLOY.
 - 1.2. OUTER SPRING: STAINLESS STEEL.
2. SPECIFICATIONS:
 - 2.1 CURRENT RATING: 5A MAX.
 - 2.2 TERMINATION TYPE: CRIMPING.
 - 2.3 WIRE RANGE: 26~24AWG.
 - 2.4 WIRE INSULATION DIA(MAX): $\varnothing 2.2\text{mm}$.
3. ROHS COMPLIANT.
4. ALL DIMENSIONS ARE FOR REFERENCE USE ONLY.
5. AVAILABLE TOOLS:
 - 5.1 HAND CRIMPER: MFX-3958. A3
 - 5.2 CRIMP APPLICATOR: MFX-3957.
 - 5.3 EXTRACTION TOOL: QXRT20.

P/N	CONTACT PLATING(MATING AREA)
SP24W2T	TIN PLATING OVER NICKEL.
SP24W2N	NICKEL PLATING OVER COPPERIZE.
SP24W2F	GOLD FLASH PLATING OVER NICKEL.
SP24W2G5	5 μ " GOLD PLATING OVER NICKEL.
SP24W2G10	10 μ " GOLD PLATING OVER NICKEL.
SP24W2G15	15 μ " GOLD PLATING OVER NICKEL.
SP24W2G30	30 μ " GOLD PLATING OVER NICKEL.

A2

REVISIONS				
REV	ECO	DESCRIPTION	DATE	BY APPR
A1	-	RELEASED DRAWING	Nov-8-17	Rookie Tommy
A2	-	ADD THE G5 PART NUMBER	Jan-28-19	Blink Tommy
A3	-	CHANGE HAND CRIMPER	Nov-8-19	Flan Tommy

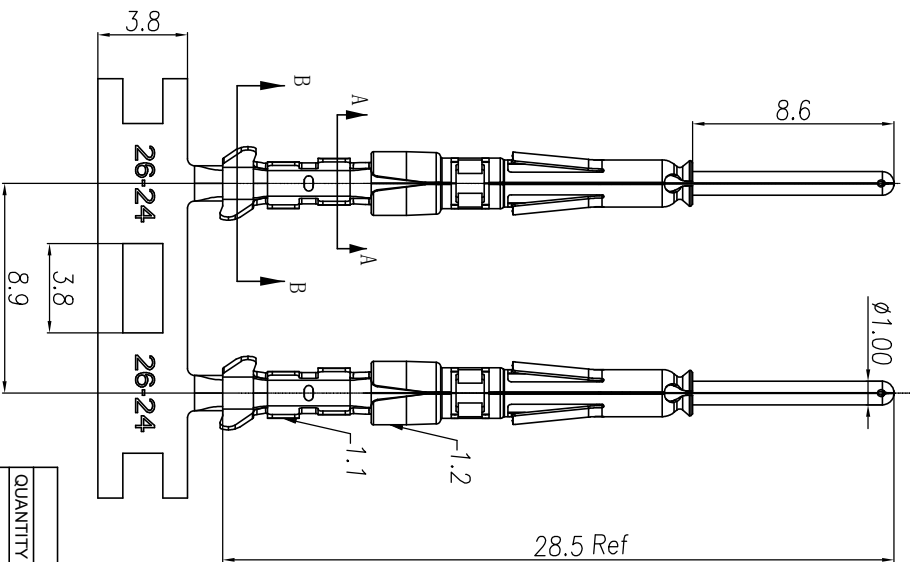

SECTION A-A

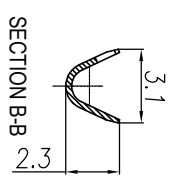

QUANTITY	PART NUMBER	DESCRIPTION	ITEM
		MATERIALS LIST	

UNLESS OTHERWISE SPECIFIED
 1) All dimensions are in millimeters.
 2) Tolerances are as follows:
 1 Pt. DEC 40-90 Fractions 1/100
 3 Pt. DEC 20-90
 3) Note reference = **△**

SIGNATURES	DATE
DRAWN: Rui	Nov-8-19
CHECKED: Mah	Nov-8-19
ENGINEER:	
APPROVE: Tommy	Nov-8-19
CUSTOMER:	

MATERIAL SPECIFICATIONS: **ECO-MATE PIN CONTACT.**

PROCESS SPECIFICATIONS: **STAMPED, 24-28AWG, SIZE 20**

THE DRAWING IS SUPPLEMENTED FOR SPECIFICATIONS AND PERFORMANCE DATA BY THE MANUFACTURING INSTRUCTIONS. THE MANUFACTURING INSTRUCTIONS ARE PART OF REPRODUCTION AND ARE MADE ALL MANUFACTURING VARIATIONS.

SCALE: NONE

Amphenol
 Sine Systems - www.amphenol-sine.com
 44724 Montey Drive
 Clinton Township, MI 48038

ECO-MATE PIN CONTACT.
 STAMPED, 24-28AWG, SIZE 20

SIZE TYPE: **B C-**

DWG NO: **SP24W2XX**

REVISION: **A3**

SHEET 1 OF 1