

REV.	EN. NO.	DESCRIPTION	SIGN	DATE
C1	N/A	INITIAL DRAWING	Liu	2019/08/13

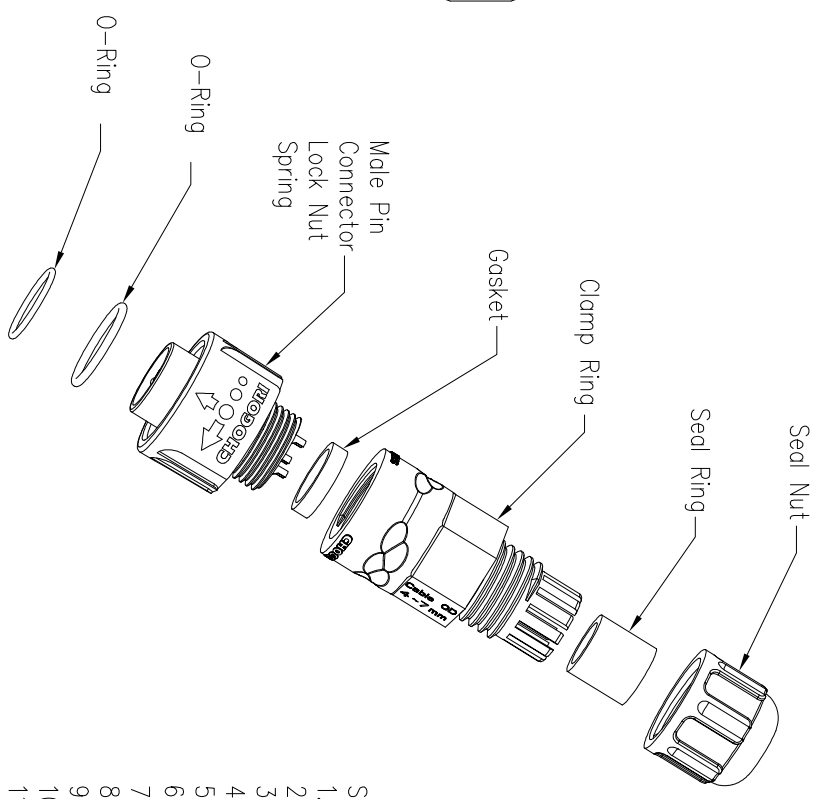

- Specification:
1. Operation Temperature: $-45^{\circ}\text{C}\sim 105^{\circ}\text{C}$.
 2. Insulation Resistance: $100\text{M}\Omega$ at DC500V.
 3. Contact Resistance: $<10\text{m}\Omega$.
 4. Withstand Voltage: 1500V AC
 5. Operating Current: 10A
 6. Operating Voltage: AC 125V
 7. Waterproof Rate: IP67 (Mated)
 8. Seal Nut: Nylon, Black
 9. Seal Nut: Silicon, Black
 10. Clamp Ring: Nylon, Black
 11. Gasket: Silicon, Red
 12. Male Pin: Copper Alloy, Gold Plated
 13. Connector: Nylon+GF, Black
 14. Lock Nut: Nylon, Blue
 15. Spring: SUS
 16. O-Ring: Silicon, Red
 17. RoHS Compliant.
 18. Cable Range OD: $\phi 3.5\text{mm}\sim\phi 6.8\text{mm}$
 19. Mating Cap: 804-00009-00

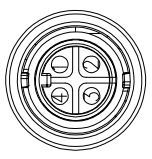
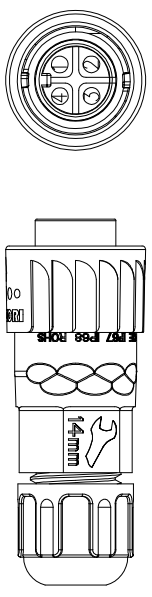
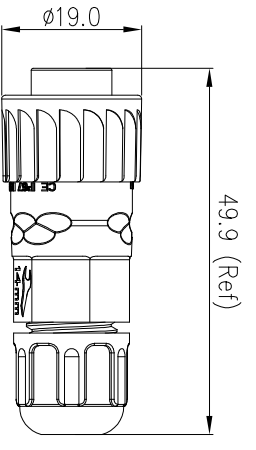
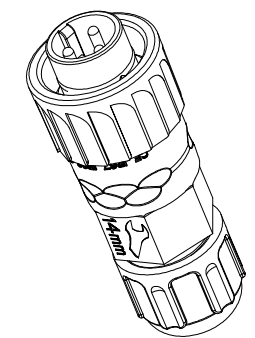

22XXX131-01

Pin Number

4 Pin

P/N: 22004131-01

Pin Assignments
Front View

UNIT: mm	DESCRIPTION
TOLERANCE .X .XX .XXX ANGLES	Standard Series Push Lock Male Plug With Male Pin
SCALE	1:1
REV	C1
SIZE	A4
SHEET	1 OF 1
* : Inspection Item	

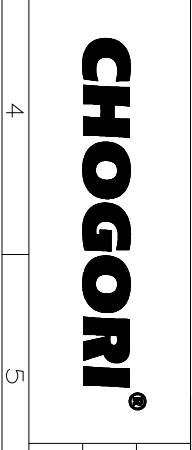

PART NO	DESCRIPTION	DATE
22XXX131-01	Standard Series Push Lock Male Plug With Male Pin	2019/08/13
DWG NO	CHECKED BY	DATE
	Mo	2019/08/13
CUSTOMER	APPROVED BY	DATE
	Pamson	2019/08/13